

PUBLIC PATH STOPPING UP ORDER 2014

TOWN AND COUNTRY PLANNING ACT 1990 SECTION 257

MALVERN HILLS DISTRICT COUNCIL

FOOTPATH 566(C) (PART)

PARISH OF UPTON-UPON-SEVERN

This Order is made by Malvern Hills District Council ("the Council") under Section 257 of the Town and Country Planning Act 1990 ("the Act") because it is satisfied that it is necessary to stop up Footpath No 566(C)(Part) in the Parish of Upton-upon-Severn to which this Order relates in order to enable the development ("the Development") to be carried out in accordance with planning permission granted under Part III of the Town and Country Planning Act 1990, namely the erection of forty three dwellings at Welland Road, Upton-upon-Severn, Worcestershire under planning permission reference number MH13/00009/FUL.

BY THIS ORDER

1. The Council authorises the stopping up of an area of the highway being Footpath No 566(C)(Part) in the Parish of Upton-upon-Severn shown with a bold black line on the attached plan ("the Plan") and described in the Schedule to this Order ("the Schedule") in order to enable the Development to be carried out.
2. The said Order will not take effect until the Malvern Hills District Council's Land at Welland Road, Upton-upon-Severn Footpath Creation Agreement comes into operation.
3. Where immediately before the date on which the footpath is stopped up there is apparatus under, in, on, over, along or across it belonging to statutory undertakers for the purpose of carrying on their undertaking, the undertakers shall continue to have the same rights in respect of the apparatus as they then had.

THE COMMON SEAL of MALVERN HILLS DISTRICT COUNCIL was hereunto affixed this 20 day of October 2014 in the presence of:-

Head of Policy and Governance



Seal: 192

NOTICE OF PUBLIC PATH STOPPING UP ORDER 2014
TOWN AND COUNTRY PLANNING ACT 1990 SECTION 257

MALVERN HILLS DISTRICT COUNCIL

FOOTPATH 566(C) (PART)

PARISH OF UPTON-UPON-SEVERN

PUBLIC NOTICE

The above Order was made on 20th October 2014 under Section 257 of the Town and Country Planning Act 1990 and the effect of the Order will be to stop up the full width of that part of Footpath 566 (C)(Part) in the Parish of Upton-upon-Severn shown by a continuous bold line commencing at Point A (Grid reference: SO 84038 39933) on the Order map and continuing in a generally southerly direction for approximately 80 metres to Point D (Grid reference: SO 84035 39851). The said Order will not take effect until the Malvern Hills District Council's Land at Welland Road, Upton-upon-Severn Footpath Creation Agreement comes into operation.

A copy of the Order and the Order Map may be seen free of charge at Malvern Hills Customer Service Centre, Graham Road, Malvern WR14 2HU during normal office hours. Copies of the Order and Map may be bought there at a cost of 10p per A4 sheet.

Any representation about or objection to the Order may be sent or delivered in writing to the Head of Planning Economy and Housing, Malvern Hills District Council, Council House, Avenue Road, Malvern, WR14 3AF not later than 5th December 2014 stating the grounds on which it is made.

If no such representations or objections are duly made, or if any so made are withdrawn, Malvern Hills District Council may itself confirm the Order as an unopposed Order. If the Order is sent to the Secretary of State for the Environment, Food and Rural Affairs for confirmation any representations or objections which have not been withdrawn will be sent with the Order.

Dated this 30th day of October 2014

John Williams
Head of Policy and Governance

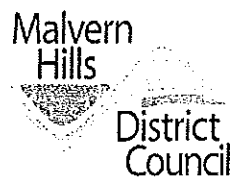

SCHEDULE

The full width of that part of footpath 566 (C)(Part) in the Parish of Upton-upon-Severn shown by a continuous bold line commencing at Point A (grid reference: SO 84038 39933) on the Order Map and continuing in a generally southerly direction for approximately 80 metres to Point D (grid reference: SO 84035 39851).

Public Path Stopping Up

Order 2014 - Footpath No 566(c)

District of Malvern Hills Parish of Upton-upon-Severn

— Footpath to be stopped up

--- Existing footpath

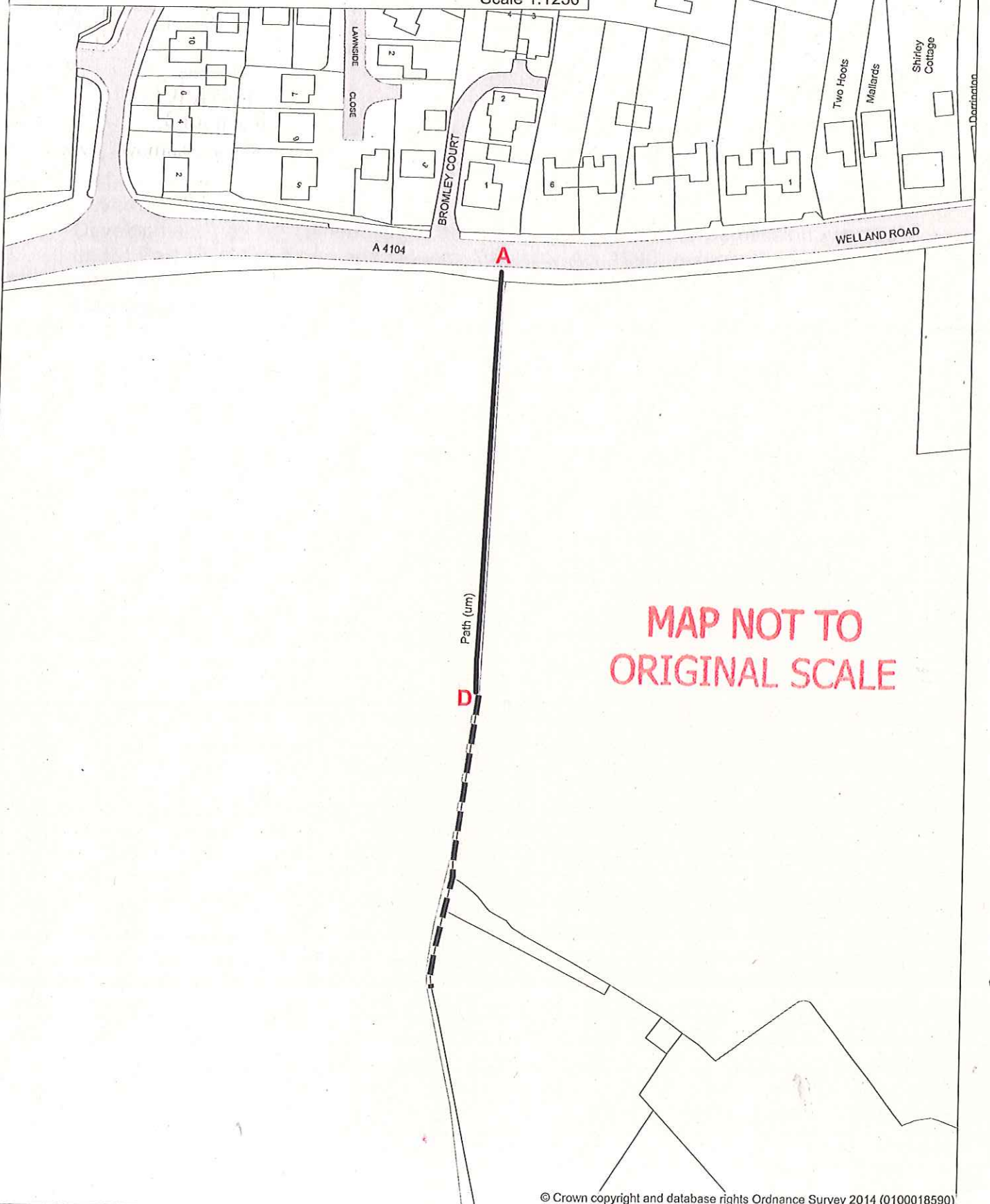
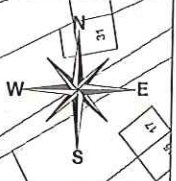

MAP NOT TO ORIGINAL SCALE