

Plan

Scale 1:10,000 @ A1

HSL01 ← → HSL06

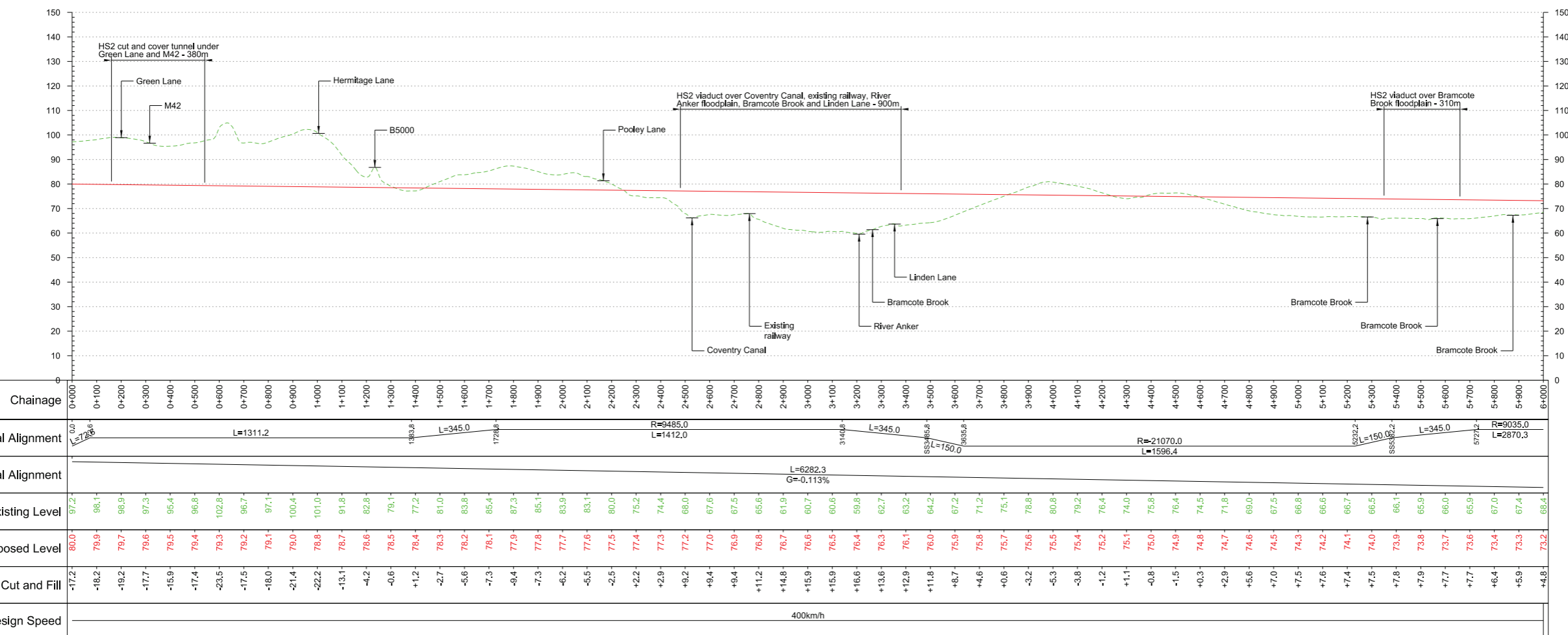

Profile

Scale H:1:10,000 V:1:1000 @ A1

Fit for Acceptance

Rev	Description	Drawn	Checked	Con App	HS2 App
P03	Client's Comments Addressed	JV	AR	MM	
P02	Client's Comments Addressed	JV	AR	MM	
P01	First Issue	CW	AR	MM	

HS2 accepts no responsibility for any circumstances which arise from the reproduction of this document after alteration, amendment or abbreviation or if it is issued in part or issued incompletely in any way.

© Crown Copyright and database right 2016. All rights reserved. Ordnance Survey Licence number 100049190

© Crown Copyright material is reproduced with the permission of Land Registry under delegated authority from the Controller of HMSO. This material was last updated on 2016 and may not be copied, distributed, sold or published without the formal permission of Land Registry. Only an official copy of a title plan or register obtained from the Land Registry may be used for legal or other official purposes.

Scale with caution as distortion can occur.

Legends/Notes

Key Environmental Features Legend	Legend
World Heritage Site	Track Centrelines
Ramsar	Viaduct
Special Areas of Conservation	Tunnel
Special Protection Areas	Existing Railway Connection
SSSI	HS2 Connection
National Nature Reserves	Fully Retained Cutting/Fill
Area of Outstanding Natural Beauty	Major Contour
National Park	Ground Profile
Major Development Sites	Track Profile
Additional Development Sites	Minor Contour
Scheduled Monuments	Node
Registered Parks and Gardens	
Historical Battlefields	
Active and/or Authorised Landfill	
Historical Landfill	
Flood Zones	
Listed Building Grade I	
Listed Building Grade II*	
Listed Building Grade II	

Engineering Earthworks

Railway Cutting
Railway Embankment
HS2 Depot/Station Operational Boundary

Registered in England
Registration No. 06791686
Registered office:
One Canada Square,
London, E14 5AB

Creator/Originator
Mott MacDonald

Zone	Leeds Leg South
Design Stage	Post-Consultation
Drawing Title	HSL06 Preferred Route
Sheet 1 of 5	

Project/Contract		West Midlands to Leeds Route	
Discipline/Function	Railway Track		
Drawn	Checked	Approved	
JV	AR	MM	
Date	Scale	Size	
05/07/2016	1:10000	A1	
Drawing No.	Rev.		
C321-MMD-RT-DPP-110-580601	P03		