

Plan
Scale 1:10,000 @ A1

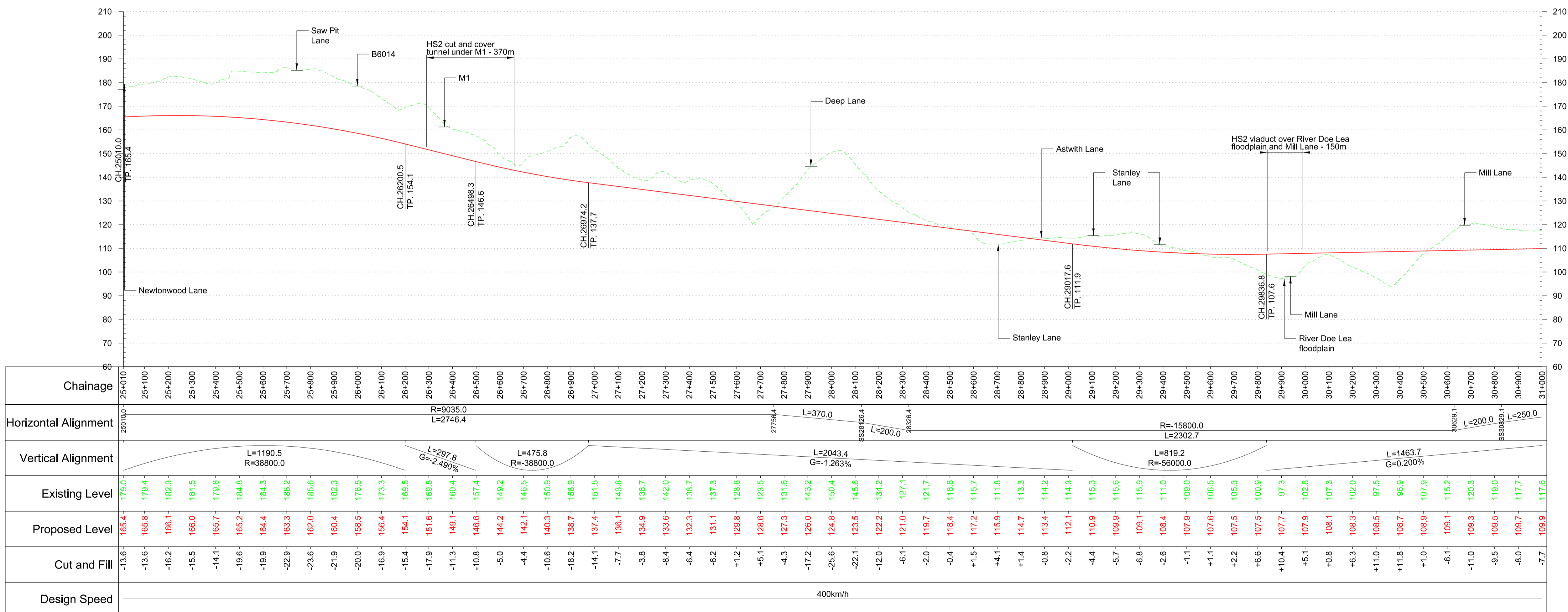

Profile
Scale H:1:10,000 V:1:1000 @ A1

Fit for Acceptance

| | | | | | | | | | | |
|-----|-------------|----------------|----------------|----------------|--|---|--|--|--|---|
| P01 | First Issue | JV 17/06/16 | AR 20/06/16 | MM 20/06/16 | <p>HS2 accepts no responsibility for any circumstances which arise from the reproduction of this document after alteration, amendment or abbreviation or if it is issued in part or issued incompletely in any way.</p> <p>© Crown Copyright and database right 2015. All rights reserved. Ordnance Survey Licence number 100049190</p> <p>© Crown Copyright material is reproduced with the permission of Land Registry under delegated authority from the Controller of HMSO.</p> <p>This material was last updated on 2015 and may not be copied, distributed, sold or published without the formal permission of Land Registry. Only an official copy of a title plan or register obtained from the Land Registry may be used for legal or other official purposes.</p> <p>Scale with caution as distortion can occur.</p> | <p>Key Environmental Features Legend</p> <ul style="list-style-type: none"> World Heritage Site Ramsar Special Areas of Conservation Special Protection Areas SSSI National Nature Reserves Area of Outstanding Natural Beauty National Park Major Development Sites Scheduled Monuments Registered Parks and Gardens Historical Battlefields Active and/or Authorised Landfill Historical Landfill Flood Zones Listed Building Grade I Listed Building Grade II* Listed Building Grade II | <p>Legend</p> <ul style="list-style-type: none"> Track Centrelines Viaduct Tunnel Fully Retained Cutting/Fill Major Contour Ground Profile Track Profile Minor Contour Node Engineering Earthworks Railway Cutting Railway Embankment HS2 Depot/Station Operational Boundary | <p>Registered in England Registration No. 06791666 Registered office: One Canada Square, London, E14 5AB</p> <p>Creator/Originator Mott MacDonald</p> | <p>Zone Leeds Leg Central</p> <p>Design Stage Pre-Consultation</p> <p>Drawing Title HSL13 M18 / Eastern Route</p> <p>Sheet 5 of 8</p> | <p>Project/Contract West Midlands to Leeds Route</p> <p>Discipline/Function Railway Track</p> <p>Drawn JV</p> <p>Checked AR</p> <p>Approved MM</p> <p>Date 17/06/2016</p> <p>Scale 1:10000</p> <p>Size A1</p> <p>Drawing No. C321-MMD-RT-DPP-120-581305</p> <p>Rev. P01</p> |
|-----|-------------|----------------|----------------|----------------|--|---|--|--|--|---|