

High Level Option (Preferred Route)

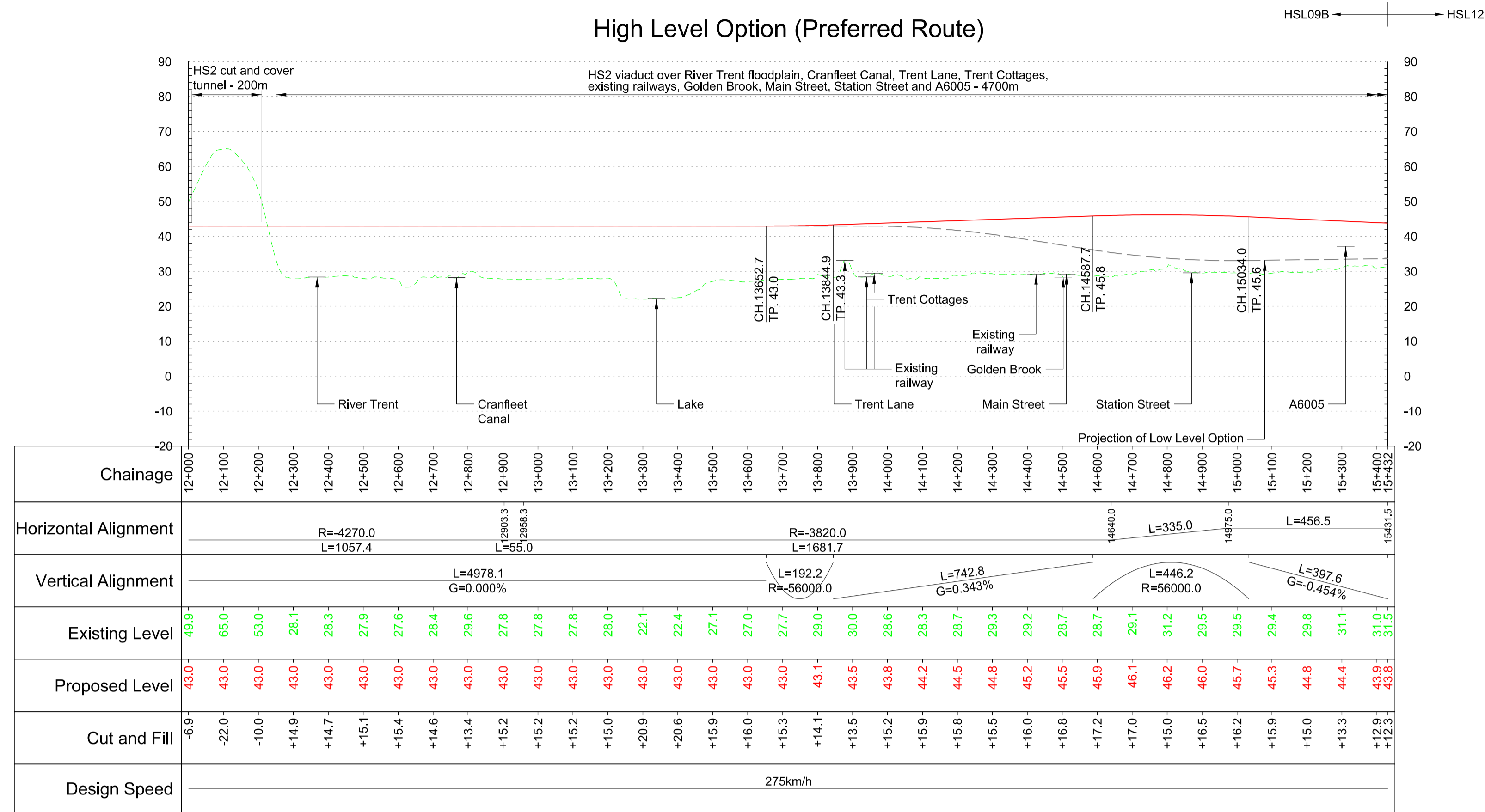

Low Level Option

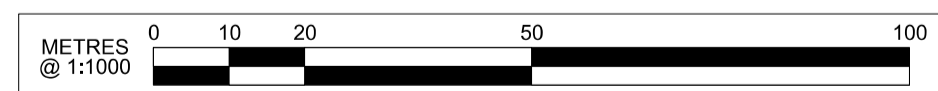
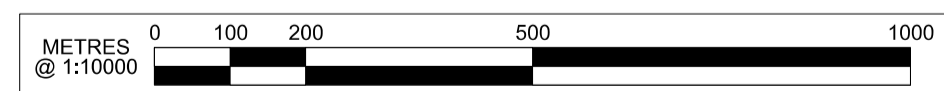
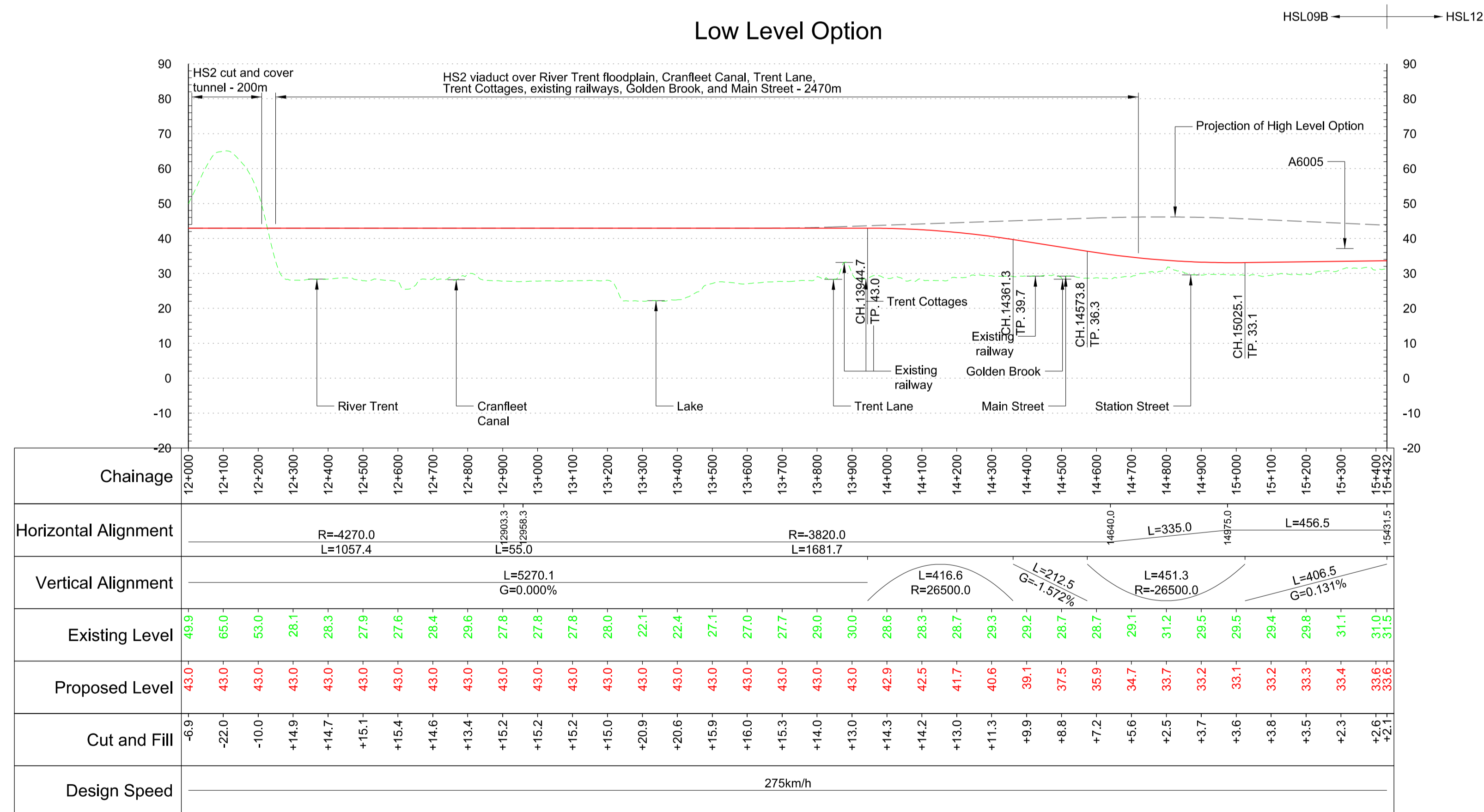

Profile
Scale H:1:10,000 V:1:1000 @ A1

Fit for Acceptance

P02	Client's Comments Addressed	JV	AR	MM	
		04/11/16	04/11/16	04/11/16	
P01	Client's Comments Addressed	JV	ARC	MM	
		14/10/16	14/10/16	14/10/16	
Rev	Description	Drawn	Checked	Con App	HS2 App

HS2 accepts no responsibility for any circumstances which arise from the reproduction of this document after alteration, amendment or abbreviation or if it is issued in part or issued incompletely in any way.

© Crown Copyright and database right 2016. All rights reserved. Ordnance Survey Licence number 100049190

© Crown Copyright material is reproduced with the permission of Land Registry under delegated authority from the Controller of HMSO. This material was last updated on 2016 and may not be copied, distributed, sold or published without the formal permission of Land Registry. Only an official copy of a title plan or register obtained from the Land Registry may be used for legal or other official purposes.

Scale with caution as distortion can occur.

Key Environmental Features Legend

- World Heritage Site
- Ramsar
- Special Areas of Conservation
- Special Protection Areas
- SSSI
- National Nature Reserves
- Area of Outstanding Natural Beauty
- National Park
- Major Development Sites
- Additional Development Sites
- Scheduled Monuments
- Registered Parks and Gardens
- Historical Battlefields
- Active and/or Authorised Landfill
- Historical Landfill
- Flood Zones
- Listed Building Grade I
- Listed Building Grade II*
- Listed Building Grade II

Legend

- Track Centrelines
- Viaduct
- Tunnel
- Existing Railway Connection
- HS2 Connection
- Fully Retained Cutting/Fill
- Major Contour
- Ground Profile
- Track Profile
- Minor Contour
- Node
- Engineering Earthworks
- Railway Cutting
- Railway Embankment
- HS2 Depot/Station Operational Boundary

Registered in England
Registration No. 06791686
Registered office:
One Canada Square,
London, E14 5AB

Creator/Originator
Mott MacDonald

Zone	Leeds Leg South	Project/Contract	West Midlands to Leeds Route		
Design Stage	Post-Consultation	Discipline/Function	Railway Track		
Drawing Title	HSL09B Long Eaton & Toton High & Low Level Options	Drawn	Checked	Approved	
		JV	AR	MM	
		Date	Scale	Size	
		05/10/2016	1:10000	A1	
		Drawing No.	Rev.		
		C321-MMD-RT-DEL-110-580903	P02		