

INDICATIVE LAKE BOUNDARY

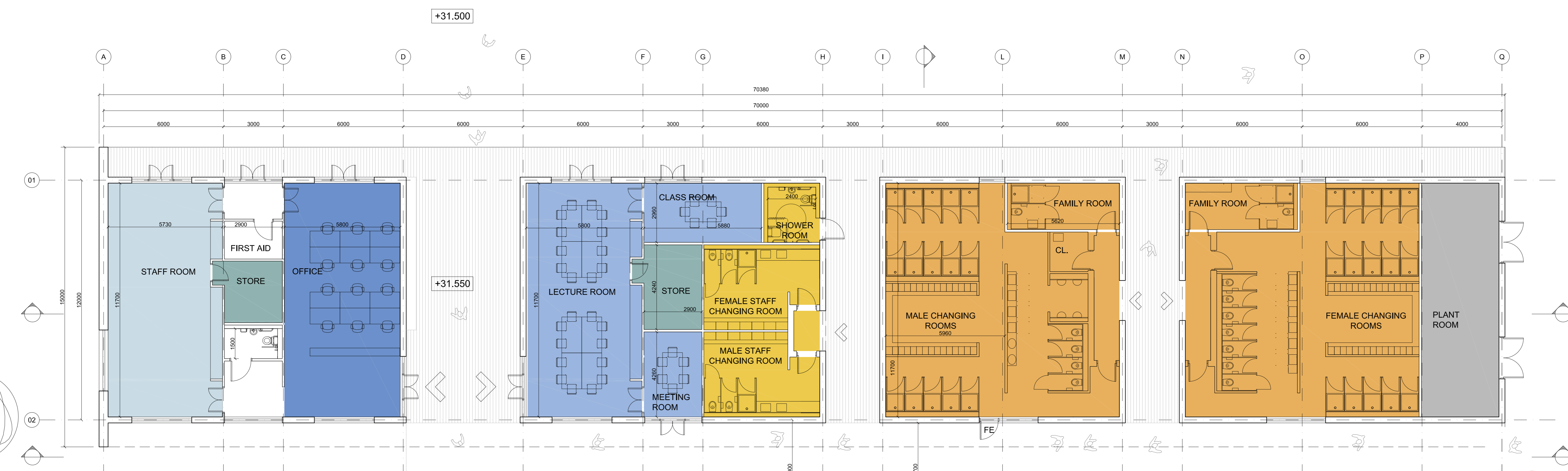

- Key:
- CLUB HOUSE
 - Office 68 sqm
 - Staff lounge area 68 sqm
 - Lecture room 68 sqm, Meeting rooms 30 sqm
 - Changing rooms users 270 sqm
 - Staff facilities
 - Internal Stores 26 sqm
 - Plantroom 45 sqm
 - GARAGE
 - Tractors' garage 178 sqm
 - WORKSHOP
 - Workshop 200 sqm

DRAFT - for engagement

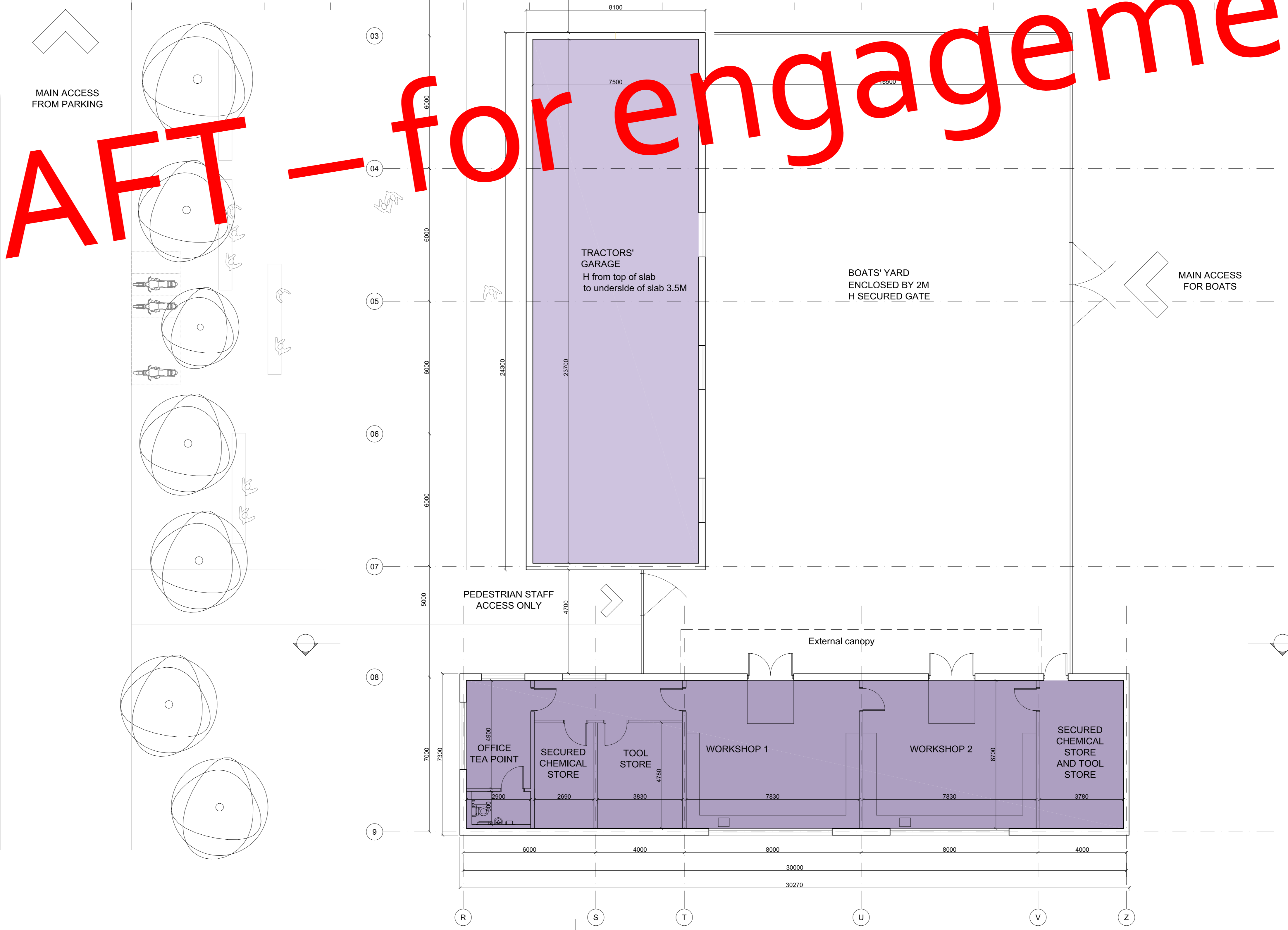

01 Ground Floor Plan
SCALE 1: 100

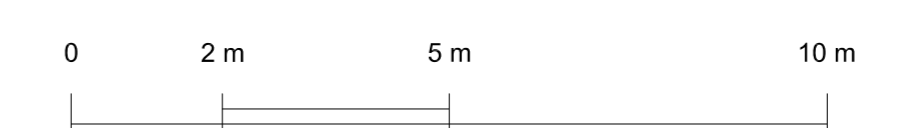

DRAFT

Drawing Status			
		Woodcote Grove Ashley Road Epsom Surrey KT18 5BW Tel: +44 (0)1372 726140 Fax: +44 (0)1372 740055 www.atkinsglobal.com	
Copyright © Atkins Limited (2015)		Client	
		Project Title HILLINGDON OUTDOOR ACTIVITIES CENTRE	
Drawing Title		CLUB HOUSE GENERAL ARRANGEMENT PROPOSED GROUND FLOOR PLAN	
Scale	1:100	Designed	MM
Drawn	EP	Checked	MM
Authorised	JSD	Original Date	10/02/2016
Drawn Date	10/02/2016	Checked Date	10/02/2016
Authorised Date	10/02/2016	Revision	
Drawing Number	HOAC-ATK-GF-DR-A-1010	Revision	P1