

HARBOUR LIMITS MAP

FOLKESTONE HARBOUR COMPANY LIMITED
 FOLKESTONE HARBOUR
 2015

PLANS, SECTIONS AND MAP REFERRED TO IN FOLKESTONE HARBOUR REVISION ORDER 2015

I HEREBY CERTIFY THAT THIS IS THE MAP REFERRED TO IN ARTICLE 2 OF THE FOLKESTONE HARBOUR REVISION ORDER 2015

DATE _____ SIGNED _____

CHIEF EXECUTIVE OFFICER OF THE MARINE MANAGEMENT ORGANISATION

© Buro Happold Limited or its group companies. All Rights reserved. Buro Happold and its group companies assert (unless otherwise agreed in writing) their rights under s.77 to 80 of the Copyright, Designs and Patents Act 1988. DO NOT SCALE THIS DRAWING.

- Notes
1. TOPOGRAPHIC SURVEY, REF. 5963-2d_National, DATED SEPTEMBER 2008
 2. WHERE APPROPRIATE THE ORDNANCE SURVEY HAS BEEN REPLACED BY THE SITE TOPOGRAPHICAL SURVEY
 3. THIS DRAWING HAS BEEN SET OUT TO NATIONAL GRID

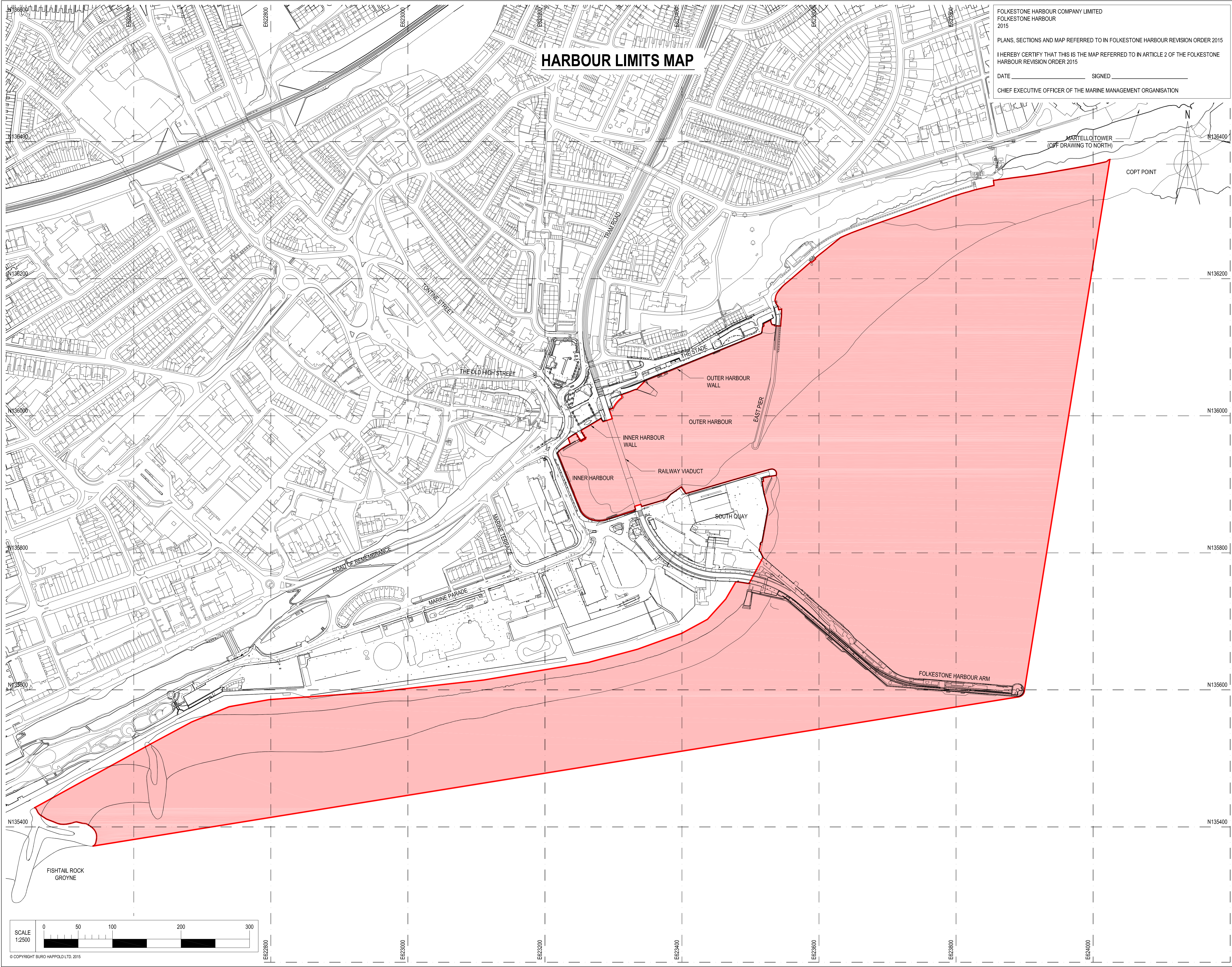
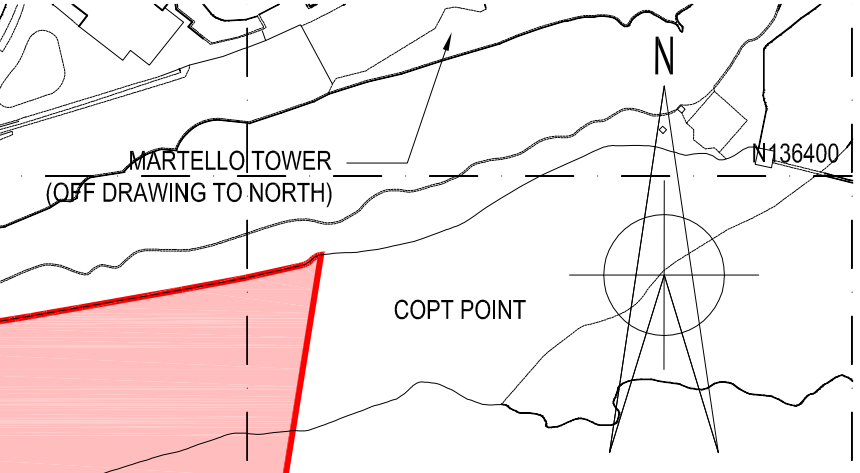

00 FOR HRO APPROVAL	19/08/15	SM	PNB
Rev	Description	Date	Drm

APPROVAL

Status of drawing

Comden Mill
 Lower Bristol Road
 Bath BA2 3DQ
 UK

Tel: +44 (0)1225 320600
 Fax: +44 (0)870 787 4148
 Email: 027011@burohappold.com
 Web: www.burohappold.com

Buro Happold
 Consulting Engineers

Architect
 Project FOLKESTONE HARBOUR REVISION ORDER 2015
 Dwg Title HARBOUR LIMITS MAP

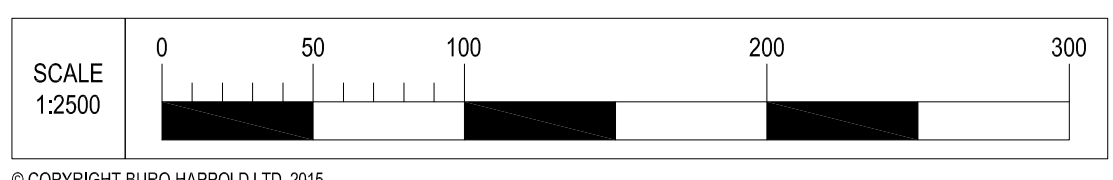

Scales@A1 1:2500	Job No. 027011
Drawn by SM	Drawing No. HRO5
Checked by PNB	Rev 00
Date AUGUST 2015	