

- Highway Land
- Common Land
- Existing footpath
- SADC Land
- Area of proposed strip widening footway (modified footway width 2.5m)
- Round topped concrete edgings with 50mm upstand above footpath level

Note - Footpath to be extended shaded red - is to be full depth construction.

Preliminary pavement design
 -20mm AC6 Surface Course
 -60mm AC20 binder course
 -150mm Type 1 granular sub-base
 Note materials and depth will match existing path construction which will be determined on site.
 Timber edging to path will be used where suitable

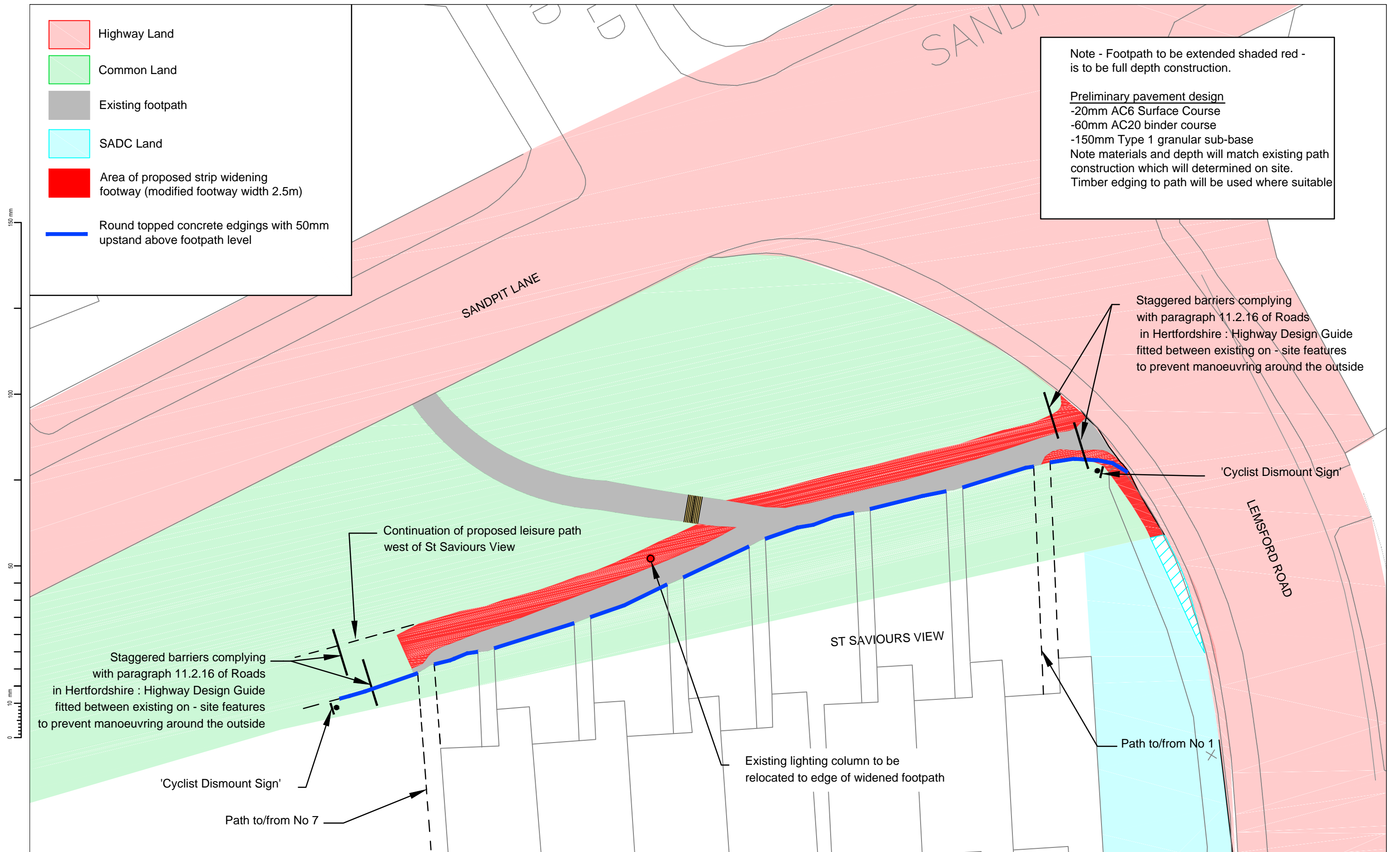

150 mm
100
50
10 mm
0

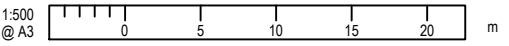

Revision	Amendment	Approved	Revision Date
R1	STAGGERED BARRIERS INTRODUCED	BH	19-03-15
R2	2nd STAGGERED BARRIER & RAISED EDGINGS ADDED	BH	21-04-15



COUNTY HALL
 Pegs Lane
 Hertford, Herts
 SG13 8DN
 Phone: 01992 555555

© Crown copyright and database right to 2014 Ordnance Survey 100019606

You are not permitted to copy, sub-licence, distribute or sell any of this data to third parties in any form.
 (This restriction may not apply to HCC and its licensed contractors, agents & partners.)

Drawn	Designed	Approved	Revision Date
DT	DT	BH	19-03-15

Project No: G-11308.81 Scale: 1:200

Project		Sheet	
ITP 13088 ST ALBANS GREEN RING - PHASE 2			
ST ALBANS, HERTFORDSHIRE LAND BOUNDARY PLAN SITE G			
Project No:	Scale:	Drawing No:	Sheet No:
G-11308.81	1:200	HC_G-11308.81(LBP)	011G
			Revision:
			R2