

NOTICE OF ORDER WILDLIFE AND COUNTRYSIDE ACT 1981 SECTION 53

Lincolnshire County Council
(Amendment of Lindsey County Council (Rural District of Louth) Definitive
Map and Statement – Evidential Events) (No. 2) Modification Order 1992
South Willingham - Addition of a Footpath from Moors Lane to Poplar Farm
&
Evidential Events (No. 1) Modification Order 2008
South Willingham and Hainton - Addition of a Footpath from Moors Lane to
A157, via North Walk Farm
&
Evidential Events (No. 4) Modification Order 1992
South Willingham - Addition of a Footpath between Hainton Road and High
Street, via South Walk Farm

Notice is hereby given that the above referenced Orders have been submitted to the Secretary of State for Environment, Food and Rural Affairs for determination. An Inspector will be appointed by the Secretary of State to determine the Orders.

The **start date** for the above Orders will be **30 November 2016**.

Consideration of the Orders will take the form of exchanges of statements of case and comments on statements of case.

The effect of the Orders, if confirmed without modifications, will be to modify the Definitive Map and Statement for the area by : -

1) FPS/Q2500/7/86

- adding thereto a public footpath in the Parish of South Willingham, approximately 2 metres wide running from OS Grid ref TF 1967 8409, running in a generally south easterly direction across OS Field No 7500 for a distance of approximately 382 metres to the north western boundary of OS Field No 0070, then running across OS Field No 00700 for a distance of approximately 238 metres, then running along the western boundary of OS Field No 1561 for a distance of approximately 166 metres to meet the public highway at OS Grid ref TF 2014 8353. The total length of the path to be approximately 786 metres.

2) FPS/Q2500/7/87

- adding to them Footpath Number 992 in the Parish of Hainton. The path leaves the A157 Louth Road near "Horse Pasture Farm" at Ordnance Survey Grid Reference TF 2000 8566 (point A on the Order Drawing A4/1423110) and follows a track in a generally south easterly direction for approximately 238 metres. At TF 2019 8551 (point B) it enters "North Walk Farm" yard, meeting the parish boundary with South Willingham. The total length of the path is approximately 238 metres and has a width of 4 metres. The path is shown to run between points A-B on the Order Drawing number A4/1423/10

- Footpath Number 992 in the Parish of South Willingham. The path leaves the parish boundary with Hainton from "North Walk Farm" yard at Ordnance Survey Grid Reference TF 2019 8551 (point B on the Order Drawing A4/1423/10) in a south westerly direction and follows a track bordering the parish boundary for approximately 711 metres to TF 1975 8496 (point C). Here it turns to follow a south easterly direction for approximately 488 metres to TF 2012 8464 (point D). It then turns in a south westerly direction for approximately 246 metres to TF 1997 8446 (point E). The total length of the path is approximately 1445 metres and has a width of 3 metres. The path is shown to run between points B-C-D-E on the Order Drawing number A4/1423/10

3) FPS/Q2500/7/88

- adding a public footpath approximately 12 metres wide in the Parish of South Willingham running from the public highway at OS Grid Ref TF 1925 8367 in a generally north easterly direction through OS Field No 4085 for a distance of approximately 1083 metres to OS Grid Ref TF 19965 84465 running in a generally south easterly direction through OS Field No 0538, then approximately 2 metres wide, running in a generally north easterly direction along the existing track through OS Field No's 3129 and 6244. Then approximately 9 metres wide running along the existing lane through OS Field No 8767 in a north easterly direction then to be 2 metres wide running in a generally south easterly direction through OS Field No 0269 and along the existing track running along the northern boundary of OS Field No 1770 for a distance of 1490 metres to meet the public highway at OS Grid Ref TF 21260 84795. The total length of path to be approximately 2, 573 metres.

Any queries relating to these Orders should be referred to Clive Richards at The Planning Inspectorate, Rights of Way Section, Room 3/G Hawk Wing, Temple Quay House, 2 The Square, Temple Quay, Bristol, BS1 6PN. Telephone: 0303 444 5502. Email: clive.richards@pins.gsi.gov.uk. Please quote reference number FPS/Q2500/7/86, 7/87 & 7/88 on all correspondence.

Any person wishing to view the statements of case and other documents relating to these Orders may do so by appointment at the Definitive Map Office, Unit 7, Witham Park House, Waterside South, Lincoln, LN5 7JN between 9am-5pm weekdays. Council contact: Alison Bean, tel: 01522 782070, ext 55185.

Timetable for sending in statements of case and comments

Within 2 weeks of the start date [by 14 December 2016]

The Order Making Authority must ensure their statement of case is received by the Secretary of State. As soon as possible after the deadline, the Secretary of State will send a copy (excluding copies of any supporting documents - these will be available to view at the Authority's offices) to everyone who has made an objection or representation, the applicant and any other person who has written to us in respect of the Orders.

Within 8 weeks of the start date [by 25 January 2017]

Everyone who has made an objection or representation or any other written representation must ensure their statement of case is received by the Secretary of State. As soon as possible after the deadline, the Secretary of State will send full copies to the Authority. Copies (excluding copies of any supporting documents - these will be available to view at the Authority's offices) will also be sent to the applicant, every person who has made an objection or representation and any other person who has written to us in respect of the Orders.

Within the same period the applicant (if applicable) must ensure their statement of case is received by the Secretary of State. As soon as possible after the deadline, Secretary of State will send a full copy to the Authority. Copies will also be sent to everyone who has made an objection or representation and any other person who has written to us in respect of the Orders (excluding copies of any supporting documents - these will be available to view at the Authority's offices).

Within 14 weeks of the start date [by 08 March 2017]

Everyone who has made an objection or representation, the Authority, the applicant (if applicable) and anyone who has written to us in respect of the Orders must ensure that their comments on any or every other statement of case is received by the Secretary of State. As soon as possible after the deadline, the Secretary of State will send copies of these comments to everyone else.

Any other person wishing to make representations in writing to the Secretary of State in respect of the above Orders must do so in line with the timetable set out above.

In fairness to the other parties everyone should keep to the timetable to ensure that statements of case and comments are received on time. Late documents will be returned.

We cannot accept any libellous, racist or abusive comments. Any documents containing such comments will be returned.

Notice of order for w/r

WILDLIFE AND COUNTRYSIDE ACT 1981

LINDSEY COUNTY COUNCIL (RURAL DISTRICT OF LOUTH)

DEFINITIVE MAP AND STATEMENT

LINCOLNSHIRE COUNTY COUNCIL (AMENDMENT OF LINDSEY COUNTY COUNCIL
(RURAL DISTRICT OF LOUTH) DEFINITIVE MAP AND STATEMENT -
EVIDENTIAL EVENTS) (NO. 4) MODIFICATION ORDER 1992

WHEREAS pursuant to Section 53(2)(b) of the Wildlife and Countryside Act 1981 (hereinafter called "the Act") it appears to Lincolnshire County Council (hereinafter called "the surveying authority") that the Definitive Map and Statement for the area of the former Lindsey County Council (Rural District of Louth) require modification in consequence of an event specified in Section 53(3)(c)(i) of the Act namely the discovery by the surveying authority of evidence which when considered with all other relevant evidence shows that there is a public footpath over land shown in the Map and Statement

AND WHEREAS the surveying authority have consulted with every local authority whose area includes the land to which the Order relates

NOW THEREFORE the surveying authority in exercise of the powers conferred on them by Section 53(2)(b) hereby make the following Order:-

1. For the purpose of this Order the relevant date shall be 19 June 1992
2. The Lindsey County Council Definitive Map and Statement for the area of the former Rural District of Louth shall be modified as described in Part I and Part II of the Schedule and shown on

7435.nnl

the annexed map

3. This Order shall have effect on the date it is confirmed

4. This Order may be cited as the Lincolnshire County Council (Amendment of Lindsey County Council (Rural District of Louth) Definitive Map and Statement - Evidential Events (No. 4) Modification Order 1992

SCHEDULE

PART I

Modification of Definitive Map

Description of Path to be added

In the Parish of South Willingham

A public footpath approximately 12 metres wide running from the public highway at OS Grid Reference TF 1925 8367 in a generally north easterly direction through OS Field No 4085 for a distance of approximately 1083 metres to OS Grid Reference TF 19965 84465 running in a generally south easterly direction through OS Field No 0538, then approximately 2 metres wide, running in a generally north easterly direction along the existing track through OS Field No's 3129 and 6244, then approximately 9 metres wide, running along the existing lane through OS Field No 8767 in a north easterly direction then to be 2 metres wide running in a generally south easterly direction through OS field No 0269 and along the existing track running along the Northern boundary of OS Field No 1770 for a distance of 1490 metres to meet the public highway at OS Grid Reference TF 21260 84795. The total length of the path to be approximately 2,573 metres as shown on annexed plan No A10/1423/9 (Sheets 1 and 2)

7435.nml

PART II

Modification of Definitive Statement

Variation of Particulars of Paths

The following details shall be added:-

In the Parish of South Willingham

A public footpath running from Hainton Road to High Street via South Walk Farm. The total length of the path to be 1490 metres.

The width of the path to be approximately 2 metres wide.

GIVEN under the Common Seal of Lincolnshire County Council this

Nineteenth day of *June* One thousand nine hundred and ninety-two

THE COMMON SEAL of)
LINCOLNSHIRE COUNTY COUNCIL)
was hereunto affixed in the)
presence of:-)

P. J. B...
Authorised Officer

No. In Seal
Book *60434*

DATED

19 June

1992

WILDLIFE AND COUNTRYSIDE ACT 1981
LINDSEY COUNTY COUNCIL (RURAL
DISTRICT OF LOUTH)
DEFINITIVE MAP AND STATEMENT

LINCOLNSHIRE COUNTY COUNCIL
(AMENDMENT OF LINDSEY COUNTY
COUNCIL (RURAL DISTRICT OF LOUTH)
DEFINITIVE MAP AND STATEMENT
EVIDENTIAL EVENTS) (NO. 4)
MODIFICATION ORDER 1992

P J BURNS
Chief Solicitor
County Offices
Lincoln

7/88

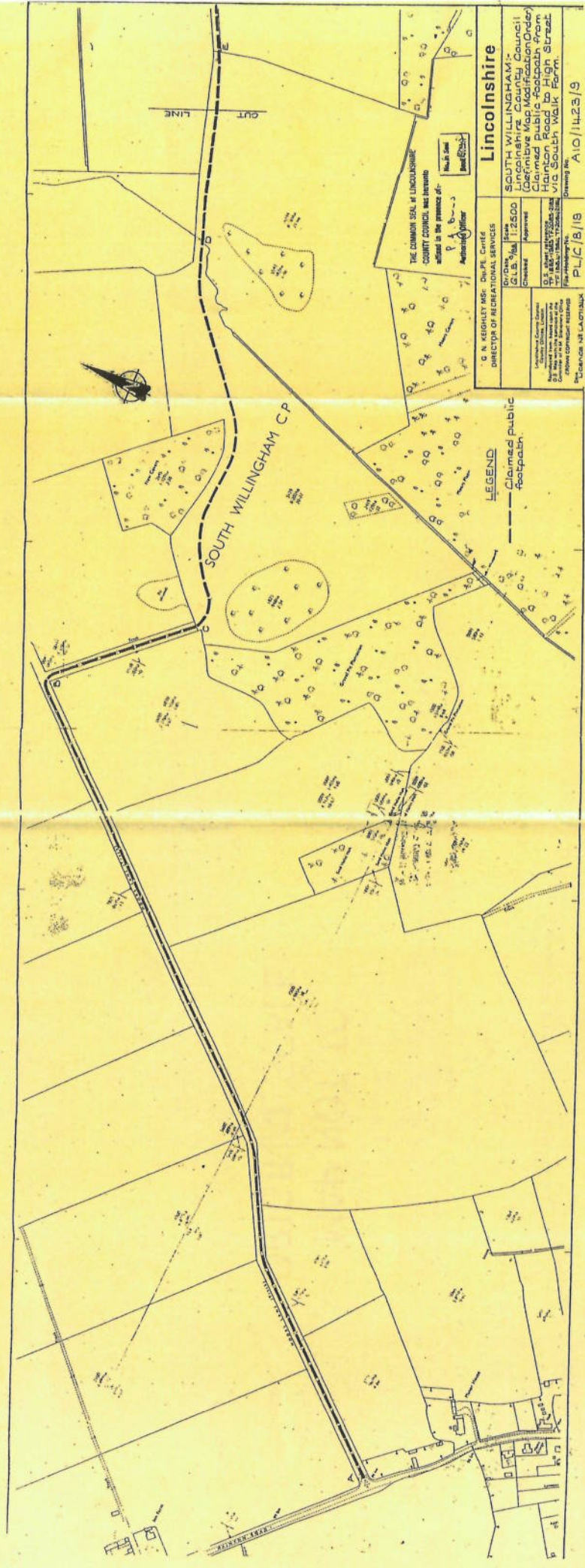

MAP NOT TO ORIGINAL SCALE

PLAN NOT TO SCALE

2700
4127/6
10-20
2700
2800
1:1

No. in Seal
Booth

Authorised Officer

THE COMMON SEAL OF LINCOLNSHIRE
COUNTY COUNCIL was hereunto
affixed in the presence of:



D.R.L.P.

LINE CUT

**MAP NOT TO
ORIGINAL SCALE**

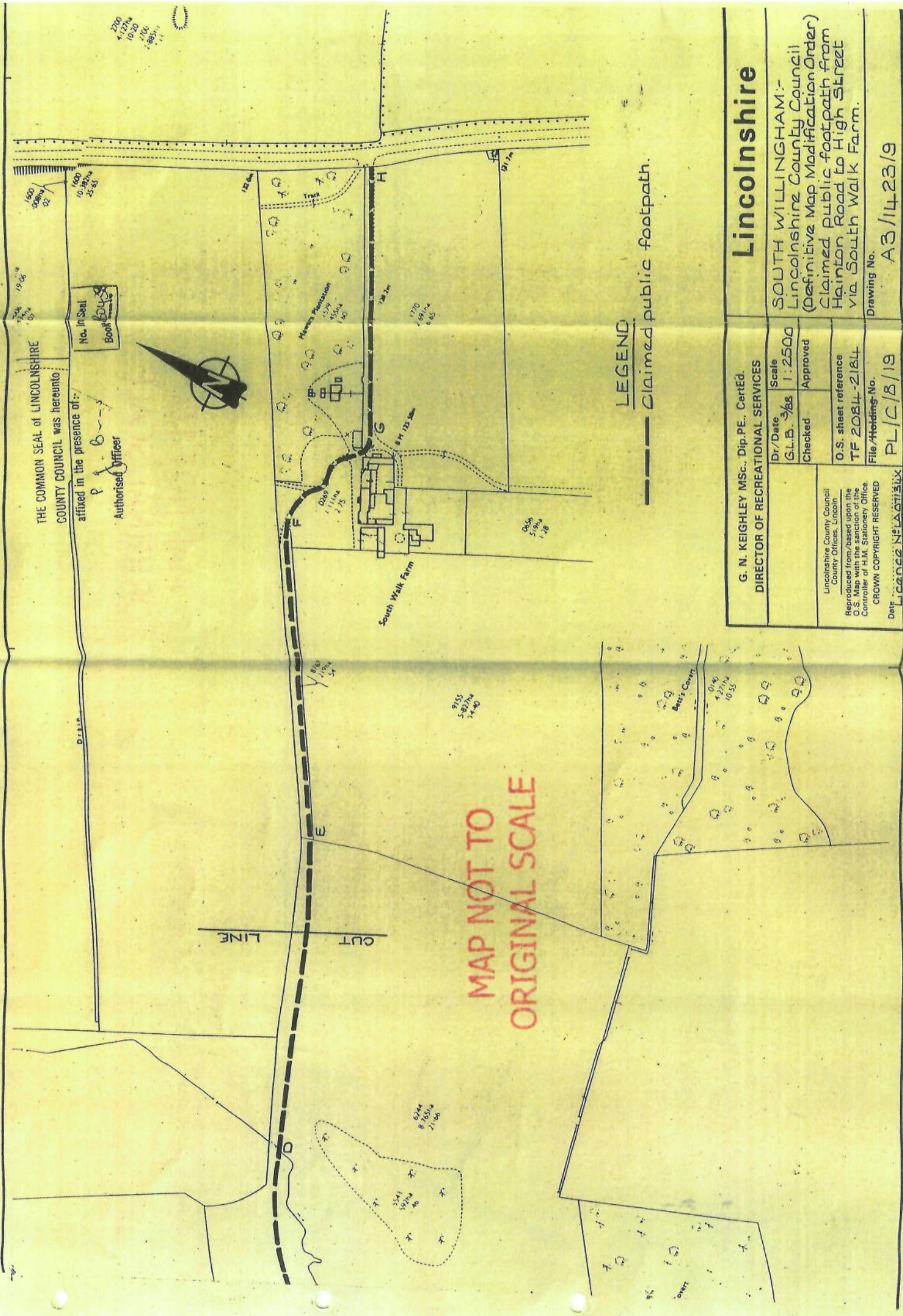

LEGEND
--- Claimed public footpath.

<p>Lincolnshire</p> <p>SOUTH WILLINGHAM:- Lincolnshire County Council (Definitive Map Modification Order) Claimed public footpath from Hainton Road to High Street via South Walk Farm.</p>		<p>G. N. KEIGHLEY MSc., Dip. PE., CertEd. DIRECTOR OF RECREATIONAL SERVICES</p>	
<p>Checked</p>	<p>Dr/Date G.L.B. 3/88</p>	<p>Scale 1:2500</p>	<p>Approved</p>
<p>Lincolnshire County Council County Offices, Lincoln</p> <p>Reproduced from/based upon the O.S. Map with the sanction of the Controller of H.M. Stationery Office</p> <p>CROWN COPYRIGHT RESERVED</p>		<p>O.S. sheet reference TF 2084-2184</p> <p>File/Holding No. PL/C/B/19</p>	
<p>Date 19/11/88</p>		<p>Drawing No. A3/1423/9</p>	

WILDLIFE AND COUNTRYSIDE ACT 1981
IN THE PARISHES OF SOUTH WILLINGHAM AND HANTON,
LINDSEY COUNTY COUNCIL
(RURAL DISTRICT OF LOUTH) DEFINITIVE MAP AND STATEMENT
LINCOLNSHIRE COUNTY COUNCIL (AMENDMENT OF
LINDSEY COUNTY COUNCIL (RURAL DISTRICT OF LOUTH)
DEFINITIVE MAP AND STATEMENT - EVIDENTIAL EVENTS) (NO.1)
MODIFICATION ORDER 2008

This Order is made by Lincolnshire County Council under Section 53(2)(b) of the Wildlife and Countryside Act 1981 ("the Act") because it appears to the Authority that the Definitive Map and Statement for the area of the Lindsey County Council (Rural District of Louth) require modification in consequence of the occurrence of an event specified in Section 53(3)(c)(i) of the Act namely the discovery by the Authority of evidence which when considered with all other relevant evidence available to them shows that a right of way which is not shown in the map and statement subsists or is reasonably alleged to subsist over land in the area to which the map relates, being a right of way such that the land over which the right subsists is a public path, a restricted byway or, subject to Section 54A, a byway open to all traffic.

The surveying authority has consulted with every local authority whose area includes the land to which the Order relates

Lincolnshire County Council hereby orders that:-

1. For the purpose of this Order the relevant date is 12 December 2008
2. The Lindsey County Council Definitive Map and Statement for the area of the Rural District of Louth shall be modified as described in Part I and Part II of the Schedules and shown on the drawing attached to the Order
3. This Order shall take effect on the date it is confirmed and may be cited as the Lincolnshire County Council (Amendment of Lindsey County Council (Rural District of Louth) Definitive Map and Statement - Evidential Events (No. 1) Modification Order 2008

SCHEDULE 1

PART I

Modification of Definitive Map

Description of Footpath to be added
In the Parish of Hainton
Footpath Number 992

The path leaves the A157 Louth Road near "Horse Pasture Farm" at Ordnance Survey Grid Reference TF 2000 8566 (point A on the Order Drawing A4/1423/10) and follows a track in a generally south easterly direction for approximately 238 metres. At TF 2019 8551 (point B) it enters "North Walk Farm" yard, meeting the parish boundary with South Willingham.

The total length of the path is approximately 238 metres and is shown to run between points A-B on the attached Order Drawing number A4/1423/10

PART II

Modification of Definitive Statement

Variation of Particulars of Path or Way

Description of Footpath to be added

In the Parish of Hainton

Footpath Number 992

The path leaves the A157 Louth Road near "Horse Pasture Farm" at Ordnance Survey Grid Reference TF 2000 8566 and follows a track in a generally south easterly direction for approximately 238 metres. At TF 2019 8551 it enters "North Walk Farm" yard, meeting the parish boundary with South Willingham.

The total length of the path is approximately 238 metres. The width of the path is 4 metres.

SCHEDULE 2

PART I

Modification of Definitive Map

Description of Footpath to be added

In the Parish of South Willingham

Footpath Number 992

The path leaves the parish boundary with Hainton from "North Walk Farm" yard at Ordnance Survey Grid Reference TF 2019 8551 (point B on the Order Drawing A4/1423/10) in a south westerly direction and follows a track bordering the parish boundary for approximately 711 metres to TF 1975 8496 (point C). Here it turns to follow a south easterly direction for approximately 488 metres to TF 2012 8464 (point D). It then turns in a south westerly direction for approximately 246 metres to TF 1997 8446 (point E).

The total length of the path is approximately 1445 metres and is shown to run between points B-C-D-E on the attached Drawing number A4/1423/10

PART II

Modification of Definitive Statement

Variation of Particulars of Path or Way
Description of Footpath to be added
In the Parish of South Willingham
Footpath Number 992

The path leaves the parish boundary with Hainton from "North Walk Farm" yard at Ordnance Survey Grid Reference TF 2019 8551 in a south westerly direction and follows a track bordering the parish boundary for approximately 711 metres to TF 1975 8496. Here it turns to follow a south easterly direction for approximately 488 metres to TF 2012 8464. It then turns in a south westerly direction for approximately 246 metres to TF 1997 8446.

The total length of the path is approximately 1445 metres. The width of the path is 3 metres.

GIVEN under the common Seal of Lincolnshire County Council this ^{12th} day of December Two thousand and eight

THE COMMON SEAL of)

LINCOLNSHIRE COUNTY COUNCIL)

was hereunto affixed in the)

presence of:-)

RA [Signature]

Authorised Officer

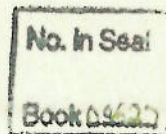

DATED 12 December 2008

WILDLIFE AND COUNTRYSIDE ACT 1981
IN THE PARISHES OF SOUTH WILLINGHAM AND HANTON,
LINDSEY COUNTY COUNCIL (RURAL DISTRICT
OF LOUTH) DEFINITIVE MAP AND STATEMENT
LINCOLNSHIRE COUNTY COUNCIL (AMENDMENT OF
LINDSEY COUNTY COUNCIL (RURAL DISTRICT OF LOUTH)
DEFINITIVE MAP AND STATEMENT - EVIDENTIAL EVENTS) (NO.1)
MODIFICATION ORDER 2008

HEAD OF LEGAL SERVICES

Lincolnshire County Council

County Offices

Newland

Lincoln

7/87

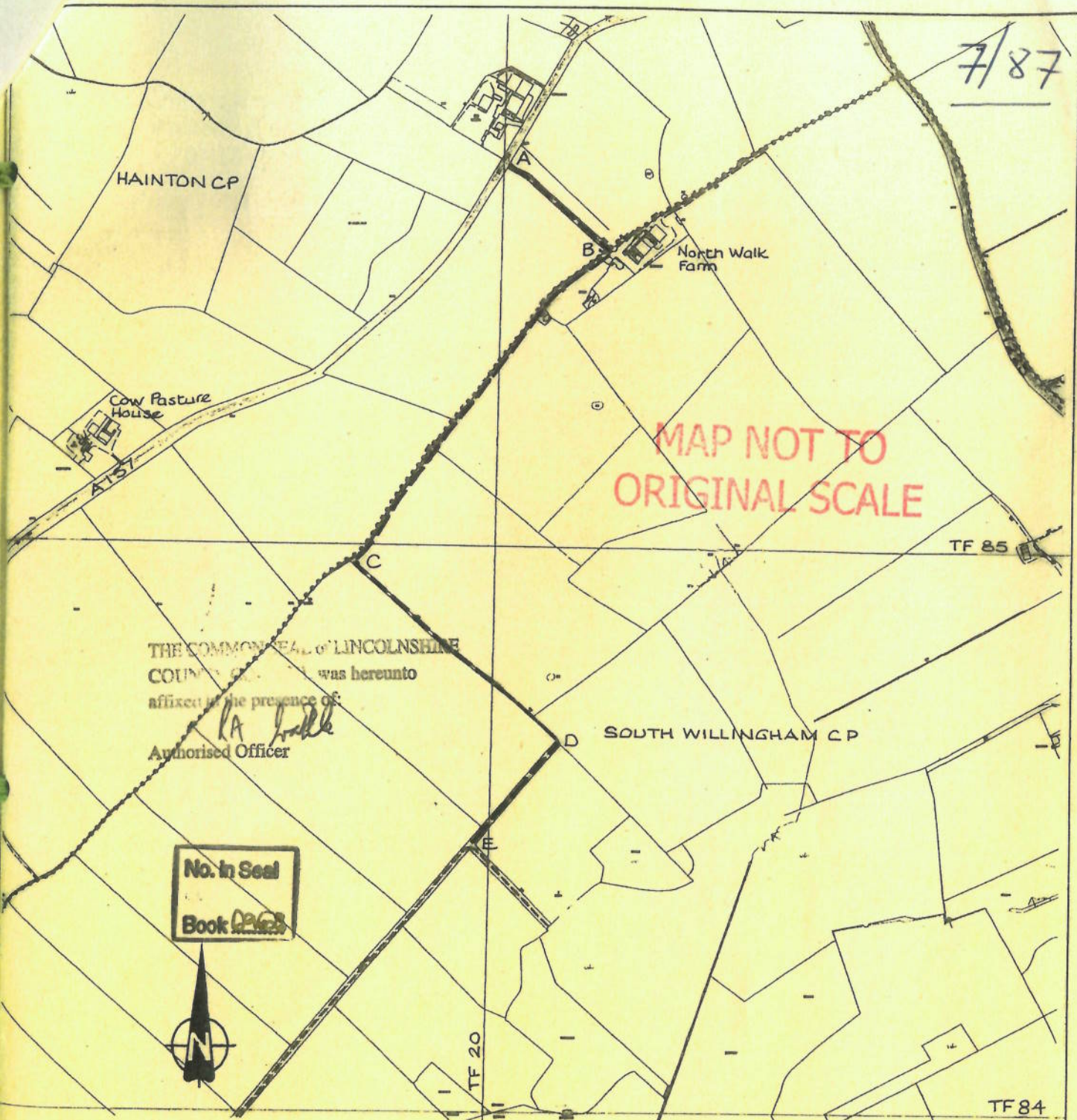

THE COMMON SEAL OF LINCOLNSHIRE
 COUNTY COUNCIL was hereunto
 affixed in the presence of
LA [unclear]
 Authorised Officer

No. in Seal
 Book *2263*



LEGEND

--- Claimed public footpath

Widths of Path

A-C = 3.3m
 C-D = 4.6m
 D-E = 9.4m

RA WILLS
 DIRECTOR FOR DEVELOPMENT

LINCOLNSHIRE COUNTY COUNCIL

Dr/Date GLB 7/07	Scale 1:10000
Checked	Approved
O.S. sheet reference	
File/Holding No. PL/C/8/19	

SOUTH WILLINGHAM/HAINTON :-
 (Definitive Map Modification Order) -
 addition of claimed public footpath from
 Moors Lane to A157 via North Walk
 Farm

Drawing No.
A4/1423/10

Lincolnshire County Council
 County Offices, Lincoln
 Reproduced from/based upon the
 O.S. Map with the sanction of the
 Controller of H.M. Stationery Office.
 CROWN COPYRIGHT RESERVED
 Date **24 NOV 2008**
 Licence No 100025370

WILDLIFE AND COUNTRYSIDE ACT 1981

LINDSEY COUNTY COUNCIL (RURAL DISTRICT OF LOUTH)

DEFINITIVE MAP AND STATEMENT

LINCOLNSHIRE COUNTY COUNCIL (AMENDMENT OF LINDSEY COUNTY COUNCIL
(RURAL DISTRICT OF LOUTH) DEFINITIVE MAP AND STATEMENT -
EVIDENTIAL EVENTS) (NO. 2) MODIFICATION ORDER 1992

WHEREAS pursuant to Section 53(2)(b) of the Wildlife and
Countryside Act 1981 (hereinafter called "the Act") it appears
to Lincolnshire County Council (hereinafter called "the surveying
authority") that the Definitive Map and Statement for the area
of the former Lindsey County Council (Rural District of Louth)
require modification in consequence of an event specified in
Section 53(3)(c)(i) of the Act namely the discovery by the
surveying authority of evidence which when considered with all
other relevant evidence shows that there is a public footpath
over land shown in the Map and Statement

AND WHEREAS the surveying authority have consulted with every
local authority whose area includes the land to which the Order
relates

NOW THEREFORE the surveying authority in exercise of the powers
conferred on them by Section 53(2)(b) hereby make the following
Order:-

1. For the purpose of this Order the relevant date shall be
19 June 1992
2. The Lindsey County Council Definitive Map and Statement for
the area of the former Rural District of Louth shall be modified
as described in Part I and Part II of the Schedule and shown on

7426.nn1

the annexed map

3. This Order shall have effect on the date it is confirmed

4. This Order may be cited as the Lincolnshire County Council
(Amendment of Lindsey County Council (Rural District of Louth)
Definitive Map and Statement - Evidential Events (No. 2)
Modification Order 1992

SCHEDULE

PART I

Modification of Definitive Map

Description of Path to be added

In the Parish of South Willingham

A public footpath approximately 2 metres wide running from OS
Grid reference TF 1967 8409, in a generally south easterly
direction across OS Field No 7500 for a distance of approximately
382 metres to the north western boundary of OS Field No 0070,
then running across OS Field No 0070 for a distance of
approximately 238 metres, then running along the western boundary
of OS Field No 1561 for a distance of approximately 166 metres
to meet the public highway at OS grid reference TF 2014 8353.
The total length of the path to be approximately 786 metres as
shown on the annexed plan No. A3/1423/7 between points A-B-C-D-E

PART II

Modification of Definitive Statement

Variation of Particulars of Paths

The following details shall be added:-

In the Parish of South Willingham

A public footpath running from Moors Lane to Poplar Farm. The

7426.nnl

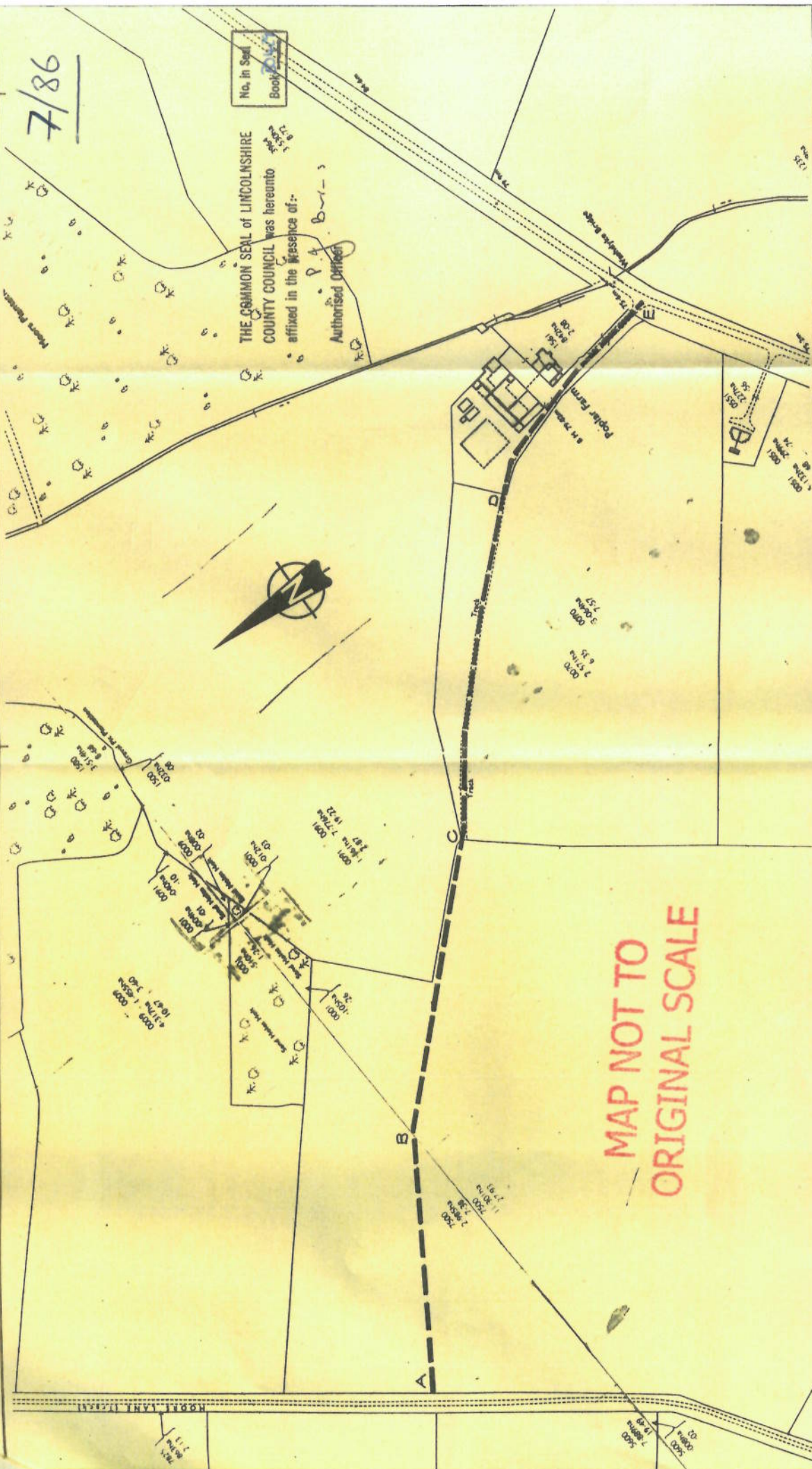

MAP NOT TO ORIGINAL SCALE

LEGEND
 --- CLAIMED public footpath.

Lincolnshire SOUTH WILLINGHAM:- Lincolnshire County Council (Definitive Map Modification Order) Claimed public footpath from Moors Lane to Poplar Farm.	
G. N. KEIGHLEY MSc., Dip. PE., CertEd. DIRECTOR OF RECREATIONAL SERVICES	
Dt./Date G.L.B. 9/88	Scale 1:2500
Checked	Approved
O.S. sheet reference TF 1885, 1985 TF 2055, 2155	
File/Holding-No. PLIC/8/19	
Date Licence No. 07111X	