

Plan  
Scale 1:10,000 @ A1

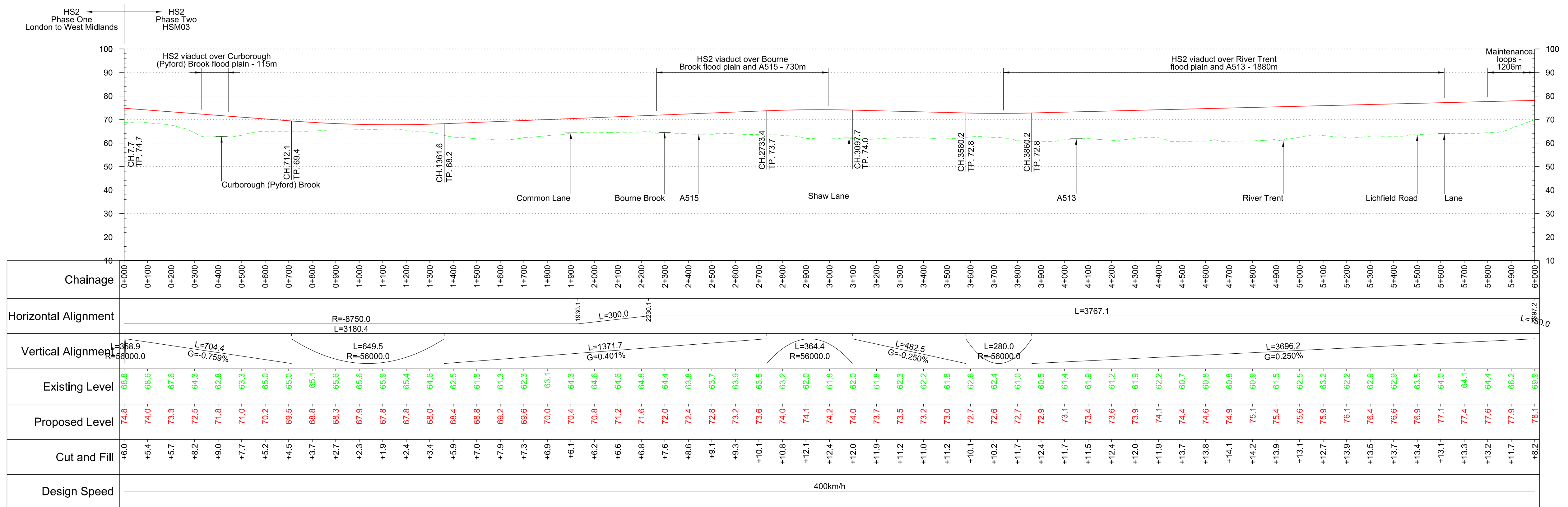

Profile  
Scale H:1:10,000 V:1:1000 @ A1

**Fit for Acceptance**

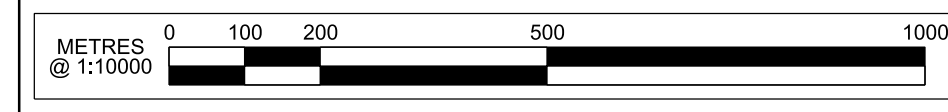

Rev	Description	Drawn	Checked	Con App	HS2 App
P03	Updated for Publication	KB 31/07/15	DC 31/07/15	JG 31/07/15	
P02	Minor Note Amendments	KB 09/06/15	DC 09/06/15	JG 09/06/15	
P01	First Issue	KB 17/04/15	DC 17/04/15	JG 17/04/15	

HS2 accepts no responsibility for any circumstances which arise from the reproduction of this document after alteration, amendment or abbreviation or if it is issued in part or issued incompletely in any way.

© Crown Copyright and database right 2015. All rights reserved. Ordnance Survey Licence number 100049190

© Crown Copyright material is reproduced with the permission of Land Registry under delegated authority from the Controller of HMSO. This material was last updated on 2015 and may not be copied, distributed, sold or published without the formal permission of Land Registry. Only an official copy of a title plan or register obtained from the Land Registry may be used for legal or other official purposes.

Scale with caution as distortion can occur.

**Key Environmental Features Legend**

- World Heritage Site
- Ramsar
- Special Areas of Conservation
- Special Protection Areas
- SSSI
- National Nature Reserves
- Area of Outstanding Natural Beauty
- National Park
- Scheduled Monuments
- Registered Parks and Gardens
- Historical Battlements
- Active and/or Authorised Landfill
- Historical Landfill
- Flood Zones
- Listed Building Grade I
- Listed Building Grade II\*
- Listed Building Grade II

**Legend**

- Track Centrelines
- Viaduct
- Tunnel
- Fully Retained Cutting/Fill
- Major Contour
- Ground Profile
- Track Profile
- Minor Contour
- Node
- Engineering Earthworks
- Railway Cutting
- Railway Embankment
- HS2 Depot/Station Operational Boundary

Registered in England  
Registration No. 06791686  
Registered office:  
One Canada Square,  
London, E14 5AB

Creator/Oriinator  
**AECOM**

Zone  
**Manchester Leg South of Crewe**

Design Stage  
**Post-Consultation**

Drawing Title  
**West Midlands to Crewe  
Preferred Route - HSM03**

Project/Contract  
**West Midlands to Manchester Route**

Discipline/Function  
**Railway Track**

Drawn  
KB

Checked  
DC

Approved  
JG

Date  
17/04/2015

Scale  
AS SHOWN

Size  
A1

Drawing No.  
C320-AEC-RT-DPP-210-061031

Rev.  
P03

Sheet 1 of 7