



Environment
Agency

Permit with introductory note

The Environmental Permitting (England & Wales) Regulations 2010

ANSA Environmental Services Limited

Cledford Lane Environmental Hub

Cledford Lane

Middlewich

Cheshire

CW10 0JW

Permit number

EPR/DP3435RJ

Cledford Lane Environmental Hub

Permit number EPR/DP3435RJ

Introductory note

This introductory note does not form a part of the permit

The main features of the permit are as follows.

The installation is located on Cledford Lane, Middlewich; NGR SJ 71330 64971.

This application is for a Waste Transfer Station/Refuse Derived Fuel (RDF) production facility located within a larger environmental services hub for the management of household waste collected from within the Cheshire East authority. The site will be operated by ANSA Environmental Services Limited on behalf of Cheshire East Council.

The permitted activities lie within a larger environmental hub, where other council activities will be located, such as vehicle workshop, fuel storage, vehicle wash facilities and general storage. These facilities sit within the Environmental Services Hub, but outside of the installation boundary. Where we discuss proximity to receptors, this is measured from the installation boundary.

The permitted activities comprise the reception and handling of household waste (green waste, recycling, black bin) within 2 buildings, with some inert waste storage outside in dedicated bays.

The smaller building takes no more than 100,000 tonnes per year of green waste and mixed dry recyclables from household waste collections. Waste is sorted, bulked up and stored until it is transported offsite.

Depending on the operational contract Cheshire East Council will enter into, the larger building will be used either as:

A Refuse Derived Fuel (RDF) production facility, comprising sorting, shredding and baling of specified waste types to meet a particular specification for use as fuel. This is a listed activity under EPR 2010, section 5.4 A(1) b) ii). The maximum throughput would not exceed 100,000 tonnes per annum. This permitted activity is set out in table S1.1.

Or,

An additional waste transfer station for residual black bin waste, with further capacity for green waste and mixed recyclables. Maximum throughput would not exceed 100,000 tonnes per annum. This permitted activity is set out in table S1.1a.

The Operator has the option to elect either to carry on the permitted activities as described in table S1.1 or table S1.1a of the permit; the maximum throughput of waste will not exceed 200,000 tonnes per annum overall and for the avoidance of doubt the Operator is not authorised to carry on the activities set out in tables S1.1 and S1.1a at the same time.

At any time that the Operator wishes to switch from the activities in one table to the other they must notify the Environment Agency of their intention and the Environment Agency must approve that switch in writing before the Operator changes the activity accordingly.

Point source emissions:

There are point source emissions to air from the biofilter odour abatement stacks located on each building, shown as A1 and A2 on the site plan. These vents are 1.5m above roof ridge height on eastern side of site, away from closest receptors.

There are no emissions to air of gaseous pollutants.

There are no direct emissions to surface water.

Clean water from the external areas (uncontaminated rainfall) is collected and directed to a storage tank which then connects to an existing drainage system via an interceptor and into the existing canal overflow which ultimately drains to Sanderson's Brook.

Any liquid waste generated from within the buildings which is potentially contaminated will be collected in sumps and tankered offsite for appropriate disposal. Waste stored outside will be on an impermeable surface which links to the drainage system described above. WEEE waste will be covered to minimise run off from rainfall.

The Operator is required to submit the final detailed design drawing of the drainage plan for our approval in writing (pre-operational condition).

There are no emissions to land.

Fugitive emissions: there will be limited storage of waste outside the building, other activities such as waste acceptance, handling, shredding and baling will take place inside the buildings.

There are a number of residential receptors located a short distance from the installation boundary, the closest being 90m to the north east on Cledford Lane.

There are no statutory habitats designations within the relevant screening distance. There are 3 Local Wildlife Sites (LWS) nearby, one of which is across the road from the site; Cledford Lane Lime Beds.

The western edge of the site borders Trent and Mersey canal.

The installation and waste activities will be managed in accordance with an Environmental Management System (EMS). This EMS is not accredited but the summary detail is in line with our guidance and the full EMS will be assessed during the initial compliance inspection.

The status log of the permit sets out the permitting history, including any changes to the permit reference number.

Status log of the permit		
Description	Date	Comments
Application EPR/DP3435RJ/A001	Duly made 23/11/15	Application for waste transfer station with RDF production.
Additional information received	22/01/16; 26/01/16; 18/02/16; 02/03/16	Schedule 5 notice and follow up requests for information and FPP amendments, additional waste table
Permit determined EPR/DP3435RJ (PAS Billing ref. DP3435RJ)	DD/MM/YY	Permit granted to ANSA Environmental Services Limited.

End of introductory note

Permit

The Environmental Permitting (England and Wales) Regulations 2010

Permit number

EPR/DP3435RJ

The Environment Agency hereby authorises, under regulation 13 of the Environmental Permitting (England and Wales) Regulations 2010

ANSA Environmental Services Limited (“the operator”),

whose registered office is

Pyms Lane Depot

Pyms Lane

Crewe

Cheshire

CW1 3PJ

company registration number 08714767

to operate an installation and waste operations at:

Cledford Lane Environmental Hub

Cledford Lane

Middlewich

Cheshire

CW10 0JW

to the extent authorised by and subject to the conditions of this permit.

Name	Date
DRAFT	[DD/MM/YYYY]

Authorised on behalf of the Environment Agency

Conditions

1 Management

1.1 General management

- 1.1.1 The operator shall manage and operate the activities:
- (a) in accordance with a written management system that identifies and minimises risks of pollution, including those arising from operations, maintenance, accidents, incidents, non-conformances, closure and those drawn to the attention of the operator as a result of complaints; and
 - (b) using sufficient competent persons and resources.
- 1.1.2 Records demonstrating compliance with condition 1.1.1 shall be maintained.
- 1.1.3 Any person having duties that are or may be affected by the matters set out in this permit shall have convenient access to a copy of it kept at or near the place where those duties are carried out.
- 1.1.4 The operator shall comply with the requirements of an approved competence scheme.

1.2 Energy efficiency

- 1.2.1 For activity A1 referenced in schedule 1, table S1.1; the operator shall:
- (a) take appropriate measures to ensure that energy is used efficiently in the activities;
 - (b) review and record at least every four years whether there are suitable opportunities to improve the energy efficiency of the activities; and
 - (c) take any further appropriate measures identified by a review.

1.3 Efficient use of raw materials

- 1.3.1 For activity A1 referenced in schedule 1, table S1.1; the operator shall:
- (a) take appropriate measures to ensure that raw materials and water are used efficiently in the activities;
 - (b) maintain records of raw materials and water used in the activities;
 - (c) review and record at least every four years whether there are suitable alternative materials that could reduce environmental impact or opportunities to improve the efficiency of raw material and water use; and
 - (d) take any further appropriate measures identified by a review.

1.4 Avoidance, recovery and disposal of wastes produced by the activities

- 1.4.1 The operator shall take appropriate measures to ensure that:
- (a) the waste hierarchy referred to in Article 4 of the Waste Framework Directive is applied to the generation of waste by the activities; and
 - (b) any waste generated by the activities is treated in accordance with the waste hierarchy referred to in Article 4 of the Waste Framework Directive; and

(c) where disposal is necessary, this is undertaken in a manner which minimises its impact on the environment.

1.4.2 The operator shall review and record at least every four years whether changes to those measures should be made and take any further appropriate measures identified by a review.

2 Operations

2.1 Permitted activities

2.1.1 The operator is authorised to carry out the activities specified in either schedule 1 table S1.1 or schedule 1 table S1.1a.

2.1.2 The Operator shall before any operations commence advise the Environment Agency in writing which of the activities (either those in table S1.1 or table S1.1a) will be undertaken.

2.1.3 Once the Operator has notified us in accordance with 2.1.2 above the Operator shall only switch from the activities in table S1.1 to the activities in S1.1a or vice versa with the written approval of the Environment Agency.

2.1.4 'The activities' shall mean the activities notified under condition 2.1.2 or as approved under condition 2.1.3 as appropriate.

2.1.5 Waste authorised by this permit shall be clearly distinguished from any other waste on the site.

2.2 The site

2.2.1 The activities shall not extend beyond the site, being the land shown edged in green on the site plan at schedule 7 to this permit.

2.3 Operating techniques

2.3.1 For activities referenced in schedule 1, table S1.1; the activities shall, subject to the conditions of this permit, be operated using the techniques and in the manner described in the documentation specified in schedule 1, table S1.2, unless otherwise agreed in writing by the Environment Agency.

2.3.2 For activities referenced in schedule 1, table S1.1a; the activities shall, subject to the conditions of this permit, be operated using the techniques and in the manner described in the documentation specified in schedule 1, table S1.2, unless otherwise agreed in writing by the Environment Agency.

2.3.3 If notified by the Environment Agency that the activities are giving rise to pollution, the operator shall submit to the Environment Agency for approval within the period specified, a revision of any plan or other documentation ("plan") specified in schedule 1, table S1.2 or otherwise required under this permit which identifies and minimises the risks of pollution relevant to that plan, and shall implement the approved revised plan in place of the original from the date of approval, unless otherwise agreed in writing by the Environment Agency.

2.3.4 Any raw materials or fuels listed in schedule 2 table S2.1 shall conform to the specifications set out in that table.

2.3.5 Waste shall only be accepted if:

(a) it is of a type and quantity listed in schedule 2 tables S2.2, S2.3 and S2.4; and

(b) it conforms to the description in the documentation supplied by the producer and holder.

2.3.6 The operator shall ensure that where waste produced by the activities is sent to a relevant waste operation, that operation is provided with the following information, prior to the receipt of the waste:

(a) the nature of the process producing the waste;

- (b) the composition of the waste;
- (c) the handling requirements of the waste;
- (d) the hazardous property associated with the waste, if applicable; and
- (e) the waste code of the waste.

2.3.7 The operator shall ensure that where waste produced by the activities is sent to a landfill site, it meets the waste acceptance criteria for that landfill.

WEEE treatment

2.3.8 The storage (including temporary storage) and treatment of WEEE shall be carried out in accordance with the technical requirements of Annex VIII of the WEEE Directive.

Hazardous waste storage and treatment

2.3.9 Hazardous waste shall not be mixed, either with a different category of hazardous waste or with other waste, substances or materials, unless it is authorised by schedule 1 table S1.1 or schedule 1 table S1.1a, and appropriate measures are taken.

2.4 Pre-operational conditions

2.4.1 The activities shall not be brought into operation until the measures specified in schedule 1 table S1.3 have been completed.

3 Emissions and monitoring

3.1 Emissions to water, air or land

3.1.1 There shall be no point source emissions to water, air or land except from the sources and emission points listed in schedule 3 tables S3.1, S3.2 and S3.3.

3.1.2 The limits given in schedule 3 shall not be exceeded.

3.1.3 Periodic monitoring shall be carried out at least once every 5 years for groundwater and 10 years for soil, unless such monitoring is based on a systematic appraisal of the risk of contamination.

3.2 Emissions of substances not controlled by emission limits

3.2.1 Emissions of substances not controlled by emission limits (excluding odour) shall not cause pollution. The operator shall not be taken to have breached this condition if appropriate measures, including, but not limited to, those specified in any approved emissions management plan, have been taken to prevent or where that is not practicable, to minimise, those emissions.

3.2.2 The operator shall:

- (a) if notified by the Environment Agency that the activities are giving rise to pollution, submit to the Environment Agency for approval within the period specified, an emissions management plan which identifies and minimises the risks of pollution from emissions of substances not controlled by emission limits;
- (b) implement the approved emissions management plan, from the date of approval, unless otherwise agreed in writing by the Environment Agency.

- 3.2.3 All liquids in containers, whose emission to water or land could cause pollution, shall be provided with secondary containment, unless the operator has used other appropriate measures to prevent or where that is not practicable, to minimise, leakage and spillage from the primary container.

3.3 Odour

- 3.3.1 Emissions from the activities shall be free from odour at levels likely to cause pollution outside the site, as perceived by an authorised officer of the Environment Agency, unless the operator has used appropriate measures, including, but not limited to, those specified in any approved odour management plan, to prevent or where that is not practicable to minimise the odour.

3.4 Noise and vibration

- 3.4.1 Emissions from the activities shall be free from noise and vibration at levels likely to cause pollution outside the site, as perceived by an authorised officer of the Environment Agency, unless the operator has used appropriate measures, including, but not limited to, those specified in any approved noise and vibration management plan to prevent or where that is not practicable to minimise the noise and vibration.
- 3.4.2 The operator shall:
- (a) if notified by the Environment Agency that the activities are giving rise to pollution outside the site due to noise and vibration, submit to the Environment Agency for approval within the period specified, a noise and vibration management plan which identifies and minimises the risks of pollution from noise and vibration;
 - (b) implement the approved noise and vibration management plan, from the date of approval, unless otherwise agreed in writing by the Environment Agency.

3.5 Monitoring

- 3.5.1 The operator shall, unless otherwise agreed in writing by the Environment Agency, undertake the monitoring specified in the following tables in schedule 3 to this permit:
- (a) point source emissions specified in tables S3.1 and S3.2;
 - (b) process monitoring specified in table S3.3.
- 3.5.2 The operator shall maintain records of all monitoring required by this permit including records of the taking and analysis of samples, instrument measurements (periodic and continual), calibrations, examinations, tests and surveys and any assessment or evaluation made on the basis of such data.
- 3.5.3 Monitoring equipment, techniques, personnel and organisations employed for the emissions monitoring programme and the environmental or other monitoring specified in condition 3.5.1 shall have either MCERTS certification or MCERTS accreditation (as appropriate), where available, unless otherwise agreed in writing by the Environment Agency.
- 3.5.4 Permanent means of access shall be provided to enable sampling/monitoring to be carried out in relation to the emission points specified in schedule 3 tables S3.1, unless otherwise agreed in writing by the Environment Agency.

3.6 Pests

3.6.1 The activities shall not give rise to the presence of pests which are likely to cause pollution, hazard or annoyance outside the boundary of the site. The operator shall not be taken to have breached this condition if appropriate measures, including, but not limited to, those specified in any approved pests management plan, have been taken to prevent or where that is not practicable, to minimise the presence of pests on the site.

3.6.2 The operator shall:

- (a) if notified by the Environment Agency, submit to the Environment Agency for approval within the period specified, a pests management plan which identifies and minimises risks of pollution from pests;
- (b) implement the pests management plan, from the date of approval, unless otherwise agreed in writing by the Environment Agency.

3.7 Fire prevention

3.7.1 The operator shall take all appropriate measures to prevent fires on site and minimise the risk of pollution from them including, but not limited to, those specified in any approved fire prevention plan.

4 Information

4.1 Records

4.1.1 All records required to be made by this permit shall:

- (a) be legible;
- (b) be made as soon as reasonably practicable;
- (c) if amended, be amended in such a way that the original and any subsequent amendments remain legible, or are capable of retrieval; and
- (d) be retained, unless otherwise agreed in writing by the Environment Agency, for at least 6 years from the date when the records were made, or in the case of the following records until permit surrender:
 - (i) off-site environmental effects; and
 - (ii) matters which affect the condition of the land and groundwater.

4.1.2 The operator shall keep on site all records, plans and the management system required to be maintained by this permit, unless otherwise agreed in writing by the Environment Agency.

4.2 Reporting

4.2.1 The operator shall send all reports and notifications required by the permit to the Environment Agency using the contact details supplied in writing by the Environment Agency.

4.2.2 For activity A1 referenced in schedule 1, table S1.1; a report or reports on the performance of the activities over the previous year shall be submitted to the Environment Agency by 31 January (or other date agreed in writing by the Environment Agency) each year. The report(s) shall include as a minimum:

- (a) a review of the results of the monitoring and assessment carried out in accordance with the permit including an interpretive review of that data;

- (b) the annual production / treatment data set out in schedule 4 table S4.2; and
- (c) the performance parameters set out in schedule 4 table S4.3 using the forms specified in table S4.4 of that schedule.

4.2.3 Within 28 days of the end of the reporting period the operator shall, unless otherwise agreed in writing by the Environment Agency, submit reports of the monitoring and assessment carried out in accordance with the conditions of this permit, as follows:

- (a) in respect of the parameters and emission points specified in schedule 4 table S4.1;
- (b) for the reporting periods specified in schedule 4 table S4.1 and using the forms specified in schedule 4 table S4.4; and
- (c) giving the information from such results and assessments as may be required by the forms specified in those tables.

4.2.4 The operator shall, unless notice under this condition has been served within the preceding four years, submit to the Environment Agency, within six months of receipt of a written notice, a report assessing whether there are other appropriate measures that could be taken to prevent, or where that is not practicable, to minimise pollution.

4.2.5 Within 1 month of the end of each quarter, the operator shall submit to the Environment Agency using the form made available for the purpose, the information specified on the form relating to the site and the waste accepted and removed from it during the previous quarter.

4.3 Notifications

4.3.1 In the event:

- (a) that the operation of the activities gives rise to an incident or accident which significantly affects or may significantly affect the environment, the operator must immediately—
 - (i) inform the Environment Agency,
 - (ii) take the measures necessary to limit the environmental consequences of such an incident or accident, and
 - (iii) take the measures necessary to prevent further possible incidents or accidents;
- (b) of a breach of any permit condition the operator must immediately—
 - (i) inform the Environment Agency, and
 - (ii) take the measures necessary to ensure that compliance is restored within the shortest possible time;
- (c) of a breach of permit condition which poses an immediate danger to human health or threatens to cause an immediate significant adverse effect on the environment, the operator must immediately suspend the operation of the activities or the relevant part of it until compliance with the permit conditions has been restored.

4.3.2 Any information provided under condition 4.3.1 shall be confirmed by sending the information listed in schedule 5 to this permit within the time period specified in that schedule.

4.3.3 Where the Environment Agency has requested in writing that it shall be notified when the operator is to undertake monitoring and/or spot sampling, the operator shall inform the Environment Agency when the relevant monitoring and/or spot sampling is to take place. The operator shall provide this information to the Environment Agency at least 14 days before the date the monitoring is to be undertaken.

4.3.4 The Environment Agency shall be notified within 14 days of the occurrence of the following matters, except where such disclosure is prohibited by Stock Exchange rules:

Where the operator is a registered company:

- (a) any change in the operator's trading name, registered name or registered office address; and
- (b) any steps taken with a view to the operator going into administration, entering into a company voluntary arrangement or being wound up.

Where the operator is a corporate body other than a registered company:

- (a) any change in the operator's name or address; and
- (b) any steps taken with a view to the dissolution of the operator.

In any other case:

- (a) the death of any of the named operators (where the operator consists of more than one named individual);
- (b) any change in the operator's name(s) or address(es); and
- (c) any steps taken with a view to the operator, or any one of them, going into bankruptcy, entering into a composition or arrangement with creditors, or, in the case of them being in a partnership, dissolving the partnership.

4.3.5 Where the operator proposes to make a change in the nature or functioning, or an extension of the activities, which may have consequences for the environment and the change is not otherwise the subject of an application for approval under the Regulations or this permit:

- (a) the Environment Agency shall be notified at least 14 days before making the change; and
- (b) the notification shall contain a description of the proposed change in operation.

4.3.6 The Environment Agency shall be given at least 14 days notice before implementation of any part of the site closure plan.

4.4 Interpretation

4.4.1 In this permit the expressions listed in schedule 6 shall have the meaning given in that schedule.

4.4.2 In this permit references to reports and notifications mean written reports and notifications, except where reference is made to notification being made "immediately", in which case it may be provided by telephone.

Schedule 1 – Operations

Table S1.1 activities			
Activity reference	Activity listed in Schedule 1 of the EP Regulations	Description of specified activity and WFD Annex I and II operations	Limits of specified activity
A1	S5.4 A1 (b)(ii)	<p>Recovery or a mix of recovery and disposal of non-hazardous waste with a capacity exceeding 75 tonnes per day involving:</p> <p>ii) pre-treatment of waste for incineration or co-incineration.</p> <p>R13: Storage of waste pending any of the operations numbered R1 to R12 (excluding temporary storage, pending collection, on the site where it is produced)</p> <p>R3: Recycling/reclamation of organic substances which are not used as solvents</p> <p>R4: Recycling/reclamation of metals and metal compounds</p> <p>R5: Recycling/reclamation of other inorganic compounds</p>	<p>Receipt, storage and treatment including shredding, crushing, screening, and baling of specific waste material for use as Refuse Derived Fuel.</p> <p>In building designated WTS – RDF</p> <p>Waste types as specified in table S2.2</p>
Directly Associated Activity			
A2	Receipt and storage of non-hazardous waste pending pre-treatment of waste for incineration or co-incineration		<p>Receipt and storage of non-hazardous waste.</p> <p>Waste types as specified in table S2.2</p>
A3	Bulking of recyclable wastes recovered as an incidental part of the production of Refuse Derived Fuel, activity A1 in this table.		Bulking up of recyclable wastes produced as a result of activity A1.
		Description of activities for waste operations	Limits of activities
A4	Waste Transfer - Recycling	<p>R13: Storage of waste pending any of the operations numbered R1 to R12 (excluding temporary storage, pending collection, on the site where it is produced)</p> <p>R3: Recycling/reclamation of organic substances which are not used as solvents</p> <p>R4: Recycling/reclamation of metals and metal compounds</p> <p>R5: Recycling/reclamation of other inorganic compounds</p>	<p>Physical treatment including screening, crushing, baling, shredding for the purpose of recovery.</p> <p>In building designated WTS – Recycling only.</p> <p>Waste types as specified in table S2.4</p>

Table S1.1a activities	
Description of activities for waste operations	Limits of activities
<p>Waste Transfer - Recycling</p> <p>R13: Storage of waste pending any of the operations numbered R1 to R12 (excluding temporary storage, pending collection, on the site where it is produced)</p> <p>R3: Recycling/reclamation of organic substances which are not used as solvents</p> <p>R4: Recycling/reclamation of metals and metal compounds</p> <p>R5: Recycling/reclamation of other inorganic compounds</p>	<p>Physical treatment including screening, crushing, baling, shredding for the purpose of recovery.</p> <p>Waste types as specified in tables S2.3 and S2.4.</p>

Table S1.2 Operating techniques		
Description	Parts	Date Received
Application EPR/DP3435RJ/A001	Application form B3, section 3 Operating Techniques	Duly Made 23/11/15
Response to Schedule 5 Notice dated 11/01/16	<p>Odour Management Plan January 2016</p> <p>Operating Techniques January 2016;</p> <p>Sections 3.2, 3.3.2, 3.3.3, 3.3.4 and 5.2 apply to activities specified in table S1.1;</p> <p>Sections 3.2, 3.3.5 and 5.3 apply to activities specified in table S1.1a.</p> <p>Remaining sections apply to either set of activities.</p>	22/01/16
Additional information	Approved Fire Prevention Plan; Fire Action Plan.	01/03/16

Table S1.3 Pre-operational measures	
Reference	Pre-operational measures
1	At least 4 weeks prior to operations commencing the Operator shall submit for approval in writing the final detailed design drawing of the drainage plan. Where any variances occur to the existing drainage plan, the operator shall provide updated risk assessment or procedures.

Schedule 2 – Waste types, raw materials and fuels

Raw materials and fuel description	Specification
-	-

Maximum quantity	less than 100,000 tonnes per year
Waste code	Description
02	Wastes from agriculture, horticulture, aquaculture, forestry, hunting and fishing, food preparation and processing
02 01	wastes from agriculture, horticulture, aquaculture, forestry, hunting and fishing
02 01 03	plant-tissue waste
02 01 04	waste plastics (except packaging)
02 01 07	wastes from forestry
02 03	wastes from fruit, vegetables, cereals, edible oils, cocoa, coffee, tea and tobacco preparation and processing; conserve production; yeast and yeast extract production, molasses preparation and fermentation
02 03 02	wastes from preserving agents
02 03 03	wastes from solvent extraction
02 03 04	materials unsuitable for consumption or processing
02 05	wastes from the dairy products industry
02 05 01	materials unsuitable for consumption or processing
02 07	wastes from the production of alcoholic and non-alcoholic beverages (except coffee, tea and cocoa)
02 07 01	wastes from washing, cleaning and mechanical reduction of raw materials
02 07 02	wastes from spirits distillation
02 07 04	materials unsuitable for consumption or processing
03	Wastes from wood processing and the production of panels and furniture, pulp, paper and cardboard
03 01	wastes from wood processing and the production of panels and furniture
03 01 01	waste bark and cork
03 01 05	sawdust, shavings, cuttings, wood, particle board and veneer other than those mentioned in 03 01 04
03 03	wastes from pulp, paper and cardboard production and processing
03 03 01	waste bark and wood
03 03 07	mechanically separated rejects from pulping of waste paper and cardboard
03 03 08	wastes from sorting of paper and cardboard destined for recycling

Table S2.2 Permitted waste types and quantities for RDF process (table S1.1)	
Maximum quantity	less than 100,000 tonnes per year
Waste code	Description
03 03 10	fibre rejects, fibre-, filler- and coating-sludges from mechanical separation
04	Wastes from the leather, fur and textile industries
04 02	wastes from the textile industry
04 02 09	wastes from composite materials (impregnated textile, elastomer, plastomer)
04 02 15	wastes from finishing other than those mentioned in 04 02 14
04 02 21	wastes from unprocessed textile fibres
04 02 22	wastes from processed textile fibres
07	Wastes from organic chemical processes
07 02	wastes from the MFSU of plastics, synthetic rubber and man-made fibres
07 02 13	waste plastic
15	Waste packaging, absorbents, wiping cloths, filter materials and protective clothing not otherwise specified
15 01	packaging (including separately collected municipal packaging waste)
15 01 01	paper and cardboard packaging
15 01 02	plastic packaging
15 01 03	wooden packaging
15 01 04	metallic packaging
15 01 05	composite packaging
15 01 06	mixed packaging
15 01 07	glass packaging
15 01 09	textile packaging
15 02	absorbents, filter materials, wiping cloths and protective clothing
15 02 03	absorbents, filter materials, wiping cloths and protective clothing other than those mentioned in 15 02 02
16	Wastes not otherwise specified in the list
16 01	end-of-life vehicles from different means of transport (including off-road machinery) and wastes from dismantling of end-of-life vehicles and vehicle maintenance (except 13, 14, 16 06 and 16 08)
16 01 19	plastic
16 01 22	Discarded components not otherwise specified
17	Construction and demolition wastes (including excavated soil from contaminated sites)
17 02	wood, glass and plastic
17 02 01	wood
17 02 03	plastic
18	Wastes from human or animal health care and/or related research (except kitchen and restaurant wastes not arising from immediate health care)
18 01	wastes from natal care, diagnosis, treatment or prevention of disease in humans

Table S2.2 Permitted waste types and quantities for RDF process (table S1.1)	
Maximum quantity	less than 100,000 tonnes per year
Waste code	Description
18 01 04	wastes whose collection and disposal is not subject to special requirements in order to prevent infection (for example dressings, plaster casts, linen, disposable clothing, diapers)
19	Wastes from waste management facilities, off-site waste water treatment plants and the preparation of water intended for human consumption and water for industrial use
19 02	wastes from physico/chemical treatments of waste (including dechromatation, decyanidation, neutralisation)
19 02 03	premixed wastes composed only of non-hazardous wastes
19 02 10	combustible wastes other than those mentioned in 19 02 08 and 19 02 09
19 04	vitrified waste and wastes from vitrification
19 04 01	vitrified waste
19 05	wastes from aerobic treatment of solid wastes
19 05 01	non-composted fraction of municipal and similar wastes
19 05 02	non-composted fraction of animal and vegetable waste
19 10	wastes from shredding of metal-containing wastes
19 10 04	fluff-light fraction and dust other than those mentioned in 19 10 03
19 10 06	other fractions other than those mentioned in 19 10 05
19 12	wastes from the mechanical treatment of waste (for example sorting, crushing, compacting, pelletising) not otherwise specified
19 12 01	paper and cardboard
19 12 04	plastic and rubber
19 12 07	wood other than that mentioned in 19 12 06
19 12 08	textiles
19 12 10	combustible waste (refuse derived fuel)
19 12 12	other wastes (including mixtures of materials) from mechanical treatment of wastes other than those mentioned in 19 12 11 - residues from treatment of non-hazardous municipal / commercial waste e.g. from MRFs and production of SRF / RDF
19 13	wastes from soil and groundwater remediation
19 13 02	solid wastes from soil remediation other than those mentioned in 19 13 01
20	Municipal wastes (household waste and similar commercial, industrial and institutional wastes) including separately collected fractions
20 01	separately collected fractions (except 15 01)
20 01 01	paper and cardboard
20 01 10	clothes
20 01 11	textiles
20 01 38	wood other than that mentioned in 20 01 37
20 01 39	plastics
20 02	garden and park wastes (including cemetery waste)
20 02 03	other non-biodegradable wastes

Table S2.2 Permitted waste types and quantities for RDF process (table S1.1)	
Maximum quantity	less than 100,000 tonnes per year
Waste code	Description
20 03	other municipal wastes
20 03 01	mixed municipal waste
20 03 02	waste from markets
20 03 07	bulky waste

Table S2.3 Permitted waste types and quantities for WTS (table S1.1a)	
Maximum quantity	less than 100,000 tonnes per year
Waste code	Description
01	Wastes resulting from exploration, mining, quarrying, and physical and chemical treatment of minerals
01 01	wastes from mineral excavation
01 01 01	wastes from mineral metalliferous excavation
01 01 02	wastes from mineral non-metalliferous excavation
01 03	wastes from physical and chemical processing of metalliferous minerals
01 03 06	tailings other than those mentioned in 01 03 04 and 01 03 05
01 03 09	red mud from alumina production other than the wastes mentioned in 01 03 10
01 04	wastes from physical and chemical processing of non-metalliferous minerals
01 04 08	waste gravel and crushed rocks other than those mentioned in 01 04 07
01 04 09	waste sand and clays
01 04 11	wastes from potash and rock salt processing other than those mentioned in 01 04 07
01 04 12	tailings and other wastes from washing and cleaning of minerals other than those mentioned in 01 04 07 and 01 04 11
01 04 13	wastes from stone cutting and sawing other than those mentioned in 01 04 07
02	Wastes from agriculture, horticulture, aquaculture, forestry, hunting and fishing, food preparation and processing
02 01	wastes from agriculture, horticulture, aquaculture, forestry, hunting and fishing
02 01 03	plant-tissue waste
02 01 04	waste plastics (except packaging)
02 01 07	wastes from forestry
02 01 10	waste metal
02 02	wastes from the preparation and processing of meat, fish and other foods of animal origin
02 02 03	materials unsuitable for consumption or processing
02 03	wastes from fruit, vegetables, cereals, edible oils, cocoa, coffee, tea and tobacco preparation and processing; conserve production; yeast and yeast

Table S2.3 Permitted waste types and quantities for WTS (table S1.1a)	
Maximum quantity	less than 100,000 tonnes per year
Waste code	Description
	extract production, molasses preparation and fermentation
02 03 04	materials unsuitable for consumption or processing
02 04	wastes from sugar processing
02 04 01	soil from cleaning and washing beet
02 04 02	off-specification calcium carbonate
02 05	wastes from the dairy products industry
02 05 01	materials unsuitable for consumption or processing
02 06	wastes from the baking and confectionery industry
02 06 01	materials unsuitable for consumption or processing
02 06 02	wastes from preserving agents
02 07	wastes from the production of alcoholic and non-alcoholic beverages (except coffee, tea and cocoa)
02 07 01	wastes from washing, cleaning and mechanical reduction of raw materials
02 07 02	wastes from spirits distillation
02 07 04	materials unsuitable for consumption or processing
03	Wastes from wood processing and the production of panels and furniture, pulp, paper and cardboard
03 01	wastes from wood processing and the production of panels and furniture
03 01 01	waste bark and cork
03 01 05	sawdust, shavings, cuttings, wood, particle board and veneer other than those mentioned in 03 01 04
03 03	wastes from pulp, paper and cardboard production and processing
03 03 01	waste bark and wood
03 03 07	mechanically separated rejects from pulping of waste paper and cardboard
03 03 08	wastes from sorting of paper and cardboard destined for recycling
03 03 10	fibre rejects, fibre-, filler- and coating-sludges from mechanical separation
04	Wastes from the leather, fur and textile industries
04 01	wastes from the leather and fur industry
04 01 08	waste tanned leather (blue sheetings, shavings, cuttings, buffing dust) containing chromium
04 01 09	wastes from dressing and finishing
04 02	wastes from the textile industry
04 02 21	wastes from unprocessed textile fibres
04 02 22	wastes from processed textile fibres
06	Wastes from inorganic chemical processes
06 09	wastes from the MSFU of phosphorous chemicals and phosphorous chemical processes
06 09 02	phosphorous slag
06 09 04	calcium-based reaction wastes other than those mentioned in 06 09 03

Table S2.3 Permitted waste types and quantities for WTS (table S1.1a)	
Maximum quantity	less than 100,000 tonnes per year
Waste code	Description
06 11	wastes from the manufacture of inorganic pigments and opacifiers
06 11 01	calcium-based reaction wastes from titanium dioxide production
07	Wastes from organic chemical processes
07 02	wastes from the MFSU of plastics, synthetic rubber and man-made fibres
07 02 13	waste plastic
09	Wastes from the photographic industry
09 01	wastes from the photographic industry
09 01 07	photographic film and paper containing silver or silver compounds
09 01 08	photographic film and paper free of silver or silver compounds
09 01 10	single-use cameras without batteries
09 01 12	single-use cameras containing batteries other than those mentioned in 09 01 11
10	Wastes from thermal processes
10 01	wastes from power stations and other combustion plants (except 19)
10 01 01	bottom ash, slag and boiler dust (excluding boiler dust mentioned in 10 01 04)
10 01 05	calcium-based reaction wastes from flue-gas desulphurisation in solid form
10 01 07	calcium-based reaction wastes from flue-gas desulphurisation in sludge form
10 01 15	bottom ash, slag and boiler dust from co-incineration other than those mentioned in 10 01 14
10 01 19	wastes from gas cleaning other than those mentioned in 10 01 05, 10 01 07 and 10 01 18
10 01 24	sands from fluidised beds
10 02	wastes from the iron and steel industry
10 02 01	wastes from the processing of slag
10 02 02	unprocessed slag
10 02 08	solid wastes from gas treatment other than those mentioned in 10 02 07
10 02 10	mill scales
10 02 14	sludges and filter cakes from gas treatment other than those mentioned in 10 02 13
10 02 15	other sludges and filter cakes
10 03	wastes from aluminium thermal metallurgy
10 03 02	anode scraps
10 03 05	waste alumina
10 03 16	skimmings other than those mentioned in 10 03 15
10 03 18	carbon-containing wastes from anode manufacture other than those mentioned in 10 03 17
10 03 24	solid wastes from gas treatment other than those mentioned in 10 03 23
10 03 26	sludges and filter cakes from gas treatment other than those mentioned in 10 03 25
10 03 28	wastes from cooling-water treatment other than those mentioned in 10 03 27
10 03 30	wastes from treatment of salt slags and black drosses other than those mentioned in

Table S2.3 Permitted waste types and quantities for WTS (table S1.1a)	
Maximum quantity	less than 100,000 tonnes per year
Waste code	Description
	10 03 29
10 04	wastes from lead thermal metallurgy
10 04 10	wastes from cooling-water treatment other than those mentioned in 10 04 09
10 05	wastes from zinc thermal metallurgy
10 05 01	slags from primary and secondary production
10 05 09	wastes from cooling-water treatment other than those mentioned in 10 05 08
10 05 11	dross and skimmings other than those mentioned in 10 05 10
10 06	wastes from copper thermal metallurgy
10 06 01	slags from primary and secondary production
10 06 02	dross and skimmings from primary and secondary production
10 06 10	wastes from cooling-water treatment other than those mentioned in 10 06 09
10 07	wastes from silver, gold and platinum thermal metallurgy
10 07 01	slags from primary and secondary production
10 07 02	dross and skimmings from primary and secondary production
10 07 03	solid wastes from gas treatment
10 07 05	sludges and filter cakes from gas treatment
10 07 08	wastes from cooling-water treatment other than those mentioned in 10 07 07
10 08	wastes from other non-ferrous thermal metallurgy
10 08 09	other slags
10 08 11	dross and skimmings other than those mentioned in 10 08 10
10 08 13	carbon-containing wastes from anode manufacture other than those mentioned in 10 08 12
10 08 14	anode scrap
10 08 18	sludges and filter cakes from flue-gas treatment other than those mentioned in 10 08 17
10 08 20	wastes from cooling-water treatment other than those mentioned in 10 08 19
10 09	wastes from casting of ferrous pieces
10 09 03	furnace slag
10 09 06	casting cores and moulds which have not undergone pouring other than those mentioned in 10 09 05
10 09 08	casting cores and moulds which have undergone pouring other than those mentioned in 10 09 07
10 09 14	waste binders other than those mentioned in 10 09 13
10 09 16	waste crack-indicating agent other than those mentioned in 10 09 15
10 10	wastes from casting of non-ferrous pieces
10 10 03	furnace slag
10 10 06	casting cores and moulds which have not undergone pouring, other than those mentioned in 10 10 05
10 10 14	waste binders other than those mentioned in 10 10 13

Table S2.3 Permitted waste types and quantities for WTS (table S1.1a)	
Maximum quantity	less than 100,000 tonnes per year
Waste code	Description
10 10 16	waste crack-indicating agent other than those mentioned in 10 10 15
10 11	wastes from manufacture of glass and glass products
10 11 03	waste glass-based fibrous materials
10 11 10	waste preparation mixture before thermal processing, other than those mentioned in 10 11 09
10 11 12	waste glass other than those mentioned in 10 11 11
10 11 16	solid wastes from flue-gas treatment other than those mentioned in 10 11 15
10 11 18	sludges and filter cakes from flue-gas treatment other than those mentioned in 10 11 17
10 12	wastes from manufacture of ceramic goods, bricks, tiles and construction products
10 12 01	waste preparation mixture before thermal processing
10 12 05	sludges and filter cakes from gas treatment
10 12 06	discarded moulds
10 12 08	waste ceramics, bricks, tiles and construction products (after thermal processing)
10 13	wastes from manufacture of cement, lime and plaster and articles and products made from them
10 13 01	waste preparation mixture before thermal processing
10 13 04	wastes from calcination and hydration of lime
10 13 07	sludges and filter cakes from gas treatment
10 13 10	wastes from asbestos-cement manufacture other than those mentioned in 10 13 09
10 13 11	wastes from cement-based composite materials other than those mentioned in 10 13 09 and 10 13 10
10 13 13	solid wastes from gas treatment other than those mentioned in 10 13 12
10 13 14	waste concrete and concrete sludge
11	Wastes from chemical surface treatment and coating of metals and other materials; non-ferrous hydro-metallurgy
11 01	wastes from chemical surface treatment and coating of metals and other materials (for example galvanic processes, zinc coating processes, pickling processes, etching, phosphating, alkaline degreasing, anodising)
11 01 10	sludges and filter cakes other than those mentioned in 11 01 09
11 01 14	degreasing wastes other than those mentioned in 11 01 13
11 02	wastes from non-ferrous hydrometallurgical processes
11 02 03	wastes from the production of anodes for aqueous electrolytical processes
11 02 06	wastes from copper hydrometallurgical processes other than those mentioned in 11 02 05
11 05	wastes from hot galvanising processes
11 05 01	hard zinc
11 05 02	zinc ash
12	Wastes from shaping and physical and mechanical surface treatment of metals and plastics

Table S2.3 Permitted waste types and quantities for WTS (table S1.1a)	
Maximum quantity	less than 100,000 tonnes per year
Waste code	Description
12 01	wastes from shaping and physical and mechanical surface treatment of metals and plastics
12 01 01	ferrous metal filings and turnings
12 01 03	non-ferrous metal filings and turnings
12 01 05	plastics shavings and turnings
12 01 13	welding wastes
12 01 17	waste blasting material other than those mentioned in 12 01 16
12 01 21	spent grinding bodies and grinding materials other than those mentioned in 12 01 20
15	Waste packaging, absorbents, wiping cloths, filter materials and protective clothing not otherwise specified
15 01	packaging (including separately collected municipal packaging waste)
15 01 01	paper and cardboard packaging
15 01 02	plastic packaging
15 01 03	wooden packaging
15 01 04	metallic packaging
15 01 05	composite packaging
15 01 06	mixed packaging
15 01 07	glass packaging
15 01 09	textile packaging
15 02	absorbents, filter materials, wiping cloths and protective clothing
15 02 03	absorbents, filter materials, wiping cloths and protective clothing other than those mentioned in 15 02 02
16	Wastes not otherwise specified in the list
16 01	end-of-life vehicles from different means of transport (including off-road machinery) and wastes from dismantling of end-of-life vehicles and vehicle maintenance (except 13, 14, 16 06 and 16 08)
16 01 03	end-of-life tyres
16 02	wastes from electrical and electronic equipment
16 02 11*	discarded equipment containing chlorofluorocarbons, HCFC, HFC
16 02 13*	discarded equipment containing hazardous components other than those mentioned in 16 02 09 to 16 02 12
16 02 14	discarded equipment other than those mentioned in 16 02 09 to 16 02 13
16 02 16	components removed from discarded equipment other than those mentioned in 16 02 15
16 03	off-specification batches and unused products
16 03 04	inorganic wastes other than those mentioned in 16 03 03
16 03 06	organic wastes other than those mentioned in 16 03 05
16 06	batteries and accumulators
16 06 04	alkaline batteries (except 16 06 03)

Table S2.3 Permitted waste types and quantities for WTS (table S1.1a)	
Maximum quantity	less than 100,000 tonnes per year
Waste code	Description
16 06 05	other batteries and accumulators
16 11	waste linings and refractories
16 11 02	carbon-based linings and refractories from metallurgical processes others than those mentioned in 16 11 01
16 11 04	other linings and refractories from metallurgical processes other than those mentioned in 16 11 03
16 11 06	linings and refractories from non-metallurgical processes others than those mentioned in 16 11 05
17	Construction and demolition wastes (including excavated soil from contaminated sites)
17 01	concrete, bricks, tiles and ceramics
17 01 01	concrete
17 01 02	bricks
17 01 03	tiles and ceramics
17 01 07	mixtures of concrete, bricks, tiles and ceramics other than those mentioned in 17 01 06
17 02	wood, glass and plastic
17 02 01	wood
17 02 02	glass
17 02 03	plastic
17 03	bituminous mixtures, coal tar and tarred products
17 03 02	bituminous mixtures other than those mentioned in 17 03 01
17 04	metals (including their alloys)
17 04 01	copper, bronze, brass
17 04 02	aluminium
17 04 03	lead
17 04 04	zinc
17 04 05	iron and steel
17 04 06	tin
17 04 07	mixed metals
17 04 11	cables other than those mentioned in 17 04 10
17 05	soil (including excavated soil from contaminated sites), stones and dredging spoil
17 05 04	soil and stones other than those mentioned in 17 05 03
17 05 08	track ballast other than those mentioned in 17 05 07
17 06	insulation materials and asbestos-containing construction materials
17 06 04	insulation materials other than those mentioned in 17 06 01 and 17 06 03
17 08	gypsum-based construction material
17 08 02	gypsum-based construction materials other than those mentioned in 17 08 01

Table S2.3 Permitted waste types and quantities for WTS (table S1.1a)	
Maximum quantity	less than 100,000 tonnes per year
Waste code	Description
17 09	other construction and demolition wastes
17 09 04	mixed construction and demolition wastes other than those mentioned in 17 09 01, 17 09 02 and 17 09 03
19	Wastes from waste management facilities, off-site waste water treatment plants and the preparation of water intended for human consumption and water for industrial use
19 01	wastes from incineration or pyrolysis of waste
19 01 02	ferrous materials removed from bottom ash
19 01 12	bottom ash and slag other than those mentioned in 19 01 11
19 01 18	pyrolysis wastes other than those mentioned in 19 01 17
19 01 19	sands from fluidised beds
19 02	wastes from physico/chemical treatments of waste (including dechromatation, decyanidation, neutralisation)
19 02 03	premixed wastes composed only of non-hazardous wastes
19 02 10	combustible wastes other than those mentioned in 19 02 08 and 19 02 09
19 04	vitrified waste and wastes from vitrification
19 04 01	vitrified waste
19 05	wastes from aerobic treatment of solid wastes
19 05 01	non-composted fraction of municipal and similar wastes
19 05 02	non-composted fraction of animal and vegetable waste
19 05 03	off-specification compost
19 12	wastes from the mechanical treatment of waste (for example sorting, crushing, compacting, pelletising) not otherwise specified
19 12 01	paper and cardboard
19 12 02	ferrous metal
19 12 03	non-ferrous metal
19 12 04	plastic and rubber
19 12 05	glass
19 12 07	wood other than that mentioned in 19 12 06
19 12 08	textiles
19 12 09	minerals (for example sand, stones)
19 12 10	combustible waste (refuse derived fuel)
19 13	wastes from soil and groundwater remediation
19 13 02	solid wastes from soil remediation other than those mentioned in 19 13 01
20	Municipal wastes (household waste and similar commercial, industrial and institutional wastes) including separately collected fractions
20 01	separately collected fractions (except 15 01)
20 01 01	paper and cardboard
20 01 02	glass

Table S2.3 Permitted waste types and quantities for WTS (table S1.1a)	
Maximum quantity	less than 100,000 tonnes per year
Waste code	Description
20 01 08	biodegradable kitchen and canteen waste
20 01 10	clothes
20 01 11	textiles
20 01 21*	fluorescent tubes and other mercury-containing waste
20 01 23*	discarded equipment containing chlorofluorocarbons
20 01 34	batteries and accumulators other than those mentioned in 20 01 33
20 01 35*	discarded electrical and electronic equipment other than those mentioned in 20 01 21 and 20 01 23 containing hazardous components
20 01 36	discarded electrical and electronic equipment other than those mentioned in 20 01 21, 20 01 23 and 20 01 35
20 01 38	wood other than that mentioned in 20 01 37
20 01 39	plastics
20 01 40	metals
20 01 41	wastes from chimney sweeping
20 02	garden and park wastes (including cemetery waste)
20 02 01	biodegradable waste
20 02 02	soil and stones
20 03	other municipal wastes
20 03 01	mixed municipal waste
20 03 02	waste from markets
20 03 03	street-cleaning residues
20 03 07	bulky waste

Table S2.4 Permitted waste types and quantities for WTS (green waste and dry recyclables)	
Maximum quantity	less than 100,000 tonnes per year
Waste code	Description
02	Wastes from agriculture, horticulture, aquaculture, forestry, hunting and fishing, food preparation and processing
02 01	wastes from agriculture, horticulture, aquaculture, forestry, hunting and fishing
02 01 03	plant-tissue waste
02 01 04	waste plastics (except packaging)
02 01 07	wastes from forestry
02 01 10	waste metal
02 04	wastes from sugar processing
02 04 01	soil from cleaning and washing beet
03	Wastes from wood processing and the production of panels and furniture, pulp, paper and cardboard

Table S2.4 Permitted waste types and quantities for WTS (green waste and dry recyclables)	
Maximum quantity	less than 100,000 tonnes per year
Waste code	Description
03 01	wastes from wood processing and the production of panels and furniture
03 01 01	waste bark and cork
03 03	wastes from pulp, paper and cardboard production and processing
03 03 01	waste bark and wood
07	Wastes from organic chemical processes
07 02	wastes from the MFSU of plastics, synthetic rubber and man-made fibres
07 02 13	waste plastic
09	Wastes from the photographic industry
09 01	wastes from the photographic industry
09 01 07	photographic film and paper containing silver or silver compounds
09 01 08	photographic film and paper free of silver or silver compounds
09 01 10	single-use cameras without batteries
09 01 12	single-use cameras containing batteries other than those mentioned in 09 01 11
10	Wastes from thermal processes
10 11	wastes from manufacture of glass and glass products
10 11 12	waste glass other than those mentioned in 10 11 11
12	Wastes from shaping and physical and mechanical surface treatment of metals and plastics
12 01	wastes from shaping and physical and mechanical surface treatment of metals and plastics
12 01 05	plastics shavings and turnings
15	Waste packaging, absorbents, wiping cloths, filter materials and protective clothing not otherwise specified
15 01	packaging (including separately collected municipal packaging waste)
15 01 01	paper and cardboard packaging
15 01 02	plastic packaging
15 01 03	wooden packaging
15 01 04	metallic packaging
15 01 05	composite packaging
15 01 06	mixed packaging
15 01 07	glass packaging
15 01 09	textile packaging
17	Construction and demolition wastes (including excavated soil from contaminated sites)
17 05	soil (including excavated soil from contaminated sites), stones and dredging spoil
17 05 04	soil and stones other than those mentioned in 17 05 03
19	Wastes from waste management facilities, off-site waste water treatment plants and the preparation of water intended for human consumption and

Table S2.4 Permitted waste types and quantities for WTS (green waste and dry recyclables)	
Maximum quantity	less than 100,000 tonnes per year
Waste code	Description
water for industrial use	
19 12	wastes from the mechanical treatment of waste (for example sorting, crushing, compacting, pelletising) not otherwise specified
19 12 01	paper and cardboard
19 12 02	ferrous metal
19 12 03	non-ferrous metal
19 12 04	plastic and rubber
19 12 05	glass
19 12 07	wood other than that mentioned in 19 12 06
19 13	wastes from soil and groundwater remediation
19 13 02	solid wastes from soil remediation other than those mentioned in 19 13 01
20 Municipal wastes (household waste and similar commercial, industrial and institutional wastes) including separately collected fractions	
20 01	separately collected fractions (except 15 01)
20 01 01	paper and cardboard
20 01 02	glass
20 01 10	clothes
20 01 11	textiles
20 01 38	wood other than that mentioned in 20 01 37
20 01 39	plastics
20 01 40	metals
20 02	garden and park wastes (including cemetery waste)
20 02 01	biodegradable waste
20 02 02	soil and stones
20 03	other municipal wastes
20 03 01	mixed municipal waste
20 03 02	waste from markets

Schedule 3 – Emissions and monitoring

Emission point ref. & location	Source	Parameter	Limit (including unit)	Reference period	Monitoring frequency	Monitoring standard or method
A1 and A2: points A1 & A2 on site plan in Schedule 7	Biofilter	-	No limit set	-	-	-

Emission point ref. & location	Source	Parameter	Limit (incl. Unit)	Reference period	Monitoring frequency	Monitoring standard or method
Discharge to canal overflow to Sanderson Brook on approved drainage plan (refer Pre Op 01)	Uncontaminated site surface water drainage	-	-	-	-	-

Emission point reference or source or description of point of measurement	Parameter	Monitoring frequency	Monitoring standard or method	Other specifications
Biofilter at WTS – RDF building	Temperature	As required	Temperature probe	Biofilter shall be regularly checked and maintained to ensure appropriate temperature and moisture content.
Biofilter at WTS-Recycling building	Moisture	As required	None specified	
	Medium	As required	None specified	
WTS – RDF building & WTS-Recycling building & Outdoor storage area	Odour	Daily	Olfactory monitoring	Odour detection at the site boundary
Waste reception, handling and storage areas	Dust	Daily	visual assessment	dust detection at site boundary

Schedule 4 – Reporting

Parameters, for which reports shall be made, in accordance with conditions of this permit, are listed below.

Table S4.1 Reporting of monitoring data			
Parameter	Emission or monitoring point/reference	Reporting period	Period begins
No parameters set	-	-	-

Table S4.2: Annual production/treatment (Activity A1, table S1.1)	
Parameter	Units
RDF production	tonnes

Table S4.3 Performance parameters (Activity A1, table S1.1)		
Parameter	Frequency of assessment	Units
Water usage	Annually	m ³
Energy usage	Annually	MWh

Table S4.4 Reporting forms		
Media/parameter	Reporting format	Date of form
Air	Form air 1 or other form as agreed in writing by the Environment Agency	DD/MM/YY
Water usage	Form water usage 1 or other form as agreed in writing by the Environment Agency	DD/MM/YY
Energy usage	Form energy 1 or other form as agreed in writing by the Environment Agency	DD/MM/YY
Other performance indicators	Form performance 1 or other form as agreed in writing by the Environment Agency	DD/MM/YY

Schedule 5 – Notification

These pages outline the information that the operator must provide.

Units of measurement used in information supplied under Part A and B requirements shall be appropriate to the circumstances of the emission. Where appropriate, a comparison should be made of actual emissions and authorised emission limits.

If any information is considered commercially confidential, it should be separated from non-confidential information, supplied on a separate sheet and accompanied by an application for commercial confidentiality under the provisions of the EP Regulations.

Part A

Permit Number	
Name of operator	
Location of Facility	
Time and date of the detection	

(a) Notification requirements for any malfunction, breakdown or failure of equipment or techniques, accident, or emission of a substance not controlled by an emission limit which has caused, is causing or may cause significant pollution	
To be notified within 24 hours of detection	
Date and time of the event	
Reference or description of the location of the event	
Description of where any release into the environment took place	
Substances(s) potentially released	
Best estimate of the quantity or rate of release of substances	
Measures taken, or intended to be taken, to stop any emission	
Description of the failure or accident.	

(b) Notification requirements for the breach of a limit	
To be notified within 24 hours of detection unless otherwise specified below	
Emission point reference/ source	
Parameter(s)	
Limit	
Measured value and uncertainty	
Date and time of monitoring	
Measures taken, or intended to be taken, to stop the emission	

Time periods for notification following detection of a breach of a limit	
Parameter	Notification period

(c) Notification requirements for the detection of any significant adverse environmental effect	
To be notified within 24 hours of detection	
Description of where the effect on the environment was detected	
Substances(s) detected	
Concentrations of substances detected	
Date of monitoring/sampling	

Part B – to be submitted as soon as practicable

Any more accurate information on the matters for notification under Part A.	
Measures taken, or intended to be taken, to prevent a recurrence of the incident	
Measures taken, or intended to be taken, to rectify, limit or prevent any pollution of the environment which has been or may be caused by the emission	
The dates of any unauthorised emissions from the facility in the preceding 24 months.	

Name*	
Post	
Signature	
Date	

* authorised to sign on behalf of the operator

Schedule 6 – Interpretation

“accident” means an accident that may result in pollution.

“application” means the application for this permit, together with any additional information supplied by the operator as part of the application and any response to a notice served under Schedule 5 to the EP Regulations.

“authorised officer” means any person authorised by the Environment Agency under section 108(1) of The Environment Act 1995 to exercise, in accordance with the terms of any such authorisation, any power specified in section 108(4) of that Act.

“building” means a construction that has the objective of providing sheltering cover and minimising emissions of noise, particulate matter, odour and litter.

“disposal”. Means any of the operations provided for in Annex I to Directive 2008/98/EC of the European Parliament and of the Council on waste.

“emissions to land” includes emissions to groundwater.

“EP Regulations” means The Environmental Permitting (England and Wales) Regulations SI 2010 No.675 and words and expressions used in this permit which are also used in the Regulations have the same meanings as in those Regulations.

“emissions of substances not controlled by emission limits” means emissions of substances to air, water or land from the activities, either from the emission points specified in schedule 3 or from other localised or diffuse sources, which are not controlled by an emission limit.

“groundwater” means all water, which is below the surface of the ground in the saturation zone and in direct contact with the ground or subsoil.

“Hazardous property” has the meaning in Annex III of the Waste Framework Directive.

“Hazardous waste” has the meaning given in the Hazardous Waste (England and Wales) Regulations 2005 (as amended).

“impermeable surface” means a surface or pavement constructed and maintained to a standard sufficient to prevent the transmission of liquids beyond the pavement surface.

“Industrial Emissions Directive” means DIRECTIVE 2010/75/EU OF THE EUROPEAN PARLIAMENT AND OF THE COUNCIL of 24 November 2010 on industrial emissions

“List of Wastes” means the list of wastes established by Commission Decision 2000/532/EC replacing Decision 94/3/EC establishing a list of wastes pursuant to Article 1(a) of Council Directive 75/442/EEC on waste and Council Decision 94/904/EC establishing a list of hazardous waste pursuant to Article 1(4) of Council Directive 91/689/EEC on hazardous waste, as amended from time to time.

“MCERTS” means the Environment Agency’s Monitoring Certification Scheme.

“pests” means Birds, Vermin and Insects.

“quarter” means a calendar year quarter commencing on 1 January, 1 April, 1 July or 1 October.

“recovery” means any of the operations provided for in Annex II to Directive 2008/98/EC of the European Parliament and of the Council on waste.

“Waste code” means the six digit code referable to a type of waste in accordance with the List of Wastes and in relation to hazardous waste, includes the asterisk.

“Waste Framework Directive” or “WFD” means Waste Framework Directive 2008/98/EC of the European Parliament and of the Council on waste

Where a minimum limit is set for any emission parameter, for example pH, reference to exceeding the limit shall mean that the parameter shall not be less than that limit.

Unless otherwise stated, any references in this permit to concentrations of substances in emissions into air means:

- in relation to emissions from combustion processes, the concentration in dry air at a temperature of 273K, at a pressure of 101.3 kPa and with an oxygen content of 3% dry for liquid and gaseous fuels, 6% dry for solid fuels; and/or
- in relation to emissions from non-combustion sources, the concentration at a temperature of 273K and at a pressure of 101.3 kPa, with no correction for water vapour content.

“year” means calendar year ending 31 December.

When the following terms appear in the waste code list in Schedule 2, tables S2.2, S2.3 and S2.4 for that those tables, they have the meaning given below:

‘hazardous substance’ means a substance classified as hazardous as a consequence of fulfilling the criteria laid down in parts 2 to 5 of Annex I to Regulation (EC) No 1272/2008

‘heavy metal’ means any compound of antimony, arsenic, cadmium, chromium (VI), copper, lead, mercury, nickel, selenium, tellurium, thallium and tin, as well as these materials in metallic form, as far as these are classified as hazardous substances

DRAFT

Schedule 7 – Site plan

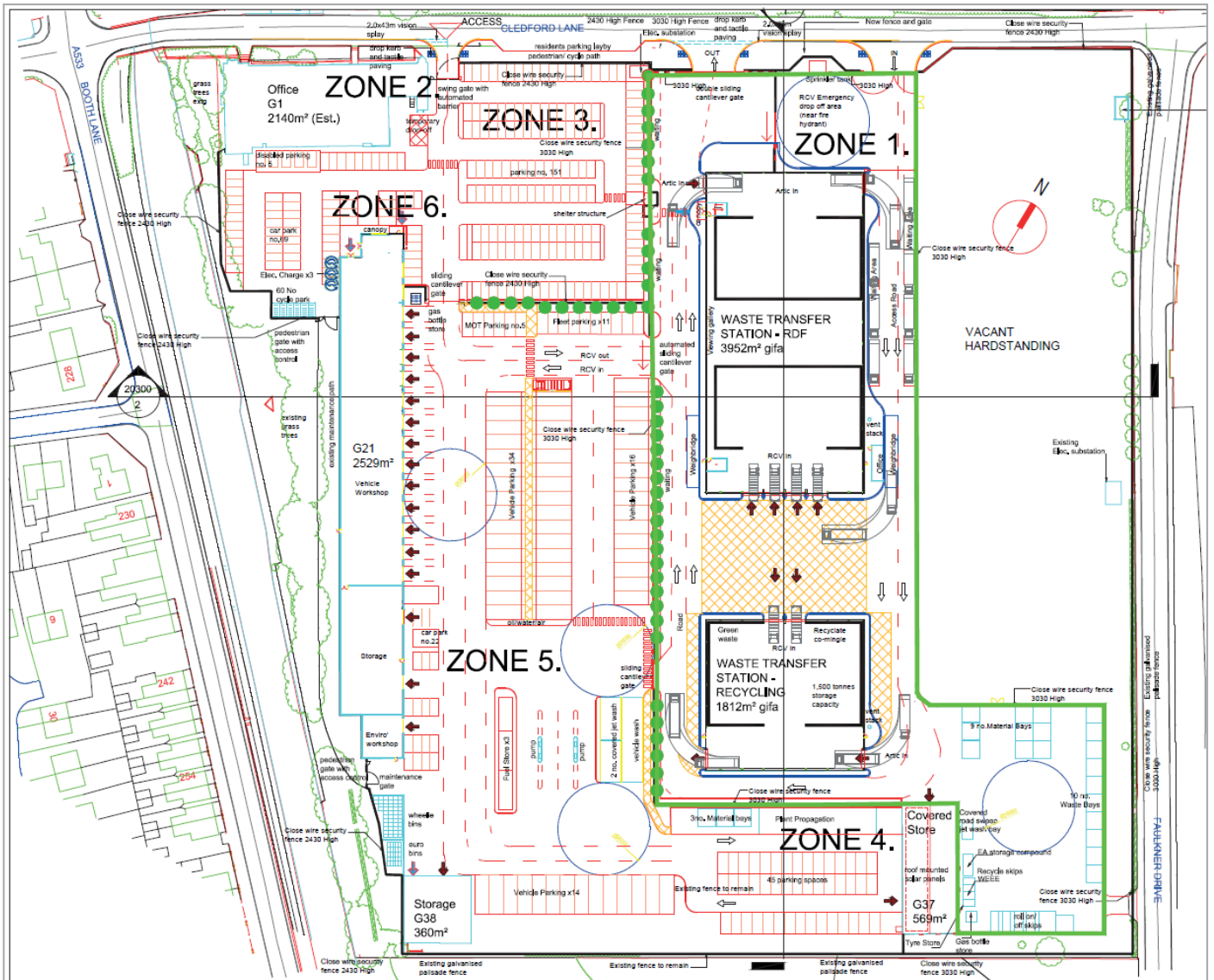

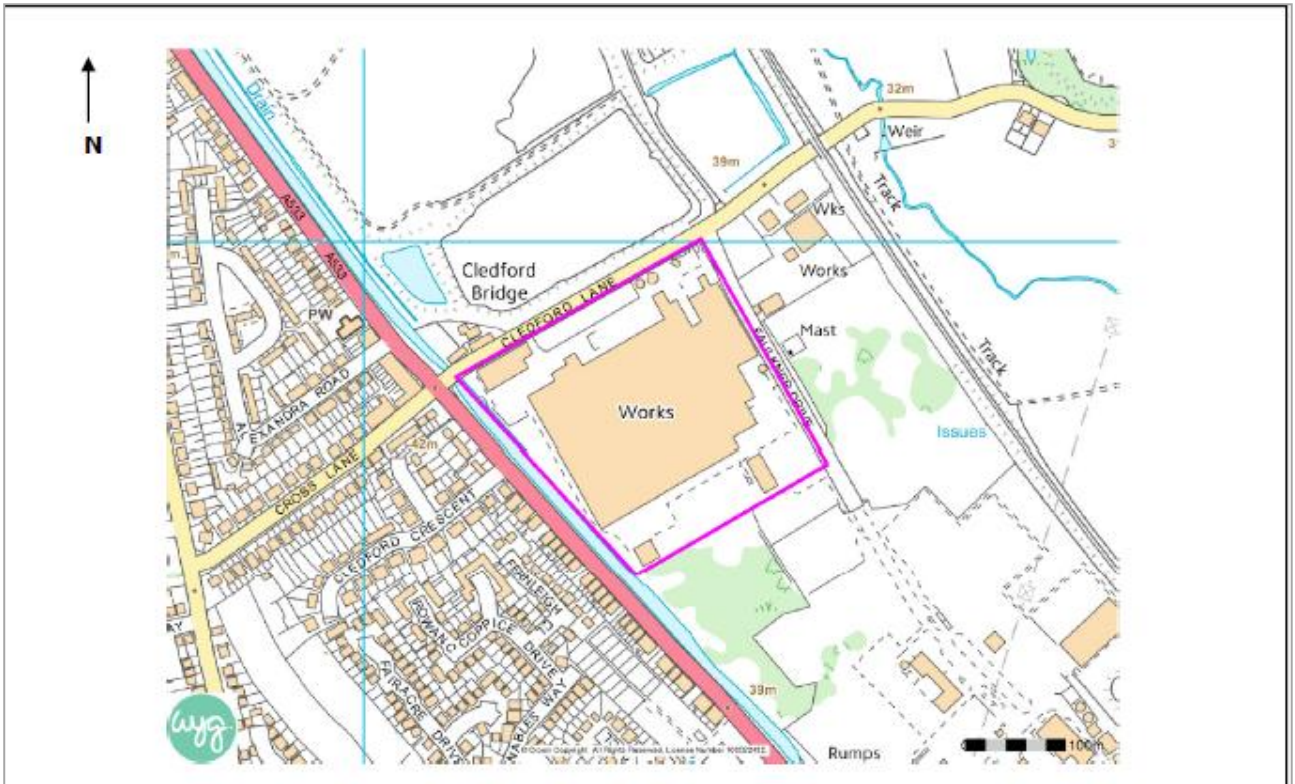

“©Crown Copyright. All rights reserved. Environment Agency, 100024198, 2016.”

END OF PERMIT

DRAFT