

NOTICE OF ORDER

HIGHWAYS ACT 1980 SECTION 26 & 119

London Borough Of Harrow

Harrow School Playing Fields Public Path Creation Order (No 1) 2013

Harrow School Playing Fields Public Path Creation Order (No 2) 2013

Harrow School Playing Fields (Footpath No 57) Diversion Order 2013

Harrow School Playing Fields (Footpath No 58) Diversion Order 2016

Notice is hereby given that the above referenced Orders have been submitted to the Secretary of State for Environment, Food and Rural Affairs for determination. An Inspector will be appointed by the Secretary of State to determine the OrderS.

The **start date** for the above Orders is **19 July 2016**.

Consideration of the Orders will take the form of a public local inquiry.

The Inquiry will be held at **Committee Rooms 1&2, Middlesex Floor, Civic Centre 1, Station Road, Harrow, HA1 2XY** on **17 January 2017** at 10.00am.

The effect of the Orders, if confirmed without modifications, will be to:-

(1) Create a public footpath from point C adjacent to the south east corner of the southernmost tennis courts in a north easterly direction for a distance of 110m to point D, then in a north east direction along the line of the brook for 92m to point F as shown on the Order Map

(2) Create a public footpath from point C adjacent to the south east corner of the southernmost tennis courts in a north easterly direction for a distance of 110m to point D, then north along the tarmac path for 60m to point E as shown on the Order Map

(57) Divert part of the line of footpath 57 running from point A in a south direction for a length of 326m to point B on the Order Map, onto a new line commencing from point A in a north-east direction along footpath 59 for a distance of 30m to point J then in a south direction adjacent to the tennis courts for a distance of 312m to point C, then in a south west direction for a distance of 91m to Point B as shown on the Order Map.

(58) Divert footpath 58 running from point A in a south easterly direction for a length of 482m to point G, onto a new line commencing from a point A in a north-east direction along footpath 59 for a distance of 166m to point H then in a southerly direction along the tarmac path for a distance of 236m to point E and then in an easterly direction for a distance of 240m to point G as shown on the Order Map.

Any queries relating to this Order should be referred to Clive Richards at The Planning Inspectorate, Rights of Way Section, Room 3/G Hawk Wing, Temple Quay House, 2 The Square, Temple Quay, Bristol, BS1 6PN. Telephone: 0303 444 5502. Email: clive.richards@pins.gsi.gov.uk. Please quote reference number FPS/M5450/6/1, 6/2, 4/1 & 4/3 on all correspondence.

Any person wishing to view the statements of case and other documents relating to this Order may do so by appointment at Access Harrow, Harrow Council, Civic Centre 1, Station Road, Harrow, HA1 2XF from 9am-5pm Monday-Friday. Council contact: Preetinder Cheema, Tel: 020 8416 8424.

Timetable for sending in statements of case and proofs of evidence

Within 8 weeks of the start date [by 13 September 2016]

The Order Making Authority must ensure their statement of case is received by the Secretary of State. As soon as possible after the deadline, the Secretary of State will send a copy (excluding copies of any supporting documents, although these will be available to view at the Authority's offices) to everyone who has made an objection or representation and the applicant and any other person who has written to us in respect of the Order.

Within 14 weeks of the start date [by 25 October 2016]

Everyone who has made an objection or representation and anyone who wishes to give evidence at the Inquiry must ensure their statement of case¹ is received by the Secretary of State. As soon as possible after the deadline, the Secretary of State will send copies to the Authority, the applicant, every person who has made an objection or representation and any other person who has written to us in respect of the Order (excluding copies of any supporting documents, although these will be available to view at the Authority's offices).

Within the same period the applicant (if applicable) must ensure their statement of case is received by the Secretary of State. As soon as possible after the deadline, the Secretary of State will send a copy to the Authority, everyone who has made an objection or representation and any other person who has written to us in respect of the Order (excluding copies of any supporting documents, although these will be available to view at the Authority's offices).

4 weeks before the date of the inquiry [by 20 December 2016]

The Authority, everyone who has made an objection or representation, the applicant (if applicable) and anyone who wishes to give evidence at the Inquiry must ensure their proof of evidence (together with any summary) is

¹ If you wish to make a legal submission, this should be submitted at the same time as your statement of case. Otherwise legal submissions will have to be submitted in writing on the day of the inquiry.

received by the Secretary of State. As soon as possible after the deadline, the Secretary of State will send copies of:

- i) the Authority's proof of evidence to everyone who has made an objection or representation, the applicant and anyone who has submitted a statement of case (excluding copies of any supporting documents – although none should be submitted with a proof of evidence);
- ii) the applicant's proof of evidence to the Authority, everyone who has made an objection or representation and anyone else who has submitted a statement of case (excluding copies of any supporting documents – although none should be submitted with a proof of evidence); and
- iii) all other proofs of evidence to the Authority, the applicant, everyone who has made an objection or representation and anyone else who has submitted a statement of case (excluding copies of any supporting documents – although none should be submitted with a proof of evidence).

All parties must keep to the timetable set out above and ensure that statements of case and proofs of evidence are received by the Secretary of State on time. Late documents will be returned.

We cannot accept any libellous, racist or abusive comments. Any documents containing such comments will be returned.

Notice of order for inquiry

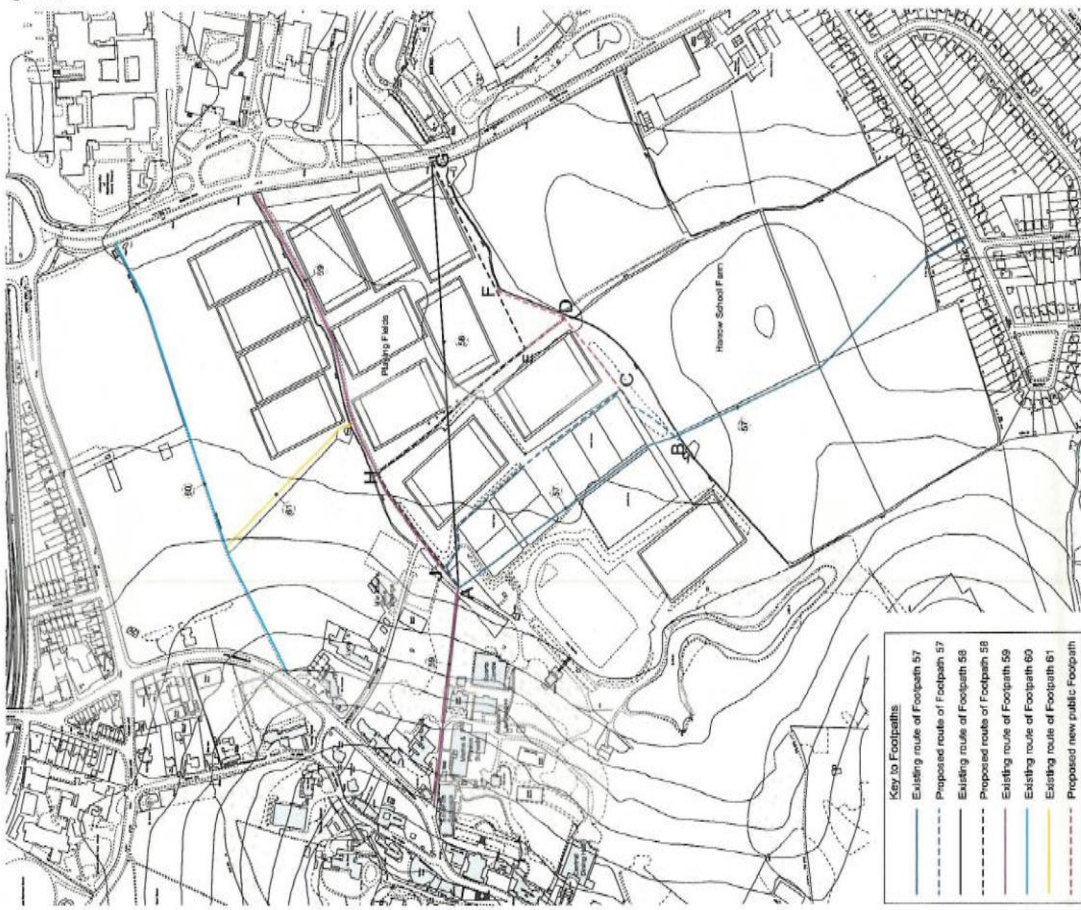

Key to Footpaths

	Existing route of Footpath 57
	Proposed route of Footpath 57
	Existing route of Footpath 58
	Proposed route of Footpath 58
	Existing route of Footpath 59
	Proposed route of Footpath 59
	Existing route of Footpath 60
	Proposed route of Footpath 60
	Existing route of Footpath 61
	Proposed new public footpath



MAP NOT TO ORIGINAL SCALE

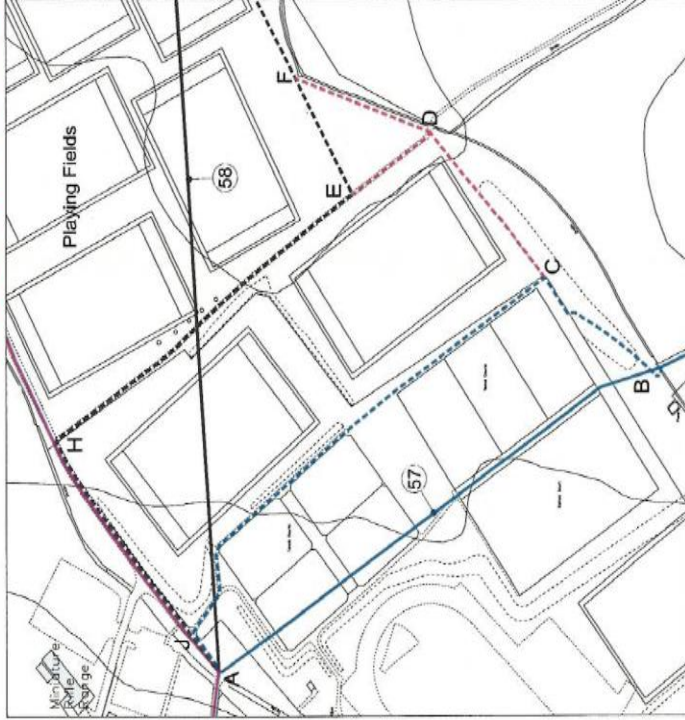

Note: Base details and features to be checked for accuracy



Harrow School Sports East
 Proposed diversion of no.s 57 & 58 Public
 Footpaths and creation of new public footpath
 14th August 2015

DATED 3 JULY 2013

**PUBLIC PATH CREATION ORDER
HIGHWAYS ACT 1980
LONDON BOROUGH OF HARROW
HARROW SCHOOL PLAYING FIELDS PUBLIC PATH CREATION ORDER (No.1) 2013**

HB Public Law
Civic Centre
Harrow
Middlesex
HA1 2UH

DX 30450 Harrow 3

Ref: EC-006705

PUBLIC PATH CREATION ORDER

HIGHWAYS ACT 1980

LONDON BOROUGH OF HARROW

HARROW SCHOOL PLAYING FIELDS PUBLIC PATH CREATION ORDER (No.1) 2013

THIS ORDER is made by the London Borough of Harrow ("the Council ") under section 26 of the Highways Act 1980 ("the 1980 Act") because it appears to the Council that, having regard to the matters set out in section 26(1), there is need for a public footpath over the land to which this Order relates, and that it is expedient that the path should be created.

BY THIS ORDER:

- 1 There shall be on the date of confirmation of this Order a public footpath over the land at Harrow School playing fields described in Part 1 of the Schedule to this Order and shown by a bold broken red line on the map attached to this Order.
- 2 The rights conferred on the public under this Order shall be subject to the limitations and conditions set out in Part 2 of the schedule.

SCHEDULE

Part 1

From point C adjacent to the south east corner of the southernmost tennis courts in an north easterly direction for a distance of 110m to point D, then in a north east direction along the line of the brook for 92m to point F as shown by a bold broken red line on the map attached to this Order.

Part 2

Limitations and conditions

None

Dated: 3 July 2013

THE COMMON SEAL OF THE MAYOR AND)
BURGESSES OF THE LONDON BOROUGH)
OF HARROW was hereunto affixed in the)
presence of)

Authorised Officer



DATED 3 JULY 2013

PUBLIC PATH CREATION ORDER
HIGHWAYS ACT 1980
LONDON BOROUGH OF HARROW
HARROW SCHOOL PLAYING FIELDS PUBLIC PATH CREATION ORDER (No.2) 2013

HB Public Law
Civic Centre
Harrow
Middlesex
HA1 2UH

DX 30450 Harrow 3

Ref: EC-006705

PUBLIC PATH CREATION ORDER

HIGHWAYS ACT 1980

LONDON BOROUGH OF HARROW

HARROW SCHOOL PLAYING FIELDS PUBLIC PATH CREATION ORDER (No.2) 2013

THIS ORDER is made by the London Borough of Harrow ("the Council ") under section 26 of the Highways Act 1980 ("the 1980 Act") because it appears to the Council that, having regard to the matters set out in section 26(1), there is need for a public footpath over the land to which this Order relates, and that it is expedient that the path should be created.

BY THIS ORDER:

- 1 There shall be on the date of confirmation of this Order a public footpath over the land at Harrow School playing fields described in Part 1 of the Schedule to this Order and shown by a bold broken red line on the map attached to this Order.
- 2 The rights conferred on the public under this Order shall be subject to the limitations and conditions set out in Part 2 of the schedule.

SCHEDULE

Part 1

From point C adjacent to the southeast corner of the southernmost tennis courts in a north easterly direction for a distance of 110m to point D, then north along the tarmac path for 60m to point E as shown by a bold broken red line on the map attached to this Order

Part 2

Limitations and conditions

None

Dated: 3 July 2013

THE COMMON SEAL OF THE MAYOR AND)
BURGESSES OF THE LONDON BOROUGH)
OF HARROW was hereunto affixed in the)
presence of)

Authorised Officer



DATED 3 JULY 2013

PUBLIC PATH DIVERSION ORDER
HIGHWAYS ACT 1980
LONDON BOROUGH OF HARROW
HARROW SCHOOL PLAYING FIELDS (FOOTPATH NO.57) DIVERSION ORDER 2013

HB Public Law
Civic Centre
Harrow
Middlesex
HA1 2UH

DX 30450 Harrow 3

Ref: EC-006705

PUBLIC PATH DIVERSION ORDER
HIGHWAYS ACT 1980
LONDON BOROUGH OF HARROW
HARROW SCHOOL PLAYING FIELDS (FOOTPATH NO.57) DIVERSION ORDER 2013

THIS ORDER is made by the London Borough of Harrow ("the Council ") under section 119 of the Highways Act 1980 ("the 1980 Act") because it appears to the Council that in the interests of the owner of the land crossed by the footpath described in paragraph 1 of the Order it is expedient that the line of the footpath should be diverted.

Harrow School has agreed to defray any compensation which becomes payable in consequence of the coming into force of this Order and any expenses which are incurred in bringing the new footpath into a fit condition for use by the public.

BY THIS ORDER

1. The public rights of way over the land situate at Harrow School playing fields and shown by a bold continuous blue line on the map attached to this Order and described in Part 1 of the Schedule to this Order shall be stopped up after 7 days from the date of confirmation of this Order.
2. Notwithstanding this Order the National Grid Gas, UK Power Networks, Thames Water and Affinity Water (or such other Statutory Undertaker as shall for the time being have statutory powers in that respect) shall have the following rights over the land referred to in paragraph 1 namely to open up the land referred to in paragraph 1 to install maintain or alter their apparatus and shall continue to have the same rights in respect of such apparatus as they had prior to the making of the Order.
3. There shall at the end of 7 days from the date of confirmation of this Order be a public footpath over the land situate at Harrow School playing fields described in Part 2 of the Schedule and shown by a bold broken blue line on the Map contained in this Order
4. The rights conferred on the public under this Order shall be subject to the limitations and conditions set out in Part 3 of the Schedule

THE SCHEDULE

PART 1

Description of part of the existing line of Footpath 57 to be stopped up

From point A running in a south direction for a length of 326 metres to point B shown by a continuous blue line on the map attached to this Order

PART 2

Description of new diverted path or way of part of Footpath 57

From point A in a north east direction along footpath 59 for a distance of 30m to point J, then in a south direction adjacent to the tennis courts for a distance of 312m to point C, then in a south west direction for a distance of 91m to Point B as shown with a bold broken blue line on the Order map

PART 3

Limitations and Conditions

None

Dated: 3 July 2013

THE COMMON SEAL OF THE MAYOR AND)
BURGESSES OF THE LONDON BOROUGH)
OF HARROW was hereunto affixed in the)
presence of)

Authorised Officer



DATED 7TH APRIL 2016

**PUBLIC PATH DIVERSION ORDER
HIGHWAYS ACT 1980
LONDON BOROUGH OF HARROW
HARROW SCHOOL PLAYING FIELDS (FOOTPATH NO. 58) DIVERSION ORDER 2016**

HB Public Law
Civic Centre
Harrow
Middlesex
HA1 2UH

DX 30450 Harrow 3

Ref: EC-006705

PUBLIC PATH DIVERSION ORDER

HIGHWAYS ACT 1980

LONDON BOROUGH OF HARROW

HARROW SCHOOL PLAYING FIELDS (FOOTPATH NO 58) DIVERSION ORDER 2016

THIS ORDER is made by the London Borough of Harrow ("the Council") under section 119 of the Highways Act 1980 ("the 1980 Act") because it appears to the Council that in the interests of the owner of the land crossed by the footpath described in paragraph 1 of the Order it is expedient that the line of the footpath should be diverted.

Harrow School has agreed to defray any compensation which becomes payable in consequence of the coming into force of this Order and any expenses which are incurred in bringing the new footpath into a fit condition for use by the public.

BY THIS ORDER

1. The public rights of way over the land situate at Harrow School playing fields and shown by a bold continuous dark grey line on the map attached to this Order and described in Part 1 of the Schedule to this Order shall be stopped up after 7 days from the date of confirmation of this Order.
2. Notwithstanding this Order the National Grid Gas, UK Power Networks, Thames Water and Affinity Water (or such other Statutory Undertaker as shall for the time being have statutory powers in that respect) shall have the following rights over the land referred to in paragraph 1 namely to open up the land referred to in paragraph 1 to install maintain or alter their apparatus and shall continue to have the same rights in respect of such apparatus as they had prior to the making of the Order.
3. There shall at the end of 7 days from the date of confirmation of this Order be a public footpath over the land situate at Harrow School playing fields described in Part 2 of the Schedule and shown by a bold broken dark grey line on the map attached to this Order
4. The rights conferred on the public under this Order shall be subject to the limitations and conditions set of in Part 3 of the Schedule

THE SCHEDULE

PART 1

Description of existing Footpath 58 to be stopped up

From point A running in a south easterly direction for a length of 482 metres to point G shown by a continuous dark grey line on the map attached to this Order

PART 2

Description of new diverted path or way of Footpath 58

From point A in a north-easterly direction along footpath 59 for a distance of 166 metres to point H then in a southerly direction along the tarmac path for a distance of 236 metres to point E and then in an easterly direction for a distance of 240 metres to point G as shown with a bold broken dark grey line on the Order map

PART 3

Limitations and Conditions

None

Dated: 7TH APRIL 2016

THE COMMON SEAL OF THE MAYOR AND)
BURGESSES OF THE LONDON BOROUGH)
OF HARROW was hereunto affixed)
in the presence of: -)

Authorised Officer: - *Smceleg-*

