

# Permit with introductory note

## The Environmental Permitting (England & Wales) Regulations 2010

---

Mick George Limited

Great Billing II Waste Transfer Station  
Lower Ecton Lane  
Great Billing  
Northampton  
NN3 5HQ

### **Permit number**

EPR/SP3935AX

# Great Billing II Waste Transfer Station

## Permit number EPR/SP3935AX

### Introductory note

#### This introductory note does not form a part of the permit

The main features of the permit are as follows.

The permitted facility is a hazardous and non-hazardous waste treatment and transfer facility. The specific waste storage and treatment activities undertaken at the facilities are:

- Storage and transfer of hazardous wastes (waste electronic and electrical equipment (WEEE), clinical waste and asbestos)
- Storage and treatment of non-hazardous waste for the purpose of recovery (including screening, crushing, sorting, shredding and baling)
- Storage and transfer of non-hazardous waste for recovery or disposal

The storage and transfer of hazardous wastes is an activity listed under Section 5.6 Part A(1), Schedule 1 of the Environmental Permitting Regulations. The storage, treatment and transfer of non-hazardous wastes are unlisted waste operation activities. The treatment of non-hazardous wastes is undertaken for the purpose of recovery only.

The facility has no point source emissions to air or sewer. The site includes a septic tank for domestic sewage. The facility has one point source emission of uncontaminated surface water (rainwater) to Ecton Brook, which runs along the northern boundary of the site. This discharge is made via a storm water attenuation pond which is provided with an oil interceptor and a penstock valve.

The facility is located to the east of Northampton, to the south-east of Great Billing and south of the A45 and Lower Ecton Lane. Ecton village lies approximately 1.2km to the north-east of the facility. A sewage treatment works is located to the south-west of the facility. To the south are open fields, sand and gravel works and the River Nene.

The closest sensitive human receptors are a caravan park (approximately 160m to the west of the facility), Ecton Brook Primary School (approximately 220m to the north-west), and residential properties that lie beyond the school (approximately 270m to the north-west).

There is one designed Special Protection Area (SPA) and Ramsar Habitat Site (Upper Nene Valley Gravel Pits) within 10km of the facility. The facility lies between two separate designated areas of the Upper Nene Valley Gravel Pits; approximately 2.5km to the north-east of one area and 4.2km to the west of the other. There is also one local nature reserve and seven local wildlife sites within 2km of the facility.

The facility will be managed in accordance with an Environmental Management System certified to ISO 14001, OHSAS 18001 and ISO 9001 standards.

The status log of the permit sets out the permitting history, including any changes to the permit reference number.

Status log of the permit		
Description	Date	Comments
Application EPR/SP3935AX/A001	Duly made 27/05/2015	Application for hazardous and non-hazardous waste treatment and transfer facility
Additional information received	16/09/2015	Response to Schedule 5 Notice 1 dated 04/08/2015
Additional information received	04/12/2015	Response to Schedule 5 Notice 2 dated 15/10/2015

<b>Status log of the permit</b>		
<b>Description</b>	<b>Date</b>	<b>Comments</b>
Additional information received	15/01/2016	Response to Request For Information dated 17/12/2015
Permit determined EPR/SP3935AX (Billing ref. SP3935AX)	01/02/2016	Permit issued to Mick George Limited

End of introductory note

# Permit

## The Environmental Permitting (England and Wales) Regulations 2010

### Permit number

**EPR/SP3935AX**

The Environment Agency hereby authorises, under regulation 13 of the Environmental Permitting (England and Wales) Regulations 2010

**Mick George Limited** (“the operator”),

whose registered office is

**Mick George Limited**  
**6 Lancaster Way**  
**Ermine Business Park**  
**Huntingdon**  
**Cambridgeshire**  
**PE29 6XU**

company registration number 02417831

to operate an installation and waste operations at

**Great Billing II Waste Transfer Station**  
**Lower Ecton Lane**  
**Great Billing**  
**Northampton**  
**NN3 5HQ**

to the extent authorised by and subject to the conditions of this permit.

Name	Date
Claire Roberts	01/02/2016

Authorised on behalf of the Environment Agency

# Conditions

## 1 Management

### 1.1 General management

- 1.1.1 The operator shall manage and operate the activities:
- (a) in accordance with a written management system that identifies and minimises risks of pollution, including those arising from operations, maintenance, accidents, incidents, non-conformances, closure and those drawn to the attention of the operator as a result of complaints; and
  - (b) using sufficient competent persons and resources.
- 1.1.2 Records demonstrating compliance with condition 1.1.1 shall be maintained.
- 1.1.3 Any person having duties that are or may be affected by the matters set out in this permit shall have convenient access to a copy of it kept at or near the place where those duties are carried out.
- 1.1.4 The operator shall comply with the requirements of an approved competence scheme.

### 1.2 Energy efficiency

- 1.2.1 For the following activities referenced in schedule 1, table S1.1 (A1 to A4) the operator shall:
- (a) take appropriate measures to ensure that energy is used efficiently in the activities;
  - (b) review and record at least every four years whether there are suitable opportunities to improve the energy efficiency of the activities; and
  - (c) take any further appropriate measures identified by a review.

### 1.3 Efficient use of raw materials

- 1.3.1 For the following activities referenced in schedule 1, table S1.1 (A1 to A4) the operator shall:
- (a) take appropriate measures to ensure that raw materials and water are used efficiently in the activities;
  - (b) maintain records of raw materials and water used in the activities;
  - (c) review and record at least every four years whether there are suitable alternative materials that could reduce environmental impact or opportunities to improve the efficiency of raw material and water use; and
  - (d) take any further appropriate measures identified by a review.

### 1.4 Avoidance, recovery and disposal of wastes produced by the activities

- 1.4.1 The operator shall take appropriate measures to ensure that:
- (a) the waste hierarchy referred to in Article 4 of the Waste Framework Directive is applied to the generation of waste by the activities; and
  - (b) any waste generated by the activities is treated in accordance with the waste hierarchy referred to in Article 4 of the Waste Framework Directive; and
  - (c) where disposal is necessary, this is undertaken in a manner which minimises its impact on the environment.

- 1.4.2 The operator shall review and record at least every four years whether changes to those measures should be made and take any further appropriate measures identified by a review.

## **2 Operations**

### **2.1 Permitted activities**

- 2.1.1 The operator is only authorised to carry out the activities specified in schedule 1 table S1.1 (the “activities”).
- 2.1.2 For the following activities referenced in schedule 1, table S1.1 (A1 to A4) waste authorised by this permit shall be clearly distinguished from any other waste on the site.

### **2.2 The site**

- 2.2.1 The activities shall not extend beyond the site, being the land shown edged in green on the site plan at schedule 7 to this permit.

### **2.3 Operating techniques**

- 2.3.1 The activities shall, subject to the conditions of this permit, be operated using the techniques and in the manner described in the documentation specified in schedule 1, table S1.2, unless otherwise agreed in writing by the Environment Agency.
- 2.3.2 If notified by the Environment Agency that the activities are giving rise to pollution, the operator shall submit to the Environment Agency for approval within the period specified, a revision of any plan or other documentation (“plan”) specified in schedule 1, table S1.2 or otherwise required under this permit which identifies and minimises the risks of pollution relevant to that plan, and shall implement the approved revised plan in place of the original from the date of approval, unless otherwise agreed in writing by the Environment Agency.
- 2.3.3 Any raw materials or fuels listed in schedule 2 table S2.1 shall conform to the specifications set out in that table.
- 2.3.4 Waste shall only be accepted if:
- (a) it is of a type and quantity listed in schedule 2 tables S2.2 and S2.3; and
  - (b) it conforms to the description in the documentation supplied by the producer and holder.
- 2.3.5 The operator shall ensure that where waste produced by the activities is sent to a relevant waste operation, that operation is provided with the following information, prior to the receipt of the waste:
- (a) the nature of the process producing the waste;
  - (b) the composition of the waste;
  - (c) the handling requirements of the waste;
  - (d) the hazardous property associated with the waste, if applicable; and
  - (e) the waste code of the waste.
- 2.3.6 The operator shall ensure that where waste produced by the activities is sent to a landfill site, it meets the waste acceptance criteria for that landfill.

### **Hazardous waste storage and treatment**

- 2.3.7 Hazardous waste shall not be mixed, either with a different category of hazardous waste or with other waste, substances or materials, unless it is authorised by schedule 1 table S1.1 and appropriate measures are taken.

## **2.4 Pre-operational conditions**

- 2.4.1 The activities shall not be brought into operation until the measures specified in schedule 1 table S1.4 have been completed.

## **3 Emissions and monitoring**

### **3.1 Emissions to water, air or land**

- 3.1.1 There shall be no point source emissions to water, air or land except from the sources and emission points listed in schedule 3 table S3.1.
- 3.1.2 The limits given in schedule 3 shall not be exceeded.
- 3.1.3 Periodic monitoring shall be carried out at least once every 5 years for groundwater and 10 years for soil, unless such monitoring is based on a systematic appraisal of the risk of contamination.

### **3.2 Emissions of substances not controlled by emission limits**

- 3.2.1 Emissions of substances not controlled by emission limits (excluding odour) shall not cause pollution. The operator shall not be taken to have breached this condition if appropriate measures, including, but not limited to, those specified in any approved emissions management plan, have been taken to prevent or where that is not practicable, to minimise, those emissions.
- 3.2.2 The operator shall:
- (a) if notified by the Environment Agency that the activities are giving rise to pollution, submit to the Environment Agency for approval within the period specified, an emissions management plan which identifies and minimises the risks of pollution from emissions of substances not controlled by emission limits;
  - (b) implement the approved emissions management plan, from the date of approval, unless otherwise agreed in writing by the Environment Agency.
- 3.2.3 All liquids in containers, whose emission to water or land could cause pollution, shall be provided with secondary containment, unless the operator has used other appropriate measures to prevent or where that is not practicable, to minimise, leakage and spillage from the primary container.

### **3.3 Odour**

- 3.3.1 Emissions from the activities shall be free from odour at levels likely to cause pollution outside the site, as perceived by an authorised officer of the Environment Agency, unless the operator has used appropriate measures, including, but not limited to, those specified in any approved odour management plan, to prevent or where that is not practicable to minimise the odour.

### **3.4 Noise and vibration**

- 3.4.1 Emissions from the activities shall be free from noise and vibration at levels likely to cause pollution outside the site, as perceived by an authorised officer of the Environment Agency, unless the operator has used appropriate measures, including, but not limited to, those specified in any approved noise and vibration management plan to prevent or where that is not practicable to minimise the noise and vibration.
- 3.4.2 The operator shall:
- (a) if notified by the Environment Agency that the activities are giving rise to pollution outside the site due to noise and vibration, submit to the Environment Agency for approval within the period

specified, a noise and vibration management plan which identifies and minimises the risks of pollution from noise and vibration;

- (b) implement the approved noise and vibration management plan, from the date of approval, unless otherwise agreed in writing by the Environment Agency.

### **3.5 Pests**

3.5.1 The activities shall not give rise to the presence of pests which are likely to cause pollution, hazard or annoyance outside the boundary of the site. The operator shall not be taken to have breached this condition if appropriate measures, including, but not limited to, those specified in any approved pests management plan, have been taken to prevent or where that is not practicable, to minimise the presence of pests on the site.

3.5.2 The operator shall:

- (a) if notified by the Environment Agency, submit to the Environment Agency for approval within the period specified, a pests management plan which identifies and minimises risks of pollution from pests;
- (b) implement the pests management plan, from the date of approval, unless otherwise agreed in writing by the Environment Agency.

### **3.6 Fire prevention**

3.6.1 The operator shall take all appropriate measures to prevent fires on site and minimise the risk of pollution from them including, but not limited to, those specified in any approved fire prevention plan.

## **4 Information**

### **4.1 Records**

4.1.1 All records required to be made by this permit shall:

- (a) be legible;
- (b) be made as soon as reasonably practicable;
- (c) if amended, be amended in such a way that the original and any subsequent amendments remain legible, or are capable of retrieval; and
- (d) be retained, unless otherwise agreed in writing by the Environment Agency, for at least 6 years from the date when the records were made, or in the case of the following records until permit surrender:
  - (i) off-site environmental effects; and
  - (ii) matters which affect the condition of the land and groundwater.

4.1.2 The operator shall keep on site all records, plans and the management system required to be maintained by this permit, unless otherwise agreed in writing by the Environment Agency.

### **4.2 Reporting**

4.2.1 The operator shall send all reports and notifications required by the permit to the Environment Agency using the contact details supplied in writing by the Environment Agency.

4.2.2 For the following activities referenced in schedule 1, table S1.1 (A1 to A4) a report or reports on the performance of the activities over the previous year shall be submitted to the Environment Agency by



31 January (or other date agreed in writing by the Environment Agency) each year. The report(s) shall include as a minimum:

- (a) a review of the results of the monitoring and assessment carried out in accordance with the permit including an interpretive review of that data;
- (b) the performance parameters set out in schedule 4 table S4.1 using the forms specified in table S4.2 of that schedule.

4.2.3 For the following activities referenced in schedule 1, table S1.1 (A1 to A4) the operator shall, unless notice under this condition has been served within the preceding four years, submit to the Environment Agency, within six months of receipt of a written notice, a report assessing whether there are other appropriate measures that could be taken to prevent, or where that is not practicable, to minimise pollution.

4.2.4 Within 1 month of the end of each quarter, the operator shall submit to the Environment Agency using the form made available for the purpose, the information specified on the form relating to the site and the waste accepted and removed from it during the previous quarter.

### **4.3 Notifications**

4.3.1 In the event:

- (a) that the operation of the activities gives rise to an incident or accident which significantly affects or may significantly affect the environment, the operator must immediately—
  - (i) inform the Environment Agency,
  - (ii) take the measures necessary to limit the environmental consequences of such an incident or accident, and
  - (iii) take the measures necessary to prevent further possible incidents or accidents;
- (b) of a breach of any permit condition the operator must immediately—
  - (i) inform the Environment Agency, and
  - (ii) take the measures necessary to ensure that compliance is restored within the shortest possible time;
- (c) of a breach of permit condition which poses an immediate danger to human health or threatens to cause an immediate significant adverse effect on the environment, the operator must immediately suspend the operation of the activities or the relevant part of it until compliance with the permit conditions has been restored.

4.3.2 Any information provided under condition 4.3.1 (a)(i), or 4.3.1 (b)(i) where the information relates to the breach of a limit specified in the permit, shall be confirmed by sending the information listed in schedule 5 to this permit within the time period specified in that schedule.

4.3.3 Where the Environment Agency has requested in writing that it shall be notified when the operator is to undertake monitoring and/or spot sampling, the operator shall inform the Environment Agency when the relevant monitoring and/or spot sampling is to take place. The operator shall provide this information to the Environment Agency at least 14 days before the date the monitoring is to be undertaken.

4.3.4 The Environment Agency shall be notified within 14 days of the occurrence of the following matters, except where such disclosure is prohibited by Stock Exchange rules:

Where the operator is a registered company:

- (a) any change in the operator's trading name, registered name or registered office address; and
- (b) any steps taken with a view to the operator going into administration, entering into a company voluntary arrangement or being wound up.

Where the operator is a corporate body other than a registered company:

- (a) any change in the operator's name or address; and
- (b) any steps taken with a view to the dissolution of the operator.

In any other case:

- (a) the death of any of the named operators (where the operator consists of more than one named individual);
- (b) any change in the operator's name(s) or address(es); and
- (c) any steps taken with a view to the operator, or any one of them, going into bankruptcy, entering into a composition or arrangement with creditors, or, in the case of them being in a partnership, dissolving the partnership.

4.3.5 Where the operator proposes to make a change in the nature or functioning, or an extension of the activities, which may have consequences for the environment and the change is not otherwise the subject of an application for approval under the Regulations or this permit:

- (a) the Environment Agency shall be notified at least 14 days before making the change; and
- (b) the notification shall contain a description of the proposed change in operation.

4.3.6 The Environment Agency shall be given at least 14 days notice before implementation of any part of the site closure plan.

## **4.4 Interpretation**

4.4.1 In this permit the expressions listed in schedule 6 shall have the meaning given in that schedule.

4.4.2 In this permit references to reports and notifications mean written reports and notifications, except where reference is made to notification being made "immediately", in which case it may be provided by telephone.

# Schedule 1 – Operations

Table S1.1 activities			
Activity reference	Activity listed in Schedule 1 of the EP Regulations	Description of specified activity and WFD Annex I and II operations	Limits of specified activity and waste types
A1	5.6 A(1)(a) Temporary storage of hazardous waste with a total capacity exceeding 50 tonnes	<p>Temporary storage of hazardous waste –</p> <p>R13: Storage of waste pending any of the operations numbered R 1 to R 12 (excluding temporary storage, pending collection, on the site where the waste is produced)</p> <p>D15: Storage pending any of the operations numbered D 1 to D 14 (excluding temporary storage, pending collection, on the site where the waste is produced)</p>	<p>Waste types and quantities as specified in Table S2.2.</p> <p>Maximum storage capacities (at any one time) apply for the following wastes types:</p> <p>Asbestos - maximum 30 tonnes.</p> <p>Clinical - maximum 20 tonnes.</p> <p>WEEE - maximum 100 tonnes.</p> <p>Waste shall only be stored in an area of the site provided with an impermeable surface and sealed drainage system.</p> <p>Hazardous clinical waste shall be stored for onward transfer in lockable rigid leak proof containers.</p>
<b>Directly Associated Activity</b>			
A2	Storage of fuel oil	On-site storage of fuel oil for use in site plant and equipment.	Storage of oil in bunded 2000 litre double skinned tank.
A3	Surface water management	Management of uncontaminated surface water and roof water and associated site infrastructure.	Collection, storage and discharge of uncontaminated surface water and roof water to Ecton Beck via site drainage system and collection pond.
A4	Wastewater management	Management of contaminated surface water and associated infrastructure.	Collection, storage and disposal of contaminated surface waters from site buildings and external areas.
Activity reference	Description of activities for waste operations	Limits of activities	
A5	<p>Non-hazardous waste transfer station, including treatment.</p> <p>R13: Storage of waste pending any of the operations numbered R1 to R12 (excluding temporary storage, pending collection, on the site where it is produced)</p>	<p>Treatment operations shall be limited to: Physical treatment including screening, crushing, sorting, shredding and baling for the purpose of recovery.</p> <p>Waste types as specified in Table 2.3.</p> <p>Excluding liquid waste, dusty and highly</p>	

<b>Table S1.1 activities</b>		
	<p>R3: Recycling/reclamation of organic substances which are not used as solvents</p> <p>R4: Recycling/reclamation of metals and metal compounds</p> <p>R5: Recycling/reclamation of other inorganic compounds</p> <p>D15: Storage of waste pending any of the operations numbered D1 to D14 (excluding temporary storage, pending collection, on the site where it is produced)</p>	<p>odorous wastes.</p> <p>Maximum of 9700 tonnes of non-hazardous waste stored on site at any one time.</p> <p>Maximum storage capacities (at any one time) apply for the following wastes types:</p> <p>Waste wood – 250 tonnes</p> <p>Green waste – 100 tonnes</p> <p>Mixed non-hazardous waste awaiting processing – 1080 tonnes</p> <p>Plasterboard &amp; gypsum wastes – 100 tonnes</p> <p>Scrap metal – 250 tonnes</p> <p>Hardcore – 5000 tonnes</p> <p>Soil – 2000 tonnes</p> <p>Non-hazardous clinical wastes – 20 tonnes</p> <p>Gypsum and non-hazardous clinical wastes are to be accepted for storage and transfer only, without treatment.</p> <p>Waste soils and aggregates stored on site must be segregated from any non-waste soils or aggregate materials, in separate clearly designated areas or bays.</p>

<b>Table S1.2 Operating techniques</b>		
<b>Description</b>	<b>Parts</b>	<b>Date Received</b>
Application	Responses to Section 3a – technical standards and Appendix 5 to Part B3 of the application form, detailed in Sections 4.2, 4.3 and 4.4 of the application documents, excluding parts concerning the acceptance, storage and treatment of hazardous waste soils by bioremediation.	27/05/2015
Application	Response to Not Duly Made letter dated 30/04/2015 regarding the acceptance, storage and handling of clinical waste.	13/05/2015
Application	Odour management plan	04/12/2015
Application	Fire Prevention Plan	15/01/2016
Response to Schedule 5 Notice dated 04/08/2015	Responses to points 3 h), i), j), k), l), n) 4 e), f), i); 6 i), k), l)	16/09/2015
Response to Schedule 5 Notice dated 15/10/2015	Responses to points 3 f); 5 g), h), j); 6 b), j)	04/12/2015

<b>Table S1.4 Pre-operational measures</b>	
<b>Reference</b>	<b>Pre-operational measures</b>
IP1	The site shall be provided with an appropriate engineered sealed drainage system, which ensures that potentially contaminated drainage from waste storage, handling and treatment areas will be contained on-site and only clean rain water and surface water will be discharged to the storm water pond and surface water. The sealed drainage system shall be designed and constructed to an appropriate engineering standard in accordance with the requirements of Sector Guidance Note S5.06 Guidance for the Recovery and Disposal of Hazardous and Non Hazardous Waste, Additional guidance for Clinical Waste (EPR 5.07) and CIRIA C736 Containment Systems for the Prevention of Pollution. The operator shall submit to the Environment Agency for approval an updated site drainage plan and written report detailing the sealed drainage system(s) that will be provided at the facility, including details of its construction.
IP2	The operator shall submit to the Environment Agency for approval waste pre-acceptance and acceptance procedures, and any associated procedures contained within the facility's Environmental Management System, in accordance with Section 2.1.1 and 2.1.2 of S5.06. The procedures shall detail how potentially odorous wastes will be identified and managed appropriately through the processes of waste pre-acceptance, acceptance and rejection.
IP3	The operator shall collect additional baseline reference data for the site of the regulated facility in order to establish existing ground conditions and identify any historical contamination. This shall contain a full suite of analysis including metals & sulphates.
IP4	The operator shall review and update the facility's Application Site Report to ensure that it details the activities that the facility is permitted to undertake, the wastes it is permitted to accept and the site containment measures provided at the facility, specifically the site drainage and containment agreed through Pre-Operational Condition IP1. The Site Report shall also be updated with the baseline data collected through Pre-Operational Condition IP3.
IP5	The operator shall review and update the Odour Management Plan (OMP) to ensure that it only includes the activities that the facility is permitted to undertake and the waste types that it is permitted to accept. The OMP shall detail the odour prevention and control measures that will be employed at the facility for these activities and wastes. The OMP shall detail odour monitoring (sniff tests) undertaken by trained staff as part of routine daily site inspections. The odour management plan shall also specify the criteria and associated action levels that monitoring results for material temperature and moisture content will be assessed against. The updated OMP shall be submitted to the Environment Agency for approval.
IP6	The operator shall submit to the Environment Agency for approval a written copy of the inspection and preventative maintenance plan that forms part of the facility's environmental management system, in accordance with the requirements of How to comply with your environmental permit (Part 1) and Section 2.3 of S5.06. The plan shall cover all relevant plant and infrastructure, whose failure could lead to an impact on the environment, including buildings, bays, tanks, surfacing, pipework, bunds and drainage systems.

## Schedule 2 – Waste types, raw materials and fuels

Raw materials and fuel description	Specification
-	-

Maximum quantity	Annual throughput 1,000 tonnes WEEE waste; 5,000 tonnes clinical waste; 5,000 tonnes asbestos waste. Additional limits on waste are set in Table S1.1.
Waste code	Description
<b>06</b>	<b>Wastes from inorganic chemical processes</b>
<b>06 07</b>	<b>wastes from the MFSU of halogens and halogen chemical processes</b>
06 07 01*	wastes containing asbestos from electrolysis
<b>06 13</b>	<b>wastes from inorganic chemical processes not otherwise specified</b>
06 13 04*	wastes from asbestos processing
<b>10 13</b>	<b>wastes from manufacture of cement, lime and plaster and articles and products made from them</b>
10 13 09*	wastes from asbestos-cement manufacture containing asbestos
<b>15</b>	<b>Waste packaging, absorbents, wiping cloths, filter materials and protective clothing not otherwise specified</b>
<b>15 01</b>	<b>packaging (including separately collected municipal packaging waste)</b>
15 01 11*	metallic packaging containing a hazardous solid porous matrix (for example asbestos), including empty pressure containers
<b>16</b>	<b>Wastes not otherwise specified in the list</b>
<b>16 01</b>	<b>end-of-life vehicles from different means of transport (including off-road machinery) and wastes from dismantling of end-of-life vehicles and vehicle maintenance (except 13, 14, 16 06 and 16 08)</b>
16 01 11*	brake pads containing asbestos
<b>16 02</b>	<b>wastes from electrical and electronic equipment</b>
16 02 09*	transformers and capacitors containing PCBs
16 02 10*	discarded equipment containing or contaminated by PCBs other than those mentioned in 16 02 09
16 02 11*	discarded equipment containing chlorofluorocarbons, HCFC, HFC
16 02 12*	discarded equipment containing free asbestos
16 02 13*	discarded equipment containing hazardous components other than those mentioned in 16 02 09 to 16 02 12
16 02 15*	hazardous components removed from discarded equipment
<b>20</b>	<b>Municipal wastes (household waste and similar commercial, industrial and institutional wastes) including separately collected fractions</b>
<b>20 01</b>	<b>separately collected fractions (except 15 01)</b>
20 01 35*	discarded electrical and electronic equipment other than those mentioned in 20 01

<b>Table S2.2 Permitted waste types and quantities for hazardous waste storage and transfer</b>	
<b>Maximum quantity</b>	Annual throughput 1,000 tonnes WEEE waste; 5,000 tonnes clinical waste; 5,000 tonnes asbestos waste. Additional limits on waste are set in Table S1.1.
<b>Waste code</b>	<b>Description</b>
	21 and 20 01 23 containing hazardous components
<b>17</b>	<b>Construction and demolition wastes (including excavated soil from contaminated sites)</b>
<b>17 06</b>	<b>insulation materials and asbestos-containing construction materials</b>
17 06 01*	insulation materials containing asbestos
17 06 05*	construction materials containing asbestos
<b>18</b>	<b>Wastes from human or animal health care and/or related research (except kitchen and restaurant wastes not arising from immediate health care)</b>
<b>18 01</b>	<b>wastes from natal care, diagnosis, treatment or prevention of disease in humans</b>
18 01 03*	wastes whose collection and disposal is subject to special requirements in order to prevent infection
18 01 08*	cytotoxic and cytostatic medicines
18 01 10*	amalgam waste from dental care
<b>18 02</b>	<b>wastes from research, diagnosis, treatment or prevention of disease involving animals</b>
18 02 02*	wastes whose collection and disposal is subject to special requirements in order to prevent infection
18 02 05*	chemicals consisting of or containing dangerous substances
18 02 07*	cytotoxic and cytostatic medicines

<b>Table S2.3 Permitted waste types and quantities for non-hazardous waste storage, treatment and transfer</b>	
<b>Maximum quantity</b>	Annual throughput of 339,000 tonnes. Additional limits on waste are set in Table S1.1.
<b>Waste code</b>	<b>Description</b>
<b>01</b>	<b>Wastes resulting from exploration, mining, quarrying, and physical and chemical treatment of minerals</b>
<b>01 01</b>	<b>wastes from mineral excavation</b>
01 01 01	wastes from mineral metalliferous excavation
01 01 02	wastes from mineral non-metalliferous excavation
<b>01 03</b>	<b>wastes from physical and chemical processing of metalliferous minerals</b>
01 03 06	tailings other than those mentioned in 01 03 04 and 01 03 05
01 03 09	red mud from alumina production other than the wastes mentioned in 01 03 10
<b>01 04</b>	<b>wastes from physical and chemical processing of non-metalliferous minerals</b>
01 04 08	waste gravel and crushed rocks other than those mentioned in 01 04 07
01 04 11	wastes from potash and rock salt processing other than those mentioned in 01 04 07
01 04 12	tailings and other wastes from washing and cleaning of minerals other than those mentioned in 01 04 07 and 01 04 11

01 04 13	wastes from stone cutting and sawing other than those mentioned in 01 04 07
<b>01 05</b>	<b>drilling muds and other drilling wastes</b>
01 05 04	freshwater drilling muds and wastes
01 05 07	barite-containing drilling muds and wastes other than those mentioned in 01 05 05 and 01 05 06
01 05 08	chloride-containing drilling muds and wastes other than those mentioned in 01 05 05 and 01 05 06
<b>02</b>	<b>Wastes from agriculture, horticulture, aquaculture, forestry, hunting and fishing, food preparation and processing</b>
<b>02 01</b>	<b>wastes from agriculture, horticulture, aquaculture, forestry, hunting and fishing</b>
02 01 01	sludges from washing and cleaning
02 01 03	plant-tissue waste
02 01 04	waste plastics (except packaging)
02 01 06	animal faeces, urine and manure (including spoiled straw), effluent, collected separately and treated off-site
02 01 07	wastes from forestry
02 01 09	agrochemical waste other than those mentioned in 02 01 08
02 01 10	waste metal
<b>02 02</b>	<b>wastes from the preparation and processing of meat, fish and other foods of animal origin</b>
02 02 03	materials unsuitable for consumption or processing
<b>02 03</b>	<b>wastes from fruit, vegetables, cereals, edible oils, cocoa, coffee, tea and tobacco preparation and processing; conserve production; yeast and yeast extract production, molasses preparation and fermentation</b>
02 03 03	wastes from solvent extraction
02 03 04	materials unsuitable for consumption or processing
<b>02 04</b>	<b>wastes from sugar processing</b>
02 04 01	soil from cleaning and washing beet
02 04 02	off-specification calcium carbonate
<b>02 05</b>	<b>wastes from the dairy products industry</b>
02 05 01	materials unsuitable for consumption or processing
<b>02 06</b>	<b>wastes from the baking and confectionery industry</b>
02 06 01	materials unsuitable for consumption or processing
02 06 02	wastes from preserving agents
<b>02 07</b>	<b>wastes from the production of alcoholic and non-alcoholic beverages (except coffee, tea and cocoa)</b>
02 07 01	wastes from washing, cleaning and mechanical reduction of raw materials
02 07 02	wastes from spirits distillation
02 07 04	materials unsuitable for consumption or processing
<b>03</b>	<b>Wastes from wood processing and the production of panels and furniture, pulp, paper and cardboard</b>
<b>03 01</b>	<b>wastes from wood processing and the production of panels and furniture</b>
03 01 01	waste bark and cork



03 01 05	sawdust, shavings, cuttings, wood, particle board and veneer other than those mentioned in 03 01 04
<b>03 03</b>	<b>wastes from pulp, paper and cardboard production and processing</b>
03 03 01	waste bark and wood
03 03 07	mechanically separated rejects from pulping of waste paper and cardboard
03 03 08	wastes from sorting of paper and cardboard destined for recycling
03 03 09	lime mud waste
03 03 10	fibre rejects, fibre-, filler- and coating-sludges from mechanical separation
<b>04</b>	<b>Wastes from the leather, fur and textile industries</b>
<b>04 01</b>	<b>wastes from the leather and fur industry</b>
04 01 01	fleshings and lime split wastes
04 01 02	liming waste
04 01 06	sludges, in particular from on-site effluent treatment containing chromium
04 01 07	sludges, in particular from on-site effluent treatment free of chromium
04 01 08	waste tanned leather (blue sheetings, shavings, cuttings, buffing dust) containing chromium
04 01 09	wastes from dressing and finishing
<b>04 02</b>	<b>wastes from the textile industry</b>
04 02 09	wastes from composite materials (impregnated textile, elastomer, plastomer)
04 02 10	organic matter from natural products (for example grease, wax)
04 02 15	wastes from finishing other than those mentioned in 04 02 14
04 02 17	dyestuffs and pigments other than those mentioned in 04 02 16
04 02 20	sludges from on-site effluent treatment other than those mentioned in 04 02 19
04 02 21	wastes from unprocessed textile fibres
04 02 22	wastes from processed textile fibres
<b>05</b>	<b>Wastes from petroleum refining, natural gas purification and pyrolytic treatment of coal</b>
<b>05 01</b>	<b>wastes from petroleum refining</b>
05 01 13	boiler feedwater sludges
05 01 14	wastes from cooling columns
05 01 16	sulphur-containing wastes from petroleum desulphurisation
05 01 17	bitumen
<b>05 06</b>	<b>wastes from the pyrolytic treatment of coal</b>
05 06 04	waste from cooling columns
<b>05 07</b>	<b>wastes from natural gas purification and transportation</b>
05 07 02	wastes containing sulphur
<b>06</b>	<b>Wastes from inorganic chemical processes</b>
<b>06 03</b>	<b>wastes from the MFSU of salts and their solutions and metallic oxides</b>
06 03 16	metallic oxides other than those mentioned in 06 03 15
<b>06 05</b>	<b>sludges from on-site effluent treatment</b>
06 05 03	sludges from on-site effluent treatment other than those mentioned in 06 05 02

<b>06 06</b>	<b>wastes from the MFSU of sulphur chemicals, sulphur chemical processes and desulphurisation processes</b>
06 06 03	wastes containing sulphides other than those mentioned in 06 06 02
<b>06 09</b>	<b>wastes from the MFSU of phosphorous chemicals and phosphorous chemical processes</b>
06 09 02	phosphorous slag
06 09 04	calcium-based reaction wastes other than those mentioned in 06 09 03
<b>06 11</b>	<b>wastes from the manufacture of inorganic pigments and opacifiers</b>
06 11 01	calcium-based reaction wastes from titanium dioxide production
<b>06 13</b>	<b>wastes from inorganic chemical processes not otherwise specified</b>
06 13 03	carbon black
<b>07</b>	<b>Wastes from organic chemical processes</b>
<b>07 01</b>	<b>wastes from the manufacture, formulation, supply and use (MFSU) of basic organic chemicals</b>
07 01 12	sludges from on-site effluent treatment other than those mentioned in 07 01 11
<b>07 02</b>	<b>wastes from the MFSU of plastics, synthetic rubber and man-made fibres</b>
07 02 12	sludges from on-site effluent treatment other than those mentioned in 07 02 11
07 02 13	waste plastic
07 02 15	wastes from additives other than those mentioned in 07 02 14
07 02 17	waste containing silicones other than those mentioned in 07 02 16
<b>07 03</b>	<b>wastes from the MFSU of organic dyes and pigments (except 06 11)</b>
07 03 12	sludges from on-site effluent treatment other than those mentioned in 07 03 11
<b>07 04</b>	<b>wastes from the MFSU of organic plant protection products (except 02 01 08 and 02 01 09), wood preserving agents (except 03 02) and other biocides</b>
07 04 12	sludges from on-site effluent treatment other than those mentioned in 07 04 11
<b>07 05</b>	<b>wastes from the MFSU of pharmaceuticals</b>
07 05 12	sludges from on-site effluent treatment other than those mentioned in 07 05 11
07 05 14	solid wastes other than those mentioned in 07 05 13
<b>07 06</b>	<b>wastes from the MFSU of fats, grease, soaps, detergents, disinfectants and cosmetics</b>
07 06 12	sludges from on-site effluent treatment other than those mentioned in 07 06 11
<b>07 07</b>	<b>wastes from the MFSU of fine chemicals and chemical products not otherwise specified</b>
07 07 12	sludges from on-site effluent treatment other than those mentioned in 07 07 11
<b>08</b>	<b>Wastes from the manufacture, formulation, supply and use (MFSU) of coatings (paints, varnishes and vitreous enamels), adhesives, sealants and printing inks</b>
<b>08 01</b>	<b>wastes from MFSU and removal of paint and varnish</b>
08 01 14	sludges from paint or varnish other than those mentioned in 08 01 13
<b>08 02</b>	<b>wastes from MFSU of other coatings (including ceramic materials)</b>
08 02 01	waste coating powders
<b>08 03</b>	<b>wastes from MFSU of printing inks</b>
08 03 18	waste printing toner other than those mentioned in 08 03 17

<b>08 04</b>	<b>wastes from MFSU of adhesives and sealants (including water proofing products)</b>
08 04 10	waste adhesives and sealants other than those mentioned in 08 04 09
08 04 12	adhesive and sealant sludges other than those mentioned in 08 04 11
<b>09</b>	<b>Wastes from the photographic industry</b>
<b>09 01</b>	<b>wastes from the photographic industry</b>
09 01 07	photographic film and paper containing silver or silver compounds
09 01 08	photographic film and paper free of silver or silver compounds
09 01 10	single-use cameras without batteries
09 01 12	single-use cameras containing batteries other than those mentioned in 09 01 11
<b>10</b>	<b>Wastes from thermal processes</b>
<b>10 01</b>	<b>wastes from power stations and other combustion plants (except 19)</b>
10 01 02	coal fly ash
10 01 03	fly ash from peat and untreated wood
10 01 05	calcium-based reaction wastes from flue-gas desulphurisation in solid form
10 01 07	calcium-based reaction wastes from flue-gas desulphurisation in sludge form
10 01 15	bottom ash, slag and boiler dust from co-incineration other than those mentioned in 10 01 14
10 01 17	fly ash from co-incineration other than those mentioned in 10 01 16
10 01 19	wastes from gas cleaning other than those mentioned in 10 01 05, 10 01 07 and 10 01 18
10 01 21	sludges from on-site effluent treatment other than those mentioned in 10 01 20
10 01 24	sands from fluidised beds
10 01 25	wastes from fuel storage and preparation of coal-fired power plants
10 01 26	wastes from cooling-water treatment
<b>10 02</b>	<b>wastes from the iron and steel industry</b>
10 02 01	wastes from the processing of slag
10 02 02	unprocessed slag
10 02 08	solid wastes from gas treatment other than those mentioned in 10 02 07
10 02 10	mill scales
10 02 12	wastes from cooling-water treatment other than those mentioned in 10 02 11
10 02 14	sludges and filter cakes from gas treatment other than those mentioned in 10 02 13
10 02 15	other sludges and filter cakes
<b>10 03</b>	<b>wastes from aluminium thermal metallurgy</b>
10 03 02	anode scraps
10 03 05	waste alumina
10 03 16	skimmings other than those mentioned in 10 03 15
10 03 18	carbon-containing wastes from anode manufacture other than those mentioned in 10 03 17
10 03 24	solid wastes from gas treatment other than those mentioned in 10 03 23
10 03 26	sludges and filter cakes from gas treatment other than those mentioned in 10 03 25

10 03 28	wastes from cooling-water treatment other than those mentioned in 10 03 27
10 03 30	wastes from treatment of salt slags and black drosses other than those mentioned in 10 03 29
<b>10 04</b>	<b>wastes from lead thermal metallurgy</b>
10 04 10	wastes from cooling-water treatment other than those mentioned in 10 04 09
<b>10 05</b>	<b>wastes from zinc thermal metallurgy</b>
10 05 01	slags from primary and secondary production
10 05 04	other particulates and dust
10 05 09	wastes from cooling-water treatment other than those mentioned in 10 05 08
10 05 11	dross and skimmings other than those mentioned in 10 05 10
<b>10 06</b>	<b>wastes from copper thermal metallurgy</b>
10 06 01	slags from primary and secondary production
10 06 02	dross and skimmings from primary and secondary production
10 06 04	other particulates and dust
10 06 10	wastes from cooling-water treatment other than those mentioned in 10 06 09
<b>10 07</b>	<b>wastes from silver, gold and platinum thermal metallurgy</b>
10 07 02	dross and skimmings from primary and secondary production
10 07 03	solid wastes from gas treatment
10 07 04	other particulates and dust
10 07 05	sludges and filter cakes from gas treatment
10 07 08	wastes from cooling-water treatment other than those mentioned in 10 07 07
<b>10 08</b>	<b>wastes from other non-ferrous thermal metallurgy</b>
10 08 04	particulates and dust
10 08 09	other slags
10 08 11	dross and skimmings other than those mentioned in 10 08 10
10 08 13	carbon-containing wastes from anode manufacture other than those mentioned in 10 08 12
10 08 14	anode scrap
10 08 16	flue-gas dust other than those mentioned in 10 08 15
10 08 18	sludges and filter cakes from flue-gas treatment other than those mentioned in 10 08 17
10 08 20	wastes from cooling-water treatment other than those mentioned in 10 08 19
<b>10 09</b>	<b>wastes from casting of ferrous pieces</b>
10 09 03	furnace slag
10 09 06	casting cores and moulds which have not undergone pouring other than those mentioned in 10 09 05
10 09 08	casting cores and moulds which have undergone pouring other than those mentioned in 10 09 07
10 09 10	flue-gas dust other than those mentioned in 10 09 09
10 09 12	other particulates other than those mentioned in 10 09 11
10 09 14	waste binders other than those mentioned in 10 09 13
10 09 16	waste crack-indicating agent other than those mentioned in 10 09 15

<b>10 10</b>	<b>wastes from casting of non-ferrous pieces</b>
10 10 03	furnace slag
10 10 06	casting cores and moulds which have not undergone pouring, other than those mentioned in 10 10 05
10 10 08	casting cores and moulds which have undergone pouring, other than those mentioned in 10 10 07
10 10 10	flue-gas dust other than those mentioned in 10 10 09
10 10 12	other particulates other than those mentioned in 10 10 11
10 10 14	waste binders other than those mentioned in 10 10 13
10 10 16	waste crack-indicating agent other than those mentioned in 10 10 15
<b>10 11</b>	<b>wastes from manufacture of glass and glass products</b>
10 11 03	waste glass-based fibrous materials
10 11 05	particulates and dust
10 11 10	waste preparation mixture before thermal processing, other than those mentioned in 10 11 09
10 11 12	waste glass other than those mentioned in 10 11 11
10 11 14	glass-polishing and -grinding sludge other than those mentioned in 10 11 13
10 11 16	solid wastes from flue-gas treatment other than those mentioned in 10 11 15
10 11 18	sludges and filter cakes from flue-gas treatment other than those mentioned in 10 11 17
10 11 20	solid wastes from on-site effluent treatment other than those mentioned in 10 11 19
<b>10 12</b>	<b>wastes from manufacture of ceramic goods, bricks, tiles and construction products</b>
10 12 01	waste preparation mixture before thermal processing
10 12 03	particulates and dust
10 12 05	sludges and filter cakes from gas treatment
10 12 06	discarded moulds
10 12 08	waste ceramics, bricks, tiles and construction products (after thermal processing)
10 12 10	solid wastes from gas treatment other than those mentioned in 10 12 09
10 12 12	wastes from glazing other than those mentioned in 10 12 11
10 12 13	sludge from on-site effluent treatment
<b>10 13</b>	<b>wastes from manufacture of cement, lime and plaster and articles and products made from them</b>
10 13 01	waste preparation mixture before thermal processing
10 13 04	wastes from calcination and hydration of lime
10 13 06	particulates and dust (except 10 13 12 and 10 13 13)
10 13 07	sludges and filter cakes from gas treatment
10 13 10	wastes from asbestos-cement manufacture other than those mentioned in 10 13 09
10 13 11	wastes from cement-based composite materials other than those mentioned in 10 13 09 and 10 13 10
10 13 13	solid wastes from gas treatment other than those mentioned in 10 13 12
10 13 14	waste concrete and concrete sludge

<b>11</b>	<b>Wastes from chemical surface treatment and coating of metals and other materials; non-ferrous hydro-metallurgy</b>
<b>11 01</b>	<b>wastes from chemical surface treatment and coating of metals and other materials (for example galvanic processes, zinc coating processes, pickling processes, etching, phosphating, alkaline degreasing, anodising)</b>
11 01 10	sludges and filter cakes other than those mentioned in 11 01 09
11 01 14	degreasing wastes other than those mentioned in 11 01 13
<b>11 02</b>	<b>wastes from non-ferrous hydrometallurgical processes</b>
11 02 03	wastes from the production of anodes for aqueous electrolytical processes
11 02 06	wastes from copper hydrometallurgical processes other than those mentioned in 11 02 05
<b>11 05</b>	<b>wastes from hot galvanising processes</b>
11 05 01	hard zinc
11 05 02	zinc ash
<b>12</b>	<b>Wastes from shaping and physical and mechanical surface treatment of metals and plastics</b>
<b>12 01</b>	<b>wastes from shaping and physical and mechanical surface treatment of metals and plastics</b>
12 01 01	ferrous metal filings and turnings
12 01 02	ferrous metal dust and particles
12 01 03	non-ferrous metal filings and turnings
12 01 04	non-ferrous metal dust and particles
12 01 05	plastics shavings and turnings
12 01 13	welding wastes
12 01 15	machining sludges other than those mentioned in 12 01 14
12 01 17	waste blasting material other than those mentioned in 12 01 16
12 01 21	spent grinding bodies and grinding materials other than those mentioned in 12 01 20
<b>15</b>	<b>Waste packaging, absorbents, wiping cloths, filter materials and protective clothing not otherwise specified</b>
<b>15 01</b>	<b>packaging (including separately collected municipal packaging waste)</b>
15 01 01	paper and cardboard packaging
15 01 02	plastic packaging
15 01 03	wooden packaging
15 01 04	metallic packaging
15 01 05	composite packaging
15 01 06	mixed packaging
15 01 07	glass packaging
15 01 09	textile packaging
<b>15 02</b>	<b>absorbents, filter materials, wiping cloths and protective clothing</b>
15 02 03	absorbents, filter materials, wiping cloths and protective clothing other than those mentioned in 15 02 02
<b>16</b>	<b>Wastes not otherwise specified in the list</b>

<b>16 01</b>	<b>end-of-life vehicles from different means of transport (including off-road machinery) and wastes from dismantling of end-of-life vehicles and vehicle maintenance (except 13, 14, 16 06 and 16 08)</b>
16 01 03	end-of-life tyres
16 01 12	brake pads other than those mentioned in 16 01 11
16 01 17	ferrous metal
16 01 18	non-ferrous metal
16 01 19	plastic
16 01 20	glass
16 01 22	components not otherwise specified
<b>16 02</b>	<b>wastes from electrical and electronic equipment</b>
16 02 14	discarded equipment other than those mentioned in 16 02 09 to 16 02 13
16 02 16	components removed from discarded equipment other than those mentioned in 16 02 15
<b>16 03</b>	<b>off-specification batches and unused products</b>
16 03 04	inorganic wastes other than those mentioned in 16 03 03
16 03 06	organic wastes other than those mentioned in 16 03 05
<b>16 05</b>	<b>gases in pressure containers and discarded chemicals</b>
16 05 05	gases in pressure containers other than those mentioned in 16 05 04
16 05 09	discarded chemicals other than those mentioned in 16 05 06, 16 05 07 or 16 05 08
<b>16 06</b>	<b>batteries and accumulators</b>
16 06 04	alkaline batteries (except 16 06 03)
16 06 05	other batteries and accumulators
<b>16 08</b>	<b>spent catalysts</b>
16 08 01	spent catalysts containing gold, silver, rhenium, rhodium, palladium, iridium or platinum (except 16 08 07)
16 08 03	spent catalysts containing transition metals or transition metal compounds not otherwise specified
<b>16 11</b>	<b>waste linings and refractories</b>
16 11 02	carbon-based linings and refractories from metallurgical processes others than those mentioned in 16 11 01
16 11 04	other linings and refractories from metallurgical processes other than those mentioned in 16 11 03
16 11 06	linings and refractories from non-metallurgical processes others than those mentioned in 16 11 05
<b>17</b>	<b>Construction and demolition wastes (including excavated soil from contaminated sites)</b>
<b>17 01</b>	<b>concrete, bricks, tiles and ceramics</b>
17 01 01	concrete
17 01 02	bricks
17 01 07	mixtures of concrete, bricks, tiles and ceramics other than those mentioned in 17 01 06
<b>17 02</b>	<b>wood, glass and plastic</b>
17 02 01	wood

17 02 02	glass
17 02 03	plastic
<b>17 03</b>	<b>bituminous mixtures, coal tar and tarred products</b>
17 03 02	bituminous mixtures other than those mentioned in 17 03 01
<b>17 04</b>	<b>metals (including their alloys)</b>
17 04 01	copper, bronze, brass
17 04 02	aluminium
17 04 03	lead
17 04 04	zinc
17 04 05	iron and steel
17 04 06	tin
17 04 07	mixed metals
17 04 11	cables other than those mentioned in 17 04 10
<b>17 05</b>	<b>soil (including excavated soil from contaminated sites), stones and dredging spoil</b>
17 05 04	soil and stones other than those mentioned in 17 05 03
17 05 06	dredging spoil other than those mentioned in 17 05 05
17 05 08	track ballast other than those mentioned in 17 05 07
<b>17 06</b>	<b>insulation materials and asbestos-containing construction materials</b>
17 06 04	insulation materials other than those mentioned in 17 06 01 and 17 06 03
<b>17 08</b>	<b>gypsum-based construction material</b>
17 08 02	gypsum-based construction materials other than those mentioned in 17 08 01
<b>17 09</b>	<b>other construction and demolition wastes</b>
17 09 04	mixed construction and demolition wastes other than those mentioned in 17 09 01, 17 09 02 and 17 09 03
<b>18</b>	<b>Wastes from human or animal health care and/or related research (except kitchen and restaurant wastes not arising from immediate health care)</b>
<b>18 01</b>	<b>wastes from natal care, diagnosis, treatment or prevention of disease in humans</b>
18 01 01	sharps (except 18 01 03)
18 01 04	wastes whose collection and disposal is not subject to special requirements in order to prevent infection (for example dressings, plaster casts, linen, disposable clothing, diapers)
18 01 07	chemicals other than those mentioned in 18 01 06
<b>18 02</b>	<b>wastes from research, diagnosis, treatment or prevention of disease involving animals</b>
18 02 03	wastes whose collection and disposal is not subject to special requirements in order to prevent infection
18 02 06	chemicals other than those mentioned in 18 02 05
<b>19</b>	<b>Wastes from waste management facilities, off-site waste water treatment plants and the preparation of water intended for human consumption and water for industrial use</b>
<b>19 01</b>	<b>wastes from incineration or pyrolysis of waste</b>
19 01 02	ferrous materials removed from bottom ash



19 01 12	bottom ash and slag other than those mentioned in 19 01 11
19 01 14	fly ash other than those mentioned in 19 01 13
19 01 16	boiler dust other than those mentioned in 19 01 15
19 01 18	pyrolysis wastes other than those mentioned in 19 01 17
19 01 19	sands from fluidised beds
<b>19 02</b>	<b>wastes from physico/chemical treatments of waste (including dechromatation, decyanidation, neutralisation)</b>
19 02 03	premixed wastes composed only of non-hazardous wastes
19 02 10	combustible wastes other than those mentioned in 19 02 08 and 19 02 09
<b>19 03</b>	<b>stabilised/solidified wastes</b>
19 03 07	solidified wastes other than those mentioned in 19 03 06
<b>19 04</b>	<b>vitrified waste and wastes from vitrification</b>
19 04 01	vitrified waste
19 04 04	aqueous liquid wastes from vitrified waste tempering
<b>19 05</b>	<b>wastes from aerobic treatment of solid wastes</b>
19 05 01	non-composted fraction of municipal and similar wastes
19 05 02	non-composted fraction of animal and vegetable waste
19 05 03	off-specification compost
<b>19 08</b>	<b>wastes from waste water treatment plants not otherwise specified</b>
19 08 01	screenings
19 08 02	waste from desanding
<b>19 09</b>	<b>wastes from the preparation of water intended for human consumption or water for industrial use</b>
19 09 01	solid waste from primary filtration and screenings
19 09 03	sludges from decarbonation
19 09 04	spent activated carbon
19 09 05	saturated or spent ion exchange resins
<b>19 10</b>	<b>wastes from shredding of metal-containing wastes</b>
19 10 01	iron and steel waste
19 10 02	non-ferrous waste
19 10 04	fluff-light fraction and dust other than those mentioned in 19 10 03
19 10 06	other fractions other than those mentioned in 19 10 05
<b>19 11</b>	<b>wastes from oil regeneration</b>
19 11 06	sludges from on-site effluent treatment other than those mentioned in 19 11 05
<b>19 12</b>	<b>wastes from the mechanical treatment of waste (for example sorting, crushing, compacting, pelletising) not otherwise specified</b>
19 12 01	paper and cardboard
19 12 02	ferrous metal
19 12 03	non-ferrous metal
19 12 04	plastic and rubber
19 12 05	glass

19 12 07	wood other than that mentioned in 19 12 06
19 12 08	textiles
19 12 09	minerals (for example sand, stones)
19 12 10	combustible waste (refuse derived fuel)
19 12 12	other wastes (including mixtures of materials) from mechanical treatment of wastes other than those mentioned in 19 12 11
<b>20</b>	<b>Municipal wastes (household waste and similar commercial, industrial and institutional wastes) including separately collected fractions</b>
<b>20 01</b>	<b>separately collected fractions (except 15 01)</b>
20 01 01	paper and cardboard
20 01 02	glass
20 01 08	biodegradable kitchen and canteen waste
20 01 10	clothes
20 01 11	textiles
20 01 25	edible oil and fat
20 01 34	batteries and accumulators other than those mentioned in 20 01 33
20 01 36	discarded electrical and electronic equipment other than those mentioned in 20 01 21, 20 01 23 and 20 01 35
20 01 38	wood other than that mentioned in 20 01 37
20 01 39	plastics
20 01 40	metals
20 01 41	wastes from chimney sweeping
<b>20 02</b>	<b>garden and park wastes (including cemetery waste)</b>
20 02 01	biodegradable waste
20 02 03	other non-biodegradable wastes
<b>20 03</b>	<b>other municipal wastes</b>
20 03 01	mixed municipal waste
20 03 02	waste from markets
20 03 03	street-cleaning residues
20 03 07	bulky waste

## Schedule 3 – Emissions and monitoring

<b>Table S3.1 Point Source emissions to water (other than sewer) and land – emission limits and monitoring requirements</b>						
<b>Emission point ref. &amp; location</b>	<b>Source</b>	<b>Parameter</b>	<b>Limit (incl. unit)</b>	<b>Reference Period</b>	<b>Monitoring frequency</b>	<b>Monitoring standard or method</b>
W1 on site plan in schedule 7, emission to Ecton Brook	Uncontaminated surface water and rain water only	No parameters set	No limit set	-	-	-

## Schedule 4 – Reporting

Parameters, for which reports shall be made, in accordance with conditions of this permit, are listed below.

<b>Table S4.1 Performance parameters</b>		
<b>Parameter</b>	<b>Frequency of assessment</b>	<b>Units</b>
Water usage	Annually	tonnes
Energy usage	Annually	MWh

<b>Table S4.2 Reporting forms</b>		
<b>Media/parameter</b>	<b>Reporting format</b>	<b>Date of form</b>
Water usage	Form water usage 1 or other form as agreed in writing by the Environment Agency	01/02/16
Energy usage	Form energy 1 or other form as agreed in writing by the Environment Agency	01/02/16
Waste returns	E-waste Return Form	-

## Schedule 5 – Notification

These pages outline the information that the operator must provide.

Units of measurement used in information supplied under Part A and B requirements shall be appropriate to the circumstances of the emission. Where appropriate, a comparison should be made of actual emissions and authorised emission limits.

If any information is considered commercially confidential, it should be separated from non-confidential information, supplied on a separate sheet and accompanied by an application for commercial confidentiality under the provisions of the EP Regulations.

### Part A

Permit Number	
Name of operator	
Location of Facility	
Time and date of the detection	

<b>(a) Notification requirements for any malfunction, breakdown or failure of equipment or techniques, accident, or emission of a substance not controlled by an emission limit which has caused, is causing or may cause significant pollution</b>	
<b>To be notified within 24 hours of detection</b>	
Date and time of the event	
Reference or description of the location of the event	
Description of where any release into the environment took place	
Substances(s) potentially released	
Best estimate of the quantity or rate of release of substances	
Measures taken, or intended to be taken, to stop any emission	
Description of the failure or accident.	

<b>(b) Notification requirements for the breach of a limit</b>	
<b>To be notified within 24 hours of detection unless otherwise specified below</b>	
Emission point reference/ source	
Parameter(s)	
Limit	
Measured value and uncertainty	
Date and time of monitoring	
Measures taken, or intended to be	

<b>(b) Notification requirements for the breach of a limit</b>	
<b>To be notified within 24 hours of detection unless otherwise specified below</b>	
taken, to stop the emission	

<b>Time periods for notification following detection of a breach of a limit</b>	
<b>Parameter</b>	<b>Notification period</b>

<b>(c) Notification requirements for the detection of any significant adverse environmental effect</b>	
<b>To be notified within 24 hours of detection</b>	
Description of where the effect on the environment was detected	
Substances(s) detected	
Concentrations of substances detected	
Date of monitoring/sampling	

## Part B – to be submitted as soon as practicable

Any more accurate information on the matters for notification under Part A.	
Measures taken, or intended to be taken, to prevent a recurrence of the incident	
Measures taken, or intended to be taken, to rectify, limit or prevent any pollution of the environment which has been or may be caused by the emission	
The dates of any unauthorised emissions from the facility in the preceding 24 months.	

Name*	
Post	
Signature	
Date	

\* authorised to sign on behalf of the operator

## Schedule 6 – Interpretation

“accident” means an accident that may result in pollution.

“application” means the application for this permit, together with any additional information supplied by the operator as part of the application and any response to a notice served under Schedule 5 to the EP Regulations.

“authorised officer” means any person authorised by the Environment Agency under section 108(1) of The Environment Act 1995 to exercise, in accordance with the terms of any such authorisation, any power specified in section 108(4) of that Act.

“building” means a construction that has the objective of providing sheltering cover and minimising emissions of noise, particulate matter, odour and litter.

“disposal” means any of the operations provided for in Annex I to Directive 2008/98/EC of the European Parliament and of the Council on waste.

“emissions to land” includes emissions to groundwater.

“EP Regulations” means The Environmental Permitting (England and Wales) Regulations SI 2010 No.675 and words and expressions used in this permit which are also used in the Regulations have the same meanings as in those Regulations.

“emissions of substances not controlled by emission limits” means emissions of substances to air, water or land from the activities, either from the emission points specified in schedule 3 or from other localised or diffuse sources, which are not controlled by an emission or background concentration limit.

“groundwater” means all water, which is below the surface of the ground in the saturation zone and in direct contact with the ground or subsoil.

“hazardous property” has the meaning given in Schedule 3 of the Hazardous Waste (England and Wales) Regulations 2005 No.894 and the Hazardous Waste (Wales) Regulations 2005 No. 1806 (W.138).

“Industrial Emissions Directive” means DIRECTIVE 2010/75/EU OF THE EUROPEAN PARLIAMENT AND OF THE COUNCIL of 24 November 2010 on industrial emissions

“Pests” means Birds, Vermin and Insects.

“quarter” means a calendar year quarter commencing on 1 January, 1 April, 1 July or 1 October.

“recovery” means any of the operations provided for in Annex II to Directive 2008/98/EC of the European Parliament and of the Council on waste.

“waste code” means the six digit code referable to a type of waste in accordance with the List of Wastes (England) Regulations 2005, or List of Wastes (Wales) Regulations 2005, as appropriate, and in relation to hazardous waste, includes the asterisk.

“Waste Framework Directive” or “WFD” means Waste Framework Directive 2008/98/EC of the European Parliament and of the Council on waste

“WEEE” means waste electrical and electronic equipment.

“WEEE Directive” means Directive 2012/19/EU of the European Parliament and of the Council of 4th July 2012 on waste electrical and electronic equipment (WEEE).

Where a minimum limit is set for any emission parameter, for example pH, reference to exceeding the limit shall mean that the parameter shall not be less than that limit.

Unless otherwise stated, any references in this permit to concentrations of substances in emissions into air means:

- in relation to emissions from combustion processes, the concentration in dry air at a temperature of 273K, at a pressure of 101.3 kPa and with an oxygen content of 3% dry for liquid and gaseous fuels, 6% dry for solid fuels; and/or
- in relation to emissions from non-combustion sources, the concentration at a temperature of 273K and at a pressure of 101.3 kPa, with no correction for water vapour content.

“year” means calendar year ending 31 December.



# Schedule 7 – Site plan

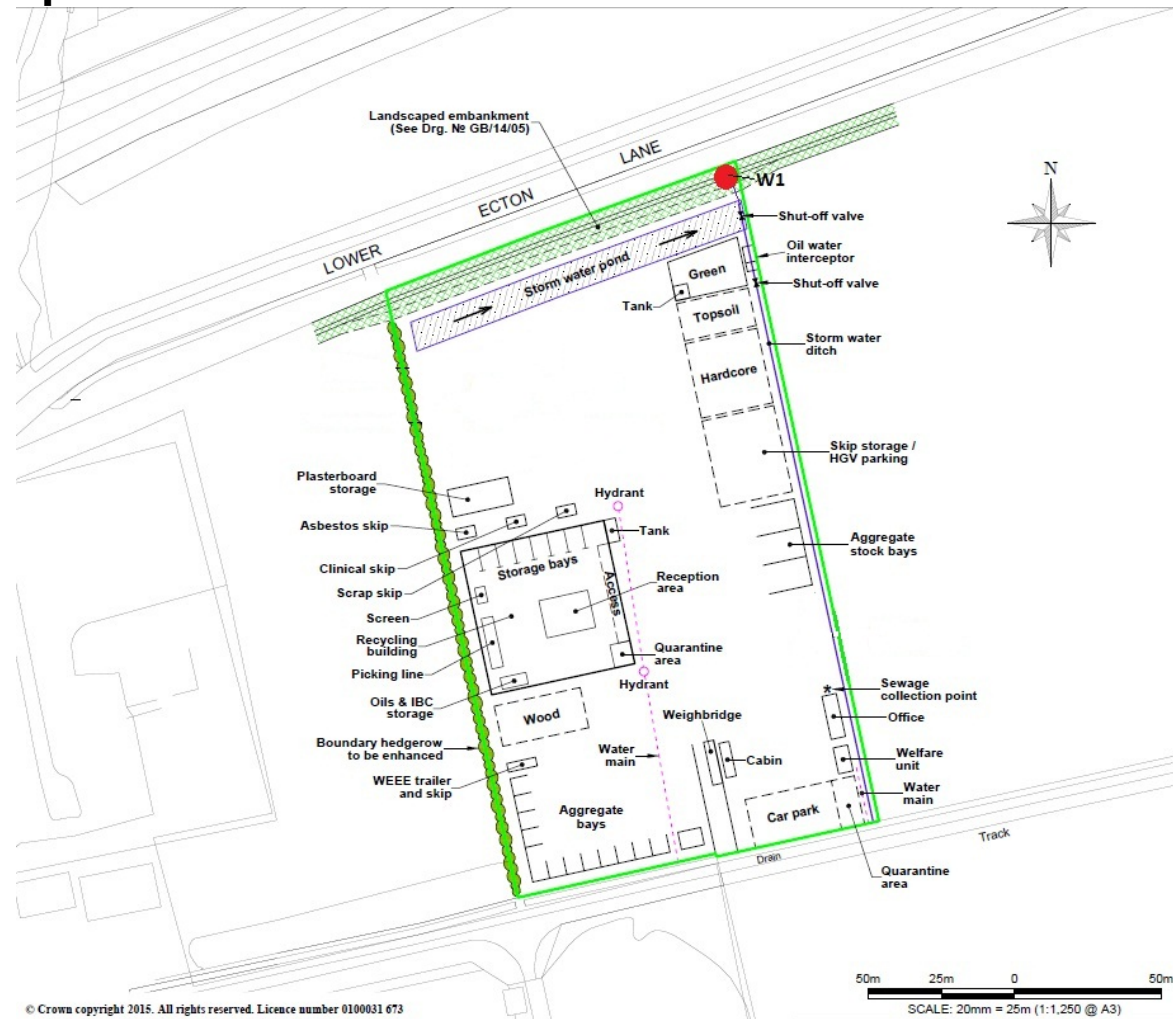

END OF PERMIT

# Reporting Forms

**Permit Number: SP3935AX**

**Operator: Mick George Ltd**

**Facility: Great Billing II  
Transfer Station**

**Form Number: WaterUsage1 / 01/02/2016**

**Reporting of Water Usage for the year**

<b>Water Source</b>	<b>Usage (m<sup>3</sup>/year)</b>	<b>Specific Usage (m<sup>3</sup>/unit output)</b>
Mains water		
Site borehole		
River abstraction		
<b>TOTAL WATER USAGE</b>		

Operator's comments:

Signed .....

Date.....

(authorised to sign as representative of Operator)

**Permit Number: SP3935AX**

**Operator:**

**Mick George Ltd**

**Facility: Great Billing II  
Transfer Station**

**Form Number:**

**Energy1 / 01/02/2016**

**Reporting of Energy Usage for the year**

Energy Source	Energy Usage		Specific Usage (MWh/unit output)
	Quantity	Primary Energy (MWh)	
Electricity *	MWh		
Natural Gas	MWh		
Gas Oil	tonnes		
Recovered Fuel Oil	tonnes		
<b>TOTAL</b>	-		

\* Conversion factor for delivered electricity to primary energy = 2.4

Operator's comments:

Signed .....

Date.....

(Authorised to sign as representative of Operator)