

EXHIBIT LIST

Page 1 of 17

No	Exhibit Name	Page
1	P7574 Existing PROWs	2 - 5
2	P7575 Construction impacts on PROWs	6 - 9
3	P7576 Operational impacts on PROWs	10 - 13
4	P7577 Construction National Trail Routes (AP2)	14 - 15
5	P7578 Operation National Trail Routes (AP2)	16 - 17



CONSTRUCTION PRoWs (AP2 PROPOSAL)

Footpath GMI/13/3 temporarily diverted during green tunnel construction

Footpath LMI/17/2 temporarily diverted to LMI/17/1, Chalk Lane, LMI/27/1, Bullbaiters Lane and Hyde Heath Road

For Continuation Refer to Drawing C222-ATK-EV-DPL-020-300022-PET0004.16

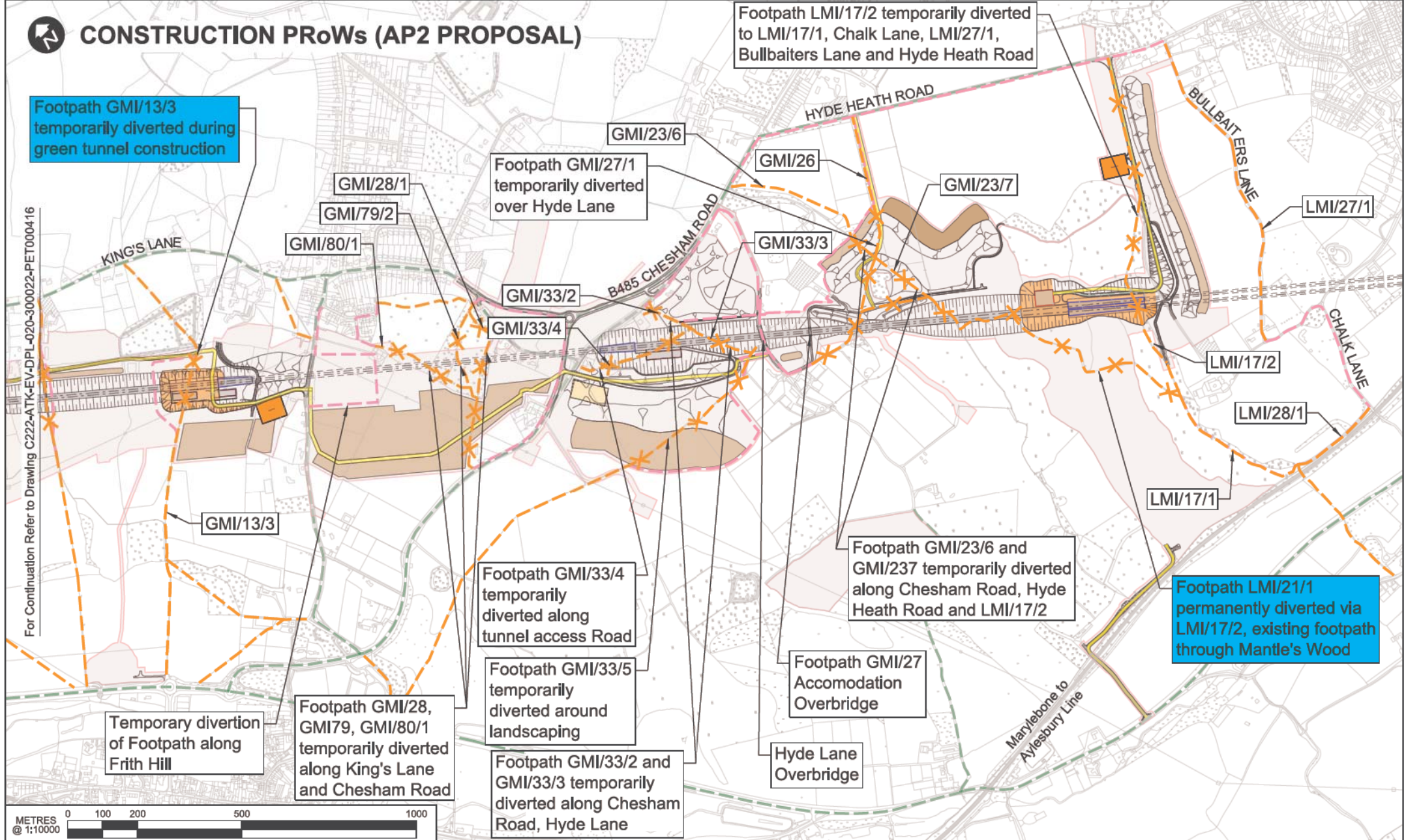

P00.1	FIRST DRAWN				

HS2 accepts no responsibility for any circumstances which arise from the reproduction of this document after alteration, amendment or abbreviation or if it is issued in part or issued incompletely in any way.

© Crown Copyright and database right 2015. All rights reserved. Ordnance Survey Licence number 100049190

© Crown Copyright material is reproduced with the permission of Land Registry under delegated authority from the Controller of HMSO. This material was last updated on 2015 and may not be copied, distributed, sold or published without the formal permission of Land Registry. Only an official copy of a title plan or register obtained from the Land Registry may be used for legal or other official purposes.

Scale with caution as distortion can occur.

Legends/Notes	
	Existing public right of way (PRoW)
	Stopped up PRoW
	Temporary PRoW Diversion

Registered in England
Registration No. 95791696
Registered office:
One Canada Square,
London, E14 5AB

Creator/Originator: Atkins

Zone	Country South	Project/Contract	Country South Design
Design Stage	DESIGN-FOR-PETITION	Discipline/Function	Environmental
Drawing Title	Chiltern District Council Petition 0416	Drawn	TB
		Checked	Approved
		Date	07/07/2015
		Scale	AS SHOWN
		Sheet	A3
		Drawing No.	C222-ATK-E
		Rev.	

Zone	Country South	Project/Contract	Country South Design
Design Stage	DESIGN-FOR-PETITION	Discipline/Function	Environmental
Drawing Title	Chiltern District Council Petition 0416	Drawn	TB
		Checked	Approved
		Date	07/07/2015
		Scale	AS SHOWN
		Sheet	A3
		Drawing No.	C222-ATK-E
		Rev.	

P7575 (1)

HOC/10518/006

OPERATION PRoWs (AP2 PROPOSAL)

Footpath WEN/39/1 reinstated and following completion of viaduct construction works

Footpath WEN/36/1 reinstated on existing alignment

Footpath GMI/12/1 reinstated over its original alignment across Footpath GMI/12 Overbridge

Further Proposed alternative WEN/37 PRoW alignment across Bowood Lane Overbridge

Footpath TLE/2/1 reinstated across Footpath TLE/2 Accommodation Overbridge

Further Proposed GMI/2/1 alternative alignment parallel to HS2 across footbridge GMI/1 Accommodation Overbridge

For Continuation Refer to Drawing C222-ATK-EV-DPL-020-300033-PET000416

For Continuation Refer to Drawing C222-ATK-EV-DPL-020-300031-PET000416

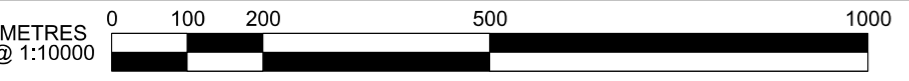

P00.1	FIRST DRAWN				

HS2 accepts no responsibility for any circumstances which arise from the reproduction of this document after alteration, amendment or abbreviation or if it is issued in part or issued incompletely in any way.

© Crown Copyright and database right 2015. All rights reserved. Ordnance Survey Licence number 100049190

© Crown Copyright material is reproduced with the permission of Land Registry under delegated authority from the Controller of HMSO. This material was last updated on 2015 and may not be copied, distributed, sold or published without the formal permission of Land Registry. Only an official copy of a title plan or register obtained from the Land Registry may be used for legal or other official purposes.

Scale with caution as distortion can occur.

Legends/Notes:

- - - Existing public right of way (PRoW)
- X - Stopped up PRoW
- New, diverted or realigned PRoW
- Alternative alignment or change to the status of PRoW to be promoted through an Additional Provision or by an Assurance

Registered in England
Registration No. 06791686
Registered office:
One Canada Square,
London, E14 5AB

Creator/Originator
Atkins

Zone	Country South	
Design Stage	DESIGN-FOR-PETITION	
Drawing Title	Chiltern District Council Petition 0416 Operation (AP2 Scheme) - Sheet 2 of 4 (revised for errata and potential assurances)	

Project/Contract	Country South Design		
Discipline/Function	Environmental		
Drawn	Checked	Approved	
TB			
Date	Scale	Size	
07/07/2015	AS SHOWN	A3	
Drawing No.	Rev.		
C222-ATK-EV-DPL-020-300032-PET000416	P00.1		



OPERATION PRoWs (AP2 PROPOSAL)

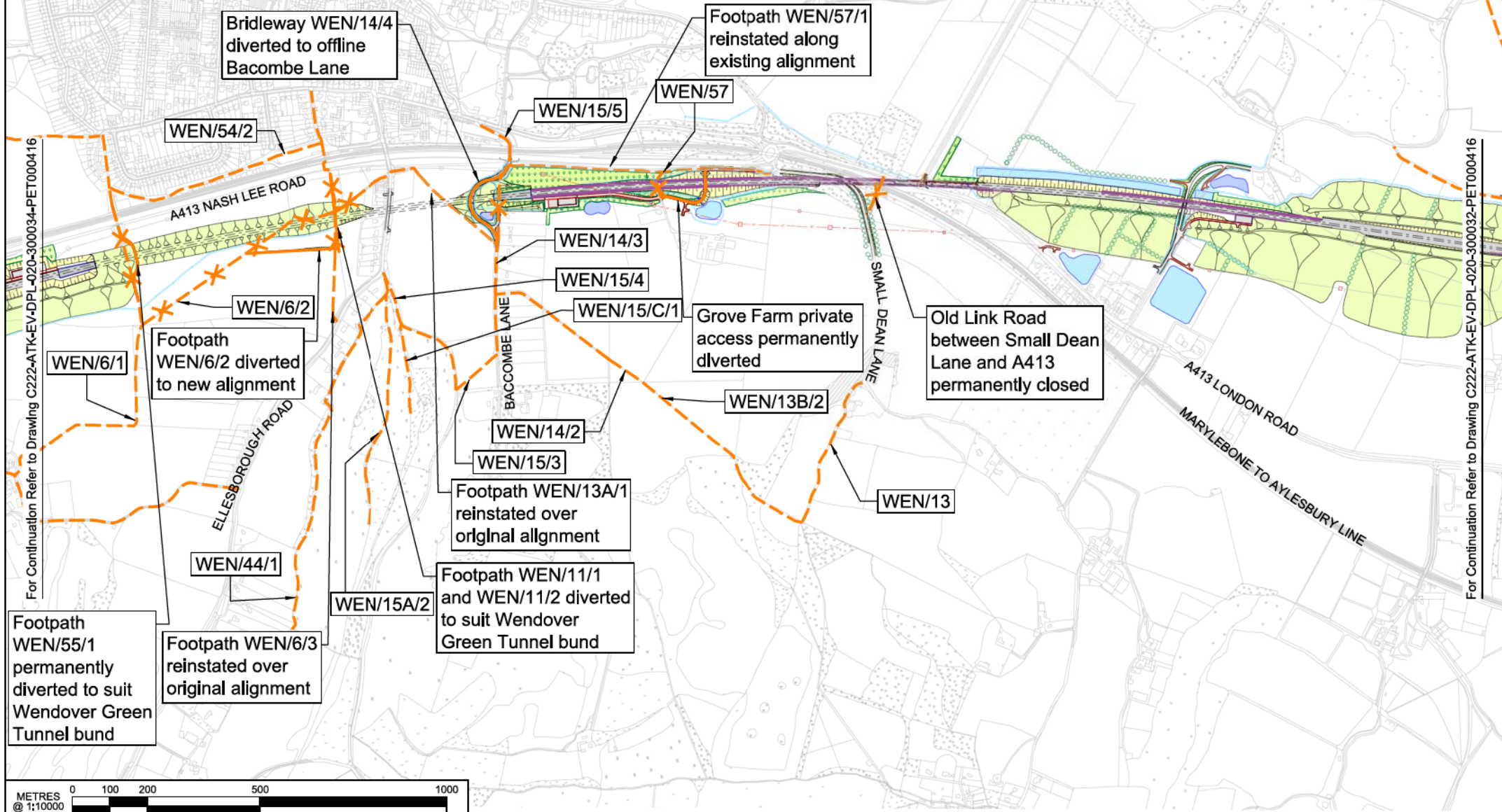

For Continuation Refer to Drawing C222-ATK-EV-DPL-020-300034-PET000416

For Continuation Refer to Drawing C222-ATK-EV-DPL-020-300032-PET000416

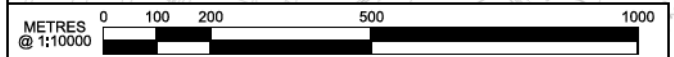

P00.1	FIRST DRAWN				

HS2 accepts no responsibility for any circumstances which arise from the reproduction of this document after alteration, amendment or abbreviation or if it is issued in part or issued incompletely in any way.

© Crown Copyright and database right 2015. All rights reserved. Ordnance Survey Licence number 100049190

© Crown Copyright material is reproduced with the permission of Land Registry under delegated authority from the Controller of HMSO. This material was last updated on 2015 and may not be copied, distributed, sold or published without the formal permission of Land Registry. Only an official copy of a title plan or register obtained from the Land Registry may be used for legal or other official purposes.

Scale with caution as distortion can occur.

Legends/Notes

- Existing public right of way (PRoW)
- ✘ Stopped up PRoW
- New, diverted or realigned PRoW

Registered in England
Registration No. 06781686
Registered office:
One Canada Square,
London, E14 5AB

Creator/Originator: Atkins

Zone	Country South	Project/Contract	Country South Design
Design Stage	DESIGN-FOR-PETITION	Discipline/Function	Environmental
Drawing Title	Chiltern District Council Petition 0416	Drawn	TB
	Operation (AP2 Scheme) - Sheet 3 of 4	Checked	Approved
		Date	07/07/2015
		Scale	AS SHOWN
		Sheet	A3
		Drawing No.	C222-ATK-E
		Rev.	

P7576 (3)

HOC/10518/0012

OPERATION PRoWs (AP2 PROPOSAL)

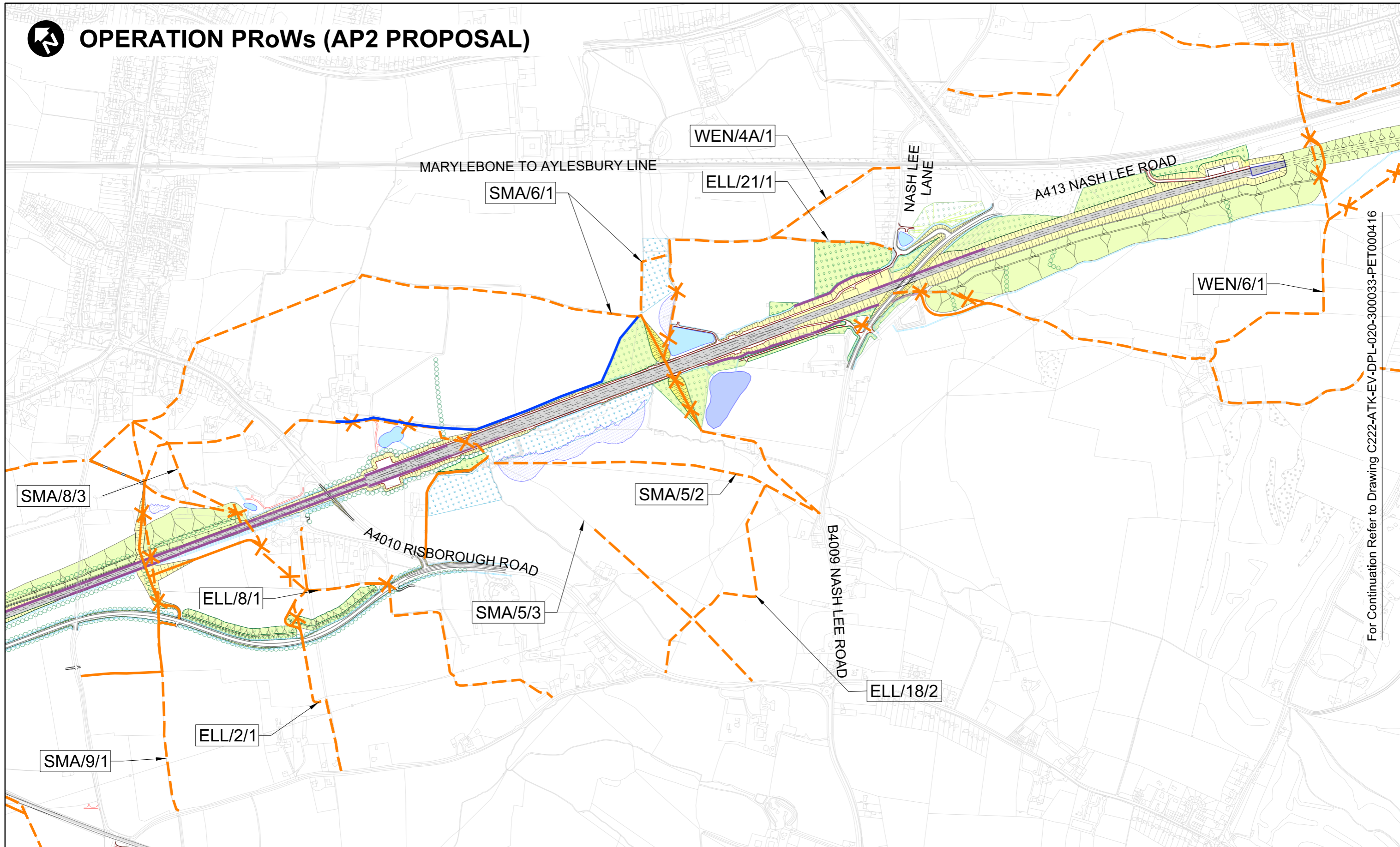

For Continuation Refer to Drawing C222-ATK-EV-DPL-020-300033-PET000416

P00.1	FIRST DRAWN	JM	08/07/15		

HS2 accepts no responsibility for any circumstances which arise from the reproduction of this document after alteration, amendment or abbreviation or if it is issued in part or issued incompletely in any way.

© Crown Copyright and database right 2015. All rights reserved. Ordnance Survey Licence number 100049190

© Crown Copyright material is reproduced with the permission of Land Registry under delegated authority from the Controller of HMSO. This material was last updated on 2015 and may not be copied, distributed, sold or published without the formal permission of Land Registry. Only an official copy of a title plan or register obtained from the Land Registry may be used for legal or other official purposes.

Scale with caution as distortion can occur.

Legends/Notes:

- - - Existing public right of way (PRoW)
- X - Stopped up PRoW
- New, diverted or realigned PRoW
- Alternative alignment or change to the status of PRoW to be promoted through an Additional Provision or by an Assurance



Registered in England
Registration No. 06791686
Registered office:
One Canada Square,
London, E14 5AB

Creator/Originator
Atkins

Zone	Country South	
Design Stage	DESIGN-FOR-PETITION	
Drawing Title	Chiltern District Council Petition 0416 Operation (AP2 Scheme) - Sheet 4 of 4	

Project/Contract	Country South Design	
Discipline/Function	Environmental	
Drawn	Checked	Approved
TB		
Date	Scale	Size
07/07/2015	AS SHOWN	A3
Drawing No.	Rev.	
C222-ATK-EV-DPL-020-300034-PET000416	P00.1	

