

Plan
Scale 1:10,000 @ A1

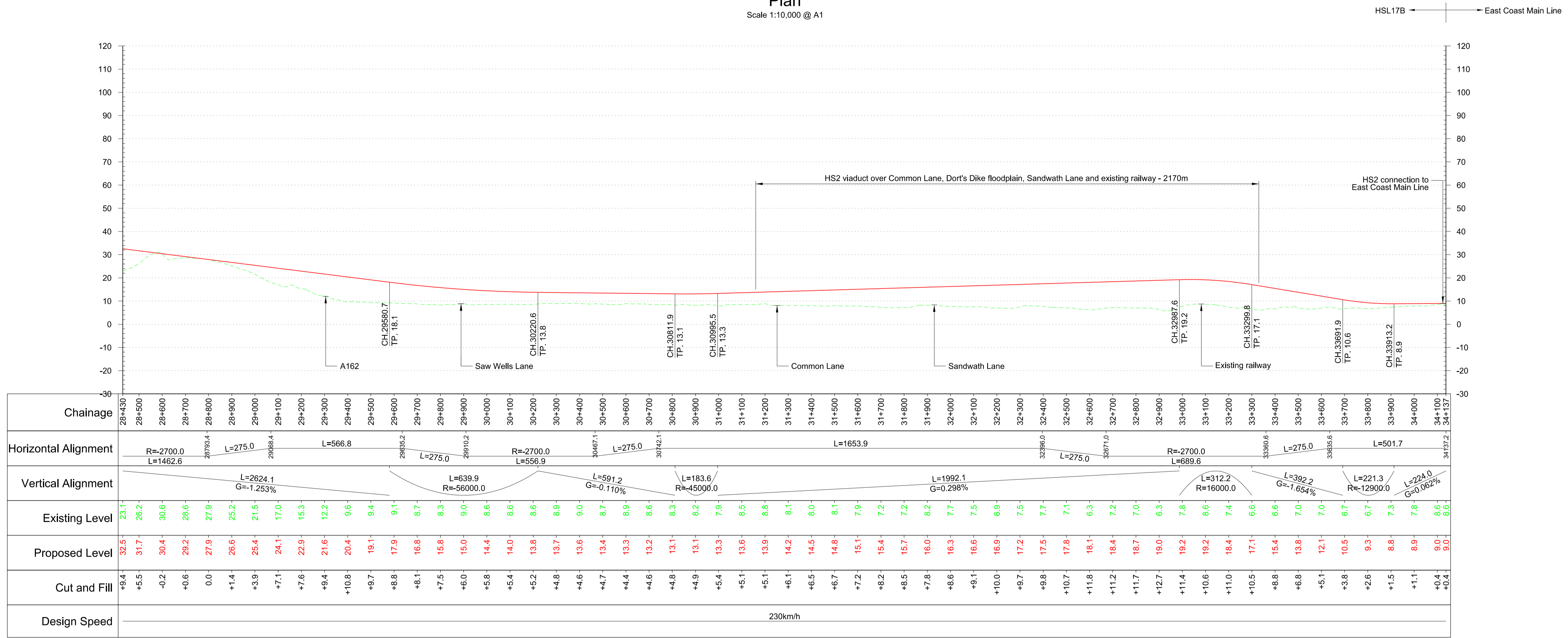

Profile
Scale H:1:10,000 V:1:1000 @ A1

Fit for Acceptance

Rev	Description	Drawn	Checked	Con App	HS2 App
P05	Client's Comments Addressed	JV	AR	MM	
P04	Client's Comments Addressed	JV	AR	MM	
P03	Client's Comments Addressed	JV	AR	MM	
P02	Client's Comments Addressed	JV	AR	MM	
P01	First Issue	RB	AR	MM	

HS2 accepts no responsibility for any circumstances which arise from the reproduction of this document after alteration, amendment or abbreviation or if it is issued in part or issued incompletely in any way.

© Crown Copyright and database right 2016. All rights reserved. Ordnance Survey Licence number 100049190

© Crown Copyright material is reproduced with the permission of Land Registry under delegated authority from the Controller of HMSO.

This material was last updated on 2016 and may not be copied, distributed, sold or published without the formal permission of Land Registry. Only an official copy of a title plan or register obtained from the Land Registry may be used for legal or other official purposes.

Scale with caution as distortion can occur.

- Key Environmental Features Legend**
- World Heritage Site
 - Ramsar
 - Special Areas of Conservation
 - Special Protection Areas
 - SSSI
 - National Nature Reserves
 - Area of Outstanding Natural Beauty
 - National Park
 - Major Development Sites
 - Additional Development Sites
 - Scheduled Monuments
 - Registered Parks and Gardens
 - Historical Battlefields
 - Active and/or Authorised Landfill
 - Historical Landfill
 - Flood Zones
 - Listed Building Grade I
 - Listed Building Grade II*
 - Listed Building Grade II

- Legend**
- Track Centrelines
 - Viaduct
 - Tunnel
 - Existing Railway Connection
 - HS2 Connection
 - Fully Retained Cutting/Fill
 - Major Contour
 - Ground Profile
 - Track Profile
 - Minor Contour
 - Node
 - Engineering Earthworks
 - Railway Cutting
 - Railway Embankment
 - HS2 Depot/Station Operational Boundary

Registered in England
Registration No. 06791686
Registered office:
One Canada Square,
London, E14 5AB

Creator/Organiser
Mott MacDonald

Zone	Leeds Leg North
Design Stage	Post-Consultation
Drawing Title	HSL17B Preferred Route Sheet 5 of 5

Project/Contract			West Midlands to Leeds Route		
Discipline/Function			Railway Track		
Drawn	Checked	Approved			
JV	AR	MM			
Date	Scale	Size			
17/06/2016	1:10000	A1			
Drawing No.		Rev.			
C321-MMD-RT-DPP-130-581706		P05			