

# Notice of variation and consolidation with introductory note

**The Environmental Permitting (England & Wales) Regulations 2010**

---

Veolia ES Cleanaway (UK) Ltd  
Greenwich Integrated Waste Management Facility  
Nathan Way  
Thameshead  
London  
SE28 0AN

**Variation application number**

EPR\DP3390EL\V003

**Permit number**

EPR\DP3390EL

# Greenwich Integrated Waste Management Facility

## Permit number EPR/DP3390EL

### Introductory note

#### **This introductory note does not form a part of the notice.**

Under the Environmental Permitting (England & Wales) Regulations 2010 (schedule 5, part 1, paragraph 19) a variation may comprise a consolidated permit reflecting the variations and a notice specifying the variations included in that consolidated permit.

Schedule 1 of the notice specifies the conditions that have been varied and schedule 2 comprises a consolidated permit which reflects the variations being made.

This application varies the existing permit EAWML/83498 which includes a Materials Recovery Facility (MRF), Waste Transfer Station and a Household Waste Recycling Centre (HWRC). The variation will change the existing MRF activity into a Refuse Derived Fuel (RDF) facility. The Refuse Derived Fuel facility will be a schedule 1 installation activity 'disposal of non-hazardous waste with a capacity exceeding 50 tonnes per day involving physico-chemical treatment'. This variation does not change any of the operations except for the MRF.

Greenwich Integrated Waste Management Facility is located approximately 1km west of Thamesmead and 1 km north of Abbey Wood. The site is surrounded by industrial/commercial uses being part of an established industrial area.

The design waste throughput capacity of the new RDF facility will be a maximum of 26 tonnes per hour. The facility is expected to process up to 60,000 tonnes per annum. The RDF facility will accept household, commercial and industrial wastes. Metals will be removed from the waste stream using an over-band magnet post shredding. The shredded waste will be compacted into bales and wrapped ready for storage and loading onto bulk vehicles for onward export to energy plants.

The quantities of waste received at the site will remain below the maximum tonnage of 411,000 tonnes per year as currently permitted.

The existing drainage is sufficient to facilitate the change to the MRF building. The existing site drainage comprises a sealed system, with surface water run-off from the external yard area draining to foul sewer, via an interceptor. Only clean surface water run-off from the building roofs is discharged to surface water sewer.

There will be no point source emissions to air from the new facility. There will be no point source emissions to land from the new facility as waste input, treatment and baling will all be contained within the RDF building.

The schedules specify the changes made to the permit.

The status log of a permit sets out the permitting history, including any changes to the permit reference number

Status log of the permit		
Description	Date	Comments
EAWML/83498	03/11/2004	Permit issued
EAWML/83498	27/09/2005	Variation issued
EAWML/83498	07/11/2008	Variation issued
Application EPR/DP3390EL/V003	Duly made 15/04/2016	
Response to Schedule 5 Notice dated 12/05/2016	Received 17/06/2016	

<b>Status log of the permit</b>		
<b>Description</b>	<b>Date</b>	<b>Comments</b>
Response to Schedule 5 Notice dated 15/07/2016	Received 28/07/2016	
Response to Schedule 5 Notice dated 16/08/2016	Received 31/08/2016	
Variation determined EPR/DP3390EL/V003 Permit EPR/DP3390EL (PAS reference number - CP3136RW)	22/09/16	Varied permit issued.

End of introductory note

# Notice of variation and consolidation

## The Environmental Permitting (England and Wales) Regulations 2010

The Environment Agency in exercise of its powers under regulation 20 of the Environmental Permitting (England and Wales) Regulations 2010 varies and consolidates

### Permit number

**EPR/DP3390EL**

### Issued to

**Veolia ES Cleanaway (UK) Ltd** (“the operator”)

whose registered office is

**210 Pentonville Road**

**London**

**N1 9JY**

company registration number 00806128

to operate a regulated facility at

**Greenwich Integrated Waste Management Facility**

**Nathan Way**

**Thameshead**

**London**

**SE28 0AN**

to the extent set out in the schedules.

The notice shall take effect from 22/09/2016

Name	Date
Emma Pemberton	22/09/2016

Authorised on behalf of the Environment Agency

## **Schedule 1**

All conditions have been varied by the consolidated permit as a result of the application made by the operator.

## **Schedule 2 – consolidated permit**

Consolidated permit issued as a separate document.

# Permit

## The Environmental Permitting (England and Wales) Regulations 2010

### Permit number

**EPR/DP3390EL**

This is the consolidated permit referred to in the variation and consolidation notice for application EPR/DP3390EL/V003 authorising,

**Veolia ES Cleanaway (UK) Ltd** (“the operator”),

whose registered office is

**210 Pentonville Road  
London  
N1 9JY**

company registration number 00806128

to operate an installation at

**Greenwich Integrated Waste Management Facility  
Nathan Way  
Thameshead  
London  
SE28 0AN**

to the extent authorised by and subject to the conditions of this permit.

<b>Name</b>	<b>Date</b>
<b>Emma Pemberton</b>	<b>22/09/2016</b>

Authorised on behalf of the Environment Agency

# Conditions

## 1 Management

### 1.1 General management

- 1.1.1 The operator shall manage and operate the activities:
- (a) in accordance with a written management system that identifies and minimises risks of pollution, including those arising from operations, maintenance, accidents, incidents, non-conformances, closure and those drawn to the attention of the operator as a result of complaints; and
  - (b) using sufficient competent persons and resources.
- 1.1.2 Records demonstrating compliance with condition 1.1.1 shall be maintained.
- 1.1.3 Any person having duties that are or may be affected by the matters set out in this permit shall have convenient access to a copy of it kept at or near the place where those duties are carried out.
- 1.1.4 The operator shall comply with the requirements of an approved competence scheme

### 1.2 Energy efficiency

- 1.2.1 For the following activities referenced in schedule 1, table S1.1 (Activity A1) The operator shall:
- (a) take appropriate measures to ensure that energy is used efficiently in the activities;
  - (b) review and record at least every four years whether there are suitable opportunities to improve the energy efficiency of the activities; and
  - (c) take any further appropriate measures identified by a review.

### 1.3 Efficient use of raw materials

- 1.3.1 For the following activities referenced in schedule 1, table S1.1 (Activity A1) The operator shall:
- (a) take appropriate measures to ensure that raw materials and water are used efficiently in the activities;
  - (b) maintain records of raw materials and water used in the activities;
  - (c) review and record at least every four years whether there are suitable alternative materials that could reduce environmental impact or opportunities to improve the efficiency of raw material and water use; and
  - (d) take any further appropriate measures identified by a review.

### 1.4 Avoidance, recovery and disposal of wastes produced by the activities

- 1.4.1 The operator shall take appropriate measures to ensure that:
- (a) the waste hierarchy referred to in Article 4 of the Waste Framework Directive is applied to the generation of waste by the activities; and
  - (b) any waste generated by the activities is treated in accordance with the waste hierarchy referred to in Article 4 of the Waste Framework Directive; and
  - (c) where disposal is necessary, this is undertaken in a manner which minimises its impact on the environment.

- 1.4.2 The operator shall review and record at least every four years whether changes to those measures should be made and take any further appropriate measures identified by a review.

## **2 Operations**

### **2.1 Permitted activities**

- 2.1.1 The operator is only authorised to carry out the activities specified in schedule 1 table S1.1 (the “activities”).

### **2.2 The site**

- 2.2.1 The activities shall not extend beyond the site, being the land shown edged in red on the site plan at schedule 7 to this permit.

### **2.3 Operating techniques**

- 2.3.1 For the following activities referenced in schedule 1, table S1.1 (Activity A1) the activities shall, subject to the conditions of this permit, be operated using the techniques and in the manner described in the documentation specified in schedule 1, table S1.2, unless otherwise agreed in writing by the Environment Agency.
- 2.3.2 If notified by the Environment Agency that the activities are giving rise to pollution, the operator shall submit to the Environment Agency for approval within the period specified, a revision of any plan or other documentation (“plan”) specified in schedule 1, table S1.2 or otherwise required under this permit which identifies and minimises the risks of pollution relevant to that plan, and shall implement the approved revised plan in place of the original from the date of approval, unless otherwise agreed in writing by the Environment Agency.
- 2.3.3 Any raw materials or fuels listed in schedule 2 table S2.1 shall conform to the specifications set out in that table.
- 2.3.4 Waste shall only be accepted if:
- (a) it is of a type and quantity listed in schedule 2 tables S2.2, S2.3, S2.4; and
  - (b) it conforms to the description in the documentation supplied by the producer and holder..
- 2.3.5 The operator shall ensure that where waste produced by the activities is sent to a relevant waste operation, that operation is provided with the following information, prior to the receipt of the waste:
- (a) the nature of the process producing the waste;
  - (b) the composition of the waste;
  - (c) the handling requirements of the waste;
  - (d) the hazardous property associated with the waste, if applicable; and
  - (e) the waste code of the waste.
- 2.3.6 The operator shall ensure that where waste produced by the activities is sent to a landfill site, it meets the waste acceptance criteria for that landfill.

### **WEEE storage**

- 2.3.7 The storage (including temporary storage) and treatment of WEEE shall be carried out in accordance with the technical requirements of Annex VIII of the WEEE Directive.



## **Hazardous waste storage and treatment**

- 2.3.8 Hazardous waste shall not be mixed, either with a different category of hazardous waste or with other waste, substances or materials, unless it is authorised by schedule 1 table S1.1 and appropriate measures are taken.

## **2.4 Improvement programme**

- 2.4.1 The operator shall complete the improvements specified in schedule 1 table S1.3 by the date specified in that table unless otherwise agreed in writing by the Environment Agency.
- 2.4.2 Except in the case of an improvement which consists only of a submission to the Environment Agency, the operator shall notify the Environment Agency within 14 days of completion of each improvement.

## **3 Emissions and monitoring**

### **3.1 Emissions to water, air or land**

- 3.1.1 There shall be no point source emissions to water, air or land except from the sources and emission points listed in schedule 3 tables S3.1 and S3.2.
- 3.1.2 Periodic monitoring shall be carried out at least once every 5 years for groundwater and 10 years for soil, unless such monitoring is based on a systematic appraisal of the risk of contamination.

### **3.2 Emissions of substances not controlled by emission limits**

- 3.2.1 Emissions of substances not controlled by emission limits (excluding odour) shall not cause pollution. The operator shall not be taken to have breached this condition if appropriate measures, including, but not limited to, those specified in any approved emissions management plan, have been taken to prevent or where that is not practicable, to minimise, those emissions.
- 3.2.2 The operator shall:
- (a) if notified by the Environment Agency that the activities are giving rise to pollution, submit to the Environment Agency for approval within the period specified, an emissions management plan which identifies and minimises the risks of pollution from emissions of substances not controlled by emission limits;
  - (b) implement the approved emissions management plan, from the date of approval, unless otherwise agreed in writing by the Environment Agency.
- 3.2.3 All liquids in containers, whose emission to water or land could cause pollution, shall be provided with secondary containment, unless the operator has used other appropriate measures to prevent or where that is not practicable, to minimise, leakage and spillage from the primary container.

### **3.3 Odour**

- 3.3.1 Emissions from the activities shall be free from odour at levels likely to cause pollution outside the site, as perceived by an authorised officer of the Environment Agency, unless the operator has used appropriate measures, including, but not limited to, those specified in any approved odour management plan, to prevent or where that is not practicable to minimise the odour.
- 3.3.2 The operator shall:
- (a) if notified by the Environment Agency that the activities are giving rise to pollution outside the site due to odour, submit to the Environment Agency for approval within the period specified, an odour management plan which identifies and minimises the risks of pollution from odour;

- (b) implement the approved odour management plan, from the date of approval, unless otherwise agreed in writing by the Environment Agency.

### **3.4 Noise and vibration**

- 3.4.1 Emissions from the activities shall be free from noise and vibration at levels likely to cause pollution outside the site, as perceived by an authorised officer of the Environment Agency, unless the operator has used appropriate measures, including, but not limited to, those specified in any approved noise and vibration management plan to prevent or where that is not practicable to minimise the noise and vibration.
- 3.4.2 The operator shall:
  - (a) if notified by the Environment Agency that the activities are giving rise to pollution outside the site due to noise and vibration, submit to the Environment Agency for approval within the period specified, a noise and vibration management plan which identifies and minimises the risks of pollution from noise and vibration;
  - (b) implement the approved noise and vibration management plan, from the date of approval, unless otherwise agreed in writing by the Environment Agency.

### **3.5 Monitoring**

- 3.5.1 The operator shall, unless otherwise agreed in writing by the Environment Agency, undertake the monitoring specified in the following tables in schedule 3 to this permit:
  - (a) point source emissions specified in tables S3.1 and S3.2;
- 3.5.2 The operator shall maintain records of all monitoring required by this permit including records of the taking and analysis of samples, instrument measurements (periodic and continual), calibrations, examinations, tests and surveys and any assessment or evaluation made on the basis of such data.
- 3.5.3 Monitoring equipment, techniques, personnel and organisations employed for the emissions monitoring programme and the environmental or other monitoring specified in condition 3.5.1 shall have either MCERTS certification or MCERTS accreditation (as appropriate), where available, unless otherwise agreed in writing by the Environment Agency.
- 3.5.4 Permanent means of access shall be provided to enable sampling/monitoring to be carried out in relation to the emission points specified in schedule 3 tables S3.1 and S3.2 unless otherwise agreed in writing by the Environment Agency.

### **3.6 Pests**

- 3.6.1 The activities shall not give rise to the presence of pests which are likely to cause pollution, hazard or annoyance outside the boundary of the site. The operator shall not be taken to have breached this condition if appropriate measures, including, but not limited to, those specified in any approved pests management plan, have been taken to prevent or where that is not practicable, to minimise the presence of pests on the site.
- 3.6.2 The operator shall:
  - (a) if notified by the Environment Agency, submit to the Environment Agency for approval within the period specified, a pests management plan which identifies and minimises risks of pollution from pests;
  - (b) implement the pests management plan, from the date of approval, unless otherwise agreed in writing by the Environment Agency.

### **3.7 Fire prevention**

- 3.7.1 The operator shall take all appropriate measures to prevent fires on site and minimise the risk of pollution from them including, but not limited to, those specified in any approved fire prevention plan.

## **4 Information**

### **4.1 Records**

- 4.1.1 All records required to be made by this permit shall:
- (a) be legible;
  - (b) be made as soon as reasonably practicable;
  - (c) if amended, be amended in such a way that the original and any subsequent amendments remain legible, or are capable of retrieval; and
  - (d) be retained, unless otherwise agreed in writing by the Environment Agency, for at least 6 years from the date when the records were made, or in the case of the following records until permit surrender:
    - (i) off-site environmental effects; and
    - (ii) matters which affect the condition of the land and groundwater.
- 4.1.2 The operator shall keep on site all records, plans and the management system required to be maintained by this permit, unless otherwise agreed in writing by the Environment Agency.

### **4.2 Reporting**

- 4.2.1 The operator shall send all reports and notifications required by the permit to the Environment Agency using the contact details supplied in writing by the Environment Agency.
- 4.2.2 For the following activities referenced in schedule 1, table S1.1 (Activity A1) a report or reports on the performance of the activities over the previous year shall be submitted to the Environment Agency by 31 January (or other date agreed in writing by the Environment Agency) each year. The report(s) shall include as a minimum:
- (a) a review of the results of the monitoring and assessment carried out in accordance with the permit including an interpretive review of that data;
  - (b) the annual production /treatment data set out in schedule 4 table S4.1; and
  - (c) the performance parameters set out in schedule 4 table S4.2 using the forms specified in table S4.3 of that schedule.
- 4.2.3 The operator shall, unless notice under this condition has been served within the preceding four years, submit to the Environment Agency, within six months of receipt of a written notice, a report assessing whether there are other appropriate measures that could be taken to prevent, or where that is not practicable, to minimise pollution.
- 4.2.4 Within 1 month of the end of each quarter, the operator shall submit to the Environment Agency using the form made available for the purpose, the information specified on the form relating to the site and the waste accepted and removed from it during the previous quarter.

### **4.3 Notifications**

- 4.3.1 In the event:
- (a) that the operation of the activities gives rise to an incident or accident which significantly affects or may significantly affect the environment, the operator must immediately—
    - (i) inform the Environment Agency,

- (ii) take the measures necessary to limit the environmental consequences of such an incident or accident, and
    - (iii) take the measures necessary to prevent further possible incidents or accidents;
  - (b) of a breach of any permit condition the operator must immediately—
    - (i) inform the Environment Agency, and
    - (ii) take the measures necessary to ensure that compliance is restored within the shortest possible time;
  - (c) of a breach of permit condition which poses an immediate danger to human health or threatens to cause an immediate significant adverse effect on the environment, the operator must immediately suspend the operation of the activities or the relevant part of it until compliance with the permit conditions has been restored.
- 4.3.2 Any information provided under condition 4.3.1 shall be confirmed by sending the information listed in schedule 5 to this permit within the time period specified in that schedule.
- 4.3.3 Where the Environment Agency has requested in writing that it shall be notified when the operator is to undertake monitoring and/or spot sampling, the operator shall inform the Environment Agency when the relevant monitoring and/or spot sampling is to take place. The operator shall provide this information to the Environment Agency at least 14 days before the date the monitoring is to be undertaken.
- 4.3.4 The Environment Agency shall be notified within 14 days of the occurrence of the following matters, except where such disclosure is prohibited by Stock Exchange rules:
- Where the operator is a registered company:
- (a) any change in the operator's trading name, registered name or registered office address; and
  - (b) any steps taken with a view to the operator going into administration, entering into a company voluntary arrangement or being wound up.
- Where the operator is a corporate body other than a registered company:
- (a) any change in the operator's name or address; and
  - (b) any steps taken with a view to the dissolution of the operator.
- In any other case:
- (a) the death of any of the named operators (where the operator consists of more than one named individual);
  - (b) any change in the operator's name(s) or address(es); and
  - (c) any steps taken with a view to the operator, or any one of them, going into bankruptcy, entering into a composition or arrangement with creditors, or, in the case of them being in a partnership, dissolving the partnership.
- 4.3.5 Where the operator proposes to make a change in the nature or functioning, or an extension of the activities, which may have consequences for the environment and the change is not otherwise the subject of an application for approval under the Regulations or this permit:
- (a) the Environment Agency shall be notified at least 14 days before making the change; and
  - (b) the notification shall contain a description of the proposed change in operation.
- 4.3.6 The Environment Agency shall be given at least 14 days notice before implementation of any part of the site closure plan.

## 4.4 Interpretation

- 4.4.1 In this permit the expressions listed in schedule 6 shall have the meaning given in that schedule.

4.4.2 In this permit references to reports and notifications mean written reports and notifications, except where reference is made to notification being made “immediately”, in which case it may be provided by telephone.

# Schedule 1 – Operations

Table S1.1 activities			
Activity reference	Activity listed in Schedule 1 of the EP Regulations	Description of specified activity and WFD Annex I and II operations	Limits of specified activity and waste types
A1	S5.4 A1 (a) (ii) Disposal of non-hazardous waste with a capacity exceeding 50 tonnes per day involving physico-chemical treatment.	<p>Treatment consisting of sorting, compaction and shredding.</p> <p>D9: Physico-chemical treatment not specified elsewhere which results in final compounds or mixtures which are disposed of by any of the operations numbered D1 to D12.</p> <p>D14 (excluding temporary storage, pending collection, on the site where it is produced).</p> <p>D15 – Storage of waste pending any of the operations numbered D1 to D14 (excluding temporary storage, pending collection, on the site where it is produced).</p>	<p>From receipt and storage of non-hazardous waste, to storage prior to despatch of Refuse Derived Fuel (RDF).</p> <p>Physical treatment of solid non-hazardous waste including sorting, shredding and wrapping for the purpose of producing RDF.</p> <p>All treatment and storage must take place on an impermeable surface with sealed drainage.</p> <p>Waste types as specified in Table S2.2.</p> <p>All treatment must take place within a building.</p>
Activity reference	Description of activities for waste operations	Limits of activities	
A2 Waste Transfer Station	<p>R3: Recycling/reclamation of organic substances which are not used as solvents</p> <p>R4: Recycling/reclamation of metals and metal compounds</p> <p>R5: Recycling/reclamation of other inorganic compounds</p> <p>R13: Storage of waste pending any of the operations numbered R1 to R12 (excluding temporary storage, pending collection, on the site where it is produced)</p> <p>D14: Repackaging prior to submission to any of the operations numbered D1 to D13</p> <p>D15: Storage pending any of the operations numbered D 1 to D 14 (excluding temporary storage, pending collection, on the site where the waste is produced)</p>	<p>From receipt and temporary storage of non-hazardous and hazardous waste to transfer off site or to the RDF facility (Activity A1)</p> <p>Physical treatment of non-hazardous waste for disposal (no more than 50 tonnes per day) or recovery; including mixing, blending, shredding, screening, sorting/separation, crushing, compaction, and baling.</p> <p>Storage and treatment must take place on impermeable surface with sealed drainage.</p> <p>Manual and mechanical sorting/ separation of hazardous waste (not including asbestos waste). The maximum quantity of hazardous waste (not including asbestos waste) treated at the site (across all activities) shall not exceed 10 tonnes per day.</p>	

Table S1.1 activities			
Activity reference	Activity listed in Schedule 1 of the EP Regulations	Description of specified activity and WFD Annex I and II operations	Limits of specified activity and waste types
			<p>The maximum quantity of hazardous waste stored at the site (across all activities) shall not exceed 50 tonnes.</p> <p>Asbestos waste shall be double bagged and stored within clearly identified, segregated, secure, lockable containers on an impermeable surface with sealed drainage system. Asbestos waste will not be accepted for treatment, only for transfer offsite.</p> <p>Waste types as specified in Table S2.3</p>
<b>A3</b> Household Waste Recycling Centre	<p>R3: Recycling/reclamation of organic substances which are not used as solvents</p> <p>R4: Recycling/reclamation of metals and metal compounds</p> <p>R5: Recycling/reclamation of other inorganic compounds</p> <p>R13: Storage of waste pending any of the operations numbered R1 to R12 (excluding temporary storage, pending collection, on the site where it is produced)</p> <p>D14: Repackaging prior to submission to any of the operations numbered D1 to D13</p> <p>D15: Storage pending any of the operations numbered D 1 to D 14 (excluding temporary storage, pending collection, on the site where the waste is produced)</p>		<p>From receipt, treatment and temporary storage of non-hazardous and hazardous waste to dispatch off-site, transfer to the RDF facility (Activity A1) or transfer to the on-site Waste Transfer Station (Activity A2).</p> <p>Physical treatment of non-hazardous waste for disposal (no more than 50 tonnes per day) or recovery; including compaction, bulking, and manual and mechanical sorting/ separation.</p> <p>Manual sorting/ separation of hazardous waste (not including asbestos waste). The maximum quantity of hazardous waste (not including asbestos waste) treated at the site (across all activities) shall not exceed 10 tonnes per day.</p> <p>The maximum quantity of hazardous waste stored at the site (across all activities) shall not exceed 50 tonnes.</p> <p>Asbestos waste shall be double bagged and stored within clearly identified, segregated, secure, lockable containers on an impermeable surface with sealed drainage system.</p> <p>Waste types as specified in Table S2.4</p>

Table S1.2 Operating techniques		
Description	Parts	Date Received
Application EPR/DP3390EL/V003	Application forms C2 and C3 and all supporting documentation.	23/12/2015

<b>Table S1.2 Operating techniques</b>		
<b>Description</b>	<b>Parts</b>	<b>Date Received</b>
Response to Schedule 5 Notice dated 12/05/2016	Greenwich Integrated Waste Management Facility Fire Prevention Plan June 2016	17/06/2016
Response to Schedule 5 Notice dated 15/07/2016	Greenwich Integrated Waste Management Facility Fire Prevention Plan July 2016. Additional information on waste codes received.	28/07/2016
Response to Schedule 5 Notice dated 16/08/2016	Additional information received on the Fire Prevention Plan. Additional information on odour management received.	31/08/2016

<b>Table S1.3 Improvement condition requirements</b>		
<b>Reference</b>	<b>Requirement</b>	<b>Date</b>
IC1	The Operator shall submit a report confirming the finalised specifications of the proposed improvements to the current fire suppression system for the waste transfer station in order to meet the standards within Section 14 of 'Fire prevention plans: environmental permits' guidance. The report shall be submitted in writing to the Environment Agency for approval prior to installation of improvements to the suppression system.	22/10/2016
IC2	Once approved in writing by the Environment Agency, the improvements to the fire suppression system specified in accordance with improvement condition IC1 above shall be installed and commissioned. On completion of the improvement works, the operator shall submit a commissioning plan to the Environment Agency that includes, but need not be limited to, confirmation that the improvements have been completed.	22/03/2017
IC3	Following commissioning of the improved suppression system in the transfer station building the site's Fire Prevention Plan shall be updated accordingly and submitted to the Environment Agency for approval. The FPP shall reflect any changes resulting from the installation of the improved suppression system. The revised FPP will form part of the Operating Techniques referenced in Table 1.2 and supersede the plan (dated July 2016) currently referenced in the permit.	Within 1 month of completion of IC2 above
IC4	The Operator shall submit a written odour management plan to the Environment Agency for approval. The odour management plan shall be developed in line with Technical Guidance Note H4 'Odour management' and include a proposed timetable for completion of any improvement works. The Operator shall implement any necessary improvements to a timetable agreed in writing with the Environment Agency.	22/12/2016



## Schedule 2 – Waste types, raw materials and fuels

Raw materials and fuel description	Specification
-	-

<b>Maximum quantity</b>	<b>The total quantity of waste accepted for the production of RDF shall be no more than 60,000 tonnes per annum. The total waste accepted at site for all activities will not exceed 411,000 tonnes.</b>
<b>Waste code</b>	<b>Description</b>
<b>15</b>	<b>WASTE PACKAGING, ABSORBENTS, WIPING CLOTHS, FILTER MATERIALS AND PROTECTIVE CLOTHING NOT OTHERWISE SPECIFIED</b>
<b>15 01</b>	<b>packaging (including separately collected municipal packaging waste)</b>
15 01 01	paper and cardboard packaging
15 01 02	plastic packaging
15 01 03	wooden packaging
15 01 05	composite packaging
15 01 06	mixed packaging
15 01 09	textile packaging
<b>19</b>	<b>WASTES FROM WASTE MANAGEMENT FACILITIES, OFF-SITE WASTE WATER TREATMENT PLANTS AND THE PREPARATION OF WATER INTENDED FOR HUMAN CONSUMPTION AND WATER FOR INDUSTRIAL USE</b>
<b>19 12</b>	<b>wastes from the mechanical treatment of waste (for example sorting, crushing, compacting, pelletising) not otherwise specified</b>
19 12 01	paper and cardboard
19 12 04	plastic and rubber
19 12 07	wood other than that mentioned in 19 12 06
19 12 08	textiles
19 12 10	combustible waste (refuse derived fuel)
19 12 12	other wastes (including mixtures of materials) from mechanical treatment of wastes other than those mentioned in 19 12 11
<b>20</b>	<b>MUNICIPAL WASTES (HOUSEHOLD WASTE AND SIMILAR COMMERCIAL, INDUSTRIAL AND INSTITUTIONAL WASTES) INCLUDING SEPARATELY COLLECTED FRACTIONS</b>
<b>20 01</b>	<b>separately collected fractions (except 15 01)</b>
20 01 01	paper and cardboard
20 01 10	clothes

<b>Table S2.2 Permitted waste types and quantities for the production of Refuse Derived Fuel (RDF) – Activity Reference A1</b>	
<b>Maximum quantity</b>	<b>The total quantity of waste accepted for the production of RDF shall be no more than 60,000 tonnes per annum. The total waste accepted at site for all activities will not exceed 411,000 tonnes.</b>
20 01 11	textiles
20 01 38	wood other than that mentioned in 20 01 37
20 01 39	plastics
<b>20 02</b>	<b>garden and park wastes (including cemetery waste)</b>
20 02 03	other non-biodegradable wastes
<b>20 03</b>	<b>other municipal wastes</b>
20 03 01	mixed municipal waste
20 03 02	waste from markets
20 03 07	bulky waste

<b>Table S2.3 Permitted waste types and quantities for the Waste Transfer Station – Activity Reference A2</b>	
<b>Maximum quantity</b>	<b>The total waste accepted at site for all activities will not exceed 411,000 tonnes.</b>
<b>Waste code</b>	<b>Description</b>
<b>02</b>	<b>WASTES FROM AGRICULTURE, HORTICULTURE, AQUACULTURE, FORESTRY, HUNTING AND FISHING, FOOD PREPARATION AND PROCESSING</b>
<b>02 01</b>	<b>wastes from agriculture, horticulture, aquaculture, forestry, hunting and fishing</b>
02 01 03	plant-tissue waste
02 01 04	waste plastics (except packaging)
02 01 07	wastes from forestry
02 01 10	waste metal
<b>02 03</b>	<b>wastes from fruit, vegetables, cereals, edible oils, cocoa, coffee, tea and tobacco preparation and processing; conserve production; yeast and yeast extract production, molasses preparation and fermentation</b>
02 03 04	materials unsuitable for consumption or processing
<b>03</b>	<b>WASTES FROM WOOD PROCESSING AND THE PRODUCTION OF PANELS AND FURNITURE, PULP, PAPER AND CARDBOARD</b>
<b>03 01</b>	<b>wastes from wood processing and the production of panels and furniture</b>
03 01 01	waste bark and cork
03 01 05	sawdust, shavings, cuttings, wood, particle board and veneer other than those mentioned in 03 01 04
<b>03 03</b>	<b>wastes from pulp, paper and cardboard production and processing</b>
03 03 01	waste bark and wood
03 03 07	mechanically separated rejects from pulping of waste paper and cardboard
03 03 08	wastes from sorting of paper and cardboard destined for recycling
03 03 10	fibre rejects, fibre-, filler- and coating-sludges from mechanical separation
<b>04</b>	<b>WASTES FROM THE LEATHER, FUR AND TEXTILE INDUSTRIES</b>

<b>Table S2.3 Permitted waste types and quantities for the Waste Transfer Station – Activity Reference A2</b>	
<b>Maximum quantity</b>	<b>The total waste accepted at site for all activities will not exceed 411,000 tonnes.</b>
<b>Waste code</b>	<b>Description</b>
<b>04 02</b>	<b>wastes from the textile industry</b>
04 02 09	wastes from composite materials (impregnated textile, elastomer, plastomer)
04 02 10	organic matter from natural products (for example grease, wax)
04 02 15	wastes from finishing other than those mentioned in 04 02 14
04 02 21	wastes from unprocessed textile fibres
04 02 22	wastes from processed textile fibres
<b>08</b>	<b>WASTES FROM THE MANUFACTURE, FORMULATION, SUPPLY AND USE (MFSU) OF COATINGS (PAINTS, VARNISHES AND VITREOUS ENAMELS), ADHESIVES, SEALANTS AND PRINTING INKS</b>
<b>08 01</b>	<b>wastes from MFSU and removal of paint and varnish</b>
08 01 11*	waste paint and varnish containing organic solvents or other hazardous substances
08 01 12	waste paint and varnish other than those mentioned in 08 01 11
08 01 18	wastes from paint or varnish removal other than those mentioned in 08 01 17
08 01 21*	waste paint or varnish remover
<b>08 02</b>	<b>wastes from MFSU of other coatings (including ceramic materials)</b>
08 02 01	waste coating powders
<b>08 03</b>	<b>wastes from MFSU of printing inks</b>
08 03 17*	waste printing toner containing hazardous substances
08 03 18	waste printing toner other than those mentioned in 08 03 17
<b>08 04</b>	<b>wastes from MFSU of adhesives and sealants (including water proofing products)</b>
08 04 09*	waste adhesives and sealants containing organic solvents or other hazardous substances
08 04 10	waste adhesives and sealants other than those mentioned in 08 04 09
<b>09</b>	<b>WASTES FROM THE PHOTOGRAPHIC INDUSTRY</b>
<b>09 01</b>	<b>wastes from the photographic industry</b>
09 01 07	photographic film and paper containing silver or silver compounds
09 01 08	photographic film and paper free of silver or silver compounds
09 01 10	single-use cameras without batteries
09 01 12	single-use cameras containing batteries other than those mentioned in 09 01 11
<b>10</b>	<b>WASTES FROM THERMAL PROCESSES</b>
<b>10 01</b>	<b>wastes from power stations and other combustion plants (except 19)</b>
10 01 19	wastes from gas cleaning other than those mentioned in 10 01 05, 10 01 07 and 10 01 18
10 01 24	sands from fluidised beds
<b>10 11</b>	<b>wastes from manufacture of glass and glass products</b>
10 11 03	waste glass-based fibrous materials
10 11 12	waste glass other than those mentioned in 10 11 11

<b>Table S2.3 Permitted waste types and quantities for the Waste Transfer Station – Activity Reference A2</b>	
<b>Maximum quantity</b>	<b>The total waste accepted at site for all activities will not exceed 411,000 tonnes.</b>
<b>Waste code</b>	<b>Description</b>
<b>10 12</b>	<b>wastes from manufacture of ceramic goods, bricks, tiles and construction products</b>
10 12 01	waste preparation mixture before thermal processing
10 12 06	discarded moulds
10 12 08	waste ceramics, bricks, tiles and construction products (after thermal processing)
10 12 10	solid wastes from gas treatment other than those mentioned in 10 12 09
10 12 12	wastes from glazing other than those mentioned in 10 12 11
<b>10 13</b>	<b>wastes from manufacture of cement, lime and plaster and articles and products made from them</b>
10 13 01	waste preparation mixture before thermal processing
10 13 04	wastes from calcination and hydration of lime
10 13 11	wastes from cement-based composite materials other than those mentioned in 10 13 09 and 10 13 10
10 13 13	solid wastes from gas treatment other than those mentioned in 10 13 12
10 13 14	waste concrete and concrete sludge
<b>13</b>	<b>OIL WASTES AND WASTES OF LIQUID FUELS (EXCEPT EDIBLE OILS, AND THOSE IN CHAPTERS 05, 12 AND 19)</b>
13 01 09*	mineral-based chlorinated hydraulic oils
13 01 10*	mineral based non-chlorinated hydraulic oils
13 01 11*	synthetic hydraulic oils
13 01 12*	readily biodegradable hydraulic oils
13 01 13*	other hydraulic oils
<b>13 02</b>	<b>waste engine, gear and lubricating oils</b>
13 02 04*	mineral-based chlorinated engine, gear and lubricating oils
13 02 05*	mineral-based non-chlorinated engine, gear and lubricating oils
13 02 06*	synthetic engine, gear and lubricating oils
13 02 07*	readily biodegradable engine, gear and lubricating oils
13 02 08*	other engine, gear and lubricating oils
<b>15</b>	<b>WASTE PACKAGING, ABSORBENTS, WIPING CLOTHS, FILTER MATERIALS AND PROTECTIVE CLOTHING NOT OTHERWISE SPECIFIED</b>
<b>15 01</b>	<b>packaging (including separately collected municipal packaging waste)</b>
15 01 01	paper and cardboard packaging
15 01 02	plastic packaging
15 01 03	wooden packaging
15 01 04	metallic packaging
15 01 05	composite packaging
15 01 06	mixed packaging

<b>Table S2.3 Permitted waste types and quantities for the Waste Transfer Station – Activity Reference A2</b>	
<b>Maximum quantity</b>	<b>The total waste accepted at site for all activities will not exceed 411,000 tonnes.</b>
<b>Waste code</b>	<b>Description</b>
15 01 07	glass packaging
15 01 09	textile packaging
<b>15 02</b>	<b>absorbents, filter materials, wiping cloths and protective clothing</b>
15 02 03	absorbents, filter materials, wiping cloths and protective clothing other than those mentioned in 15 02 02
<b>16 01</b>	<b>WASTES NOT OTHERWISE SPECIFIED IN THE LIST</b>
<b>16 01</b>	<b>end-of-life vehicles from different means of transport (including off-road machinery) and wastes from dismantling of end-of-life vehicles and vehicle maintenance (except 13, 14, 16 06 and 16 08)</b>
16 01 03	end-of-life tyres
16 01 17	ferrous metal
16 01 18	non-ferrous metal
16 01 19	plastic
16 01 20	glass
16 01 22	components not otherwise specified
<b>16 02</b>	<b>wastes from electrical and electronic equipment</b>
16 02 11*	discarded equipment containing chlorofluorocarbons, HCFC, HFC
16 02 13*	discarded equipment containing hazardous components other than those mentioned in 16 02 09 to 16 02 12
16 02 14	discarded equipment other than those mentioned in 16 02 09 to 16 02 13
16 02 16	components removed from discarded equipment other than those mentioned in 16 02 15
<b>16 03</b>	<b>off-specification batches and unused products</b>
16 03 04	inorganic wastes other than those mentioned in 16 03 03
16 03 06	organic wastes other than those mentioned in 16 03 05
<b>16 05</b>	<b>gases in pressure containers and discarded chemicals</b>
16 05 05	gases in pressure containers other than those mentioned in 16 05 04
16 05 09	discarded chemicals other than those mentioned in 16 05 06, 16 05 07 or 16 05 08
<b>16 06</b>	<b>batteries and accumulators</b>
16 06 01*	lead batteries
16 06 02*	Ni-Cd batteries
16 06 03*	mercury-containing batteries
16 06 04	alkaline batteries (except 16 06 03)
16 06 05	other batteries and accumulators
<b>17</b>	<b>CONSTRUCTION AND DEMOLITION WASTES (INCLUDING EXCAVATED SOIL FROM CONTAMINATED SITES)</b>
<b>17 01</b>	<b>concrete, bricks, tiles and ceramics</b>
17 01 01	concrete

<b>Table S2.3 Permitted waste types and quantities for the Waste Transfer Station – Activity Reference A2</b>	
<b>Maximum quantity</b>	<b>The total waste accepted at site for all activities will not exceed 411,000 tonnes.</b>
<b>Waste code</b>	<b>Description</b>
17 01 02	bricks
17 01 03	tiles and ceramics
17 01 07	mixtures of concrete, bricks, tiles and ceramics other than those mentioned in 17 01 06
<b>17 02</b>	<b>wood, glass and plastic</b>
17 02 01	wood
17 02 02	glass
17 02 03	plastic
<b>17 04</b>	<b>metals (including their alloys)</b>
17 04 01	copper, bronze, brass
17 04 02	aluminium
17 04 03	lead
17 04 04	zinc
17 04 05	iron and steel
17 04 06	tin
17 04 07	mixed metals
17 04 11	cables other than those mentioned in 17 04 10
<b>17 05</b>	<b>soil (including excavated soil from contaminated sites), stones and dredging spoil</b>
17 05 04	soil and stones other than those mentioned in 17 05 03
<b>17 06</b>	<b>insulation materials and asbestos-containing construction materials</b>
17 06 01*	insulation materials containing asbestos
17 06 04	insulation materials other than those mentioned in 17 06 01 and 17 06 03
17 06 05*	construction materials containing asbestos
<b>17 08</b>	<b>gypsum-based construction material</b>
17 08 02	gypsum-based construction materials other than those mentioned in 17 08 01
<b>17 09</b>	<b>other construction and demolition wastes</b>
17 09 04	mixed construction and demolition wastes other than those mentioned in 17 09 01, 17 09 02 and 17 09 03
<b>18</b>	<b>WASTES FROM HUMAN OR ANIMAL HEALTH CARE AND/OR RELATED RESEARCH (EXCEPT KITCHEN AND RESTAURANT WASTES NOT ARISING FROM IMMEDIATE HEALTH CARE)</b>
<b>18 01</b>	<b>wastes from natal care, diagnosis, treatment or prevention of disease in humans</b>
18 01 01	sharps (except 18 01 03)
18 01 02	body parts and organs including blood bags and blood preserves (except 18 01 03)
18 01 03*	wastes whose collection and disposal is subject to special requirements in order to prevent infection
18 01 04	wastes whose collection and disposal is not subject to special requirements in order to prevent infection (for example dressings, plaster casts, linen, disposable clothing, diapers)

<b>Table S2.3 Permitted waste types and quantities for the Waste Transfer Station – Activity Reference A2</b>	
<b>Maximum quantity</b>	<b>The total waste accepted at site for all activities will not exceed 411,000 tonnes.</b>
<b>Waste code</b>	<b>Description</b>
18 01 07	chemicals other than those mentioned in 18 01 06
18 01 08*	cytotoxic and cytostatic medicines
18 01 09	medicines other than those mentioned in 18 01 08
<b>19</b>	<b>WASTES FROM WASTE MANAGEMENT FACILITIES, OFF-SITE WASTE WATER TREATMENT PLANTS AND THE PREPARATION OF WATER INTENDED FOR HUMAN CONSUMPTION AND WATER FOR INDUSTRIAL USE</b>
<b>19 12</b>	<b>wastes from the mechanical treatment of waste (for example sorting, crushing, compacting, pelletising) not otherwise specified</b>
19 12 01	paper and cardboard
19 12 02	ferrous metal
19 12 03	non-ferrous metal
19 12 04	plastic and rubber
19 12 05	glass
19 12 07	wood other than that mentioned in 19 12 06
19 12 08	textiles
19 12 09	minerals (for example sand, stones)
19 12 10	combustible waste (refuse derived fuel)
19 12 12	other wastes (including mixtures of materials) from mechanical treatment of wastes other than those mentioned in 19 12 11
<b>19 13</b>	<b>wastes from soil and groundwater remediation</b>
19 13 02	solid wastes from soil remediation other than those mentioned in 19 13 01
<b>20</b>	<b>MUNICIPAL WASTES (HOUSEHOLD WASTE AND SIMILAR COMMERCIAL, INDUSTRIAL AND INSTITUTIONAL WASTES) INCLUDING SEPARATELY COLLECTED FRACTIONS</b>
<b>20 01</b>	<b>separately collected fractions (except 15 01)</b>
20 01 01	paper and cardboard
20 01 02	glass
20 01 08	biodegradable kitchen and canteen waste
20 01 10	clothes
20 01 11	textiles
20 01 21*	fluorescent tubes and other mercury-containing waste
20 01 23*	discarded equipment containing chlorofluorocarbons
20 01 25	edible oil and fat
20 01 27*	paint, inks, adhesives and resins containing hazardous substances
20 01 28	paint, inks, adhesives and resins other than those mentioned in 20 01 27
20 01 30	detergents other than those mentioned in 20 01 29
20 01 33*	batteries and accumulators included in 16 06 01, 16 06 02 or 16 06 03 and unsorted batteries and accumulators containing these batteries

<b>Table S2.3 Permitted waste types and quantities for the Waste Transfer Station – Activity Reference A2</b>	
<b>Maximum quantity</b>	<b>The total waste accepted at site for all activities will not exceed 411,000 tonnes.</b>
<b>Waste code</b>	<b>Description</b>
20 01 34	batteries and accumulators other than those mentioned in 20 01 33
20 01 35*	discarded electrical and electronic equipment other than those mentioned in 20 01 21 and 20 01 23 containing hazardous components
20 01 36	discarded electrical and electronic equipment other than those mentioned in 20 01 21, 20 01 23 and 20 01 35
20 01 38	wood other than that mentioned in 20 01 37
20 01 39	plastics
20 01 40	metals
20 01 41	wastes from chimney sweeping
20 01 99	Only wastes comprising of non-clinical human and animal offensive/hygiene waste which is not subject to special requirements in order to prevent infection (not arising from healthcare and/or related research i.e. not including waste from natal care, diagnosis, treatment or prevention of disease).
<b>20 02</b>	<b>garden and park wastes (including cemetery waste)</b>
20 02 01	biodegradable waste
20 02 02	soil and stones
20 02 03	other non-biodegradable wastes
<b>20 03</b>	<b>other municipal wastes</b>
20 03 01	mixed municipal waste
20 03 02	waste from markets
20 03 03	street-cleaning residues
20 03 07	bulky waste

<b>Table S2.4 Permitted waste types and quantities for the Household Waste Recycling Centre – Activity Reference A3</b>	
<b>Maximum quantity</b>	<b>The total quantity of waste accepted at the Household Waste Recycling Centre shall be no more than 13,000 tonnes per annum.</b>
	<b>The total waste accepted at site for all activities will not exceed 411,000 tonnes.</b>
<b>Waste code</b>	<b>Description</b>
<b>08</b>	<b>WASTES FROM THE MANUFACTURE, FORMULATION, SUPPLY AND USE (MFSU) OF COATINGS (PAINTS, VARNISHES AND VITREOUS ENAMELS), ADHESIVES, SEALANTS AND PRINTING INKS</b>
<b>08 03</b>	<b>wastes from MFSU of printing inks</b>
08 03 17*	waste printing toner containing hazardous substances
08 03 18	waste printing toner other than those mentioned in 08 03 17
<b>13</b>	<b>OIL WASTES AND WASTES OF LIQUID FUELS (EXCEPT EDIBLE OILS, AND THOSE IN CHAPTERS 05, 12 AND 19)</b>
13 01 09*	mineral-based chlorinated hydraulic oils



**Table S2.4 Permitted waste types and quantities for the Household Waste Recycling Centre – Activity Reference A3**

<b>Maximum quantity</b>	<b>The total quantity of waste accepted at the Household Waste Recycling Centre shall be no more than 13,000 tonnes per annum.</b>  <b>The total waste accepted at site for all activities will not exceed 411,000 tonnes.</b>
<b>Waste code</b>	<b>Description</b>
13 01 10*	mineral based non-chlorinated hydraulic oils
13 01 11*	synthetic hydraulic oils
13 01 12*	readily biodegradable hydraulic oils
13 01 13*	other hydraulic oils
<b>13 02</b>	<b>waste engine, gear and lubricating oils</b>
13 02 04*	mineral-based chlorinated engine, gear and lubricating oils
13 02 05*	mineral-based non-chlorinated engine, gear and lubricating oils
13 02 06*	synthetic engine, gear and lubricating oils
13 02 07*	readily biodegradable engine, gear and lubricating oils
13 02 08*	other engine, gear and lubricating oils
<b>15</b>	<b>WASTE PACKAGING, ABSORBENTS, WIPING CLOTHS, FILTER MATERIALS AND PROTECTIVE CLOTHING NOT OTHERWISE SPECIFIED</b>
<b>15 01</b>	<b>packaging (including separately collected municipal packaging waste)</b>
15 01 01	paper and cardboard packaging
15 01 02	plastic packaging
15 01 03	wooden packaging
15 01 04	metallic packaging
15 01 05	composite packaging
15 01 06	mixed packaging
15 01 07	glass packaging
15 01 09	textile packaging
<b>15 02</b>	<b>absorbents, filter materials, wiping cloths and protective clothing</b>
15 02 03	absorbents, filter materials, wiping cloths and protective clothing other than those mentioned in 15 02 02
<b>16 01</b>	<b>WASTES NOT OTHERWISE SPECIFIED IN THE LIST</b>
<b>16 01</b>	<b>end-of-life vehicles from different means of transport (including off-road machinery) and wastes from dismantling of end-of-life vehicles and vehicle maintenance (except 13, 14, 16 06 and 16 08)</b>
16 01 03	end-of-life tyres
<b>16 05</b>	<b>gases in pressure containers and discarded chemicals</b>
16 05 05	gases in pressure containers other than those mentioned in 16 05 04
16 05 09	discarded chemicals other than those mentioned in 16 05 06, 16 05 07 or 16 05 08
<b>16 06</b>	<b>batteries and accumulators</b>
16 06 01*	lead batteries

**Table S2.4 Permitted waste types and quantities for the Household Waste Recycling Centre – Activity Reference A3**

<b>Maximum quantity</b>	<p>The total quantity of waste accepted at the Household Waste Recycling Centre shall be no more than 13,000 tonnes per annum.</p> <p>The total waste accepted at site for all activities will not exceed 411,000 tonnes.</p>
<b>Waste code</b>	<b>Description</b>
<b>17</b>	<b>CONSTRUCTION AND DEMOLITION WASTES (INCLUDING EXCAVATED SOIL FROM CONTAMINATED SITES)</b>
<b>17 01</b>	<b>concrete, bricks, tiles and ceramics</b>
17 01 01	concrete
17 01 02	bricks
17 01 03	tiles and ceramics
17 01 07	mixtures of concrete, bricks, tiles and ceramics other than those mentioned in 17 01 06
<b>17 06</b>	<b>insulation materials and asbestos-containing construction materials</b>
17 06 05*	construction materials containing asbestos
<b>17 08</b>	<b>gypsum-based construction material</b>
17 08 02	gypsum-based construction materials other than those mentioned in 17 08 01
<b>17 09</b>	<b>other construction and demolition wastes</b>
17 09 04	mixed construction and demolition wastes other than those mentioned in 17 09 01, 17 09 02 and 17 09 03
<b>20</b>	<b>MUNICIPAL WASTES (HOUSEHOLD WASTE AND SIMILAR COMMERCIAL, INDUSTRIAL AND INSTITUTIONAL WASTES) INCLUDING SEPARATELY COLLECTED FRACTIONS</b>
<b>20 01</b>	<b>separately collected fractions (except 15 01)</b>
20 01 01	paper and cardboard
20 01 02	glass
20 01 08	biodegradable kitchen and canteen waste
20 01 10	clothes
20 01 11	textiles
20 01 21*	fluorescent tubes and other mercury-containing waste
20 01 23*	discarded equipment containing chlorofluorocarbons
20 01 25	edible oil and fat
20 01 27*	paint, inks, adhesives and resins containing hazardous substances
20 01 28	paint, inks, adhesives and resins other than those mentioned in 20 01 27
20 01 30	detergents other than those mentioned in 20 01 29
20 01 33*	batteries and accumulators included in 16 06 01, 16 06 02 or 16 06 03 and unsorted batteries and accumulators containing these batteries
20 01 34	batteries and accumulators other than those mentioned in 20 01 33
20 01 35*	discarded electrical and electronic equipment other than those mentioned in 20 01 21 and 20 01 23 containing hazardous components
20 01 36	discarded electrical and electronic equipment other than those mentioned in 20 01 21, 20 01 23 and 20 01 35
20 01 38	wood other than that mentioned in 20 01 37

**Table S2.4 Permitted waste types and quantities for the Household Waste Recycling Centre – Activity Reference A3**

<b>Maximum quantity</b>	<p>The total quantity of waste accepted at the Household Waste Recycling Centre shall be no more than 13,000 tonnes per annum.</p> <p>The total waste accepted at site for all activities will not exceed 411,000 tonnes.</p>
<b>Waste code</b>	<b>Description</b>
20 01 39	plastics
20 01 40	metals
<b>20 02</b>	<b>garden and park wastes (including cemetery waste)</b>
20 02 01	biodegradable waste
20 02 02	soil and stones
20 02 03	other non-biodegradable wastes
<b>20 03</b>	<b>other municipal wastes</b>
20 03 01	mixed municipal waste
20 03 02	waste from markets
20 03 03	street-cleaning residues
20 03 07	bulky waste

## Schedule 3 – Emissions and monitoring

<b>Table S3.1 Point source emissions to sewer – emission limits and monitoring requirements</b>						
<b>Emission point ref. &amp; location</b>	<b>Source</b>	<b>Parameter</b>	<b>Limit (including unit)</b>	<b>Reference period</b>	<b>Monitoring frequency</b>	<b>Monitoring standard or method</b>
Emission point to sewer via an interceptor	Wash down water and run off from external yard area	No parameters set	No limit set	-	-	-

<b>Table S3.2 Point Source emissions to water (other than sewer) and land – emission limits and monitoring requirements</b>						
<b>Emission point ref. &amp; location</b>	<b>Source</b>	<b>Parameter</b>	<b>Limit (incl. unit)</b>	<b>Reference Period</b>	<b>Monitoring frequency</b>	<b>Monitoring standard or method</b>
Emission point to surface water	Uncontaminated surface run off from building roofs	No parameters set	No limit set	-	-	-

## Schedule 4 – Reporting

Parameters, for which reports shall be made, in accordance with conditions of this permit, are listed below.

<b>Table S4.1 Annual Production/treatment</b>		
<b>Parameter</b>	<b>Frequency of assessment</b>	<b>Units</b>
Production of Refuse Derived Fuel	Annually	tonnes

<b>Table S4.2 Performance parameters</b>		
<b>Parameter</b>	<b>Frequency of assessment</b>	<b>Units</b>
Water usage	Annually	tonnes
Energy usage	Annually	MWh

<b>Table S4.2 Reporting forms</b>		
<b>Media/parameter</b>	<b>Reporting format</b>	<b>Date of form</b>
Water usage	Form water usage 1 or other form as agreed in writing by the Environment Agency	22/09/16
Energy usage	Form energy 1 or other form as agreed in writing by the Environment Agency	22/09/16
Other performance indicators	Form performance 1 or other form as agreed in writing by the Environment Agency	22/09/16

## Schedule 5 – Notification

These pages outline the information that the operator must provide.

Units of measurement used in information supplied under Part A and B requirements shall be appropriate to the circumstances of the emission. Where appropriate, a comparison should be made of actual emissions and authorised emission limits.

If any information is considered commercially confidential, it should be separated from non-confidential information, supplied on a separate sheet and accompanied by an application for commercial confidentiality under the provisions of the EP Regulations.

### Part A

Permit Number	
Name of operator	
Location of Facility	
Time and date of the detection	

<b>(a) Notification requirements for any malfunction, breakdown or failure of equipment or techniques, accident, or emission of a substance not controlled by an emission limit which has caused, is causing or may cause significant pollution</b>	
<b>To be notified within 24 hours of detection</b>	
Date and time of the event	
Reference or description of the location of the event	
Description of where any release into the environment took place	
Substances(s) potentially released	
Best estimate of the quantity or rate of release of substances	
Measures taken, or intended to be taken, to stop any emission	
Description of the failure or accident.	

<b>(b) Notification requirements for the breach of a limit</b>	
<b>To be notified within 24 hours of detection unless otherwise specified below</b>	
Emission point reference/ source	
Parameter(s)	
Limit	
Measured value and uncertainty	
Date and time of monitoring	

<b>(b) Notification requirements for the breach of a limit</b>	
<b>To be notified within 24 hours of detection unless otherwise specified below</b>	
Measures taken, or intended to be taken, to stop the emission	

<b>Time periods for notification following detection of a breach of a limit</b>	
<b>Parameter</b>	<b>Notification period</b>

<b>(c) Notification requirements for the detection of any significant adverse environmental effect</b>	
<b>To be notified within 24 hours of detection</b>	
Description of where the effect on the environment was detected	
Substances(s) detected	
Concentrations of substances detected	
Date of monitoring/sampling	

## Part B – to be submitted as soon as practicable

Any more accurate information on the matters for notification under Part A.	
Measures taken, or intended to be taken, to prevent a recurrence of the incident	
Measures taken, or intended to be taken, to rectify, limit or prevent any pollution of the environment which has been or may be caused by the emission	
The dates of any unauthorised emissions from the facility in the preceding 24 months.	

Name*	
Post	
Signature	
Date	

\* authorised to sign on behalf of the operator

## Schedule 6 – Interpretation

“accident” means an accident that may result in pollution.

“application” means the application for this permit, together with any additional information supplied by the operator as part of the application and any response to a notice served under Schedule 5 to the EP Regulations.

“authorised officer” means any person authorised by the Environment Agency under section 108(1) of The Environment Act 1995 to exercise, in accordance with the terms of any such authorisation, any power specified in section 108(4) of that Act.

“disposal”. Means any of the operations provided for in Annex I to Directive 2008/98/EC of the European Parliament and of the Council on waste.

“emissions to land” includes emissions to groundwater.

“EP Regulations” means The Environmental Permitting (England and Wales) Regulations SI 2010 No.675 and words and expressions used in this permit which are also used in the Regulations have the same meanings as in those Regulations.

“emissions of substances not controlled by emission limits” means emissions of substances to air, water or land from the activities, either from the emission points specified in schedule 3 or from other localised or diffuse sources, which are not controlled by an emission or background concentration limit.

“groundwater” means all water, which is below the surface of the ground in the saturation zone and in direct contact with the ground or subsoil.

“Hazardous property” has the meaning in Annex III of the Waste Framework Directive.

“Hazardous waste” has the meaning given in the Hazardous Waste (England and Wales) Regulations 2005 (as amended).

“Industrial Emissions Directive” means DIRECTIVE 2010/75/EU OF THE EUROPEAN PARLIAMENT AND OF THE COUNCIL of 24 November 2010 on industrial emissions

“Pests” means Birds, Vermin and Insects.

“quarter” means a calendar year quarter commencing on 1 January, 1 April, 1 July or 1 October.

Drafting note: only use above definition if condition 4.2.5 used

“recovery” means any of the operations provided for in Annex II to Directive 2008/98/EC of the European Parliament and of the Council on waste.

“Waste code” means the six digit code referable to a type of waste in accordance with the List of Wastes and in relation to hazardous waste, includes the asterisk.

“Waste Framework Directive” or “WFD” means Waste Framework Directive 2008/98/EC of the European Parliament and of the Council on waste

Where a minimum limit is set for any emission parameter, for example pH, reference to exceeding the limit shall mean that the parameter shall not be less than that limit.

Unless otherwise stated, any references in this permit to concentrations of substances in emissions into air means:

- in relation to emissions from combustion processes, the concentration in dry air at a temperature of 273K, at a pressure of 101.3 kPa and with an oxygen content of 3% dry for liquid and gaseous fuels, 6% dry for solid fuels; and/or
- in relation to emissions from non-combustion sources, the concentration at a temperature of 273K and at a pressure of 101.3 kPa, with no correction for water vapour content.

“year” means calendar year ending 31 December



# Schedule 7 – Site plan

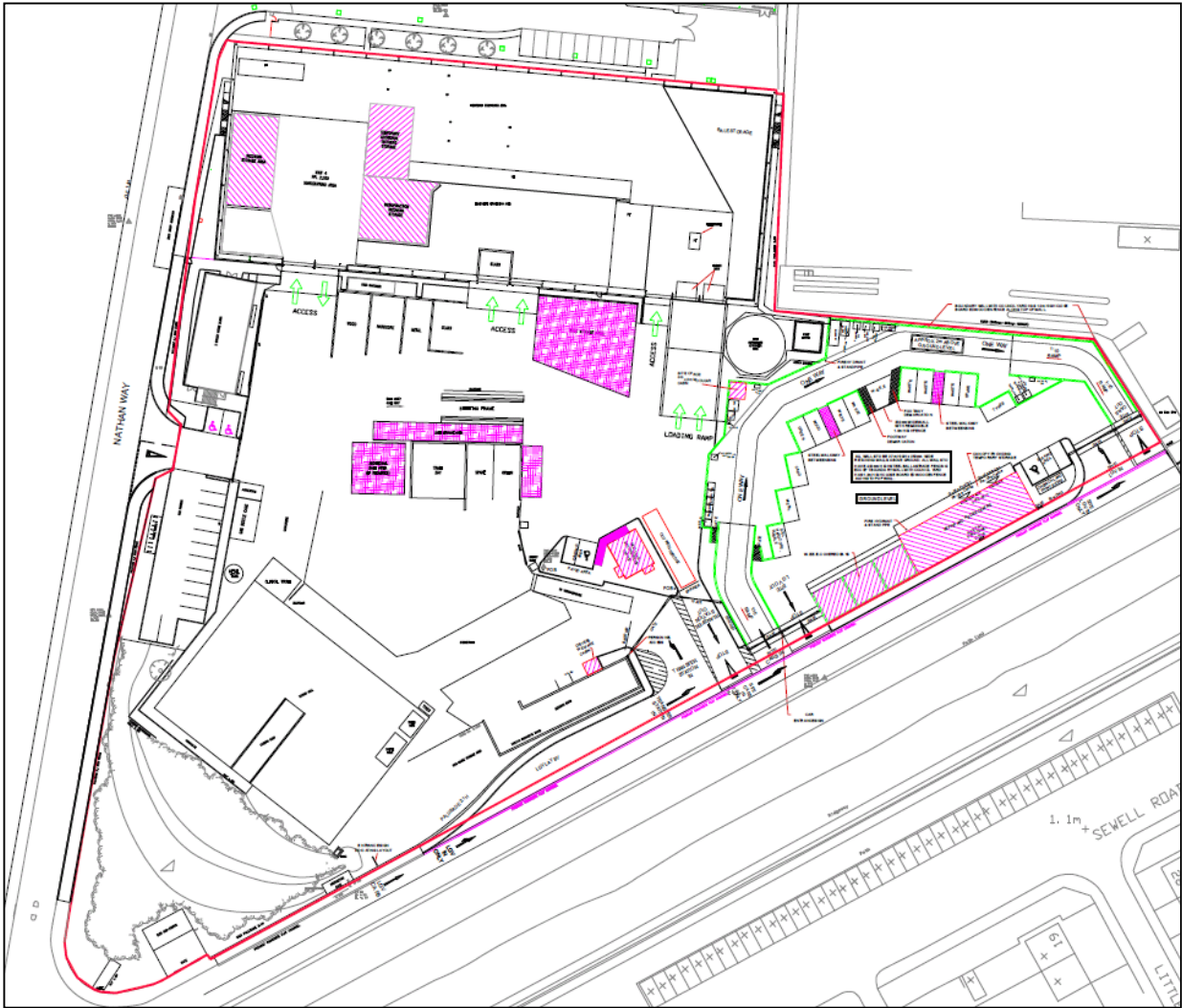

END OF PERMIT