

---

## Order Decision

Site visit made on 16 November 2015

**by Alison Lea MA (Cantab) Solicitor**

**an Inspector appointed by the Secretary of State for Environment, Food and Rural Affairs**

**Decision date: 27 July 2016**

---

### **Order Ref: FPS/U1050/7/94M**

- This Order is made under Section 53 (2) (b) of the Wildlife and Countryside Act 1981 (the 1981 Act) and is known as the Derbyshire County Council (Footpath along Rowfields Lane between the B5035 and the Parish Boundary – Parish of Kniveton) Modification Order 2014.
- Derbyshire County Council submitted the Order to the Secretary of State for Environment, Food and Rural Affairs for confirmation.
- The Order is dated 27 March 2014 and proposes to modify the Definitive Map and Statement for the area by adding a footpath as shown on the Order plan and described in the Order Schedule.
- In accordance with paragraph 8(2) of Schedule 15 to the 1981 Act I have given notice of my proposal to confirm the Order subject to modifications.

**Summary of Decision: The Order is confirmed subject to the modifications that I formerly proposed.**

---

### **Procedural Matters**

1. The effect of the Order if confirmed with the modifications that I previously proposed would be to add a public footpath of a specified width between Points A and C on the Order plan.
2. Following notice of my proposed modifications one representation and one objection were submitted. However the objection was not made within the statutory period and did not contain any relevant new evidence and the representation was withdrawn.

### **Conclusions**

3. Bearing in mind the above I conclude that the Order should be confirmed subject to the modifications set out in paragraph 52 of my interim decision dated 17 December 2015.

### **Formal Decision**

4. I confirm the Order subject to the modifications previously proposed:
  - In the title to and paragraph 3 of the Order and in the annotation on the Plan to the Order delete the words "THE PARISH BOUNDARY" after "BETWEEN THE B5035 AND" and insert "KNIVETON PUBLIC FOOTPATH No 12"
  - In Part I of the Schedule to the Order delete the words "the parish boundary with Fenny Bentley at Point B (GR SK 1912 4974) a distance

of 730 metres or thereabouts” and insert “Kniveton Public Footpath No 12 at Point C (GR SK 1914 4972) a distance of 701 metres or thereabouts and a width varying between 2 and 3.2 metres”

- In Part II of the Schedule to the Order delete the word “Approx.” from the heading “Approx. Width”
- In Part II of the Schedule to the Order, under Status and Description of Route, delete the words “the parish boundary with Fenny Bentley (GR SK 1913 4974) and insert “Kniveton Public Footpath No 12 (GR SK 1914 4972)
- In Part II of the Schedule to the Order, under Approx. Length delete the figure “730” and insert “701”
- In Part II of the Schedule to the Order, under Width, delete “GR SK 1913 4974” and insert GR SK 1914 4972”
- On the plan to the Order insert Point C as shown in red and delete the route between Points B and C

*Alison Lea*

**Inspector**

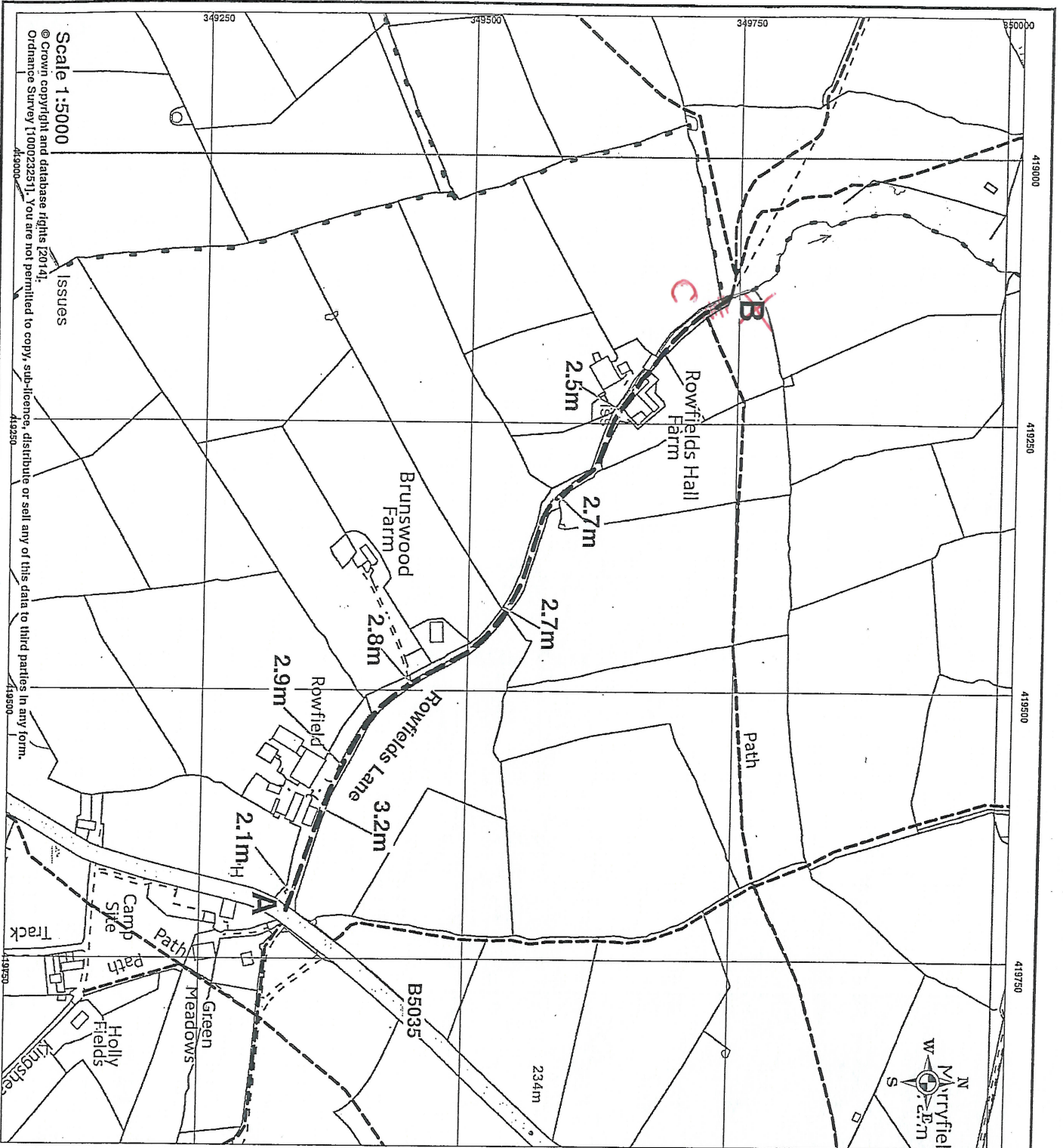

Scale 1:5000

© Crown copyright and database rights (2014).  
Ordnance Survey (100023251). You are not permitted to copy, sub-licence, distribute or sell any of this data to third parties in any form.

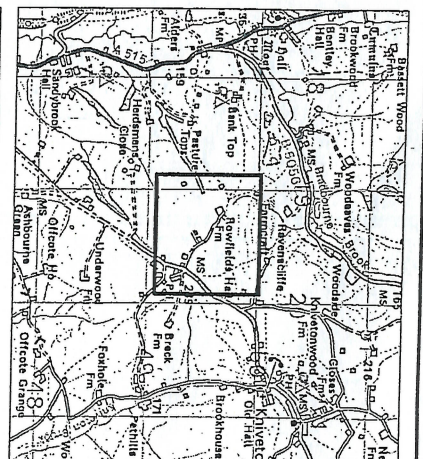

Wildlife and Countryside Act 1981 S.53

The Derbyshire County Council  
(Footpath along Rowfields Lane  
between B5035 and the parish  
boundary - Parish of Kniveton)  
Modification Order 2014

# KEY

- Footpath to be added ————
- Existing footpaths - - - - -
- Parish boundary ————



Improving life for local people

Mike Ashworth  
Strategic Director - Economy, Transport & Environment  
Shand House  
Dale Road South  
Matlock  
Derbyshire  
DE4 3RY

Produced by Public Rights of Way on 17 March 2014  
Ref: PE/AVX3722/Order/2014

KNIVETON  
PUBLIC  
FOOTPATH  
No 12