

Notice of variation and consolidation with introductory note

The Environmental Permitting (England & Wales) Regulations 2010

R G & W Whitfield Limited

Balladoyle Farm
Silloth
Cumbria
CA7 4QA

Variation application number

EPR/VP3639KY/V003

Permit number

EPR/VP3639KY

Balladoyle Farm

Permit number EPR/VP3639KY

Introductory note

This introductory note does not form a part of the notice.

Under the Environmental Permitting (England & Wales) Regulations 2010 (schedule 5, part 1, paragraph 19) a variation may comprise a consolidated permit reflecting the variations and a notice specifying the variations included in that consolidated permit.

Schedule 1 of the notice specifies the conditions that have been varied and schedule 2 comprises a consolidated permit which reflects the variations being made. Only the variations specified in schedule 1 are subject to a right of appeal.

This variation is for the use of two biomass boilers (<0.5MW total thermal input) to provide heat to the poultry buildings. At the request of the Applicant the permit has been consolidated with previous variations and updated to the latest permit template. It incorporates the changes required by the Industrial Emissions Directive. This includes the amendment of the wording of several permit conditions. This also includes the addition of a condition relating to a requirement for routine monitoring, and an associated reporting condition.

The schedules specify the changes made to the original permit.

The main features of the permit are as follows.

Balladoyle Farm is located within Cumbria. It lies approximately 2 kilometres south east of the village of Silloth and approximately 2.5 kilometres to the east of the Solway Firth coast. The installation is designed for the sole purpose of rearing broiler birds for meat production with 100,000 places.

Ventilation consists of ridge fans and side inlets. All walls and roofs are fitted with insulation.

Nipple drinker lines are used to reduce wastage of water and to maintain dry litter, subsequently reducing ammonia levels inside the shed.

Broilers are brought in from a hatchery and are reared until slaughter at 49 days of age following an all in/all out managerial programme. On depletion of the site the empty houses will be washed down and disinfected before beginning a new cycle. Wash is channelled to underground collection tanks and later spread on to land on the farm. Spent litter is removed from the site to be spread on agricultural land.

Daily mortalities are removed from the sheds and the numbers recorded. Carcasses are stored in sealed vermin proof containers before being collected by a licensed collection agent.

The status log of a permit sets out the permitting history, including any changes to the permit reference number.

Status log of the permit

Description	Date	Comments
Application EPR/VP3639KY/A001	Duly made 10/08/2010	
Updated drainage plan legend received		26/10/2010
Permit determined	15/12/2010	
Application EPR/VP3639KY/V002 (PP3031CL)	Duly made 25/06/2012	Received as streamlined application, not eligible, therefore changed to normal variation
Variation determined	30/07/2012	
Variation application EPR/VP3639KY/V003	Duly made 23/04/2014	Add two biomass boilers and consolidate
Variation issued EPR/VP3639KY/V003 (billing reference DP3432VD)	15/05/2014	

End of introductory note

Notice of variation and consolidation

The Environmental Permitting (England and Wales) Regulations 2010

The Environment Agency in exercise of its powers under regulation 20 of the Environmental Permitting (England and Wales) Regulations 2010 varies and consolidates

permit number
EPR/VP3639KY

issued to
R G & W Whitfield Limited (“the operator”)

whose registered office is

Balladoyle Farm
Silloth
Wigton
Cumbria
CA7 4QA

company registration number 05928491

to operate a regulated facility at

Balladoyle Farm
Silloth
Wigton
Cumbria
CA7 4QA

to the extent set out in the schedules.

The notice shall take effect from 15/05/2014

Name	Date
Anne Nightingale	15/05/2014

Authorised on behalf of the Environment Agency

Schedule 1

Only conditions 1.4.1, 1.4.2, 2.3.1, 2.3.6, 2.3.7, 3.1.2, 3.6, 4.3.1, table S1.1, table S1.2, table S2.1, table S3.1, table S3.2, table S3.4, schedule 6 and schedule 7 have been varied by the consolidated permit ERP/VP3639KY as a result of the application made by the operator.

Schedule 2 – consolidated permit

Consolidated permit issued as a separate document.

Permit

The Environmental Permitting (England and Wales) Regulations 2010

Permit number
EPR/VP3639KY

This is the consolidated permit referred to in the variation and consolidation notice for application EPR/VP3639KY/V003 authorising,

R G & W Whitfield Limited (“the operator”),
whose registered office is

Balladoyle Farm
Silloth
Wigton
Cumbria
CA7 4QA

company registration number 05928491

to operate an installation at

Balladoyle Farm
Silloth
Wigton
Cumbria
CA7 4QA

to the extent authorised by and subject to the conditions of this permit.

Name	Date
Anne Nightingale	15/05/2014

Authorised on behalf of the Environment Agency

Conditions

1 Management

1.1 General management

1.1.1 The operator shall manage and operate the activities:

- (a) in accordance with a written management system that identifies and minimises risks of pollution, including those arising from operations, maintenance, accidents, incidents, non-conformances, closure and those drawn to the attention of the operator as a result of complaints; and
- (b) using sufficient competent persons and resources.

1.1.2 Records demonstrating compliance with condition 1.1.1 shall be maintained.

1.1.3 Any person having duties that are or may be affected by the matters set out in this permit shall have convenient access to a copy of it kept at or near the place where those duties are carried out.

1.2 Energy efficiency

1.2.1 The operator shall:

- (a) take appropriate measures to ensure that energy is used efficiently in the activities;
- (b) review and record at least every four years whether there are suitable opportunities to improve the energy efficiency of the activities; and
- (c) take any further appropriate measures identified by a review.

1.3 Efficient use of raw materials

1.3.1 The operator shall:

- (a) take appropriate measures to ensure that raw materials and water are used efficiently in the activities;
- (b) maintain records of raw materials and water used in the activities;
- (c) review and record at least every four years whether there are suitable alternative materials that could reduce environmental impact or opportunities to improve the efficiency of raw material and water use; and
- (d) take any further appropriate measures identified by a review.

1.4 Avoidance, recovery and disposal of wastes produced by the activities

1.4.1 The operator shall take appropriate measures to ensure that:

- (a) the waste hierarchy referred to in Article 4 of the Waste Framework Directive is applied to the generation of waste by the activities; and
- (b) any waste generated by the activities is treated in accordance with the waste hierarchy referred to in Article 4 of the Waste Framework Directive; and
- (c) where disposal is necessary, this is undertaken in a manner which minimises its impact on the environment.

- 1.4.2 The operator shall review and record at least every four years whether changes to those measures should be made and take any further appropriate measures identified by a review.

2 Operations

2.1 Permitted activities

- 2.1.1 The operator is only authorised to carry out the activities specified in schedule 1 table S1.1 (the “activities”).

2.2 The site

- 2.2.1 The activities shall not extend beyond the site, being the land shown edged in green on the site plan at schedule 7 to this permit.

2.3 Operating techniques

- 2.3.1 (a) The activities shall, subject to the conditions of this permit, be operated using the techniques and in the manner described in the documentation specified in schedule 1, table S1.2, unless otherwise agreed in writing by the Environment Agency.
- (b) If notified by the Environment Agency that the activities are giving rise to pollution, the operator shall submit to the Environment Agency for approval within the period specified, a revision of any plan or other documentation (“plan”) specified in schedule 1, table S1.2 or otherwise required under this permit which identifies and minimises the risks of pollution relevant to that plan, and shall implement the approved revised plan in place of the original from the date of approval, unless otherwise agreed in writing by the Environment Agency.
- 2.3.2 The operator shall maintain and implement a system to record the number of animal places and animal movements.
- 2.3.3 The operator shall take appropriate measures in off-site disposal or recovery of solid manure or slurry to prevent, or where this is not practicable to minimise, pollution.
- 2.3.4 The operator shall:
- (a) maintain and implement a manure management plan;
- (b) review and record at least every four years whether changes to the plan should be made;
- (c) make any appropriate changes to the plan identified by the review.
- 2.3.5 The operator shall ensure that where waste produced by the activities is sent to a landfill site, it meets the waste acceptance criteria for that landfill.
- 2.3.6 The operator shall ensure that where waste produced by the activities is sent to a relevant waste operation, that operation is provided with the following information, prior to the receipt of the waste:
- (a) the nature of the process producing the waste;
- (b) the composition of the waste;
- (c) the handling requirements of the waste;
- (d) the hazardous property associated with the waste, if applicable; and
- (e) the waste code of the waste.
- 2.3.7 Any raw materials or fuels listed in schedule 2 table S2.1 shall conform to the specifications set out in that table.

3 Emissions and monitoring

3.1 Emissions to water, air or land

- 3.1.1 There shall be no point source emissions to water, air or land except from the sources and emission points listed in schedule 3 tables S3.1, S3.2 and S3.3.
- 3.1.2 Periodic monitoring shall be carried out at least once every 5 years for groundwater and 10 years for soil, unless such monitoring is based on a systematic appraisal of the risk of contamination

3.2 Emissions of substances not controlled by emission limits

- 3.2.1 Emissions of substances not controlled by emission limits (excluding odour) shall not cause pollution. The operator shall not be taken to have breached this condition if appropriate measures, including, but not limited to, those specified in any approved emissions management plan, have been taken to prevent or where that is not practicable, to minimise, those emissions.
- 3.2.3 All liquids in containers, whose emission to water or land could cause pollution, shall be provided with secondary containment, unless the operator has used other appropriate measures to prevent or where that is not practicable, to minimise, leakage and spillage from the primary container.

3.3 Odour

- 3.3.1 Emissions from the activities shall be free from odour at levels likely to cause pollution outside the site, as perceived by an authorised officer of the Environment Agency, unless the operator has used appropriate measures, including, but not limited to, those specified in any approved odour management plan, to prevent or where that is not practicable to minimise the odour.

3.4 Noise and vibration

- 3.4.1 Emissions from the activities shall be free from noise and vibration at levels likely to cause pollution outside the site, as perceived by an authorised officer of the Environment Agency, unless the operator has used appropriate measures, including, but not limited to, those specified in any approved noise and vibration management plan to prevent or where that is not practicable to minimise the noise and vibration.

3.6 Pests

- 3.6.1 The activities shall not give rise to the presence of pests which are likely to cause pollution, hazard or annoyance outside the boundary of the site. The operator shall not be taken to have breached this condition if appropriate measures, including, but not limited to, those specified in any approved pests management plan, have been taken to prevent or where that is not practicable, to minimise the presence of pests on the site.
- 3.6.2 The operator shall:
- (a) if notified by the Environment Agency, submit to the Environment Agency for approval within the period specified, a pests management plan which identifies and minimises risks of pollution, hazard or annoyance from pests;

- (b) implement the pests management plan, from the date of approval, unless otherwise agreed in writing by the Environment Agency.

4 Information

4.1 Records

4.1.1 All records required to be made by this permit shall:

- (a) be legible;
- (b) be made as soon as reasonably practicable;
- (c) if amended, be amended in such a way that the original and any subsequent amendments remain legible, or are capable of retrieval; and
- (d) be retained, unless otherwise agreed in writing by the Environment Agency, for at least 6 years from the date when the records were made, or in the case of the following records until permit surrender:
 - (i) off-site environmental effects; and
 - (ii) matters which affect the condition of the land and groundwater.

4.1.2 The operator shall keep on site all records, plans and the management system required to be maintained by this permit, unless otherwise agreed in writing by the Environment Agency.

4.2 Reporting

4.2.1 The operator shall send all reports and notifications required by the permit to the Environment Agency using the contact details supplied in writing by the Environment Agency.

4.2.2 The operator shall, unless notice under this condition has been served within the preceding four years, submit to the Environment Agency, within six months of receipt of a written notice, a report assessing whether there are other appropriate measures that could be taken to prevent, or where that is not practicable, to minimise pollution.

4.3 Notifications

- 4.3.1
- (a) In the event that the operation of the activities gives rise to an incident or accident which significantly affects or may significantly affect the environment, the operator must immediately—
 - (i) inform the Environment Agency,
 - (ii) take the measures necessary to limit the environmental consequences of such an incident or accident, and
 - (iii) take the measures necessary to prevent further possible incidents or accidents;
 - (b) in the event of a breach of any permit condition the operator must immediately—
 - (i) inform the Environment Agency, and
 - (ii) take the measures necessary to ensure that compliance is restored within the shortest possible time;
 - (c) in the event of a breach of permit condition which poses an immediate danger to human health or threatens to cause an immediate significant adverse effect on the environment, the operator must immediately suspend the operation of the activities or the relevant part of it until compliance with the permit conditions has been restored.

4.3.2 Any information provided under condition 4.3.1 shall be confirmed by sending the information listed in schedule 5 to this permit within the time period specified in that schedule.

- 4.3.3 Where the Environment Agency has requested in writing that it shall be notified when the operator is to undertake monitoring and/or spot sampling, the operator shall inform the Environment Agency when the relevant monitoring and/or spot sampling is to take place. The operator shall provide this information to the Environment Agency at least 14 days before the date the monitoring is to be undertaken.
- 4.3.4 The Environment Agency shall be notified within 14 days of the occurrence of the following matters, except where such disclosure is prohibited by Stock Exchange rules:
- Where the operator is a registered company:
- (a) any change in the operator's trading name, registered name or registered office address; and
 - (b) any steps taken with a view to the operator going into administration, entering into a company voluntary arrangement or being wound up.
- Where the operator is a corporate body other than a registered company:
- (a) any change in the operator's name or address; and
 - (b) any steps taken with a view to the dissolution of the operator.
- In any other case:
- (a) the death of any of the named operators (where the operator consists of more than one named individual);
 - (b) any change in the operator's name(s) or address(es); and
 - (c) any steps taken with a view to the operator, or any one of them, going into bankruptcy, entering into a composition or arrangement with creditors, or, in the case of them being in a partnership, dissolving the partnership.
- 4.3.5 Where the operator proposes to make a change in the nature or functioning, or an extension of the activities, which may have consequences for the environment and the change is not otherwise the subject of an application for approval under the Regulations or this permit:
- (a) the Environment Agency shall be notified at least 14 days before making the change; and
 - (b) the notification shall contain a description of the proposed change in operation.
- 4.3.6 The Environment Agency shall be given at least 14 days notice before implementation of any part of the site closure plan.
- 4.3.7 Where the operator has entered into a climate change agreement with the Government, the Environment Agency shall be notified within one month of:
- (a) a decision by the Secretary of State not to re-certify the agreement;
 - (b) a decision by either the operator or the Secretary of State to terminate the agreement; and
 - (c) any subsequent decision by the Secretary of State to re-certify such an agreement.

4.4 Interpretation

- 4.4.1 In this permit the expressions listed in schedule 6 shall have the meaning given in that schedule.
- 4.4.2 In this permit references to reports and notifications mean written reports and notifications, except where reference is made to notification being made "without delay", in which case it may be provided by telephone.

Schedule 1 - operations

Table S1.1 activities		
Activity listed in Schedule 1 of the EP Regulations	Description of specified activity	Limits of specified activity
Section 6.9 A(1)(a) (i) Rearing of poultry intensively in an installation with more than 40,000 places.	The rearing of poultry in a facility with a capacity for 100,000 broiler places.	From receipt of birds, raw materials and fuels onto the site, to removal of birds and associated wastes from site
Directly Associated Activity		
Biomass Boiler	Operation of two biomass boilers with a maximum (aggregated) thermal input not exceeding 0.5 MW for site heating requirements, burning biomass fuel not comprising waste or animal carcasses.	From receipt of raw materials and fuels, to release of combustion products to air and associated wastes removed from site.

Table S1.2 Operating techniques		
Description	Parts	Date Received
Application	Responses to Part B3 section 3 of the application form and referenced supporting documentation	10/08/2010
Application	Odour management plan reference Appendix 8 and Noise management plan reference Appendix 9 in response to Part B3 section 3b, Table 3b	10/08/2010
Request for Information dated 20/10/2010	Response to Request for Information confirming site drainage plan legend	26/10/2010
Variation application EPR/VP3639KY/V003	<ul style="list-style-type: none"> • The response to question 3a of application form C3 • Appendix 7 • Appendix 11 	23/04/2014

Schedule 2 - waste types, raw materials and fuels

Table S2.1 Raw materials and fuels	
Raw materials and fuel description	Specification
Fuel for biomass boiler units	Biomass pellets or chips comprising only virgin timber, straw, miscanthus or a combination of these.

Schedule 3 – emissions and monitoring

Table S3.1 Point source emissions to air – emission limits and monitoring requirements						
Emission point ref. & location	Parameter	Source	Limit (including unit)	Reference period	Monitoring frequency	Monitoring standard or method
Roof fan outlets on buildings 1 and 2 as shown on 'Site plan' of application EPR/VP3639KY/V003	---	Poultry shed 1 and 2	---	---	---	---
Rear fan outlets on buildings 1 and 2 as shown on 'Site plan' of application EPR/VP3639KY/V003	---	Poultry shed 1 and 2	---	---	---	---
BB1 as shown on 'Site plan' of application EPR/VP3639KY/V003	---	Biomass Boiler	---	---	---	---
BB2 as shown on the 'Site plan' of application EPR/VP3639KY/V003	---	Biomass boiler	---	---	---	---

Table S3.2 Point Source emissions to water (other than sewer) – emission limits and monitoring requirements						
Emission point ref. & location	Parameter	Source	Limit (incl. unit)	Reference Period	Monitoring frequency	Monitoring standard or method
Yard drainage shown with blue broken arrow on the 'drainage plan' of application EPR/VP3639KY/V003	---	Yard areas around site office	---	---	---	---

Table S3.3 Point source emissions to land– emission limits and monitoring requirements						
	Parameter	Source	Limit (incl. Unit)	Reference period	Monitoring frequency	Monitoring standard or method
Rainwater flow from buildings/yards, emission to soakaway shown on the 'drainage plan' of application EPR/VP3639KY/V003	---	Water from roofs of poultry sheds and surrounding yard areas	---	---	---	---

Schedule 4 - reporting

There is no reporting under this schedule.

Schedule 5 - notification

These pages outline the information that the operator must provide.

Units of measurement used in information supplied under Part A and B requirements shall be appropriate to the circumstances of the emission. Where appropriate, a comparison should be made of actual emissions and authorised emission limits.

If any information is considered commercially confidential, it should be separated from non-confidential information, supplied on a separate sheet and accompanied by an application for commercial confidentiality under the provisions of the EP Regulations.

Part A

Permit Number	VP3639KY
Name of operator	R G & W Whitfield Ltd
Location of Facility	Balladoyle Farm, Silloth, Cumbria, CA7 4QA
Time and date of the detection	

(a) Notification requirements for any activity that gives rise to an incident or accident which significantly affects or may significantly affect the environment

To be notified Immediately	
Date and time of the event	
Reference or description of the location of the event	
Description of where any release into the environment took place	
Substances(s) potentially released	
Best estimate of the quantity or rate of release of substances	
Measures taken, or intended to be taken, to stop any emission	
Description of the failure or accident.	

(b) Notification requirements for the breach of a limit

To be notified immediately	
Emission point reference/ source	
Parameter(s)	
Limit	
Measured value and uncertainty	
Date and time of monitoring	
Measures taken, or intended to be taken, to stop the emission	

Time periods for notification following detection of a breach of a limit	
Parameter	Notification period

(c) Notification requirements for the detection of any significant adverse environmental effect	
To be notified within 24 hours of detection	
Description of where the effect on the environment was detected	
Substances(s) detected	
Concentrations of substances detected	
Date of monitoring/sampling	

Part B - to be submitted as soon as practicable

Any more accurate information on the matters for notification under Part A.	
Measures taken, or intended to be taken, to prevent a recurrence of the incident	
Measures taken, or intended to be taken, to rectify, limit or prevent any pollution of the environment which has been or may be caused by the emission	
The dates of any unauthorised emissions from the facility in the preceding 24 months.	

Name*	
Post	
Signature	
Date	

* authorised to sign on behalf of R G & W Whitfield Ltd

Schedule 6 - Interpretation

“*accident*” means an accident that may result in pollution.

“*annually*” means once every year.

“*application*” means the application for this permit, together with any additional information supplied by the operator as part of the application and any response to a notice served under Schedule 5 to the EP Regulations.

“*emissions to land*” includes emissions to groundwater.

“*EP Regulations*” means The Environmental Permitting (England and Wales) Regulations SI 2010 No.675 and words and expressions used in this permit which are also used in the Regulations have the same meanings as in those Regulations.

“*emissions of substances not controlled by emission limits*” means emissions of substances to air, water or land from the activities, either from the emission points specified in schedule 3 or from other localised or diffuse sources, which are not controlled by an emission or background concentration limit.

“*groundwater*” means all water, which is below the surface of the ground in the saturation zone and in direct contact with the ground or subsoil.

“*quarter*” means a calendar year quarter commencing on 1 January, 1 April, 1 July or 1 October.

“*year*” means calendar year ending 31 December.

“*authorised officer*” means any person authorised by the Environment Agency under section 108(1) of The Environment Act 1995 to exercise, in accordance with the terms of any such authorisation, any power specified in section 108(4) of that Act.

“*Manure and slurry*” have the following meaning:

- Manures may be either slurries or solid manures.
- Slurries consist of excreta produced by livestock whilst in a yard or building mixed with rainwater and wash water and, in some cases, waste bedding and feed. Slurries can be pumped or discharged by gravity.
- Slurry includes duck effluent, seepage from manure and wash water.
- Solid manures include farmyard manure (FYM) and comprise material from straw-based housing systems, excreta with lots of straw/sawdust/woodchips in it, or solids from mechanical separators.
- Most poultry systems produce solid manure (litter).
- Solid manure can generally be stacked.

“*Manure management plan*” means the requirements described in Section 2.3 of SGN 6.09 How to Comply – Intensive Farming.

“*SGN How to comply – Intensive Farming*” The EPR Sector Guidance Note 6.09 for intensive pig and poultry farmers.

“virgin timber” means timber from

- whole trees and the woody parts of trees including branches and bark derived from forestry works, woodland management, tree surgery and other similar operations (it does not include clippings or trimmings that consist primarily of foliage);
- virgin wood processing (e.g. wood offcuts, pellets, chips, shavings or sawdust from sawmills) or timber product manufacture dealing in virgin timber.

If virgin timber is mixed with waste timber or any other waste, the mixed load is classed as waste.

Schedule 7 - site plan

Site Location Plan

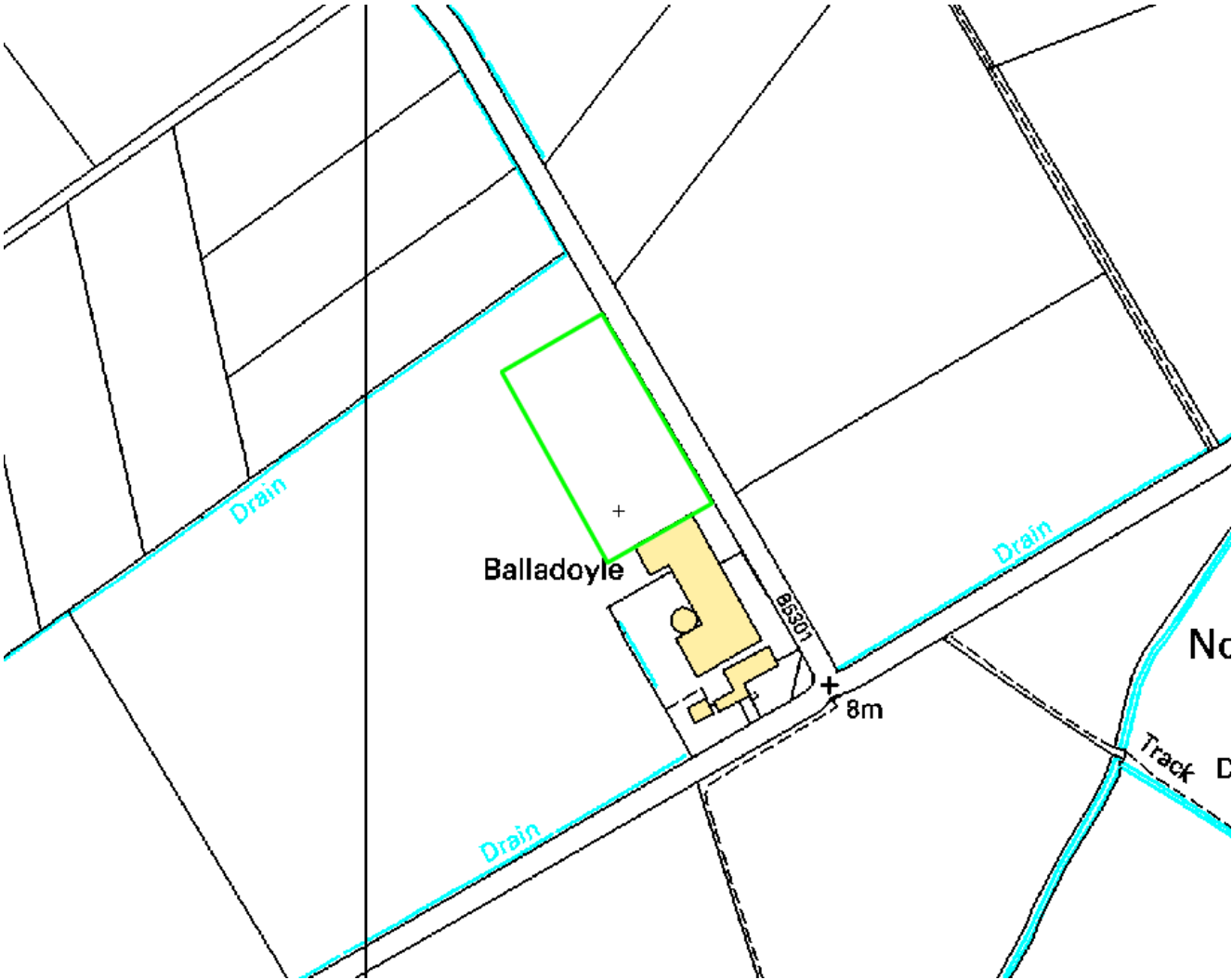

“©Crown Copyright. All rights reserved. Environment Agency, 100026380, 2010.”

Site Layout Plan

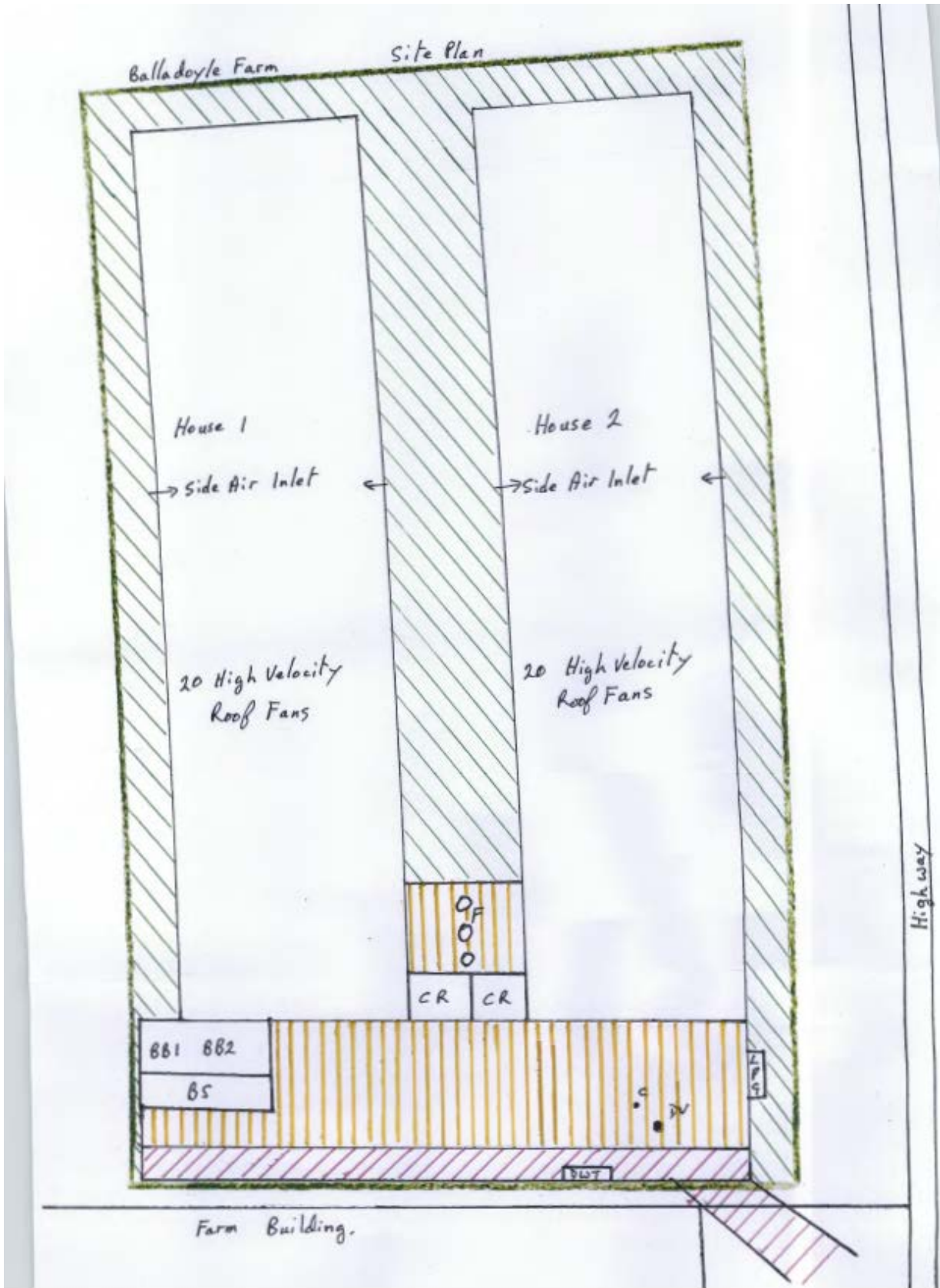

END OF PERMIT