

Notice of variation with introductory note

The Environmental Permitting (England & Wales) Regulations 2010

Mr Richard Howat

Roads Farm Poultry Unit
Roads Farm
St Briavels
Lydney
Gloucestershire
GL15 6QT

Variation notice number

EPR/EP3736ZE

Permit number

EPR/EP3736ZE/V002

Roads Farm Poultry Unit

Permit number EPR/EP3736ZE

Introductory note

This introductory note does not form a part of the notice

The following notice gives notice of the variation of an environmental permit.

The main features of the installation are as follows. The installation is located in St. Briavels, Lydney, Gloucestershire and covers approximately 2.6 hectares centred at grid reference SO 5771 0511. The nearest European habitat site is Wye Valley & Forest of Dean Bat Sites SAC, approximately 2400 m from the installation. The nearest SSSI site is Slade Brook SSSI, approximately 760 m from the installation. Potential releases from this type of installation include releases of ammonia and dust to air and releases of odour and noise.

This variation authorises the following changes:

Overall this variation includes the change of farm usage from egg laying hens to pullets for off-site free range egg laying. The chicks are housed on straw bedding and are removed from the installation at 16 weeks of age. Poultry house heating allows optimum temperature conditions over age range of chicks.

- Increase in bird numbers from 146,000 egg laying hens (as per original permit EPR/RP3832MT) to 220,000 pullets. This involves upgrading of the existing poultry houses. The original three houses have been modified to convert into six poultry houses on the same footprint as the original poultry houses. Houses 1 and 2 will house 58,000 birds each, houses 3 and 5 31,000 birds each and houses 4 and 6 will house 21,000 birds each. All sheds will include pan feeders, chain feeders and contained nipple drinkers.
- The poultry houses have been re-insulated as part of the modifications. The poultry house ventilation has been converted from side vents to ridge high ventilation fans to provide enhanced dispersion of ammonia emissions.
- Drainage plan updated: the changes involve the addition of two new dirty water tanks of 18 m³ volume. Roof and yard clean water will discharge to a single soak away.
- Removal of carcass incineration facility; previously a directly associated activity.

There is a kerosene tank for heating and a diesel tank for the standby generator; both are plastic bunded tanks.

This variation incorporates the changes required by the Industrial Emissions Directive. This includes the addition of a condition relating to a requirement for routine monitoring, and an additional notification requirement.

The schedules specify the changes made to the original permit.

The status log of a permit sets out the permitting history, including any changes to the permit reference number.

Status Log of the permit		
Detail	Date	Response Date
Application EPR/RP3832MT/A001	Duly made 08/12/06	
Additional information received	14/05/07	
Permit determined EPR/RP3832MT	26/10/07	Original permit issued to Deans Foods Limited.
Variation determined EPR/RP3832MT/V002	13/03/09	
Received notification of change of company name	18/01/11	
Issue of updated permit pages to show change of company name	26/01/11	
Application EPR/EP3736ZE/T001	Duly made 04/03/13	Application to transfer the permit in full to Mr Richard Howat. (full transfer of permit EPR/RP3832MT)
Transfer determined EPR/EP3736ZE	03/04/13	Full transfer of permit complete.
Variation application EPR/EP3736ZE/V002	Duly made 28/07/14	
Variation determined EPR/EP3736ZE/V002	27/08/14	

End of introductory note

Notice of variation

The Environmental Permitting (England and Wales) Regulations 2010

The Environment Agency in exercise of its powers under regulation 20 of the Environmental Permitting (England and Wales) Regulations 2010 varies

Permit number
EPR/EP3736ZE

issued to:

Mr Richard Howat
("the operator"),
of
Woolaston Court
Main Road
Woolaston
Lydney
Gloucestershire
GL15 6PJ

to operate a regulated facility at

Roads Farm Poultry Unit
Roads Farm
St. Braivels
Lydney
Gloucestershire
GL15 6QT

to the extent set out in the schedules.

The notice shall take effect from **27/08/2014**

Name	Date
Anne Nightingale	27/08/2014

Authorised on behalf of the Environment Agency

Schedule 1 – conditions to be deleted

None.

Schedule 2 – conditions to be amended

The following conditions are amended as a result of the application made by the operator:

- **Table S1.1 as referenced in permit condition 2.1.1 is amended to include increase to type and number of birds as follows. The amended table is as follows:**

Table S1.1 activities		
Activity listed in Schedule 1 of the EP Regulations	Description of specified activity	Limits of specified activity
Section 6.9 A(1)(a)(i) Rearing of poultry intensively in an installation with more than 40,000 places	The rearing of poultry in a facility with a capacity for 220,000 pullets for off-site free range egg laying.	From receipt of birds, raw materials and fuels onto the site to removal of birds and associated wastes from site
Directly Associated Activity		
-	-	-

- **Table S1.2 as referenced in permit condition 2.3.1 is amended as follows to include new operating techniques for the variation changes. The amended table is as follows:**

Table S1.2 Operating techniques		
Description	Parts	Date Received
Application RP3832MT (EPR/RP3832MT/A001)	The responses to sections B2.3.1, B2.3.2, B2.3.3, B2.6.1, B2.6.2, B2.6.3, B2.7.1 and B2.7.2 in the Application.	08/12/06
Request for Information dated 04/05/07	Response to Request for Information confirming the installation boundary and the drainage facilities/ plans at the installation.	14/05/07
Application EPR/EP3736ZE/V002	The responses to C3 question 3, supporting technical document and duly making responses (including updated Odour Management Plan and Site Drainage Plan)	Duly made 28/07/14

- Table S4.1 as referenced in permit condition 3.1.1 is amended to update the ventilation to high velocity ridge fans for all poultry houses. The amended table is as follows:

Table S4.1 Point source emissions to air – emission limits and monitoring requirements						
Emission point ref. & location	Parameter	Source	Limit (including unit)	Reference period	Monitoring frequency	Monitoring standard or method
High velocity ridge fan outlets on buildings 1 – 6 as shown on the site plan in application EPR/EP3736ZE/V002	-	Poultry sheds 1 - 6	-	-	-	-
Vent from LPG tank as shown on the site plan in application RP3832MT (EPR/RP3832MT/A001)	-	LPG Tank	-	-	-	-
Exhausts from stand-by generators as shown on the site plan in application RP3832MT (EPR/RP3832MT/A001)	-	Standby generators	-	-	-	-
Vent from oil tank as shown on the site plan in application RP3832MT (EPR/RP3832MT/A001)	-	Diesel Tank	-	-	-	-

- Table S4.2 as referenced in permit condition 3.1.1 is amended to confirm one single soak away for clean water from all poultry houses. The amended table reads as follows:

Table S4.2 Point source emissions to land– emission limits and monitoring requirements						
Emission point ref. & location	Parameter	Source	Limit (incl. Unit)	Reference period	Monitoring frequency	Monitoring standard or method
Single Soak away as shown on the drainage plan in application EPR/EP3736ZE/V002	-	Yard and roof water from buildings 1 – 6	-	-	-	-

The following condition is amended as a result of the application made by the operator and the requirements of the Industrial Emissions Directive.

- **Operating techniques condition 2.3.1 is updated in line with latest permit condition**

- 2.3.1 (a) The activities shall, subject to the conditions of this permit, be operated using the techniques and in the manner described in the documentation specified in schedule 1, table S1.2, unless otherwise agreed in writing by the Environment Agency.
- (b) If notified by the Environment Agency that the activities are giving rise to pollution, the operator shall submit to the Environment Agency for approval within the period specified, a revision of any plan specified in schedule 1, table S1.2 or otherwise required under this permit which identifies and minimises the risks of pollution relevant to that plan, and shall implement the approved revised plan in place of the original from the date of approval, unless otherwise agreed in writing by the Environment Agency.

- **Notifications permit conditions 4.3.1 and 4.3.2 are amended as follows:**

- 4.3.1 (a) In the event that the operation of the activities gives rise to an incident or accident which significantly affects or may significantly affect the environment, the operator must immediately—
- (i) inform the Environment Agency,
 - (ii) take the measures necessary to limit the environmental consequences of such an incident or accident, and
 - (iii) take the measures necessary to prevent further possible incidents or accidents;
- (b) in the event of a breach of any permit condition the operator must immediately—
- (i) inform the Environment Agency, and
 - (ii) take the measures necessary to ensure that compliance is restored within the shortest possible time;
- (c) in the event of a breach of permit condition which poses an immediate danger to human health or threatens to cause an immediate significant adverse effect on the environment, the operator must immediately suspend the operation of the activities or the relevant part of it until compliance with the permit conditions has been restored.
- 4.3.2 Any information provided under condition 4.3.1 shall be confirmed by sending the information listed schedule 6 of this permit within the time period specified in that schedule.

- An amended Notifications Schedule 6 is included below.

Schedule 6 - Notification

These pages outline the information that the operator must provide.

Units of measurement used in information supplied under Part A and B requirements shall be appropriate to the circumstances of the emission. Where appropriate, a comparison should be made of actual emissions and authorised emission limits.

If any information is considered commercially confidential, it should be separated from non-confidential information, supplied on a separate sheet and accompanied by an application for commercial confidentiality under the provisions of the EP Regulations.

Part A

Permit Number	EPR/EP3736ZE
Name of operator	
Location of Facility	
Time and date of the detection	

(a) Notification requirements for any activity that gives rise to an incident or accident which significantly affects or may significantly affect the environment

To be notified Immediately	
Date and time of the event	
Reference or description of the location of the event	
Description of where any release into the environment took place	
Substances(s) potentially released	
Best estimate of the quantity or rate of release of substances	
Measures taken, or intended to be taken, to stop any emission	
Description of the failure or accident.	

(b) Notification requirements for the breach of a permit condition

To be notified immediately	
Emission point reference/ source	
Parameter(s)	
Limit	
Measured value and uncertainty	

Date and time of monitoring	
Measures taken, or intended to be taken, to stop the emission	

Time periods for notification following detection of a breach of a limit	
Parameter	Notification period
In the event of a breach of permit condition which poses an immediate danger to human health or threatens to cause an immediate significant adverse effect on the environment:	
Description of where the effect on the environment was detected	
Substances(s) detected	
Concentrations of substances detected	
Date of monitoring/sampling	

Part B - to be submitted as soon as practicable

Any more accurate information on the matters for notification under Part A.	
Measures taken, or intended to be taken, to prevent a recurrence of the incident	
Measures taken, or intended to be taken, to rectify, limit or prevent any pollution of the environment which has been or may be caused by the emission	
The dates of any unauthorised emissions from the facility in the preceding 24 months.	

Name*	
Post	
Signature	
Date	

* authorised to sign on behalf of the operator

Schedule 3 – conditions to be added

The following conditions are added as a result of the application made by the operator and the requirements of the Industrial Emissions Directive:

- **Ground water and soil monitoring condition 3.1.2 is to added as follows:**

3.1.2 Periodic monitoring shall be carried out at least once every 5 years for groundwater and 10 years for soil, unless such monitoring is based on a systematic appraisal of the risk of contamination.

- **Fugitive emissions condition 3.3.3 is added in line with latest permit condition as follows:**

3.3.3 The operator shall:

- (a) if notified by the Environment Agency that the activities are giving rise to pollution, submit to the Environment Agency for approval within the period specified, an emissions management plan which identifies and minimises the risks of pollution from emissions of substances not controlled by emission limits;
- (b) implement the approved emissions management plan, from the date of approval, unless otherwise agreed in writing by the Environment Agency.

- **Pest conditions 3.6.1 and 3.6.2 added as follows:**

3.6 Pests

3.6.1 The activities shall not give rise to the presence of pests which are likely to cause pollution, hazard or annoyance outside the boundary of the site. The operator shall not be taken to have breached this condition if appropriate measures, including, but not limited to, those specified in any approved pests management plan, have been taken to prevent or where that is not practicable, to minimise the presence of pests on the site.

3.6.2 The operator shall:

- (a) if notified by the Environment Agency, submit to the Environment Agency for approval within the period specified, a pests management plan which identifies and minimises risks of pollution, hazard or annoyance from pests;
- (b) implement the pests management plan, from the date of approval, unless otherwise agreed in writing by the Environment Agency.

- **The following term has been added to Schedule 7 - Interpretation:**

“Industrial Emissions Directive” means DIRECTIVE 2010/75/EU OF THE EUROPEAN PARLIAMENT AND OF THE COUNCIL of 24 November 2010 on industrial emissions

Schedule 4 – amended plan

The installation boundary is unchanged.

A revised drainage plan is included below to confirm revised clean and dirty water management for the installation.

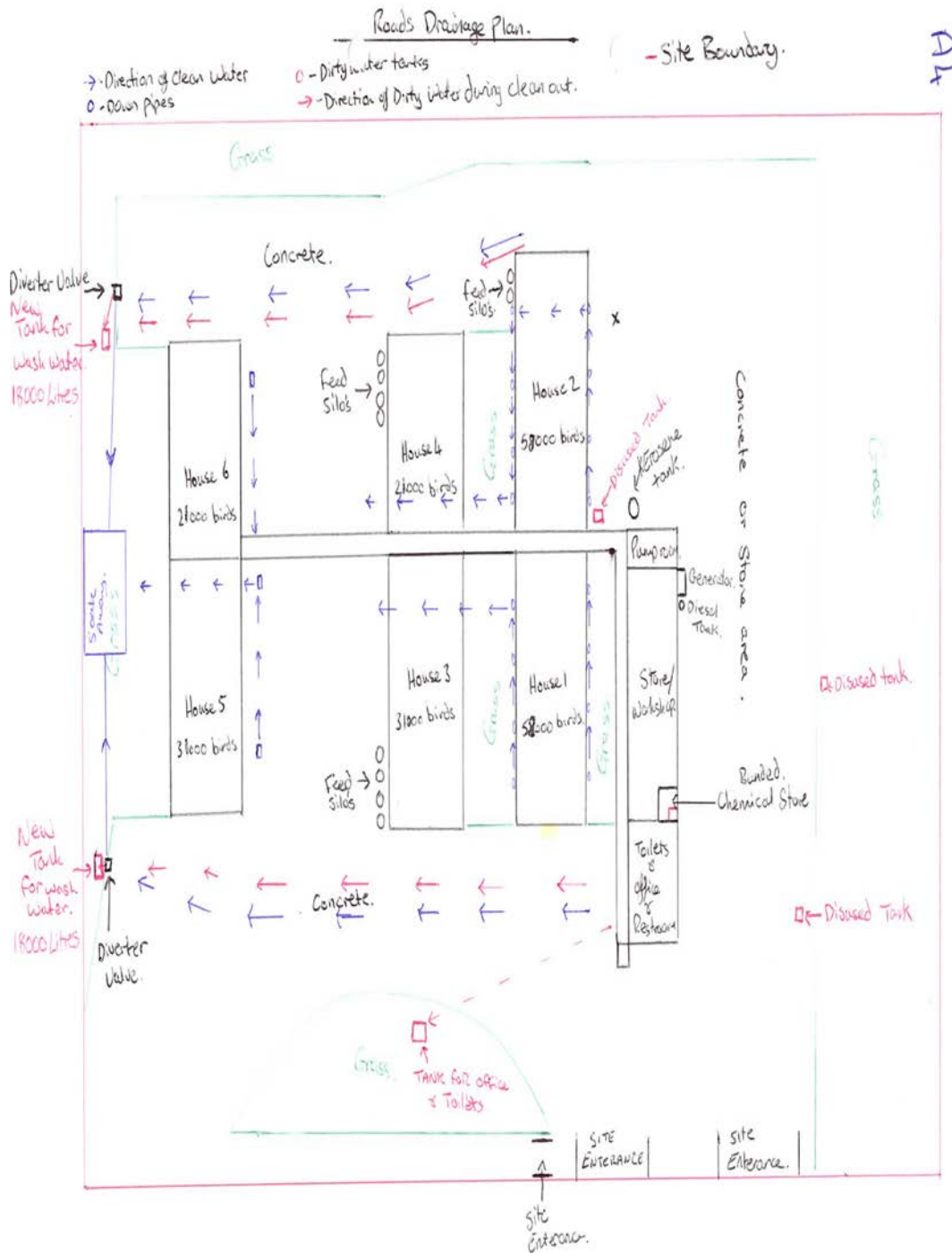

END OF NOTICE