

Notice of variation and consolidation with introductory note

The Environmental Permitting (England & Wales) Regulations 2010

Elsham Linc Limited
Prosperity Farm Pig Unit
Scrubb Lane
South Reston
Louth
Lincolnshire
LN11 8PG

Variation application number

EPR/MP3833UN/V004

Permit number

EPR/MP3833UN

Prosperity Farm Pig Unit

Permit number EPR/MP3833UN

Introductory note

This introductory note does not form a part of the notice.

Under the Environmental Permitting (England & Wales) Regulations 2010 (schedule 5, part 1, paragraph 19) a variation may comprise a consolidated permit reflecting the variations and a notice specifying the variations included in that consolidated permit.

Schedule 1 of the notice specifies the conditions that have been varied and schedule 2 comprises a consolidated permit which reflects the variations being made.

Prosperity Farm Pig Unit is approximately centred on National Grid Reference TF 40184 81840.

This variation authorises the following changes:

- The number of production pigs over 30 kilograms has been increased to 5,175 to include the grower places which can reach weights of 45 kg. The number of pigs less than 30 kg remains at 3,260 and there remain 788 sow places. The maximum number of production pigs (above 30kg) plus pigs less than 30kg that can be held on the farm at any one time is 6,835 to reflect the maximum capacity of the site.
- Farrowing houses 4, 5, 6, 7, 8 and 9 will be demolished and replaced by a new farrowing house 4 on the site of the existing farrowing houses 4, 5 and 6. The new farrowing house 4 will have fully slatted flooring and high velocity roof fans.
- Existing flat decks 4 and 5 will be replaced with a new flat deck 4 with a capacity for 850 weaner places. New flat deck 4 will have fully slatted flooring and high velocity roof fans. The stocking rate of existing flat decks 1, 2 and 3 will be reduced from 320 in each building to 250 in each building.
- A new grower house will be constructed to house 450 growing pigs on the site of existing farrowing houses 7, 8 and 9. There will be a reduction in the number of grower places in the existing grower house from 1,600 to 1,150. The new grower house will have fully slatted flooring and will have high velocity roof fans.
- Roof water from the new housing will be directed to the existing soakaways.
- Two air source heat pumps will heat new farrowing house 4 and new flat deck 4.

There are now a total of 22 sheds with a mixture of solid straw flooring, part slatted and fully slatted flooring.

The installation continues to be operated as follows:

Solid manure is kept on concrete pads with a collection system for liquids. Slurry is piped to reception tanks. Dirty water from the yards and foot baths are added to the slurry. Slurry and manure is taken to neighbouring land for spreading. A proportion of uncontaminated roof water is reused as washwater. Any water which cannot be reused is directed via drains to an un-named drainage ditch. The surrounding land use is agricultural.

There are three Sites of Special Scientific Interest (SSSI) within 5 kilometres of the installation (Muckton Wood, Swaby Valley and Calceby Marsh).

This consolidated variation incorporates the changes required by the Industrial Emissions Directive.

The schedules specify the changes made to the permit.

The status log of a permit sets out the permitting history, including any changes to the permit reference number.

Status log of the permit		
Description	Date	Comments
Application EPR/MP3833UN/A001	Duly made 18/01/07	Application for an intensive farming pig installation permit.
Permit EPR/MP3833UN/A001 determined	22/08/07	Permit issued to Elsham Linc Limited
Application reference EPR/MP3833UN/V002	Requested 16/11/12	Environment Agency initiated application to reassess the permit with gilts included under new definition.
Variation issued EPR/MP3833UN/V002	21/12/12	Varied permit issued.
Application reference EPR/MP3833UN/V003	Requested 23/04/14	Environment Agency initiated application to amend the number of pigs below 30kg to 3,260.
Additional information received	14/05/14	"Summary Prosperity Building Ventilation Updated by Elsham Linc on 14 May 2014", received by email.
Variation issued EPR/MP3833UN/V003	13/06/14	Varied and consolidated permit issued in modern conditions to include the requirements of IED.
Application EPR/MP3833UN/V004 (variation and consolidation)	Duly made 24/09/14	Application to vary and update the permit to modern conditions.
Variation determined EPR/MP3833UN	15/12/14	Varied and consolidated permit issued in modern condition format.

End of introductory note

Notice of variation and consolidation

The Environmental Permitting (England and Wales) Regulations 2010

The Environment Agency in exercise of its powers under regulation 20 of the Environmental Permitting (England and Wales) Regulations 2010 varies and consolidates

Permit number

EPR/MP3833UN

Issued to

Elsham Linc Limited ("the operator")

whose registered office is

**Wootton Road
Elsham Top
Brigg
Lincolnshire
DN20 0NU**

company registration number 05525289

to operate an installation at

**Prosperity Farm Pig Unit
Scrubb Lane
South Reston
Louth
Lincolnshire
LN11 8PG**

to the extent set out in the schedules.

The notice shall take effect from 15/12/2014.

Name	Date
Tracey Pollard	15/12/2014

Authorised on behalf of the Environment Agency

Schedule 1

All conditions have been varied by the consolidated permit EPR/MP3833UN/V004 as a result of the application made by the operator.

Schedule 2 – consolidated permit

Consolidated permit issued as a separate document.

Permit

The Environmental Permitting (England and Wales) Regulations 2010

Permit number

EPR/MP3833UN

This is the consolidated permit referred to in the variation and consolidation notice for application EPR/MP3833UN/V004 authorising,

Elsham Linc Limited ("the operator"),

whose registered office is

**Wootton Road
Elsham Top
Brigg
Lincolnshire
DN20 0NU**

company registration number 05525289

to operate an installation at

**Prosperity Farm Pig Unit
Scrubb Lane
South Reston
Louth
Lincolnshire
LN11 8PG**

to the extent authorised by and subject to the conditions of this permit.

Name	Date
Tracey Pollard	15/12/2014

Authorised on behalf of the Environment Agency

Conditions

1 Management

1.1 General management

- 1.1.1 The operator shall manage and operate the activities:
- (a) in accordance with a written management system that identifies and minimises risks of pollution, including those arising from operations, maintenance, accidents, incidents, non-conformances, closure and those drawn to the attention of the operator as a result of complaints; and
 - (b) using sufficient competent persons and resources.
- 1.1.2 Records demonstrating compliance with condition 1.1.1 shall be maintained.
- 1.1.3 Any person having duties that are or may be affected by the matters set out in this permit shall have convenient access to a copy of it kept at or near the place where those duties are carried out.

1.2 Energy efficiency

- 1.2.1 The operator shall:
- (a) take appropriate measures to ensure that energy is used efficiently in the activities;
 - (b) review and record at least every four years whether there are suitable opportunities to improve the energy efficiency of the activities; and
 - (c) take any further appropriate measures identified by a review.

1.3 Efficient use of raw materials

- 1.3.1 The operator shall:
- (a) take appropriate measures to ensure that raw materials and water are used efficiently in the activities;
 - (b) maintain records of raw materials and water used in the activities;
 - (c) review and record at least every four years whether there are suitable alternative materials that could reduce environmental impact or opportunities to improve the efficiency of raw material and water use; and
 - (d) take any further appropriate measures identified by a review.

1.4 Avoidance, recovery and disposal of wastes produced by the activities

- 1.4.1 The operator shall take appropriate measures to ensure that:
- (a) the waste hierarchy referred to in Article 4 of the Waste Framework Directive is applied to the generation of waste by the activities;
 - (b) any waste generated by the activities is treated in accordance with the waste hierarchy referred to in Article 4 of the Waste Framework Directive; and
 - (c) where disposal is necessary, this is undertaken in a manner which minimises its impact on the environment.

- 1.4.2 The operator shall review and record at least every four years whether changes to those measures should be made and take any further appropriate measures identified by a review.

2 Operations

2.1 Permitted activities

- 2.1.1 The operator is only authorised to carry out the activities specified in schedule 1 table S1.1 (the “activities”).

2.2 The site

- 2.2.1 The activities shall not extend beyond the site, being the land shown edged in green on the site plan at schedule 7 to this permit.

2.3 Operating techniques

- 2.3.1 The activities shall, subject to the conditions of this permit, be operated using the techniques and in the manner described in the documentation specified in schedule 1, table S1.2, unless otherwise agreed in writing by the Environment Agency.
- 2.3.2 If notified by the Environment Agency that the activities are giving rise to pollution, the operator shall submit to the Environment Agency for approval within the period specified, a revision of any plan or other documentation (“plan”) specified in schedule 1, table S1.2 or otherwise required under this permit which identifies and minimises the risks of pollution relevant to that plan, and shall implement the approved revised plan in place of the original from the date of approval, unless otherwise agreed in writing by the Environment Agency.
- 2.3.3 The operator shall maintain and implement a system to record the number of animal places and animal movements.
- 2.3.4 The operator shall take appropriate measures in off-site disposal or recovery of solid manure or slurry to prevent, or where this is not practicable, to minimise pollution.
- 2.3.5 The operator shall ensure that where waste produced by the activities is sent to a relevant waste operation, that operation is provided with the following information, prior to the receipt of the waste:
- (a) the nature of the process producing the waste;
 - (b) the composition of the waste;
 - (c) the handling requirements of the waste;
 - (d) the hazardous property associated with the waste, if applicable; and
 - (e) the waste code of the waste.
- 2.3.6 The operator shall ensure that where waste produced by the activities is sent to a landfill site, it meets the waste acceptance criteria for that landfill.

2.4 Improvement programme

- 2.4.1 The operator shall complete the improvements specified in schedule 1 table S1.3 by the date specified in that table unless otherwise agreed in writing by the Environment Agency.
- 2.4.2 Except in the case of an improvement which consists only of a submission to the Environment Agency, the operator shall notify the Environment Agency within 14 days of completion of each improvement.

3 Emissions and monitoring

3.1 Emissions to water, air or land

- 3.1.1 There shall be no point source emissions to water, air or land except from the sources and emission points listed in schedule 3 tables S3.1 and S3.2.
- 3.1.2 The limits given in schedule 3 shall not be exceeded.
- 3.1.3 Periodic monitoring shall be carried out at least once every 5 years for groundwater and 10 years for soil, unless such monitoring is based on a systematic appraisal of the risk of contamination.

3.2 Emissions of substances not controlled by emission limits

- 3.2.1 Emissions of substances not controlled by emission limits (excluding odour) shall not cause pollution. The operator shall not be taken to have breached this condition if appropriate measures, including, but not limited to, those specified in any approved emissions management plan, have been taken to prevent or where that is not practicable, to minimise, those emissions.
- 3.2.2 The operator shall:
 - (a) if notified by the Environment Agency that the activities are giving rise to pollution, submit to the Environment Agency for approval within the period specified, an emissions management plan which identifies and minimises the risks of pollution from emissions of substances not controlled by emission limits; and
 - (b) implement the approved emissions management plan, from the date of approval, unless otherwise agreed in writing by the Environment Agency.
- 3.2.3 All liquids in containers, whose emission to water or land could cause pollution, shall be provided with secondary containment, unless the operator has used other appropriate measures to prevent or where that is not practicable, to minimise, leakage and spillage from the primary container.

3.3 Odour

- 3.3.1 Emissions from the activities shall be free from odour at levels likely to cause pollution outside the site, as perceived by an authorised officer of the Environment Agency, unless the operator has used appropriate measures, including, but not limited to, those specified in any approved odour management plan, to prevent or where that is not practicable to minimise the odour.

3.4 Noise and vibration

- 3.4.1 Emissions from the activities shall be free from noise and vibration at levels likely to cause pollution outside the site, as perceived by an authorised officer of the Environment Agency, unless the operator has used appropriate measures, including, but not limited to, those specified in any approved noise and vibration management plan to prevent or where that is not practicable to minimise the noise and vibration.

3.5 Monitoring

- 3.5.1 The operator shall, unless otherwise agreed in writing by the Environment Agency, undertake the monitoring specified in the following tables in schedule 3 to this permit:
 - (a) point source emissions specified in tables S3.1 and S3.2.

3.6 Pests

- 3.6.1 The activities shall not give rise to the presence of pests which are likely to cause pollution, hazard or annoyance outside the boundary of the site. The operator shall not be taken to have breached this condition if appropriate measures, including, but not limited to, those specified in any approved pests management plan, have been taken to prevent or where that is not practicable, to minimise the presence of pests on the site.
- 3.6.2 The operator shall:
- (a) if notified by the Environment Agency, submit to the Environment Agency for approval within the period specified, a pests management plan which identifies and minimises risks of pollution, hazard or annoyance from pests;
 - (b) implement the pests management plan, from the date of approval, unless otherwise agreed in writing by the Environment Agency.

4 Information

4.1 Records

- 4.1.1 All records required to be made by this permit shall:
- (a) be legible;
 - (b) be made as soon as reasonably practicable;
 - (c) if amended, be amended in such a way that the original and any subsequent amendments remain legible, or are capable of retrieval; and
 - (d) be retained, unless otherwise agreed in writing by the Environment Agency, for at least 6 years from the date when the records were made, or in the case of the following records until permit surrender:
 - (i) off-site environmental effects; and
 - (ii) matters which affect the condition of the land and groundwater.
- 4.1.2 The operator shall keep on site all records, plans and the management system required to be maintained by this permit, unless otherwise agreed in writing by the Environment Agency.

4.2 Reporting

- 4.2.1 The operator shall send all reports and notifications required by the permit to the Environment Agency using the contact details supplied in writing by the Environment Agency.
- 4.2.2 The operator shall, unless notice under this condition has been served within the preceding four years, submit to the Environment Agency, within six months of receipt of a written notice, a report assessing whether there are other appropriate measures that could be taken to prevent, or where that is not practicable, to minimise pollution.

4.3 Notifications

- 4.3.1 In the event:
- (a) that the operation of the activities gives rise to an incident or accident which significantly affects or may significantly affect the environment, the operator must immediately—
 - (i) inform the Environment Agency,

- (ii) take the measures necessary to limit the environmental consequences of such an incident or accident, and
 - (iii) take the measures necessary to prevent further possible incidents or accidents;
- (b) of a breach of any permit condition the operator must immediately—
 - (i) inform the Environment Agency, and
 - (ii) take the measures necessary to ensure that compliance is restored within the shortest possible time;
- (c) of a breach of permit condition which poses an immediate danger to human health or threatens to cause an immediate significant adverse effect on the environment, the operator must immediately suspend the operation of the activities or the relevant part of it until compliance with the permit conditions has been restored.

4.3.2 Any information provided under condition 4.3.1 shall be confirmed by sending the information listed in schedule 5 to this permit within the time period specified in that schedule.

4.3.3 Where the Environment Agency has requested in writing that it shall be notified when the operator is to undertake monitoring and/or spot sampling, the operator shall inform the Environment Agency when the relevant monitoring and/or spot sampling is to take place. The operator shall provide this information to the Environment Agency at least 14 days before the date the monitoring is to be undertaken.

4.3.4 The Environment Agency shall be notified within 14 days of the occurrence of the following matters, except where such disclosure is prohibited by Stock Exchange rules:

Where the operator is a registered company:

- (a) any change in the operator's trading name, registered name or registered office address; and
- (b) any steps taken with a view to the operator going into administration, entering into a company voluntary arrangement or being wound up.

Where the operator is a corporate body other than a registered company:

- (a) any change in the operator's name or address; and
- (b) any steps taken with a view to the dissolution of the operator.

In any other case:

- (a) the death of any of the named operators (where the operator consists of more than one named individual);
- (b) any change in the operator's name(s) or address(es); and
- (c) any steps taken with a view to the operator, or any one of them, going into bankruptcy, entering into a composition or arrangement with creditors, or, in the case of them being in a partnership, dissolving the partnership.

4.3.5 Where the operator proposes to make a change in the nature or functioning, or an extension of the activities, which may have consequences for the environment and the change is not otherwise the subject of an application for approval under the Regulations or this permit:

- (a) the Environment Agency shall be notified at least 14 days before making the change; and
- (b) the notification shall contain a description of the proposed change in operation.

4.3.6 The Environment Agency shall be given at least 14 days notice before implementation of any part of the site closure plan.

4.3.7 Where the operator has entered into a climate change agreement with the Government, the Environment Agency shall be notified within one month of:

- (a) a decision by the Secretary of State not to re-certify the agreement;

- (b) a decision by either the operator or the Secretary of State to terminate the agreement; and
- (c) any subsequent decision by the Secretary of State to re-certify such an agreement.

4.4 Interpretation

- 4.4.1 In this permit the expressions listed in schedule 6 shall have the meaning given in that schedule.
- 4.4.2 In this permit references to reports and notifications mean written reports and notifications, except where reference is made to notification being made “immediately”, in which case it may be provided by telephone.

Schedule 1 – Operations

Table S1.1 activities		
Activity listed in Schedule 1 of the EP Regulations	Description of specified activity	Limits of specified activity
Section 6.9 A(1)(a)(ii) Rearing of pigs intensively in an installation with more than 2,000 places for production pigs (over 30 kg)	Rearing of pigs intensively in an installation with a capacity for 5,175 production pig (over 30 kg) places. The maximum number of production pigs plus pigs less than 30kg that can be held on the farm at any one time is 6,835.	Keeping of production pigs and not served gilts (over 30 kg), including from receipt of raw materials and fuels on to the site to pigs and associated wastes being removed from site.
Section 6.9 A(1)(a)(iii) Rearing of pigs intensively in an installation with more than 750 places for sows	Rearing of pigs intensively in an installation with a capacity for 788 sow places.	Keeping of sows and served gilts for production of piglets, from receipt of raw materials and fuels on to the site to removal of sows and associated wastes from site.
Directly Associated Activity	Description of specified activity	Limits of specified activity
Rearing of pigs (up to 30 kg)	Rearing of 3,260 pigs to 30 kg.	From weaning pigs and receipt of raw materials and fuels on to the site up to pigs reaching 30 kg and removal of pigs and associated wastes from site.

Table S1.2 Operating techniques		
Description	Parts	Date Received
Application EPR/MP3833UN/A001	The responses to sections B2.3.1, B2.3.2, B2.3.3, B2.5.1, B2.5.3, B2.7.1 and B2.7.2 in the Application.	18/01/07
Additional information received	"300512 Email from Sam Godfrey with Pig Numbers for Permitted sites including gilts" (received by email) confirming stock numbers and housing arrangements.	30/05/12
Additional information received	"Summary Prosperity Building Ventilation Updated by Elsham Linc on 14 May 2014" (received by email) confirming ventilation arrangements.	14/05/14
Application EPR/MP3833UN/V004	Application forms Part C2 and Part C3 and all referenced supporting documentation.	27/08/14
Application EPR/MP3833UN/V004	Revised site plan.	24/09/14

Table S1.3 Improvement programme requirements		
Reference	Requirement	Date
IC1	A written plan shall be submitted to the Agency for approval detailing proposals for replacing or covering existing uncovered slurry stores and lagoons to comply with the requirements of section 5.3.1 of TGN How to Comply, Version 1. The proposals shall include a timetable for the replacement and refurbishment work. The notification requirements of condition 2.5.2 shall be deemed to have been complied with on	Completed 04/01/10

Table S1.3 Improvement programme requirements		
Reference	Requirement	Date
	<p>submission of the plan.</p> <p>The plan shall be implemented by the operator from the date of approval in writing by the Agency subject to such amendments or additions as notified by the Agency.</p>	
IC2	<p>A written plan shall be submitted to the Agency for approval, following a review of all site drainage at the installation. The plan should take into account the appropriate measures for the management of drainage systems and run-off in S3.3 of TGN How to Comply, Version 1, and include a timetable for any improvements to the drainage system. The notification requirements of condition 2.5.2 shall be deemed to have been complied with on submission of the plan.</p> <p>The plan shall be implemented by the operator from the date of approval in writing by the Agency subject to such amendments or additions as notified by the Agency.</p>	Completed 12/08/08
IC3	<p>A written plan shall be submitted to the Agency for approval following a review of existing pig housing and management practices at the installation. The plan shall take into account the appropriate measures in S5.2.1 & S5.2.2 of TGN How to Comply, Version 1. The plan shall identify measures to reduce emissions to all media, the likely cost of such measures and a proposed timetable for their implementation</p> <p>The notification requirements of condition 2.5.2 shall be deemed to have been complied with on submission of the plan.</p> <p>The plan shall be implemented by the operator from the date of approval in writing by the Agency subject to such amendments or additions as notified by the Agency.</p>	Completed 24/09/08

Schedule 2 – Waste types, raw materials and fuels

Table S2.1 Raw materials and fuels	
Raw materials and fuel description	Specification
---	---

Schedule 3 – Emissions and monitoring

Table S3.1 Point source emissions to air – emission limits and monitoring requirements						
Emission point ref. & location	Source	Parameter	Limit (including unit)	Reference Period	Monitoring frequency	Monitoring standard or method
Roof fan outlets on pig housing shown on the site plan in application EPR/MP3833UN/V004	Farrowing house 4, flat deck 2, 3 & 4 & new grower house	---	---	---	---	---
Side fan outlets on pig housing shown on the site plan in application EPR/MP3833UN/V004	Flat deck 1, Old grower house, finisher 6 & 7	---	---	---	---	---
Side outlets on pig housing shown on the site plan in application EPR/MP3833UN/V004	Isolation pens, gilt yard, service house, ESF House, baby porcs 1 & 2, farrowing houses 1, 2 & 3, finisher 1, 2, 3, 4 & 5 and hospital.	---	---	---	---	---
Vent from oil tank as shown on the site plan B1.3 app 5 in the application EPR/MP3833UN/A001	Diesel tank	---	---	---	---	---

Table S3.2 Point Source emissions to water (other than sewer) and land – emission limits and monitoring requirements						
Emission point ref. & location	Source	Parameter	Limit (incl. unit)	Reference Period	Monitoring frequency	Monitoring standard or method
Points on drainage plan, emission to unnamed ditch	Uncontaminated water from roofs and yard	---	---	---	---	---

Schedule 4 – Reporting

There is no reporting under this schedule.

Schedule 5 – Notification

These pages outline the information that the operator must provide.

Units of measurement used in information supplied under Part A and B requirements shall be appropriate to the circumstances of the emission. Where appropriate, a comparison should be made of actual emissions and authorised emission limits.

If any information is considered commercially confidential, it should be separated from non-confidential information, supplied on a separate sheet and accompanied by an application for commercial confidentiality under the provisions of the EP Regulations.

Part A

Permit Number	
Name of operator	
Location of Facility	
Time and date of the detection	

(a) Notification requirements for any malfunction, breakdown or failure of equipment or techniques, accident, or emission of a substance not controlled by an emission limit which has caused, is causing or may cause significant pollution	
To be notified within 24 hours of detection	
Date and time of the event	
Reference or description of the location of the event	
Description of where any release into the environment took place	
Substances(s) potentially released	
Best estimate of the quantity or rate of release of substances	
Measures taken, or intended to be taken, to stop any emission	
Description of the failure or accident.	

(b) Notification requirements for the breach of a limit	
To be notified within 24 hours of detection	
Emission point reference/ source	
Parameter(s)	
Limit	
Measured value and uncertainty	
Date and time of monitoring	
Measures taken, or intended to be	

(b) Notification requirements for the breach of a limit	
To be notified within 24 hours of detection	
taken, to stop the emission	

Time periods for notification following detection of a breach of a limit	
Parameter	Notification period

(c) Notification requirements for the detection of any significant adverse environmental effect	
To be notified within 24 hours of detection	
Description of where the effect on the environment was detected	
Substances(s) detected	
Concentrations of substances detected	
Date of monitoring/sampling	

Part B – to be submitted as soon as practicable

Any more accurate information on the matters for notification under Part A.	
Measures taken, or intended to be taken, to prevent a recurrence of the incident	
Measures taken, or intended to be taken, to rectify, limit or prevent any pollution of the environment which has been or may be caused by the emission	
The dates of any unauthorised emissions from the facility in the preceding 24 months.	

Name*	
Post	
Signature	
Date	

* authorised to sign on behalf of the operator

Schedule 6 – Interpretation

“accident” means an accident that may result in pollution.

“application” means the application for this permit, together with any additional information supplied by the operator as part of the application and any response to a notice served under Schedule 5 to the EP Regulations.

“authorised officer” means any person authorised by the Environment Agency under section 108(1) of The Environment Act 1995 to exercise, in accordance with the terms of any such authorisation, any power specified in section 108(4) of that Act.

“emissions to land” includes emissions to groundwater.

“emissions of substances not controlled by emission limits” means emissions of substances to air, water or land from the activities, either from the emission points specified in schedule 3 or from other localised or diffuse sources, which are not controlled by an emission limit.

“EP Regulations” means The Environmental Permitting (England and Wales) Regulations SI 2010 No.675 and words and expressions used in this permit which are also used in the Regulations have the same meanings as in those Regulations.

“groundwater” means all water, which is below the surface of the ground in the saturation zone and in direct contact with the ground or subsoil.

“Industrial Emissions Directive” means DIRECTIVE 2010/75/EU OF THE EUROPEAN PARLIAMENT AND OF THE COUNCIL of 24 November 2010 on industrial emissions.

“Manure and slurry” have the following meaning:

- Manures may be either slurries or solid manures.
- Slurries consist of excreta produced by livestock whilst in a yard or building mixed with rainwater and wash water and, in some cases, waste bedding and feed. Slurries can be pumped or discharged by gravity.
- Slurry includes duck effluent, seepage from manure and wash water.
- Solid manures include farmyard manure (FYM) and comprise material from straw-based housing systems, excreta with lots of straw/sawdust/woodchips in it, or solids from mechanical separators.
- Most poultry systems produce solid manure (litter).
- Solid manure can generally be stacked.

“pests” means Birds, Vermin and Insects.

“SGN How to comply – Intensive Farming” The EPR Sector Guidance Note 6.09 for intensive pig and poultry farmers, Version 2 published January 2010.

“waste code” means the six digit code referable to a type of waste in accordance with the List of Wastes (England) Regulations 2005, or List of Wastes (Wales) Regulations 2005, as appropriate, and in relation to hazardous waste, includes the asterisk.

“Waste Framework Directive” or “WFD” means Waste Framework Directive 2008/98/EC of the European Parliament and of the Council on waste.

“year” means calendar year ending 31 December.

Schedule 7 – Site plan

Installation boundary plan

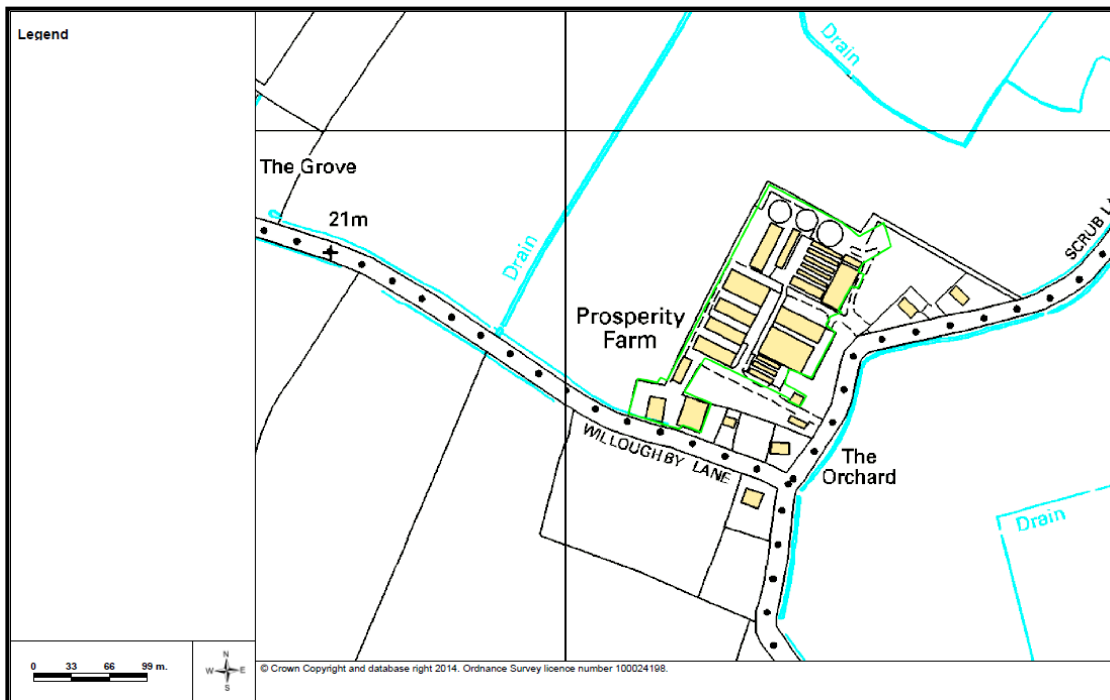

©Crown Copyright. All rights reserved. Environment Agency, 100026380, 2014.

Site Plan

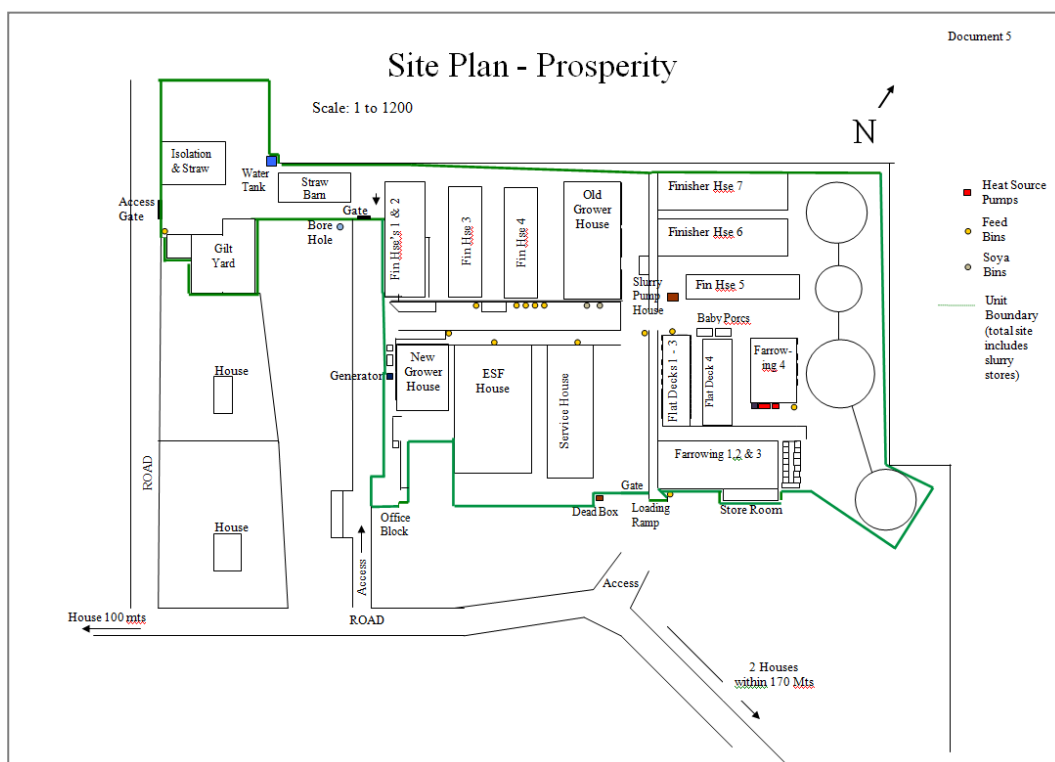

END OF PERMIT