THE PHILIPPINE PPP PROGRAM



PUBLIC-PRIVATE PARTNERSHIP
CENTER

THE PHILIPPINE PPP AGENDA

PPP Program is geared towards
INCLUSIVE GROWTH



PPP as one of the strategies
to accelerate
**INFRASTRUCTURE
DEVELOPMENT**



Private sector as
**PARTNER IN
DEVELOPMENT**



PPP Center as the
**CHAMPION FOR
PUBLIC-PRIVATE
PARTNERSHIPS**



REPUBLIC OF THE PHILIPPINES
**PUBLIC-PRIVATE PARTNERSHIP
CENTER**

LIST OF PPP PROJECTS

(BY PROJECT STATUS AS OF SEPTEMBER 2014)

Status	No. of Projects	Estimated Cost (in million USD)
PROJECTS UNDER IMPLEMENTATION		
Awarded	8	2,833.30
Other projects for implementation	2	1,995.60
Sub-total	10	4,828.90
PPP PIPELINE		
Projects for awarding	1	786.67
Projects under procurement	5	3,426.67
Projects approved for roll-out	3	821.78
For approval of relevant government bodies	7	4,075.56
Projects with ongoing studies	10	6,882.89
For procurement of consultants	10	TBD
Under conceptualization or development	10	TBD
Unsolicited Project	1	TBD
Sub-total	47	15,993.56*
TOTAL	57	20,822.46*



*This does not include 28 projects with no estimated costs yet.

LIST OF PPP PROJECTS

(BY IMPLEMENTING AGENCY)

Implementing Agencies	No. of Projects
Department of Transportation and Communications	28
Department of Public Works and Highways	11
Department of Health	5
Department of Education	3
Metropolitan Waterworks and Sewerage System	2
Other Agencies*	8
TOTAL	57

**Other Agencies: Toll Regulatory Board, Department of Justice, Philippine National Oil Company, Department of Finance, Freeport Area of Bataan, Department of Agriculture-National Irrigation Administration, Bases Conversion and Development Authority (2 projects)*



LIST OF PPP PROJECTS

(BY SECTOR)

Sector	No. of Projects
Transport	30
Road Network	12
Health	5
Education	3
Water	2
Security (Prisons)	1
Energy	1
Agriculture	2
Urban Development	1
TOTAL	57



INVESTMENT OPPORTUNITIES PROJECTS UNDER PROCUREMENT

BULACAN BULK WATER SUPPLY PROJECT

Construction and operation of bulk water distribution system facilities including water treatment and conveyance structures to the water districts

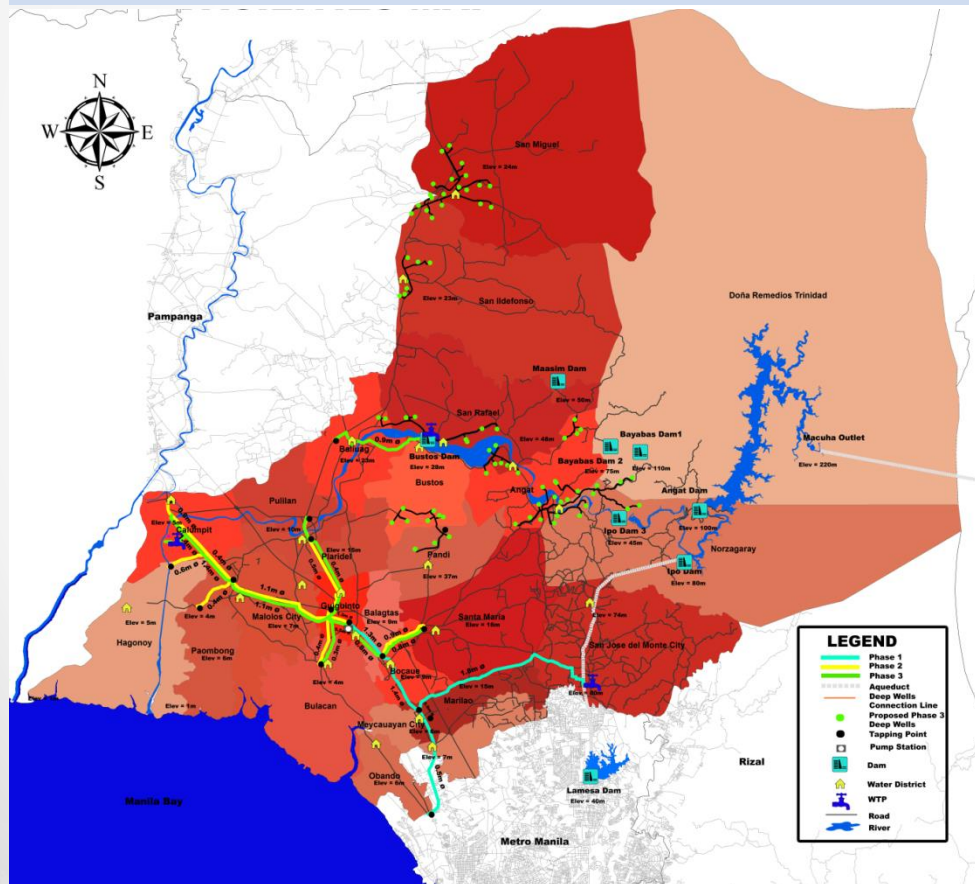

Implementing Agency

Metropolitan Waterworks and Sewerage System (MWSS)

Expected Output

475 million liters per day (mld)

Estimated Project Cost

USD 542.22 million

PPP Structure

Build-Operate-Transfer (BOT)

Cooperation Period

32 years (inclusive of a 2-year construction period)

Status

On-going pre-qualification;

Submission of Prequalification (PQ) documents: 20 Oct 2014

INTEGRATED TRANSPORT SYSTEM PROJECT – SOUTH TERMINAL

Construction of a central transport terminal which will connect passengers from Southern Luzon to various modes of transport serving inner Metro Manila



Implementing Agency

Department of Transport and Communications (DOTC)

Estimated Project Cost

USD 100.0 million

PPP Structure

Build-Transfer-and-Operate (BTO)

Cooperation Period

35 years inclusive of construction period

Status

On-going pre-qualification;

Submission of PQ documents:
06 October 2014

LAGUNA LAKESHORE EXPRESSWAY DIKE PROJECT

Construction of a 47-km expressway dike with two sections: Laguna Lakeshore Expressway Dike and Calamba-Los Baños Toll Expressway; and a flood control system; with a 700-has reclamation component (optional)



Implementing Agency

Department of Public Works and Highways (DPWH)

Estimated Project Cost

USD 2,728.89 million

PPP Structure

BTO: Dike
Build-Transfer: Reclamation

Cooperation Period

37 years
(including 7 years construction)

Status

On-going pre-qualification;
Submission of PQ documents:
16 October 2014

O&M OF LRT LINE 2

Operation and maintenance of the existing 13.8-km LRT Line 2, the approved 4.19-km east extension to Masinag, Antipolo, and any other future expansion

Average daily ridership is 197,924pax/day; passes through cities of Manila, San Juan, Quezon City, Marikina, Pasig, and runs over several major thoroughfares of Metro Manila

Implementing Agency

Department of Transportation and Communications (DOTC)

Cooperation Period

10-15 years

Estimated Project Cost

(no CAPEX)

PPP Structure

Operation and Maintenance

Status

Request for Qualification issued 13 September 2014



INVESTMENT OPPORTUNITIES PROJECTS TO BE ROLLED-OUT

NEW CENTENNIAL WATER SUPPLY SOURCE

Financing, design, and construction of the Kaliwa Dam, intake facilities & other appurtenant facilities, and a water conveyance tunnel



Implementing Agency

MWSS

Expected Output

Capacity to store 600mld and convey up to 2,400mld of water

Estimated Project Cost

USD 416.0 million

PPP Structure

Build-Transfer (BT)

Cooperation Period

30 years (inclusive of construction)

Status

For issuance of Request for Qualification

O&M OF NEW BOHOL (PANGLAO) AIRPORT

Operation and maintenance of the airside and landside facilities of the existing airport until completion of new facilities; O&M of the new facility, management of all sub-concessions, commercial development, and future expansion of the airport.



Implementing Agency

DOTC and Civil Aviation Authority of the Philippines (CAAP)

Estimated Project Cost

USD 52.0 million
(excluding future expansion estimates)

PPP Structure

Operate-Add-and-Transfer

Cooperation Period

30 years

Status

For issuance of Request for Qualification

Passenger traffic is forecasted to reach apx 2.7 M domestic and international passengers in 2045

O&M OF LAGUINDINGAN AIRPORT

Operation and maintenance of the existing facilities of the Laguindingan Airport; expansion/ construction of new passenger terminals; enhancement of airside facilities; and installation of required equipment and associated facilities

Implementing Agency

DOTC and CAAP

Estimated Project Cost

USD 353.78 million

Cooperation Period

30 years

PPP Structure

Operate-Add-and-Transfer

Status

For issuance of Request for Qualification



Traffic	2008	2012
Domestic Passenger Traffic	884,671	1,622,049
Aircraft Movements	7,776	15,540
Cargo Traffic (MT)	11,036	21,818

O&M OF PUERTO PRINCESA AIRPORT

Operation and maintenance of the airside and landside facilities of the existing airport until completion of new facilities; O&M of the new facility, management of all sub-concessions, commercial development, and future expansion of the airport

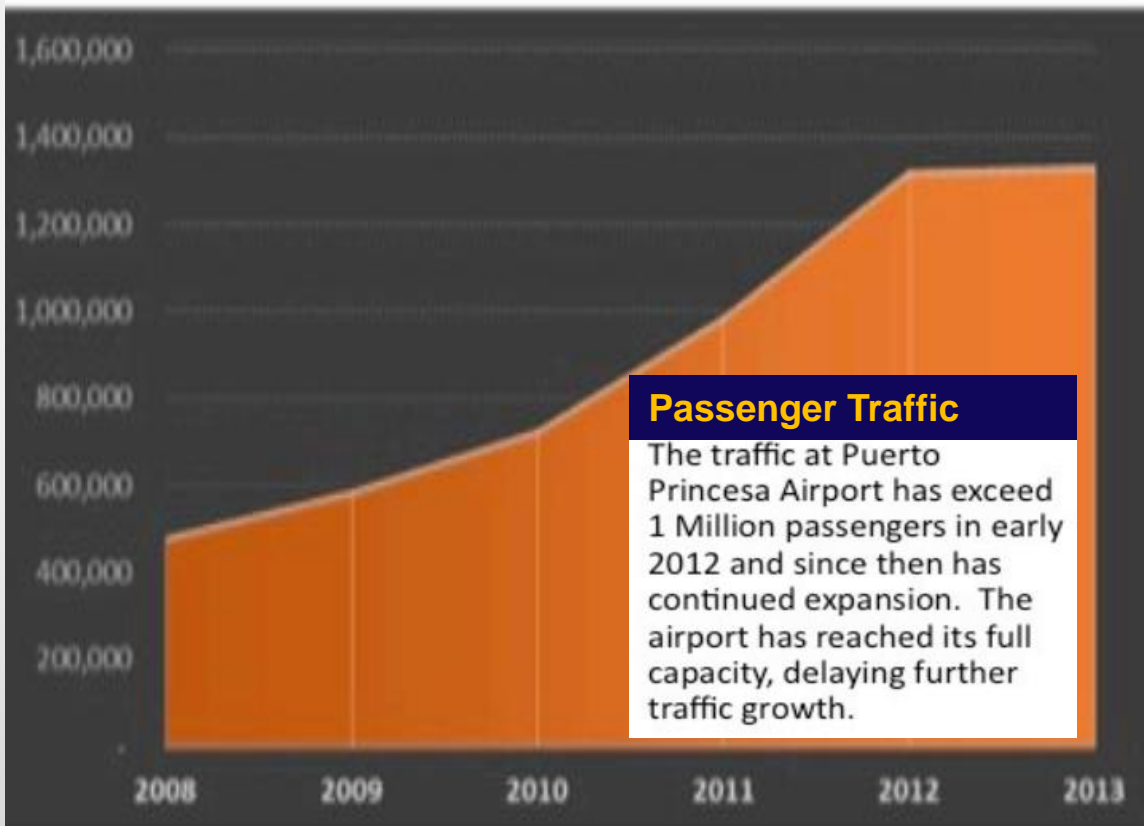

Implementing Agency

DOTC and CAAP

Estimated Project Cost

USD 116.22 million

(excluding future expansion estimates)

PPP Structure

Operate-Add-and-Transfer

Cooperation Period

30 years

Status

For approval of relevant government bodies

O&M OF DAVAO AIRPORT

Operation and maintenance of the existing Davao International Airport; enhancement/ development and O&M of airside facilities to meet the enhanced scale of operations at the airport

Implementing Agency	Estimated Project Cost
DOTC and CAAP	USD 901.56 million
Cooperation Period	PPP Structure
30 years	Operate-Add-and-Transfer
Status	
For approval of relevant government bodies	



Traffic	2008	2012
Domestic Passenger Traffic	1.64 Million	2.76 Million
International Passenger Traffic	46,468	34,905
Commercial Aircraft Movements	13,224	21,714
Cargo Traffic (MT)	33,380	43,862

O&M OF BACOLOD AIRPORT

O&M of the existing facilities of the Bacolod-Silay Airport; expansion/ construction of new passenger terminal(s); enhancement of airside facilities; and installation of all the required equipment and facilities as per applicable standards

Implementing Agency

DOTC and CAAP

Estimated Project Cost

USD 450.22 million

Cooperation Period

30 years

PPP Structure

Operate-Add-and-Transfer

Status

For approval of relevant government bodies



Traffic

	2008	2012
Domestic Passenger Traffic	0.84 Million	1.31 Million
International Passenger Traffic	-	-
Aircraft Movements	7,879	11,500
Domestic Cargo Traffic (MT)	8,268	10,788

O&M OF ILOILO AIRPORT

O&M of the existing facilities of the Iloilo Airport; expansion/construction of new passenger terminal(s); enhancement of airside facilities; and installation of all the required equipment and facilities as per applicable standards.

Implementing Agency

DOTC and CAAP

Estimated Project Cost

USD 675.56 million

Cooperation Period

30 years

PPP Structure

Operate-Add-and-Transfer

Status

For approval of relevant government bodies



Traffic

	2008	2012
Domestic Passenger Traffic	1.07 Million	1.85 Million
International Passenger Traffic	-	7,796
Aircraft Movements	9,358	16,549
Cargo Traffic (MT)	9,360	12,960

SAN FERNANDO AIRPORT

Upgrading of the San Fernando Airport facilities to meet International Civil Aviation Organization (ICAO) requirements to cater to larger aircrafts for international flights and safety standards; also involves the construction of an airport terminal with a mall complex



Implementing Agency

Bases Conversion and Development Authority (BCDA)

Estimated Project Cost

USD 180.0 million

PPP Structure

BOT

Cooperation Period

30 years

Status

Feasibility Study nearing completion

DAVAO SASA PORT

Development and Operations & Maintenance of the existing Davao Sasa Port in Davao City into a modern, international-standard container terminal

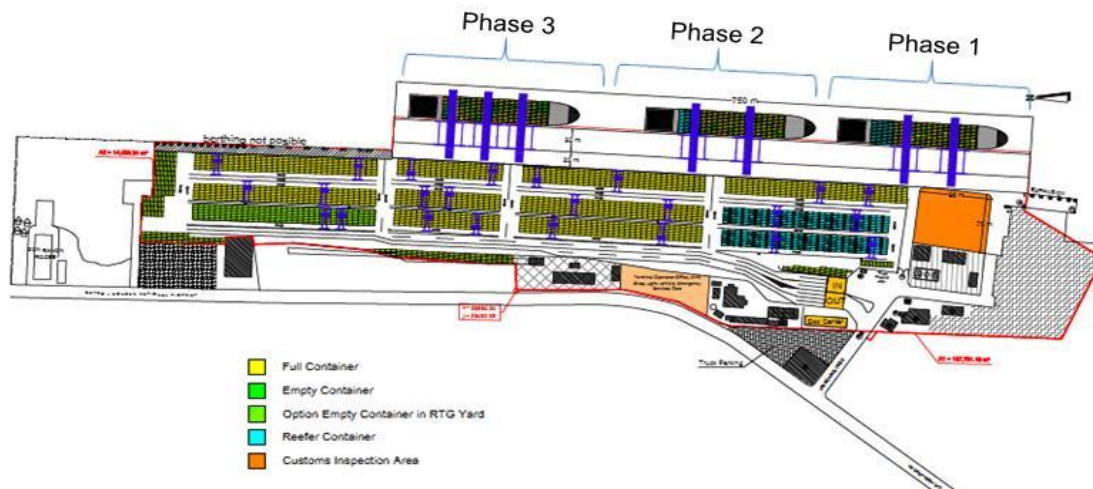

Implementing Agency

DOTC and Philippine Ports Authority (PPA)

Estimated Project Cost

USD 388.0 million

PPP Structure

BTO

Cooperation Period

35-40 years

Status

For approval of relevant government bodies

REGIONAL PRISON FACILITIES THROUGH PPP

Construction and maintenance of a prison facility with a capacity of 26,880 inmates, including staff housing and administrative buildings, areas for rehabilitation (sports, work and religious activity), and installation of high-security equipment



Implementing Agency

Department of Justice
(Bureau of Correction)

Estimated Project Cost

USD 1,115.11 million

PPP Structure

Build-Transfer-and-Maintain
(BTM)

Cooperation Period

23 years (inclusive of a 3-year
construction period)

Status

For approval of relevant
government bodies

MOTOR VEHICLE INSPECTION SYSTEM

Development and O&M of a national network of Motor Vehicle Inspection Centers using inspection methods that will be linked to the information system of the Land Transportation Office (LTO).



Implementing Agency

DOTC and Land
Transportation Office (LTO)

Estimated Project Cost

USD 428.89 million

PPP Structure

Build-Transfer-Operate (BTO)

Cooperation Period

12 years (inclusive of Design
and Construction)

Status

For approval of relevant
government bodies

By 2035, the motor vehicle population in the country is estimated to reach almost 35 million

NORTH-SOUTH RAILWAY PROJECT: SOUTH LINE

The project will entail the development and revitalization of the existing South line of the Philippine National Railway, covering the Manila-Calamba-Legaspi line and, extending to Matnog in Sorsogon. The private proponent will design, finance and rehabilitate existing structures, build new ones in the South Line as well as undertake its operation and maintenance.



Implementing Agency

DOTC

Estimated Project Cost

USD 3,702.89 million

PPP Structure

BTO

Status

Feasibility Study
nearing completion

MASS TRANSIT SYSTEM LOOP

Construction and O&M of a rail system to connect Bonifacio Global City, Makati Central Business District, and the Mall of Asia area in Pasay; involves construction of a 12-km new rail line which will run mostly underground with some elevated sections making it the first subway in the country.

Implementing Agency

DOTC

Estimated Project Cost

USD 3,000.0 million

Status

Feasibility Study nearing completion

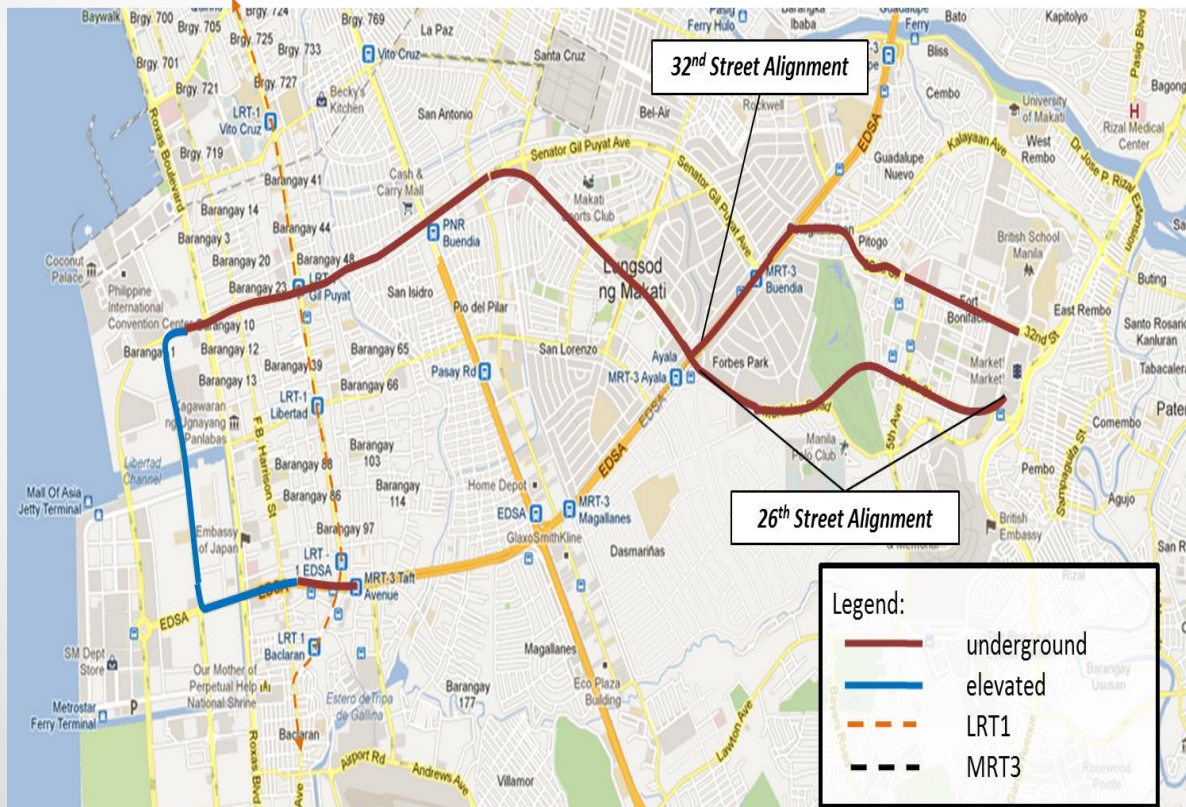

LRT LINE-1 DASMARIÑAS EXTENSION

Further extension of LRT Line-1 covering approximately 15 kilometers of service line which will start at the proposed terminus of the LRT-1 Cavite extension project in Bacoor to Dasmariñas, Cavite

Implementing Agency

DOTC

Status

Draft Feasibility Study under review



Niyog

Dasmariñas
City

BATANGAS-MANILA NATURAL GAS PIPELINE

Construction of a 110-km natural gas transmission and distribution pipeline facilities from the province of Batangas to transport and supply natural gas to Batangas, Laguna, and Cavite



Implementing Agency

Philippine National Oil Company (PNOC)

Status

Feasibility Study nearing completion

MANILA BAY-PASIG RIVER-LAGUNA LAKE FERRY SYSTEM

Development of an integrated ferry system that would traverse the Manila Bay, Pasig River, Marikina River, and the Laguna Lake



Implementing Agency

DOTC

Status

Feasibility Study nearing completion

OVERVIEW OF THE BIDDING PROCESS

Two-Stage Bidding Process

STAGE 1: Prequalification of Bidders (2-3 months)

- From publication of project advertisement/ invitation to prequalify and bid (ITPB)
- Conduct of Investors Forum and Pre-bid Conference
- Preparation and submission of qualification documents—legal, technical, financial requirements

STAGE 2: Bid Proper (5-8 months)

- From issuance of Instructions to Bidders (ITB) to release of Notice of Award (NOA)
- Conduct of Pre-bid Conference, one-on-one sessions with bidders, and responses to bidder queries
- Bidders' due diligence review and submission of bids

BASIS OF THE BID PROCESS

- RA 7718 (Amended Build-Operate-Transfer Law)
- Revised Implementing Rules and Regulations (IRR) of the BOT Law
- Bidding Rules set by the PBAC



INSTITUTIONAL ARRANGEMENT

Institutional Arrangement

- **Contracting Parties/ Implementing Agencies**
 - National Line Agencies
 - Government Corporations
 - Local Government Units
- **Review and Approving Bodies**
 - Inter-Agency Investment Coordination Committee (ICC)
 - NEDA Board
- **Coordinating and Monitoring Agency**
 - The Public-Private Partnership Center
- **Other Government Bodies Concerned**
 - Policy-making Bodies (PPP Governing Board)
 - National and Sectoral Regulatory Bodies

PREQUALIFICATION, BIDS AND AWARDS COMMITTEE (PBAC)

- Responsible for all aspects of the pre-bidding and bidding process, including the preparation of tender documents, conduct and evaluation of bids, and interpretation of the rules regarding the bidding, among others



LEGAL FRAMEWORK & OTHER POLICIES

Provisions on Foreign Participation in PPP Projects

- For projects that do not require a public utility franchise, **the facility operator or concessionaire may be foreign-owned**
- For projects that would require a public utility franchise, the facility operator must be a Filipino or, if a corporation, must be duly registered with the Securities and Exchange Commission (SEC) and owned up to at least 60% by Filipinos.



OTHER PPP INITIATIVES

Creation of the Contingent Liability Fund

- Already included in the 2014 GAA; proposed to be institutionalized in the proposed PPP Act (or amendments to the BOT Law)
- Fund to be drawn if government breaches on its obligations for PPP contracts

Project Development and Monitoring Facility

- Revolving fund that supports pre-investment activities to ensure project viability and bankability through contracting high-caliber firms
- PDMF Panel of Consulting Firms: 22 internationally-renowned consortia under Indefinite Delivery Contracts (IDCs)
- **39 projects** approved with PDMF support
 - ✓ 10 projects rolled-out with PDMF support
 - ✓ 3 projects for roll-out
 - ✓ 5 projects awaiting NEDA Board/ ICC approval
 - ✓ 9 projects with on-going pre-investment studies
 - ✓ 12 projects for procurement of transaction advisors



**For more information please visit
www.ppp.gov.ph**

**PUBLIC-PRIVATE PARTNERSHIP CENTER OF THE PHILIPPINES
NEDA COMPLEX, EDSA, DILIMAN, QUEZON CITY**

**Contact Details:
(632) 990-0721 | www.ppp.gov.ph**

