

Plan Scale 1:10000

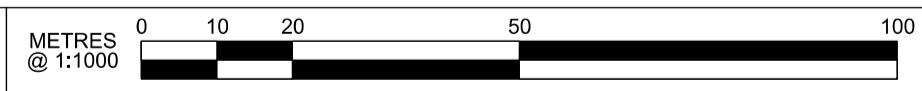
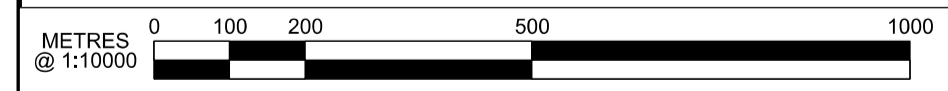
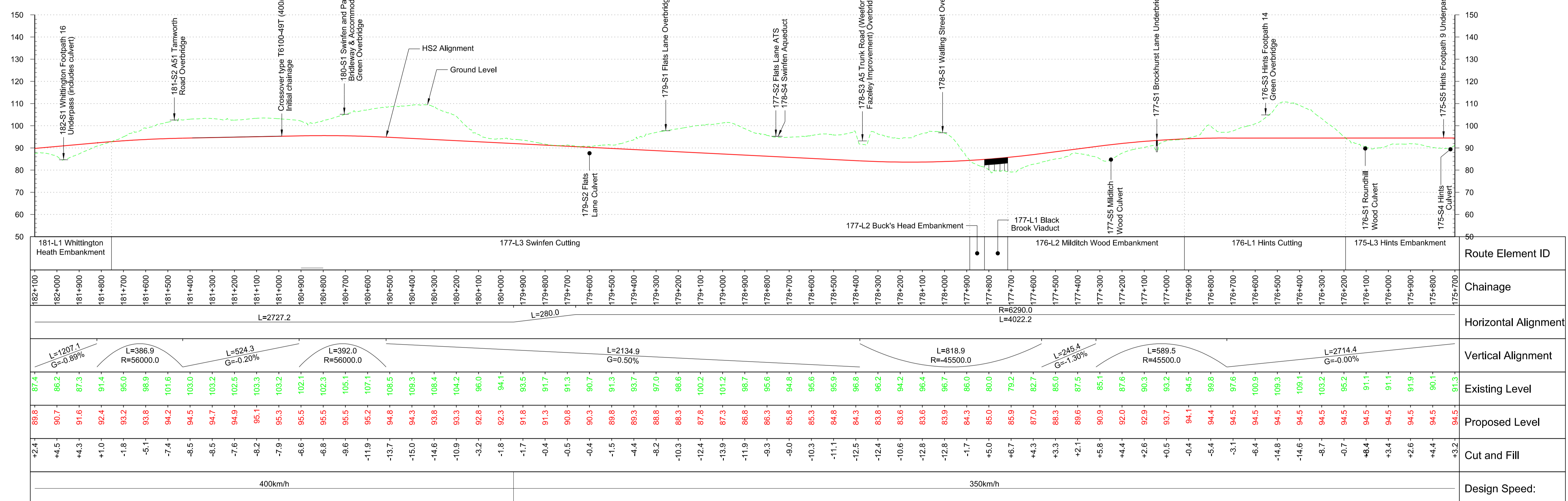

Note: Bridge Profiles indicated at FRL to HS2 track

Profile Scale H 1:10000 V 1:1000

Rev	Description	Drawn	Checked	Con App	HS2 App
P10	Condition B. Code 1. Fit for hybrid bill submission	NOR	MC	PD	
P09	Revised Interim Condition B	NOR	MC	PD	
P08	Revised Interim Condition B	NOR	MC	PD	
P07	Revised Interim Condition B	NOR	PD	PD	
P06	Interim Condition B	AG	MC	PD	

HS2 accepts no responsibility for any circumstances which arise from the reproduction of this document after alteration, amendment or abbreviation or if it is issued in part or issued incompletely in any way.

© Crown Copyright and database right 2013. All rights reserved. Ordnance Survey Licence number 100049190

© Crown Copyright material is reproduced with the permission of Land Registry under delegated authority from the Controller of HMSO.

This material was last updated on 2013 and may not be copied, distributed, sold or published without the formal permission of Land Registry. Only an official copy of a title plan or register obtained from the Land Registry may be used for legal or other official purposes.

Scale with caution as distortion can occur.

Legends/Notes:

- Depot, station, headhouse or portal building
- Tunnel portal
- Electricity substation
- Land drainage area
- Ecological mitigation pond
- Balancing pond
- Replacement floodplain storage
- Woodland habitat creation
- Wetland habitat creation
- Grassland habitat creation
- Landscape mitigation planting (scrub / woodland)
- Grassed areas
- Sustainable placement
- Public realm
- Engineering earthworks
- Landscape earthworks
- Rail alignment formation
- Returned to suitable development use
- County boundary
- Borough / District boundary
- Community forum boundary
- Watercourse diversion
- Existing watercourse
- Ditches - new
- Hedgerow habitat creation
- Existing public right of way (PRoW)
- New, diverted or realigned PRoW
- Stopped-up PRoW
- Tunnels external extent
- Rail alignment
- HS2 Access road
- Noise fence barrier
- Chainage (e.g. 10+000)

Registered in England  
Registration No. 06791686  
Registered office:  
Eland House,  
Bressenden Place,  
London, SW1E 5DU

Creator/Organizer  
**Capita Symonds Ineco JV**

HS2 Security Classification  
**INTERNAL**

Zone	Country North	Project/Contract	Country North Design
Design Stage	hybrid bill submission	Discipline/Function	Civil
Drawing Title	Main Line	Drawn	NOR
	Sheet 46 of 49	Checked	PD
	Chainage 175+700 to 182+100	Approved	PD
		Date	11/03/2013
		Scale	AS SHOWN
		Size	A1
		Drawing No.	C223-CSI-CV-DPP-030-000010
		Rev.	P10