

Plan  
Scale 1:10000

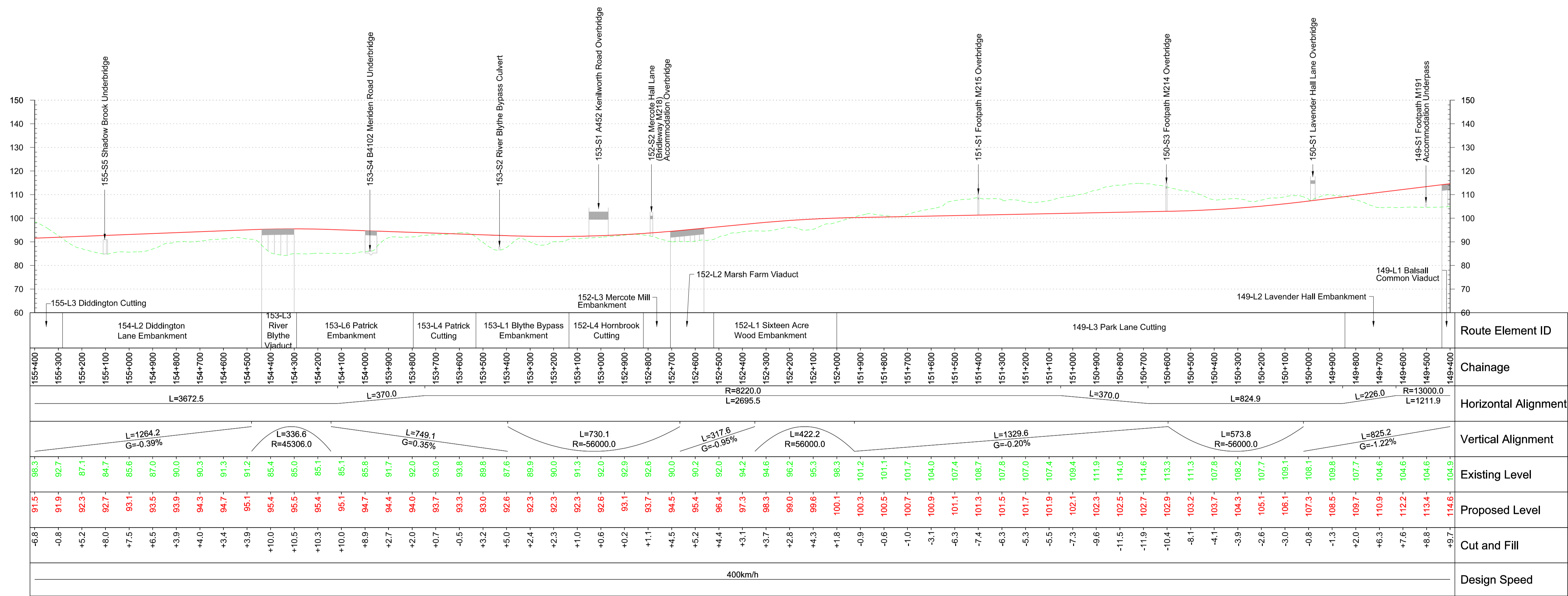

Profile  
Scale H 1:10000 V 1:1000

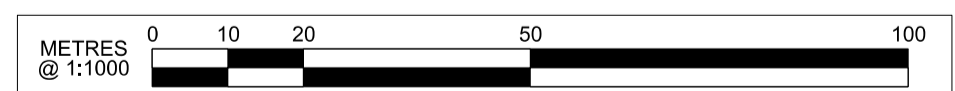
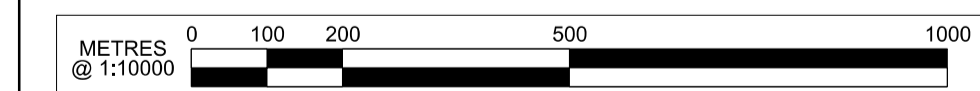

Rev	Description	Drawn	Checked	Con App	HS2 App
P07	Condition B, Code 1. Fit for hybrid bill submission	JDS	PW	PC	25/11/13
P06	Condition B, Code 1. Fit for hybrid bill submission	GLW	PW	JJPB	11/11/13
P05	Condition B, Code 1. Fit for hybrid bill submission	RHG	PW	JJPB	27/09/13
P04	Issued for Condition B2 IPD	AJT	PW	PC	23/08/13
P03	Issued for Condition B1 IPD	PN	PW	JJPB	18/06/13

HS2 accepts no responsibility for any circumstances which arise from the reproduction of this document after alteration, amendment or abbreviation or if it is issued in part or issued incompletely in any way.

© Crown Copyright and database right 2013. All rights reserved. Ordnance Survey Licence number 100049190

© Crown Copyright material is reproduced with the permission of Land Registry under delegated authority from the Controller of HMSO. This material was last updated on 2013 and may not be copied, distributed, sold or published without the formal permission of Land Registry. Only an official copy of a title plan or register obtained from the Land Registry may be used for legal or other official purposes.

Scale with caution as distortion can occur.

**Legends/Notes:**

- Depot, station, headhouse or portal building
- Tunnel portal
- Electricity substation
- Land drainage area
- Ecological mitigation pond
- Balancing pond
- Replacement floodplain storage
- Woodland habitat creation
- Wetland habitat creation
- Grassland habitat creation
- Landscape mitigation planting (scrub / woodland)
- Grassed areas
- Sustainable placement
- Public realm
- Engineering earthworks
- Landscape earthworks
- Rail alignment formation
- Returned to suitable development use
- County boundary
- Borough / District boundary
- Community forum boundary
- Watercourse diversion
- Existing watercourse
- Ditches - new
- Hedgerow habitat creation
- Main utility works
- Existing public right of way (PRoW)
- New, diverted or realigned PRoW
- Stopped-up PRoW
- Tunnels external extent
- Rail alignment
- HS2 Access road
- Noise fence barrier
- Chainage (e.g. 10+000)

Registered in England  
Registration No. 06791686  
Registered office:  
Eland House,  
Bressenden Place,  
London, SW1E 5DU

Creator/Originator  
**Ove Arup & Partners International Ltd**

HS2 Security Classification  
**INTERNAL**

Zone  
**West Midlands Metropolitan**

Design Stage  
**hybrid bill submission**

Drawing Title  
**Main Line**  
Sheet 41 of 49  
Chainage 149+400 to 155+400

Project/Contract		Discipline/Function	
<b>Birmingham Metropolitan Area Design</b>		<b>Civil</b>	
Drawn	Checked	Approved	
<b>NJB</b>	<b>PW</b>	<b>JJPB</b>	
Date	Scale	Size	
<b>13/03/2013</b>	<b>AS SHOWN</b>	<b>A1</b>	
Drawing No.		Rev.	
<b>C224-ARP-CV-DPP-040-320500</b>		<b>P07</b>	