

ZOLL AED Defibrillators Training Alert

SAFETY ALERT

In 2013 A-one+ Area 14 purchased 17 ZOLL AED PLUS Defibrillators for its depots and welfare facilities.

In August 2014, an AED was deployed when a person went into cardiac arrest at one of its locations. The first aid team responded immediately and through excellent CPR and team working kept the person alive long enough for the paramedics to take over 15 minutes later.

Whilst CPR was being administered, a ZOLL defibrillator was deployed by tearing the outer bag (photo 1), and applying the pads (photo 2). The pads have a central blue section that ensures they fit an average build of person correctly. However on this occasion, the right pad appeared to tear off making the deployer believe it had broken and called for a spare within the building, delaying the application of the AED.

Photo 1



Photo 2

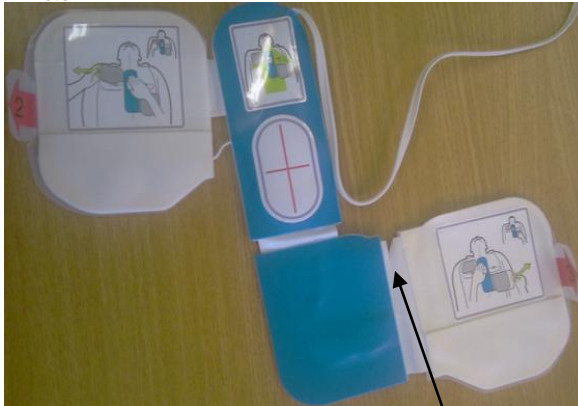

Upon investigation, ZOLL have confirmed that the V cut, between the blue central area and the right pad, is a design feature that allows a deployer to tear the right pad and apply it to a larger than average person (there is a cable hidden within the white zone that keeps the pad attached and working).

Action to be taken:

Ensure all trained defibrillator deployers understand

- what the V cut is for: tearing the unit to fit a larger person
- they know how and where the pads are supposed to be fitted on a person
- that they are aware the unit will still function should the plastic tear when opening the packaging.

Ensure trainers of this type of Defibrillator are aware of this alert and the excerpt from the ZOLL training manual on the reverse.

SHE Advice:		Area 7	Area 12	Area 14
	SHE Manager	Neil Davison 077720805449	Dean Saunders 07799 435941	Martin Partington (SBS Manager) 07912 970048
	SHE Advisor	Chris Wells 07540701 602	Dean Weston 07540 690835	Mick McCormack 07809511215
Circulation:	A-one+			
Action:	Circulate to all Defibrillator trained personnel			
Date of Issue:	04/11/2014			

Applying **CPR-D•padz**

Prepare the victim before attaching the electrodes.

WARNING! CPR-D•padz are intended for use on adult victims only; do not use on victims under 8 years of age.

To prepare the victim:

1. Remove all clothing covering the victim's chest.
2. Ensure the victim's chest is dry.
3. If the victim has excessive chest hair, clip or shave the hair to help ensure proper adhesion of the electrodes.

To apply the electrodes:

1. Tear open the electrode package and unfold the electrodes. Place the electrodes on the victim according to the graphics on the package (see Figure 5).
2. Hold the CPR sensor and place the sensor between the nipples and on the middle of the victim's breastbone, using the sensor's cross hairs to guide you.
3. Press the CPR sensor with your right hand and pull the number 2 tab to peel the protective backing from the electrode. Press the electrode from the center out to make sure it adheres properly to the victim's skin.
4. Press the CPR sensor with your left hand and pull the number 3 tab to peel the protective backing from the electrode. Press the electrode from the center out to make sure it adheres properly to the victim's skin.

NOTE If the victim is large or there is a need to place the electrode under a breast, you may need to tear away the lower pad at the perforated line (see Figure 5) and extend the pad. Place the pad slightly to the victim's left and below the victim's left breast.

NOTE If the victim has an implanted pacemaker or defibrillator in the upper right chest, angle the electrodes slightly to avoid placing the electrodes over either device. Make certain that the CPR sensor maintains a position over the lower half of the breastbone.

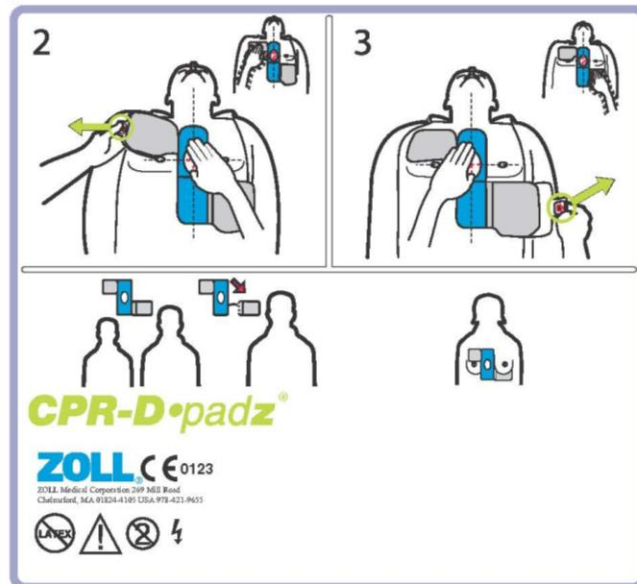

Figure 5: Placement of **CPR-D•padz**