

For Continuation Refer To C221-MMD-CV-DPP-010-201501

**Plan**  
Scale 1:2500

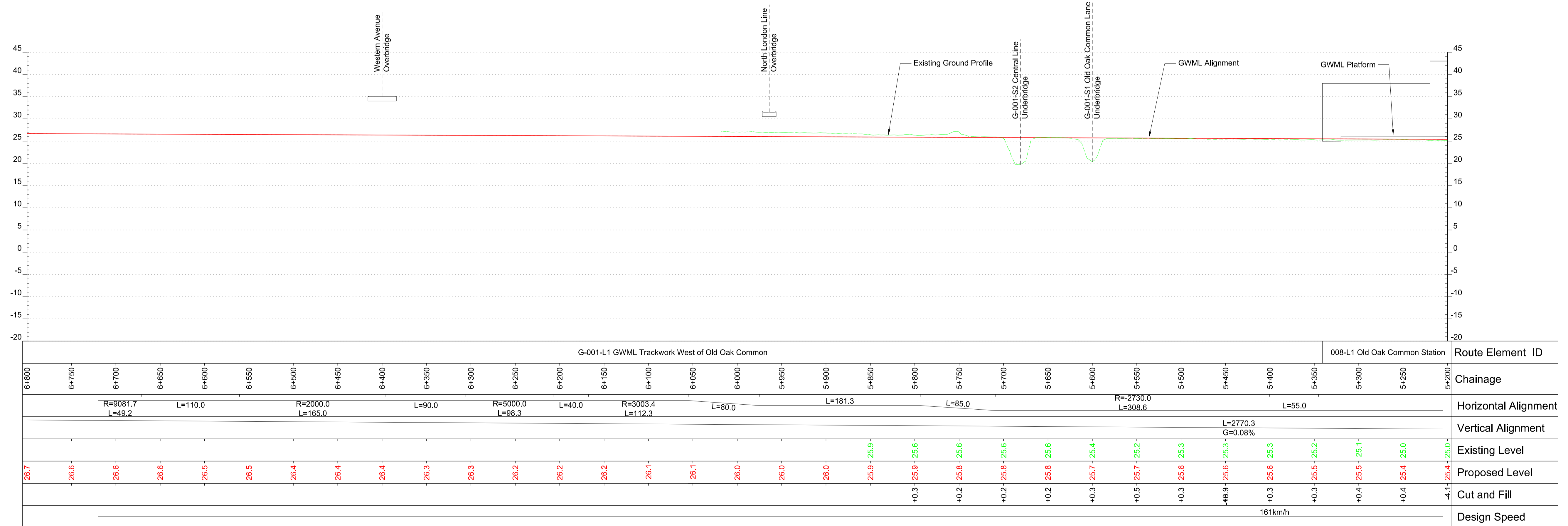

**Profile**  
Scale H 1:2500 V 1:500

© Mott MacDonald  
This document is issued for the party which commissioned it and for specific purposes connected with the captioned project only. It should not be relied upon by any other party or used for any other purpose. We accept no responsibility for the consequences of this document being relied upon by any other party, or being used for any other purpose, or containing any error or omission which is due to an error or omission in data supplied to us by other parties.

© Crown Copyright and database right 2013. All rights reserved.  
Ordnance Survey Licence number 100049190

© Crown Copyright material is reproduced with the permission of Land Registry under delegated authority from the Controller of HMSO.  
This material was last updated on 2013 and may not be copied, distributed, sold or published without the formal permission of Land Registry. Only an official copy of a title plan or register obtained from the Land Registry may be used for legal or other official purposes.

Scale with caution as distortion can occur.

**Legends/Notes:**

- Depot, station, headhouse or portal building
- Tunnel portal
- Electricity substation
- Land drainage area
- Ecological mitigation pond
- Balancing pond
- Replacement floodplain storage
- Woodland habitat creation
- Wetland habitat creation
- Grassland habitat creation (scrub / woodland)
- Landscape mitigation planting
- Grassed areas
- Sustainable placement
- Public realm
- Engineering earthworks
- Landscape earthworks
- Rail alignment formation
- Returned to suitable development use
- County boundary
- Borough / District boundary
- Community forum boundary
- Watercourse diversion
- Existing watercourse
- Ditches - new
- Hedgerow habitat creation
- Main utility works
- Existing public right of way (PRoW)
- New, diverted or realigned PRoW
- Stopped-up PRoW
- Tunnels external extent
- Rail alignment
- HS2 Access road
- Noise fence barrier
- Chainage (e.g. 10+000)

Registered in England  
Registration No. 06791686  
Registered office:  
Eland House,  
Bressenden Place,  
London, SW1E 5DU

Creator/Organator  
**Mott MacDonald**

HS2 Security Classification  
**INTERNAL**

Zone  
**London Metropolitan**

Design Stage  
**hybrid bill submission**

Drawing Title  
**Great Western Main Line  
Sheet 2 of 2  
Chainage 5+200 to 6+800**

Project/Contract <b>London Metropolitan Area Design</b>			
Discipline/Function <b>Civil</b>			
Drawn <b>IM</b>	Checked <b>SA</b>	Approved <b>MP</b>	
Date <b>11/10/2013</b>	Scale <b>AS SHOWN</b>	Size <b>A1</b>	
Drawing No. <b>C221-MMD-CV-DPP-010-201701</b>			Rev. <b>P07</b>