

Permit with introductory note

The Environmental Permitting (England & Wales) Regulations 2010

Mr Simon Hall, Mr John Hall, Mrs
Doreen Hall and Mr David Hall

Highfield Grange
Greengate Lane
Thornton Dale
Pickering
YO18 7LX

Permit number
EPR/KP3439EP

Highfield Grange

Permit number EPR/KP3439EP

Introductory note

This introductory note does not form a part of the permit

The main features of the permit are as follows.

Highfield Grange Farm is situated approximately 450m north east of the village of Thornton-Le-Dale in North Yorkshire. The installation is approximately centred on National Grid Reference SE SE82771,83437.

The installation is operated by Mr Simon Hall, Mr John Hall, Mrs Doreen Hall and Mr David Hall (J&D Hall Partnership) and is a pig breeding, rearing and finishing business. All pigs are bred on site including replacement gilts and boars. The farm has around 735 breeding pigs (i.e. sows, gilts and boars), 3600 growing pigs and 3600 finishing pigs.

There are currently two farrowing houses, one containing 100 crates and the other 17 crates. Piglets heat mats are on a diminishing curve of heat so as they grow older and require less heat the mat does not offer as much, saving energy. Weaning takes place at an average of 24 days and these pigs progress to the nursery until they reach a weight of 15kg. The pigs go through an intermediate grower stage after the nursery until they are upwards of 30kg and then they are transferred to the finisher sheds until 108kg (around 24 weeks).

As each growing stage is completed all pens are pressure washed out before restocking and all wash water drains into the slurry pit. Slurry is removed on a regular basis using a sealed tanker and either spread on own land or taken to the secure lagoon depending on season and nutrient requirement of the crops in accordance with the manure management plan.

The slurry lagoon is located approximately 2 miles north of the farm and has a capacity to hold up to 4000m³ of slurry, however this does not form part of the installation and is not regulated by this permit. The farm itself has a smaller slurry reception pit which holds approximately 50m³ but the purpose of this pit is simply to allow the slurry tanker to remove the slurry from the sheds. Slurry is removed from all buildings on approximately a monthly basis (although they are capable of five months worth or storage) and is mixed prior to removal to prevent blockages in the pipes and reduce sediment in the slurry pits.

The farm comprises of mainly modern type buildings less than five years old and some older twenty years old and above buildings, which the operator is intending to replace with modern buildings using best practice technology and techniques. The modern buildings are built using insulated bonded panels with roof outlet chimneys with an efflux velocity of 7m/s, for increased ventilation efficiency. Specifically the grower pens have roof vents with fans, the finisher pens will have roof vents with fans (on completion of improvement condition IC1) and boar pens and sow houses are naturally vented.

Pig mortalities are removed each day and numbers recorded and carcasses held in a covered vermin proof container prior to delivery to approved disposal centre.

The sow house and boar pens are the only buildings not on a slatted surface so require straw bedding. They are cleaned out 3 times weekly using a scraper and the manure/soiled bedding is contained in an undercover manure heap until it is relocated to a field heap and spread.

Only lightly contaminated water and clean rain water is fed into soakaways, any water which is potentially contaminated from farm yard manure or milling activities is fed into dirty water tanks or slurry pits.

There is a biomass boiler on site but this does not form part of the installation as it simply heats the farm houses, and so is not covered by this permit.

There are 3 SACs or SPA's within 10km of the site, 7 SSSI's within 5km of the site and 5 local wildlife or ancient woodlands within 2km of the site.

This permit implements the requirements of the EU Directive on Industrial Emissions.

The status log of the permit sets out the permitting history, including any changes to the permit reference number.

Status log of the permit		
Description	Date	Comments
Application EPR/KP3439EP/A001	Duly made 07/02/14	Application for an intensive farming pig installation permit.
Additional information received	Emails dated 13/3/14 & 18/3/14	Response to schedule 5 notice dated 10/3/14.
Permit determined	08/04/14	Permit issued to Mr Simon Hall, Mr John Hall, Mrs Doreen Hall and Mr David Hall

End of introductory note

Permit

The Environmental Permitting (England and Wales) Regulations 2010

Permit number
EPR/KP3439EP

The Environment Agency hereby authorises, under regulation 13 of the Environmental Permitting (England and Wales) Regulations 2010

Mr Simon Hall, Mr John Hall, Mrs Doreen Hall and Mr David Hall (“the operator”),

whose principal office is

Highfield Grange
Greengate Lane
Thornton Dale
Pickering
YO18 7LX

to operate an installation at

Highfield Grange
Greengate Lane
Thornton Dale
Pickering
YO18 7LX

to the extent authorised by and subject to the conditions of this permit.

Name	Date
A.J. Nixon	08 April 2014

Authorised on behalf of the Environment Agency

Conditions

1 Management

1.1 General management

1.1.1 The operator shall manage and operate the activities:

- (a) in accordance with a written management system that identifies and minimises risks of pollution, including those arising from operations, maintenance, accidents, incidents, non-conformances, closure and those drawn to the attention of the operator as a result of complaints; and
- (b) using sufficient competent persons and resources.

1.1.2 Records demonstrating compliance with condition 1.1.1 shall be maintained.

1.1.3 Any person having duties that are or may be affected by the matters set out in this permit shall have convenient access to a copy of it kept at or near the place where those duties are carried out.

1.2 Energy efficiency

1.2.1 The operator shall:

- (a) take appropriate measures to ensure that energy is used efficiently in the activities;
- (b) review and record at least every four years whether there are suitable opportunities to improve the energy efficiency of the activities; and
- (c) take any further appropriate measures identified by a review.

1.3 Efficient use of raw materials

1.3.1 The operator shall:

- (a) take appropriate measures to ensure that raw materials and water are used efficiently in the activities;
- (b) maintain records of raw materials and water used in the activities;
- (c) review and record at least every four years whether there are suitable alternative materials that could reduce environmental impact or opportunities to improve the efficiency of raw material and water use; and
- (d) take any further appropriate measures identified by a review.

1.4 Avoidance, recovery and disposal of wastes produced by the activities

1.4.1 The operator shall take appropriate measures to ensure that:

- (a) the waste hierarchy referred to in Article 4 of the Waste Framework Directive is applied to the generation of waste by the activities; and
- (b) any waste generated by the activities is treated in accordance with the waste hierarchy referred to in Article 4 of the Waste Framework Directive; and

(c) where disposal is necessary, this is undertaken in a manner which minimises its impact on the environment.

1.4.2 The operator shall review and record at least every four years whether changes to those measures should be made and take any further appropriate measures identified by a review.

2 Operations

2.1 Permitted activities

2.1.1 The operator is only authorised to carry out the activities specified in schedule 1 table S1.1 (the “activities”).

2.2 The site

2.2.1 The activities shall not extend beyond the site, being the land shown edged in green on the site plan at schedule 7 to this permit.

2.3 Operating techniques

2.3.1 (a) The activities shall, subject to the conditions of this permit, be operated using the techniques and in the manner described in the documentation specified in schedule 1, table S1.2, unless otherwise agreed in writing by the Environment Agency.

(b) If notified by the Environment Agency that the activities are giving rise to pollution, the operator shall submit to the Environment Agency for approval within the period specified, a revision of any plan or other documentation (“plan”) specified in schedule 1, table S1.2 or otherwise required under this permit which identifies and minimises the risks of pollution relevant to that plan, and shall implement the approved revised plan in place of the original from the date of approval, unless otherwise agreed in writing by the Environment Agency.

2.3.2 The operator shall maintain and implement a system to record the number of animal places and animal movements.

2.3.3 The operator shall take appropriate measures in off-site disposal or recovery of solid manure or slurry to prevent, or where this is not practicable to minimise, pollution.

2.3.4 The operator shall:

(a) maintain and implement a manure management plan;

(b) review and record at least every four years whether changes to the plan should be made;

(c) make any appropriate changes to the plan identified by the review.

2.3.5 Any raw materials or fuels listed in schedule 2 table S2.1 shall conform to the specifications set out in that table.

2.3.6 The operator shall ensure that where waste produced by the activities is sent to a relevant waste operation, that operation is provided with the following information, prior to the receipt of the waste:

(a) the nature of the process producing the waste;

- (b) the composition of the waste;
- (c) the handling requirements of the waste;
- (d) the hazardous property associated with the waste, if applicable; and
- (e) the waste code of the waste.

2.3.7 The operator shall ensure that where waste produced by the activities is sent to a landfill site, it meets the waste acceptance criteria for that landfill.

2.4 Improvement programme

2.4.1 The operator shall complete the improvements specified in schedule 1 table S1.3 by the date specified in that table unless otherwise agreed in writing by the Environment Agency.

2.4.2 Except in the case of an improvement which consists only of a submission to the Environment Agency, the operator shall notify the Environment Agency within 14 days of completion of each improvement.

3 Emissions and monitoring

3.1 Emissions to water, air or land

3.1.1 There shall be no point source emissions to water, air or land except from the sources and emission points listed in schedule 3 tables S3.1 and S3.2.

3.1.2 The limits given in schedule 3 shall not be exceeded.

3.1.3 Periodic monitoring shall be carried out at least once every 5 years for groundwater and 10 years for soil, unless such monitoring is based on a systematic appraisal of the risk of contamination.

3.2 Emissions of substances not controlled by emission limits

3.2.1 Emissions of substances not controlled by emission limits (excluding odour) shall not cause pollution. The operator shall not be taken to have breached this condition if appropriate measures, including, but not limited to, those specified in any approved emissions management plan, have been taken to prevent or where that is not practicable, to minimise, those emissions.

3.2.2 The operator shall:

- (a) if notified by the Environment Agency that the activities are giving rise to pollution, submit to the Environment Agency for approval within the period specified, an emissions management plan which identifies and minimises the risks of pollution from emissions of substances not controlled by emission limits;
- (b) implement the approved emissions management plan, from the date of approval, unless otherwise agreed in writing by the Environment Agency.

3.2.3 All liquids in containers, whose emission to water or land could cause pollution, shall be provided with secondary containment, unless the operator has used other appropriate measures to prevent or where that is not practicable, to minimise, leakage and spillage from the primary container.

3.3 Odour

- 3.3.1 Emissions from the activities shall be free from odour at levels likely to cause pollution outside the site, as perceived by an authorised officer of the Environment Agency, unless the operator has used appropriate measures, including, but not limited to, those specified in any approved odour management plan, to prevent or where that is not practicable to minimise the odour.

3.4 Noise and vibration

- 3.4.1 Emissions from the activities shall be free from noise and vibration at levels likely to cause pollution outside the site, as perceived by an authorised officer of the Environment Agency, unless the operator has used appropriate measures, including, but not limited to, those specified in any approved noise and vibration management plan to prevent or where that is not practicable to minimise the noise and vibration.

3.5 Monitoring

- 3.5.1 The operator shall, unless otherwise agreed in writing by the Environment Agency, undertake the monitoring specified in the following tables in schedule 3 to this permit:
- (a) point source emissions specified in tables S3.1 and S3.2

3.6 Pests

- 3.6.1 The activities shall not give rise to the presence of pests which are likely to cause pollution, hazard or annoyance outside the boundary of the site. The operator shall not be taken to have breached this condition if appropriate measures, including, but not limited to, those specified in any approved pests management plan, have been taken to prevent or where that is not practicable, to minimise the presence of pests on the site.
- 3.6.2 The operator shall:
- (a) if notified by the Environment Agency, submit to the Environment Agency for approval within the period specified, a pests management plan which identifies and minimises risks of pollution, hazard or annoyance from pests;
- (b) implement the pests management plan, from the date of approval, unless otherwise agreed in writing by the Environment Agency.

4 Information

4.1 Records

- 4.1.1 All records required to be made by this permit shall:
- (a) be legible;
- (b) be made as soon as reasonably practicable;
- (c) if amended, be amended in such a way that the original and any subsequent amendments remain legible, or are capable of retrieval; and
- (d) be retained, unless otherwise agreed in writing by the Environment Agency, for at least 6 years from the date when the records were made, or in the case of the following records until permit surrender:
- (i) off-site environmental effects; and
- (ii) matters which affect the condition of the land and groundwater.

- 4.1.2 The operator shall keep on site all records, plans and the management system required to be maintained by this permit, unless otherwise agreed in writing by the Environment Agency.

4.2 Reporting

- 4.2.1 The operator shall send all reports and notifications required by the permit to the Environment Agency using the contact details supplied in writing by the Environment Agency.
- 4.2.2 The operator shall, unless notice under this condition has been served within the preceding four years, submit to the Environment Agency, within six months of receipt of a written notice, a report assessing whether there are other appropriate measures that could be taken to prevent, or where that is not practicable, to minimise pollution.

4.3 Notifications

- 4.3.1 (a) In the event that the operation of the activities gives rise to an incident or accident which significantly affects or may significantly affect the environment, the operator must immediately—
- (i) inform the Environment Agency,
 - (ii) take the measures necessary to limit the environmental consequences of such an incident or accident, and
 - (iii) take the measures necessary to prevent further possible incidents or accidents;
- (b) in the event of a breach of any permit condition the operator must immediately—
- (i) inform the Environment Agency, and
 - (ii) take the measures necessary to ensure that compliance is restored within the shortest possible time;
- (c) in the event of a breach of permit condition which poses an immediate danger to human health or threatens to cause an immediate significant adverse effect on the environment, the operator must immediately suspend the operation of the activities or the relevant part of it until compliance with the permit conditions has been restored.
- 4.3.2 Any information provided under condition 4.3.1 shall be confirmed by sending the information listed in schedule 5 to this permit within the time period specified in that schedule.
- 4.3.3 Where the Environment Agency has requested in writing that it shall be notified when the operator is to undertake monitoring and/or spot sampling, the operator shall inform the Environment Agency when the relevant monitoring and/or spot sampling is to take place. The operator shall provide this information to the Environment Agency at least 14 days before the date the monitoring is to be undertaken.
- 4.3.4 The Environment Agency shall be notified within 14 days of the occurrence of the following matters, except where such disclosure is prohibited by Stock Exchange rules:
- Where the operator is a registered company:
- (a) any change in the operator's trading name, registered name or registered office address; and

- (b) any steps taken with a view to the operator going into administration, entering into a company voluntary arrangement or being wound up.

Where the operator is a corporate body other than a registered company:

- (a) any change in the operator's name or address; and
- (b) any steps taken with a view to the dissolution of the operator.

In any other case:

- (a) the death of any of the named operators (where the operator consists of more than one named individual);
- (b) any change in the operator's name(s) or address(es); and
- (c) any steps taken with a view to the operator, or any one of them, going into bankruptcy, entering into a composition or arrangement with creditors, or, in the case of them being in a partnership, dissolving the partnership.

4.3.5 Where the operator proposes to make a change in the nature or functioning, or an extension of the activities, which may have consequences for the environment and the change is not otherwise the subject of an application for approval under the Regulations or this permit:

- (a) the Environment Agency shall be notified at least 14 days before making the change; and
- (b) the notification shall contain a description of the proposed change in operation.

4.3.6 The Environment Agency shall be given at least 14 days notice before implementation of any part of the site closure plan.

4.4 Interpretation

4.4.1 In this permit the expressions listed in schedule 6 shall have the meaning given in that schedule.

4.4.2 In this permit references to reports and notifications mean written reports and notifications, except where reference is made to notification being made "without delay", in which case it may be provided by telephone.

Schedule 1 - Operations

Table S1.1 activities		
Activity listed in Schedule 1 of the EP Regulations	Description of specified activity	Limits of specified activity
Section 6.9 A(1)(a)(ii) Rearing of pigs intensively in an installation with more than 2,000 places for production pigs (over 30kg)	Rearing of pigs intensively in an installation with a capacity for 3633 production pig (over 30kg) places, [including 23 boars].	Keeping of production pigs and not served gilts (over 30kg), including from receipt of raw materials and fuels on to the site to pigs and associated wastes being removed from site.
Directly Associated Activity		
Keeping sows (below the threshold)	Rearing of breeding stock in an installation with a capacity for 735 sow places.	Keeping of sows and served gilts for production of piglets, from receipt of raw materials and fuels on to the site to removal of sows and associated wastes from site
Rearing of pigs (up to 30kg)	Rearing of 3590 pigs to 30kg	From weaning pigs and receipt of raw materials and fuels on to the site up to pigs reaching 30kg and removal of pigs and associated wastes from site
Feed mill	The milling, mixing and transfer of feedstuff to and from storage areas.	From receipt of raw materials and fuels onto the site to removal of feed and associated wastes.

Table S1.2 Operating techniques		
Description	Parts	Date Received
Application	Response to section 3a – technical standards , Part B3 of the application form, and the operating techniques identified in the following application documents: Appendix 5 – non technical summary Appendix 6 – environmental risk assessment Appendix 9 – accident management plan Highfield Grange – J&D Hall Energy Review	Duly made 7/2/14
Application	Odour management plan reference “B2.3.4 odour management pan – pig final” in Appendix 7 of supporting information, in response to section 3b, table 3b – General Requirements, of part B3 of the application form	Duly made 7/2/14
Application	Noise management plan reference “B2.3.5 noise management pan – pig final” in Appendix 8 of supporting information, in response to section 3b, table 3b – General Requirements, of part B3 of the application form	Duly made 7/2/14
Response to Schedule 5 Notice dated 10/3/14	Response to questions: 1- confirming numbers and types of pigs on site, 4- confirming finishing house venting, 7- detailing planned preventative maintenance, 9 – detailing slurry pit design 10 – detailing water and contaminated water drainage	Emails dated 13/3/14 and 18/3/14

Table S1.3 Improvement programme requirements

Reference	Requirement	Date
IC1	The operator shall install roof extraction fans on the finishing houses	15/10/14

Schedule 2 - Waste types, raw materials and fuels

Table S2.1 Raw materials and fuels

Raw materials and fuel description	Specification
-	

Schedule 3 – Emissions and monitoring

Table S3.1 Point source emissions to air – emission limits and monitoring requirements

Emission point ref. & location	Parameter	Source	Limit (including unit)	Reference period	Monitoring frequency	Monitoring standard or method
GPA 1-7 Roof Vents with fans, shown on site plan in Schedule 7	No parameters set	Grower Pens	No limit set	--	--	--
FPA 1-12 High Capacity roof chimney outlets with fans, shown on site plan in Schedule 7	No parameters set	Finishing Pens	No limit set	--	--	--
BPA 1 Natural ventilation shown on site plan in Schedule 7	No parameters set	Boar Pens	No limit set	--	--	--
SHA 1-4 Natural ventilation shown on site plan in Schedule 7	No parameters set	Sow House	No limit set	--	--	--
A1 vent from diesel tank on site	No parameters set	Diesel Tank	No limit set	--	--	--

Table S3.2 Point Source emissions to water (other than sewer) and land – emission limits and monitoring requirements

Emission point ref. & location	Parameter	Source	Limit (incl. unit)	Reference Period	Monitoring frequency	Monitoring standard or method
WS 1-3 soakaways on site plan in schedule 7	No parameters set	Rain water from workshop building	No limit set	--	--	--
ES 1-4 soakaways on site plan in schedule 7	No parameters set	Rain water from equipment shed	No limit set	--	--	--
GP 1-18 soakaways on site plan in schedule 7	No parameters set	Lightly Contaminated rain water from roof of grower pens	No limit set	--	--	--

Table S3.2 Point Source emissions to water (other than sewer) and land – emission limits and monitoring requirements

Emission point ref. & location	Parameter	Source	Limit (incl. unit)	Reference Period	Monitoring frequency	Monitoring standard or method
BP 1-4 soakaways on site plan in schedule 7	No parameters set	Rain water from roof of boar pens	No limit set	--	--	--
FP 1-12 soakaways on site plan in schedule 7	No parameters set	Lightly Contaminated rain water from roof of finisher pens	No limit set	--	--	--
M1-5 soakaways on site plan in schedule 7	No parameters set	Rain water from roof of mill	No limit set	--	--	--
SH 1-4 soakaways on site plan in schedule 7	No parameters set	Lightly Contaminated rain water from roof of sow house	No limit set	--	--	--

Schedule 4 - Reporting

There is no reporting under this schedule.

Schedule 5 - Notification

These pages outline the information that the operator must provide.

Units of measurement used in information supplied under Part A and B requirements shall be appropriate to the circumstances of the emission. Where appropriate, a comparison should be made of actual emissions and authorised emission limits.

If any information is considered commercially confidential, it should be separated from non-confidential information, supplied on a separate sheet and accompanied by an application for commercial confidentiality under the provisions of the EP Regulations.

Part A

Permit Number	
Name of operator	
Location of Facility	
Time and date of the detection	

(a) Notification requirements for any malfunction, breakdown or failure of equipment or techniques, accident, or emission of a substance not controlled by an emission limit which has caused, is causing or may cause significant pollution

To be notified within 24 hours of detection	
Date and time of the event	
Reference or description of the location of the event	
Description of where any release into the environment took place	
Substances(s) potentially released	
Best estimate of the quantity or rate of release of substances	
Measures taken, or intended to be taken, to stop any emission	
Description of the failure or accident.	

(b) Notification requirements for the breach of a limit

To be notified within 24 hours of detection unless otherwise specified below	
Emission point reference/ source	
Parameter(s)	
Limit	
Measured value and uncertainty	
Date and time of monitoring	
Measures taken, or intended to be taken, to stop the emission	

Time periods for notification following detection of a breach of a limit	
Parameter	Notification period

(c) Notification requirements for the detection of any significant adverse environmental effect	
To be notified within 24 hours of detection	
Description of where the effect on the environment was detected	
Substances(s) detected	
Concentrations of substances detected	
Date of monitoring/sampling	

Part B - to be submitted as soon as practicable

Any more accurate information on the matters for notification under Part A.	
Measures taken, or intended to be taken, to prevent a recurrence of the incident	
Measures taken, or intended to be taken, to rectify, limit or prevent any pollution of the environment which has been or may be caused by the emission	
The dates of any unauthorised emissions from the facility in the preceding 24 months.	

Name*	
Post	
Signature	
Date	

* authorised to sign on behalf of the operator

Schedule 6 - Interpretation

“*accident*” means an accident that may result in pollution.

“*application*” means the application for this permit, together with any additional information supplied by the operator as part of the application and any response to a notice served under Schedule 5 to the EP Regulations.

“*authorised officer*” means any person authorised by the Environment Agency under section 108(1) of The Environment Act 1995 to exercise, in accordance with the terms of any such authorisation, any power specified in section 108(4) of that Act.

“*building*” means a construction that has the objective of providing sheltering cover and minimising emissions of noise, particulate matter, odour and litter.

“*emissions to land*” includes emissions to groundwater.

“*emissions of substances not controlled by emission limits*” means emissions of substances to air, water or land from the activities, *either from the emission points specified in schedule 3 or from other localised or diffuse sources, which are not controlled by an emission limit.*

“*EP Regulations*” means The Environmental Permitting (England and Wales) Regulations SI 2010 No.675 and words and expressions used in this permit which are also used in the Regulations have the same meanings as in those Regulations.

“*groundwater*” means all water, which is below the surface of the ground in the saturation zone and in direct contact with the ground or subsoil.

“*Industrial Emissions Directive*” means DIRECTIVE 2010/75/EU OF THE EUROPEAN PARLIAMENT AND OF THE COUNCIL of 24 November 2010 on industrial emissions

“*Manure and slurry*” have the following meaning:

- Manures may be either slurries or solid manures.
- Slurries consist of excreta produced by livestock whilst in a yard or building mixed with rainwater and wash water and, in some cases, waste bedding and feed. Slurries can be pumped or discharged by gravity.
- Slurry includes duck effluent, seepage from manure and wash water.
- Solid manures include farmyard manure (FYM) and comprise material from straw-based housing systems, excreta with lots of straw/sawdust/woodchips in it, or solids from mechanical separators.
- Most poultry systems produce solid manure (litter).
- Solid manure can generally be stacked.

“*Manure management plan*” means the requirements described in Section 2.3 of SGN 6.09 How to Comply – Intensive Farming.

“*Pests*” mean birds, vermin and insects.

“*SGN How to comply – Intensive Farming*” The EPR Sector Guidance Note 6.09 for intensive pig and poultry farmers, Version 2 published January 2010.

“*year*” means calendar year ending 31 December.

Schedule 7 - Site plan

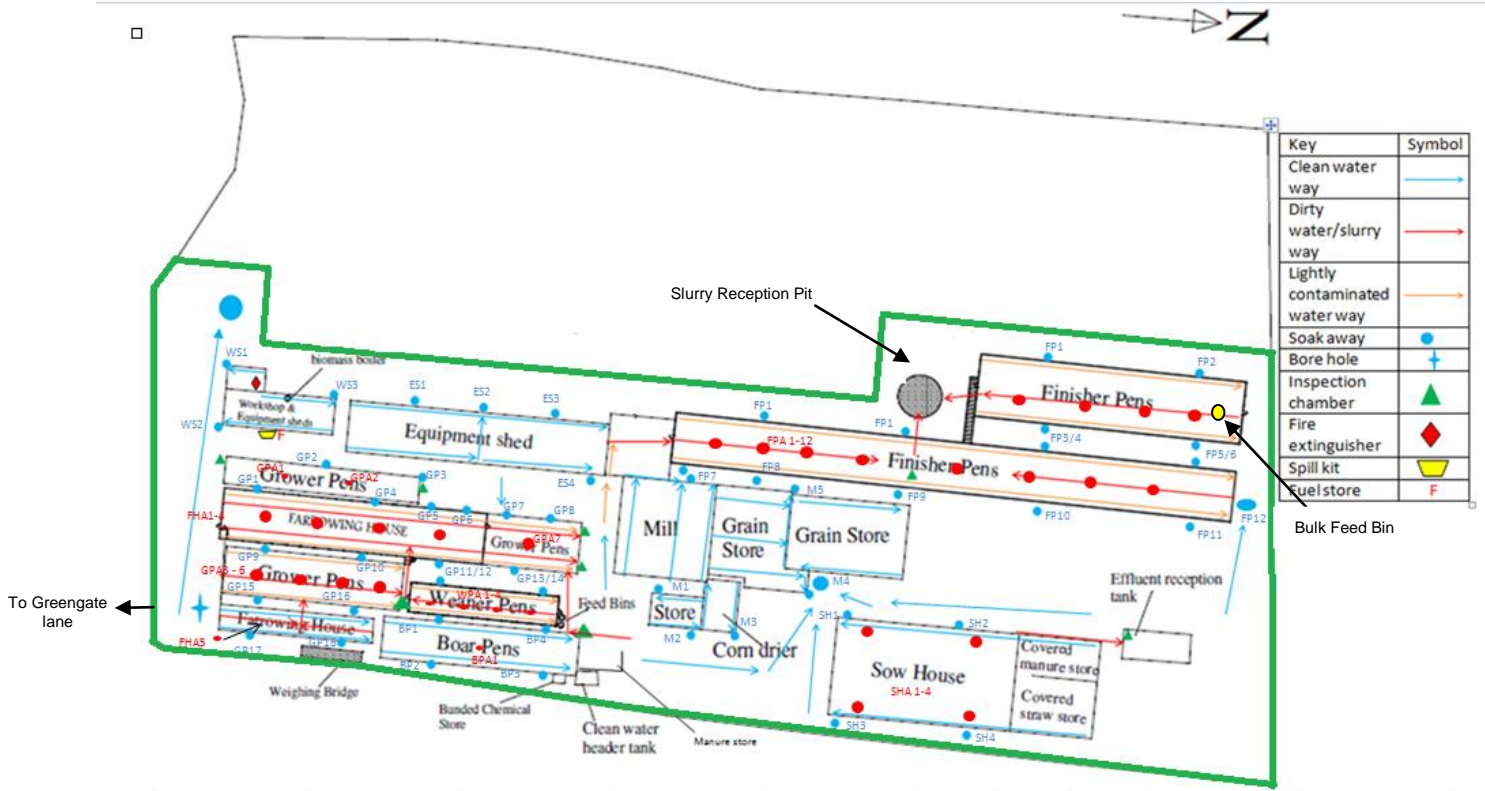

Point source emissions to land (soakaways)

Emission point ref.	Source
WS 1-3	Rain water from workshop building
ES 1-4	Rain water from equipment shed
GP 1-18	Lightly contaminated rain water from the roof of grower pens
BP 1-4	Rain water from the roof of the boar pens
FP 1-12	Lightly contaminated water from the roof of finisher pens
M1-5	Rain water from the roof of the mill
SH 1-4	Lightly contaminated water from the roof of the mill

Point source emissions to air

Emission point ref.	Source
GPA 1-7	Roof vents with fans in grower pens
FPA 1-5	High capacity roof outlets (chimneys)
BPA 1	Naturally ventilated (open ridge)
SHA 1-4	Naturally ventilation (Yorkshire boarding)

END OF PERMIT