

Profile
Scale H 1:15000 V 1:1500

Fit for Information

P01	Draft	TCS	MRW	PC	
		06/11/14	31/10/14	31/10/14	

HS2 accepts no responsibility for any circumstances which arise from the reproduction of this document after alteration, amendment or abbreviation or if it is issued in part or issued incompletely in any way.

© Crown Copyright and database right 2014. All rights reserved. Ordnance Survey Licence number 100049190

© Crown Copyright material is reproduced with the permission of Land Registry under delegated authority from the Controller of HMSO.

This material was last updated on 2014 and may not be copied, distributed, sold or published without the formal permission of Land Registry. Only an official copy of a title plan or register obtained from the Land Registry may be used for legal or other official purposes.

Scale with caution as distortion can occur.

Legends/Notes:

Plan Legend:-

- Hybrid Bid Scheme Limit of Deviation
- Construction Compound required for Tunnel Works
- Tunnel Option Vertical Alignment
- Tunnel Structure
- Existing Hybrid Bill Design
- Construction Traffic Route

Profile Legend:-

- Existing Ground Level
- Tunnel Option Vertical Alignment
- Hybrid Bill Scheme Vertical Alignment
- Additional Landtake required for this tunnel option.

Structure Legend:-

- Tunnel Portal
- Chainage (e.g. 10+000)
- Intervention Shaft
- Rugby to Birmingham Line
- Structure altered to suit new design
- Structure no longer required for tunnel option
- Transition between Hybrid Bill Scheme and Tunnel Option

Registered in England
Registration No. 06791686
Registered office:
One Canada Square,
London, E14 5AB

Creator/Organiser
Ove Arup & Partners International Ltd

Zone	West Midlands Metropolitan	Project/Contract	Birmingham Metropolitan Area Design
Design Stage	DESIGN-FOR-PETITION	Discipline/Function	Civil
Drawing Title	Berkswell Tunnel Option A1	Drawn	GLW
		Checked	MRW
		Approved	PC
		Date	17/09/2014
		Scale	AS SHOWN
		Size	A1
		Drawing No.	C224-ARP-CV-DSK-040-000010-RST00002820
		Rev.	P01

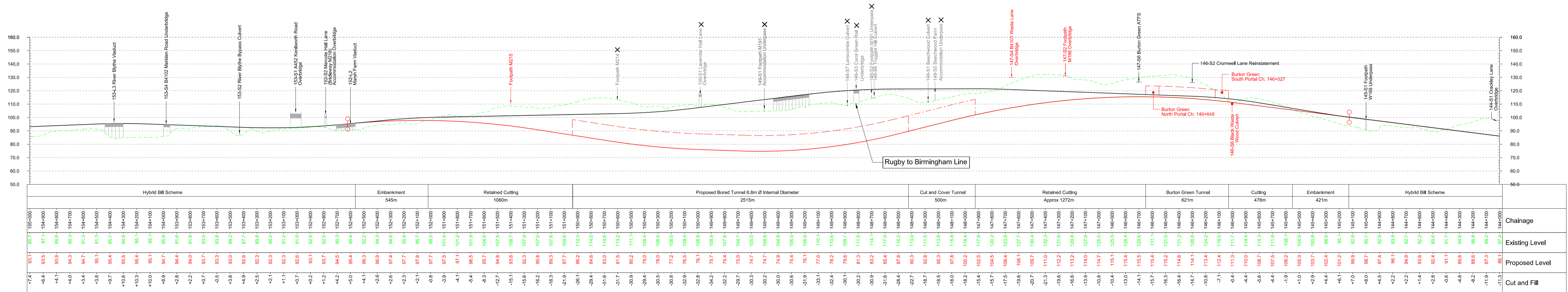
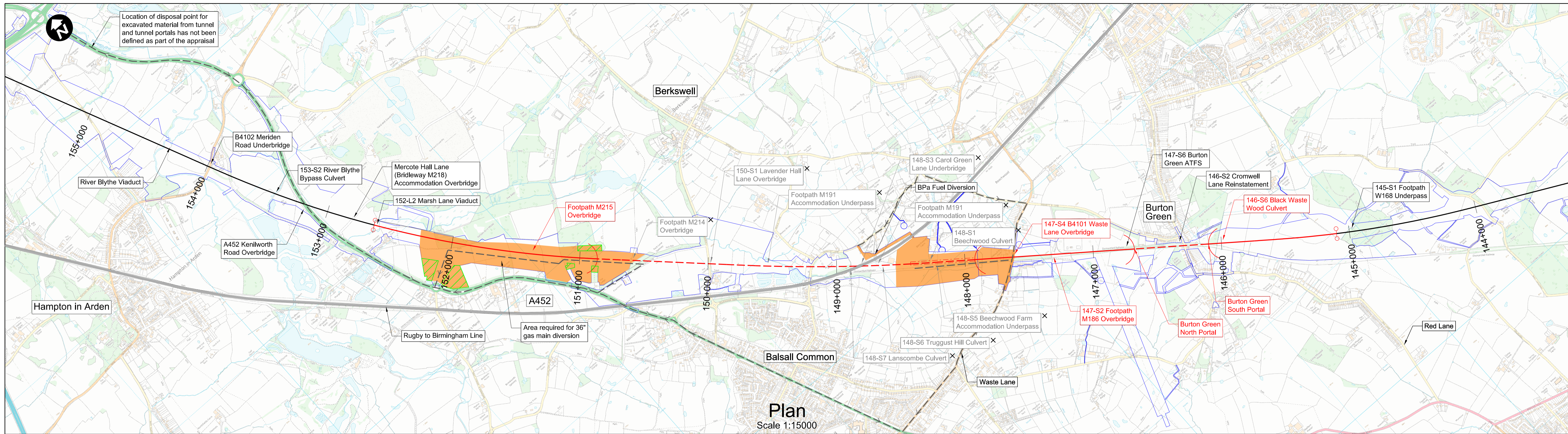

Profile Scale H 1:15000 V 1:1500

Fit for Information

P01	Draft	TCS	MRW	PC
		06/11/14	31/10/14	31/10/14

HS2 accepts no responsibility for any circumstances which arise from the reproduction of this document after alteration, amendment or abbreviation or if it is issued in part or issued incompletely in any way.

© Crown Copyright and database right 2014. All rights reserved. Ordnance Survey Licence number 100049190

© Crown Copyright material is reproduced with the permission of Land Registry under delegated authority from the Controller of HMSO.

This material was last updated on 2014 and may not be copied, distributed, sold or published without the formal permission of Land Registry. Only an official copy of a title plan or register obtained from the Land Registry may be used for legal or other official purposes.

Scale with caution as distortion can occur.

Legends/Notes:

Plan Legend:-

- Hybrid Bid Scheme Limit of Deviation
- Construction Compound required for Tunnel Works
- Tunnel Option Alignment
- Tunnel Structure
- Existing Hybrid Bill Design
- Construction Traffic Route

Profile Legend:-

- Existing Ground Level
- Tunnel Option Vertical Alignment
- Hybrid Bill Scheme Vertical Alignment
- Additional Landtake required for this tunnel option.

Structure Legend:-

- Tunnel Portal
- Chainage (e.g. 10+000)
- Intervention Shaft
- Rugby to Birmingham Line
- Structure altered to suit new design
- Structure no longer required for tunnel option
- Transition between Hybrid Bill Scheme and Tunnel Option

Registered in England
Registration No. 06791696
Registered office:
One Canada Square,
London, E14 5AB

Creator/Organiser
Ove Arup & Partners International Ltd

Zone	West Midlands Metropolitan
Design Stage	DESIGN-FOR-PETITION
Drawing Title	Berkswell Tunnel Option A2

Project/Contract			Birmingham Metropolitan Area Design		
Discipline/Function			Civil		
Drawn	Checked	Approved	GLW	MRW	PC
Date	Scale	Size	17/09/2014	AS SHOWN	A1
Drawing No.			C224-ARP-CV-DSK-040-000020-RST00002820		
Rev.			P01		

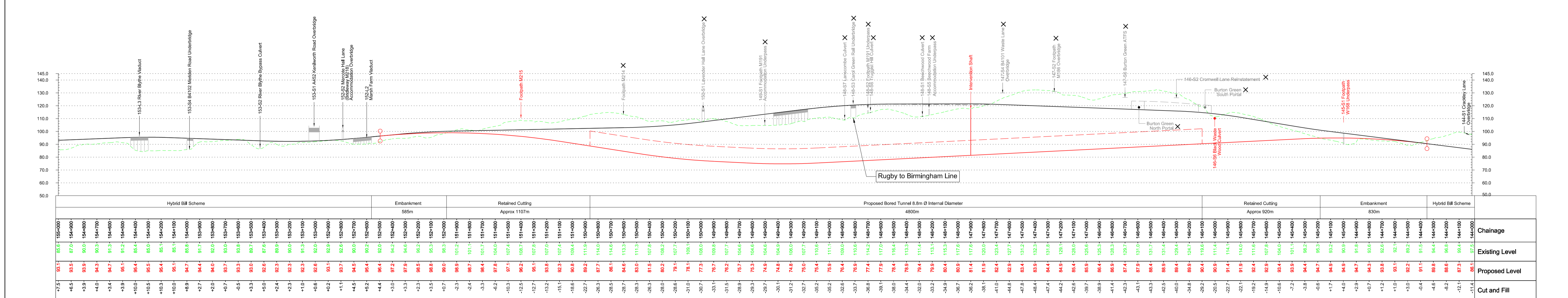
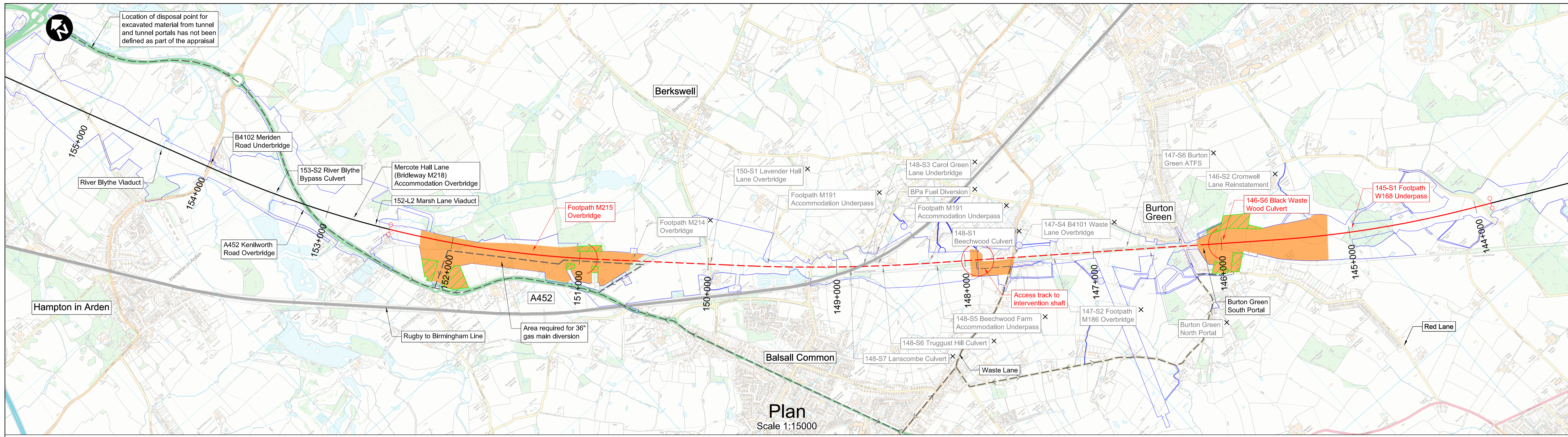

Profile Scale H 1:15000 V 1:1500

Fit for Information

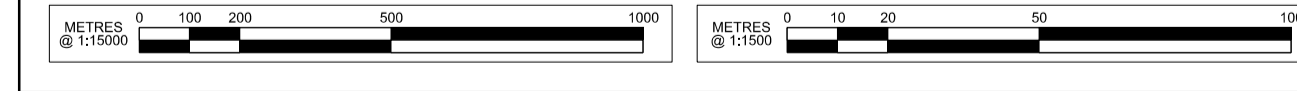

P01	Draft	TCS	MRW	PC	HS2 accepts no responsibility for any circumstances which arise from the reproduction of this document after alteration, amendment or abbreviation or if it is issued in part or issued incompletely in any way.
		06/11/14	31/10/14	31/10/14	© Crown Copyright and database right 2014. All rights reserved. Ordnance Survey Licence number 100049190
					© Crown Copyright material is reproduced with the permission of Land Registry under delegated authority from the Controller of HMSO. This material was last updated on 2014 and may not be copied, distributed, sold or published without the formal permission of Land Registry. Only an official copy of a title plan or register obtained from the Land Registry may be used for legal or other official purposes.
Rev	Description	Drawn	Checked	Con App	HS2 App
					Scale with caution as distortion can occur.

Legends/Notes:

Plan Legend:-

- Hybrid Bid Scheme Limit of Deviation
- Construction Compound required for Tunnel Works
- Tunnel Option Alignment
- Tunnel Structure
- Existing Hybrid Bill Design
- Construction Traffic Route

Profile Legend:-

- Existing Ground Level
- Tunnel Option Vertical Alignment
- Hybrid Bill Scheme Vertical Alignment
- Additional Landtake required for this tunnel option.

Structure Legend:-

- Tunnel Portal
- Chainage (e.g. 10+000)
- Intervention Shaft
- Rugby to Birmingham Line
- Structure to altered to suit new design
- Structure no longer required for tunnel option
- Transition between Hybrid Bill Scheme and Tunnel Option

Registered in England
Registration No. 06791666
Registered office:
One Canada Square,
London, E14 5AB

Creator/Organator
Ove Arup & Partners International Ltd

Zone	West Midlands Metropolitan	Project/Contract	Birmingham Metropolitan Area Design		
Design Stage	DESIGN-FOR-PETITION	Discipline/Function	Civil		
Drawing Title	Berkswell Tunnel Option B	Drawn	Checked	Approved	
		GLW	MRW	PC	
		Date	Scale	Size	
		17/09/2014	AS SHOWN	A1	
		Drawing No.	Rev.		
		C224-ARP-CV-DSK-040-000030-RST00002820	P01		

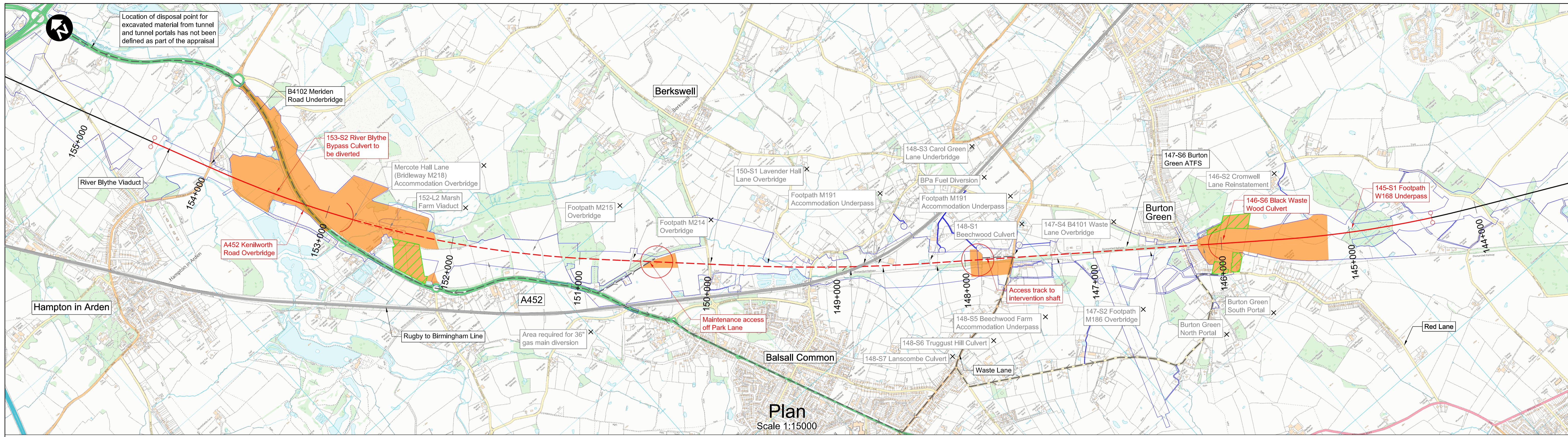

Plan
Scale 1:15000

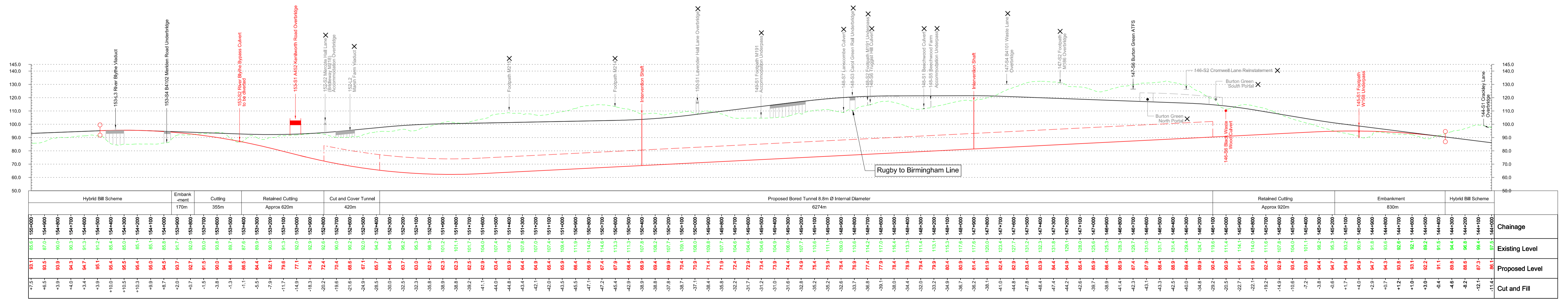

Profile
Scale H 1:15000 V 1:1500

Fit for Information

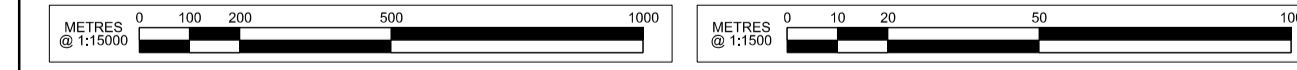

P01	Draft	TCS	MRW	PC
		06/11/14	31/10/14	31/10/14

HS2 accepts no responsibility for any circumstances which arise from the reproduction of this document after alteration, amendment or abbreviation or if it is issued in part or issued incompletely in any way.

© Crown Copyright and database right 2014. All rights reserved. Ordnance Survey Licence number 100049190

© Crown Copyright material is reproduced with the permission of Land Registry under delegated authority from the Controller of HMSO.

This material was last updated on 2014 and may not be copied, distributed, sold or published without the formal permission of Land Registry. Only an official copy of a title plan or register obtained from the Land Registry may be used for legal or other official purposes.

Scale with caution as distortion can occur.

Legends/Notes:

Plan Legend:-

- Hybrid Bid Scheme Limit of Deviation
- Construction Compound required for Tunnel Works
- Tunnel Option Alignment
- Tunnel Structure
- Existing Hybrid Bill Design
- Construction Traffic Route

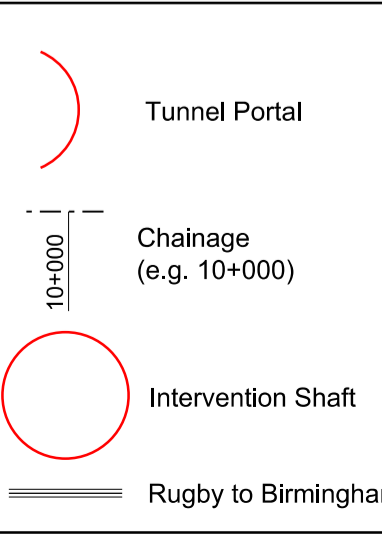

Profile Legend:-

- Existing Ground Level
- Tunnel Option Vertical Alignment
- Hybrid Bill Scheme Vertical Alignment
- Additional Landtake required for this tunnel option

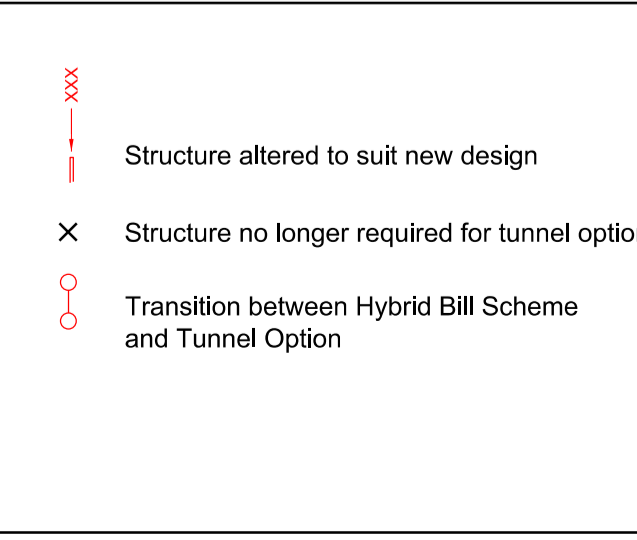

Registered in England
Registration No. 06791666
Registered office:
One Canada Square,
London, E14 5AB

Creator/Organator
Ove Arup & Partners International Ltd

Zone	West Midlands Metropolitan
Design Stage	DESIGN-FOR-PETITION
Drawing Title	Berkswell Tunnel Option C

Project/Contract			Birmingham Metropolitan Area Design		
Discipline/Function			Civil		
Drawn	Checked	Approved	GLW	MRW	PC
Date	Scale	Size	17/09/2014	AS SHOWN	A1
Drawing No.					Rev.
C224-ARP-CV-DSK-040-000040-RST00002820					P01

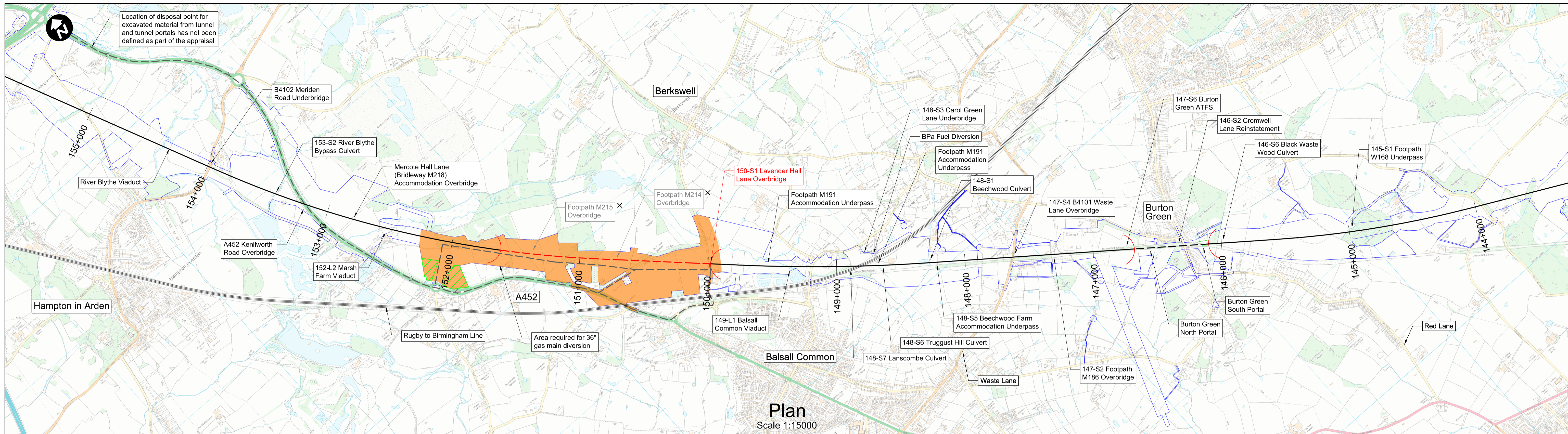

Plan
Scale 1:15000

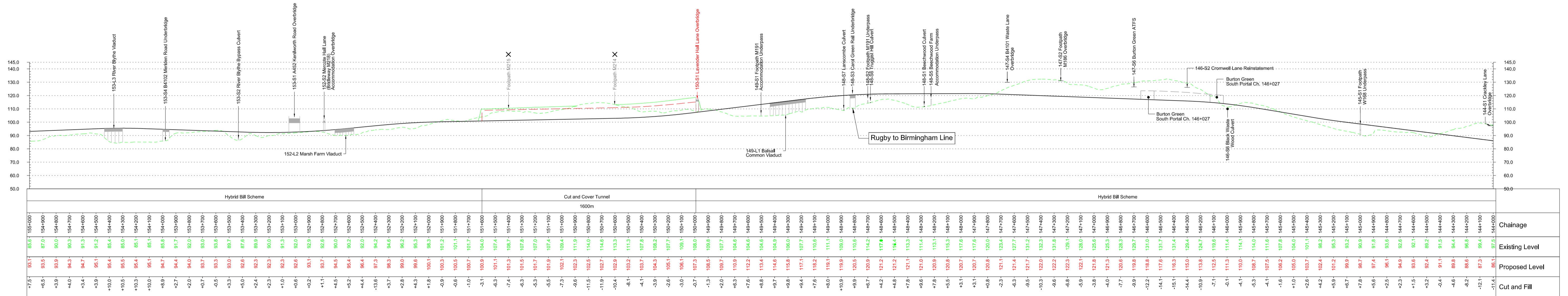

Profile
Scale H 1:15000 V 1:1500

Fit for Information

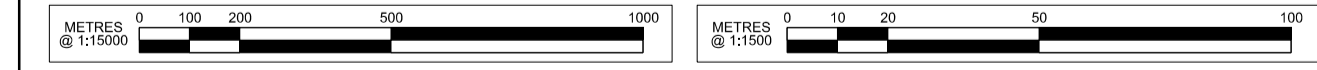

Rev	Description	Drawn	Checked	Con App	HS2 App
P01	Draft	TCS	MRW	PC	
		06/11/14	31/10/14	31/10/14	

HS2 accepts no responsibility for any circumstances which arise from the reproduction of this document after alteration, amendment or abbreviation or if it is issued in part or issued incompletely in any way.

© Crown Copyright and database right 2014. All rights reserved. Ordnance Survey Licence number 100049190

© Crown Copyright material is reproduced with the permission of Land Registry under delegated authority from the Controller of HMSO. This material was last updated on 2014 and may not be copied, distributed, sold or published without the formal permission of Land Registry. Only an official copy of a title plan or register obtained from the Land Registry may be used for legal or other official purposes.

Scale with caution as distortion can occur.

Legends/Notes:

Plan Legend:-

- Hybrid Bid Scheme Limit of Deviation
- Construction Compound required for Tunnel Works
- Tunnel Option Alignment
- Tunnel Structure
- Existing Hybrid Bill Design
- Construction Traffic Route

Profile Legend:-

- Existing Ground Level
- Tunnel Option Vertical Alignment
- Hybrid Bill Scheme Vertical Alignment
- Additional Landtake required for this tunnel option.

Structure Legend:

- Tunnel Portal
- Chainage (e.g. 10+000)
- Intervention Shaft
- Rugby to Birmingham Line
- Structure altered to suit new design
- Structure no longer required for tunnel option
- Transition between Hybrid Bill Scheme and Tunnel Option

Registered in England
Registration No. 06791686
Registered office:
One Canada Square,
London, E14 5AB

Creator/Organiser
Ove Arup & Partners International Ltd

Zone	West Midlands Metropolitan	Project/Contract	Birmingham Metropolitan Area Design		
Design Stage	DESIGN-FOR-PETITION	Discipline/Function	Civil		
Drawing Title	Berkswell Tunnel Option D1	Drawn	GLW	Checked	MRW
		Date	17/09/2014	Scale	AS SHOWN
		Approved	PC	Size	A1
		Drawing No.	C224-ARP-CV-DSK-040-000050-RST00002820		
		Rev.	P01		

