

**Plan**  
Scale 1:10,000 @ A1

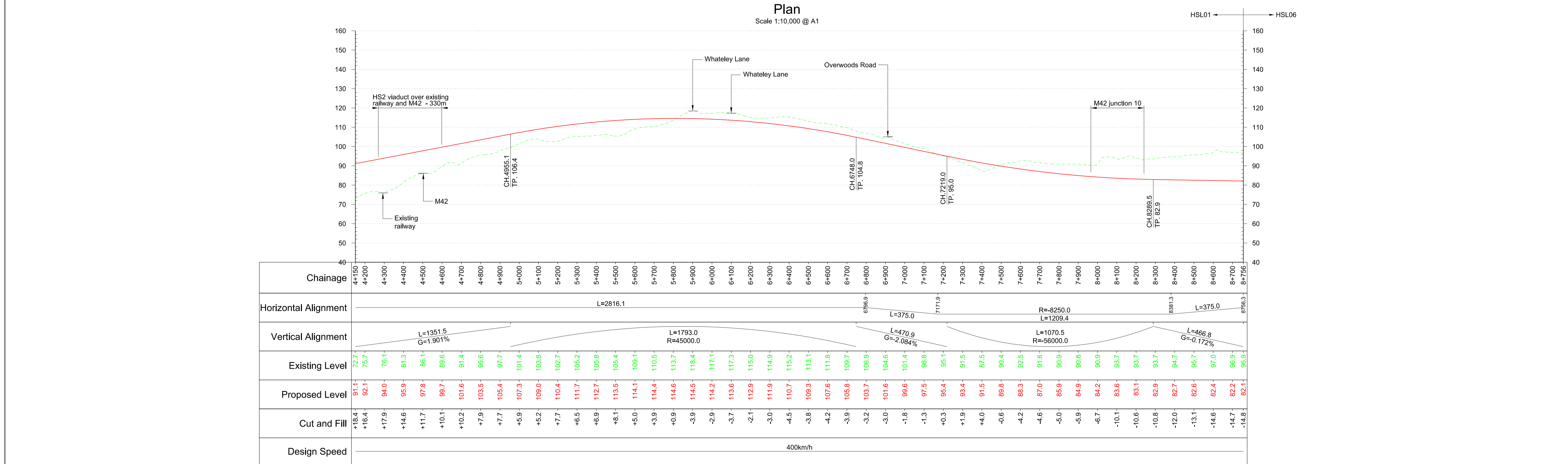

**Profile**  
Scale H:1:10,000 V:1:1000 @ A1

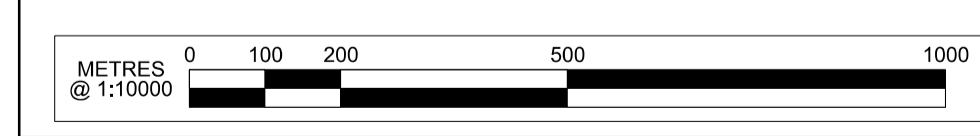

Rev	Description	Drawn	Checked	Con App	HS2 App
P05	Fit for Condition A	SHN	RC	TW	05/07/13
P04	Fit for Condition A	JA	RC	TW	18/06/13
P03	Client's Comments Addressed	GKR	RC	TW	07/06/13
P02	Client's Comments Addressed	GKR	RC	TW	21/05/13
P01	First Issue	JA	RC	TW	10/05/13

HS2 accepts no responsibility for any circumstances which arise from the reproduction of this document after alteration, amendment or abbreviation or if it is issued in part or issued incompletely in any way.

© Crown Copyright and database right 2012. All rights reserved. Ordnance Survey Licence number 100049190

© Crown Copyright material is reproduced with the permission of Land Registry under delegated authority from the Controller of HMSO. This material was last updated on 2012 and may not be copied, distributed, sold or published without the formal permission of Land Registry. Only an official copy of a title plan or register obtained from the Land Registry may be used for legal or other official purposes.

Scale with caution as distortion can occur.

Key Environmental Features Legend	
World Heritage Site	Scheduled Monuments
Ramsar	Registered Parks and Gardens
Special Areas of Conservation	Historical Battlefields
Special Protection Areas	Active and/or Authorised Landfill
SSSI	Historical Landfill
National Nature Reserves	Flood Zones
Area of Outstanding Natural Beauty	
National Park	

Legend	
Track Centrelines	Engineering Earthworks
Viaduct	Railway Cutting
Tunnel	Railway Embankment
Fully Retained Cutting/Fill	HS2 Depot/Station Operational Boundary
Major Contour	
Ground Profile	
Track Profile	
Minor Contour	
Node	

Registered in England  
Registration No. 06791686  
Registered office:  
Eland House,  
Bressenden Place,  
London, SW1E 5DU

Creator/Originator  
**Mott MacDonald**

HS2 Security Classification  
**INTERNAL**

Zone	Leeds Leg South
Design Stage	Pre-Consultation
Drawing Title	Route HSL01 Plan and Profile
	Sheet 2 of 2

Project/Contract		West Midlands to Leeds Route	
Discipline/Function	Railway Track		
Drawn	Checked	Approved	
GKR	RC	TW	
Date	Scale	Size	
03/05/2013	1:10000	A1	
Drawing No.	Rev.		
C321-MMD-RT-DPP-110-550102	P05		

# Fit for Condition A