

Plan
Scale 1:5,000 @ A1

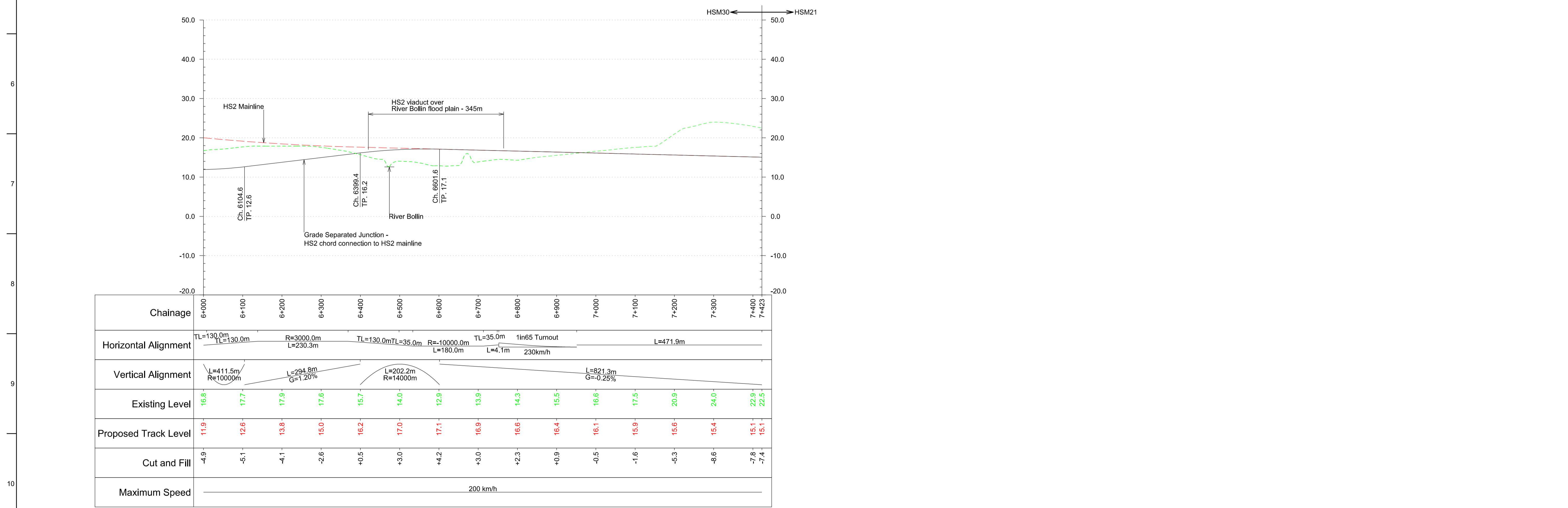

Profile
Scale H:1:5,000 V:1:500 @ A1

© Crown copyright and database rights 2012 Ordnance Survey 100049190.

Key Environmental Features Legend

- World Heritage Site
- Ramsar
- Special Areas of Conservation
- Special Protection Areas
- SSSI
- National Nature Reserves
- Area of Outstanding Natural Beauty
- National Park
- Scheduled Monuments
- Registered Parks and Gardens
- Historical Battlefields
- Active and/or Authorised Landfill
- Historical Landfill
- Flood Zone 3

Legend

- Alignment Centreline
- Viaduct / Tunnel / Fully Retained Cutting
- Major Contour
- Minor Contour
- Node
- Railway Cutting
- Railway Embankment
- Highway Cutting
- Highway Embankment

Retained structures will be used at depths of 15m or greater

Issue	Date	By	Chkd	Appd
P6	23.11.12	VS	RC	TW
P5	16.11.12	AS	RC	TW
P4	30.10.12	VS	RC	TW
P3	19.10.12	JA	RC	TW
P2	31.08.12	AS	RC	TW
P1	20.03.12	MM	RC	TW



Client
Job Title
HS2 West Midlands to Manchester
Initial Preferred Route
December 2012
Scale at A1
1:5000
Discipline
Rail



Drawing Title
Route HSM30
Plan and Profile
Sheet 3 of 3
Drawing Status
Job No
277592
Issue No
HS2-MSG-MAJ-ZZ-DR-RT-53003
Issue
P6