

# NOTICE OF ORDER

## HIGHWAYS ACT 1980 SECTION 119

Essex County Council  
Public Path Diversion Order 2017, Highways Act 1980;  
In the District of Braintree, Footpath 25 Great Bardfield

Notice is hereby given that the above referenced Order has been submitted to the Secretary of State for Environment, Food and Rural Affairs for determination. An Inspector will be appointed by the Secretary of State to determine the Order.

The **start date** for the above Order is 29 November 2017.

Consideration of the Order will take the form of exchanges of statements of case and comments on statements of case.

The effect of the Order, if confirmed without modifications, will be to divert Footpath 25 in the Parish of Great Bardfield as shown on the Order map contained in this Order.

A part length of Footpath 25 Great Bardfield starting from a point just west of the highway known as Daw Street at grid reference 56937,23093 and running in a south westerly direction for 94 metres to the ditch at grid reference 56928,23090 and then continuing in a westerly direction across the next field for a distance of 246 metres to grid reference 56905,23090 will be diverted to a new route commencing at the same above point and running in a north north easterly direction along the field boundary for a distance of 32 metres to grid reference 56936,23096 then continuing in a generally south easterly direction along the field boundary on the south side of the River Pant for a distance of 100 metres. Then continuing in a generally north westerly direction along the field boundary for a distance of 86 metres to grid reference 56923,23095 and then in a west north westerly direction, then in a southerly direction around the field boundary for a distance of 107 metres to grid reference 56915,23090 and finally in a west south westerly direction along the field boundary for a distance of 110 metres to the same above point where it continues unaffected.

Any queries relating to this Order should be referred to Jean McEntee at The Planning Inspectorate, Rights of Way Section, Room 3/G Hawk Wing, Temple Quay House, 2 The Square, Temple Quay, Bristol, BS1 6PN. Telephone: 0303 444 5437. Email: [jean.mcentee@pins.gsi.gov.uk](mailto:jean.mcentee@pins.gsi.gov.uk). Please quote reference number ROW/3182380 on all correspondence.

Any person wishing to view the statements of case and other documents relating to this Order may do so by appointment at The Definitive Map Service Department, A2 Seax House, County Hall, Market Road, Chelmsford, Essex CM1 1QH. Telephone: 01245 342886.

## **Timetable for sending in statements of case and comments**

### **Within 2 weeks of the start date [by 13 December 2017]**

The Order Making Authority must ensure their statement of case is received by the Secretary of State. As soon as possible after the deadline, the Secretary of State will send a copy (excluding copies of any supporting documents - these will be available to view at the Authority's offices) to everyone who has made an objection or representation, the applicant and any other person who has written to us in respect of the Order.

### **Within 8 weeks of the start date [by 24 January 2018]**

Everyone who has made an objection or representation or any other written representation must ensure their statement of case is received by the Secretary of State. As soon as possible after the deadline, the Secretary of State will send full copies to the Authority. Copies (excluding copies of any supporting documents - these will be available to view at the Authority's offices) will also be sent to the applicant, every person who has made an objection or representation and any other person who has written to us in respect of the Order.

Within the same period the applicant (if applicable) must ensure their statement of case is received by the Secretary of State. As soon as possible after the deadline, Secretary of State will send a full copy to the Authority. Copies will also be sent to everyone who has made an objection or representation and any other person who has written to us in respect of the Order (excluding copies of any supporting documents - these will be available to view at the Authority's offices).

### **Within 14 weeks of the start date [by 7 March 2018]**

Everyone who has made an objection or representation, the Authority, the applicant (if applicable) and anyone who has written to us in respect of the Order must ensure that their comments on any or every other statement of case is received by the Secretary of State. As soon as possible after the deadline, the Secretary of State will send copies of these comments to everyone else.

Any other person wishing to make representations in writing to the Secretary of State in respect of the above Order must do so in line with the timetable set out above.

**In fairness to the other parties everyone should keep to the timetable to ensure that statements of case and comments are received on time. Late documents will be returned.**

We cannot accept any libellous, racist or abusive comments. Any documents containing such comments will be returned.

**ESSEX COUNTY COUNCIL**

**PUBLIC PATH DIVERSION ORDER 2017**

**FOOTPATH 25 GREAT BARDFIELD**

**IN  
THE DISTRICT OF BRAINTREE**

**HIGHWAYS ACT 1980 - SECTION 119**

**PUBLIC PATH DIVERSION ORDER**

HIGH/10181 (SI)  
FP25

**PUBLIC PATH DIVERSION ORDER 2017**

**HIGHWAYS ACT 1980**

**IN THE DISTRICT OF BRAINTREE**

**FOOTPATH 25 GREAT BARDFIELD**

This Order is made by Essex County Council ("the authority") under section 119 of the Highways Act 1980 ("the 1980 Act") because it appears to the authority that in the interest of the owners of the land crossed by the footpath described in paragraph 1 of this Order that it is expedient that the line of the path should be diverted

The landowner has agreed to defray any compensation which becomes payable in consequence of the coming into force of this order and any expenses which are incurred in bringing the new site of the path into a fit condition for use by the public.

Braintree District Council has been consulted and has consented to the making of the Order as required by section 120(2) of the 1980 Act.

**BY THIS ORDER:**

1. The public right of way situated at Chiefs Farm in the parish of Great Bardfield known as Footpath 25 and shown by bold black continuous lines on the order map numbered GBAR 25F contained in this order and described in Part 1 of the Schedule to this Order shall be stopped up after 35 days from the date of confirmation of this Order.
2. There shall at the end of 28 days from the date of confirmation of this Order be a public footpath over the land situated at Chiefs Farm in the parish of Great Bardfield as described in Part 2 of the Schedule and shown by bold black broken line on the order map numbered GBAR 25F contained in this Order.

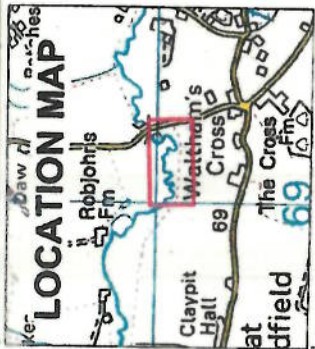

**MAP NOT TO ORIGINAL SCALE**

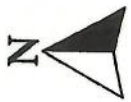

Sculpin's Bridge

DAW STREET

FINCHINGFIELD

River Pant

GREAT BARDFIELD

Drain

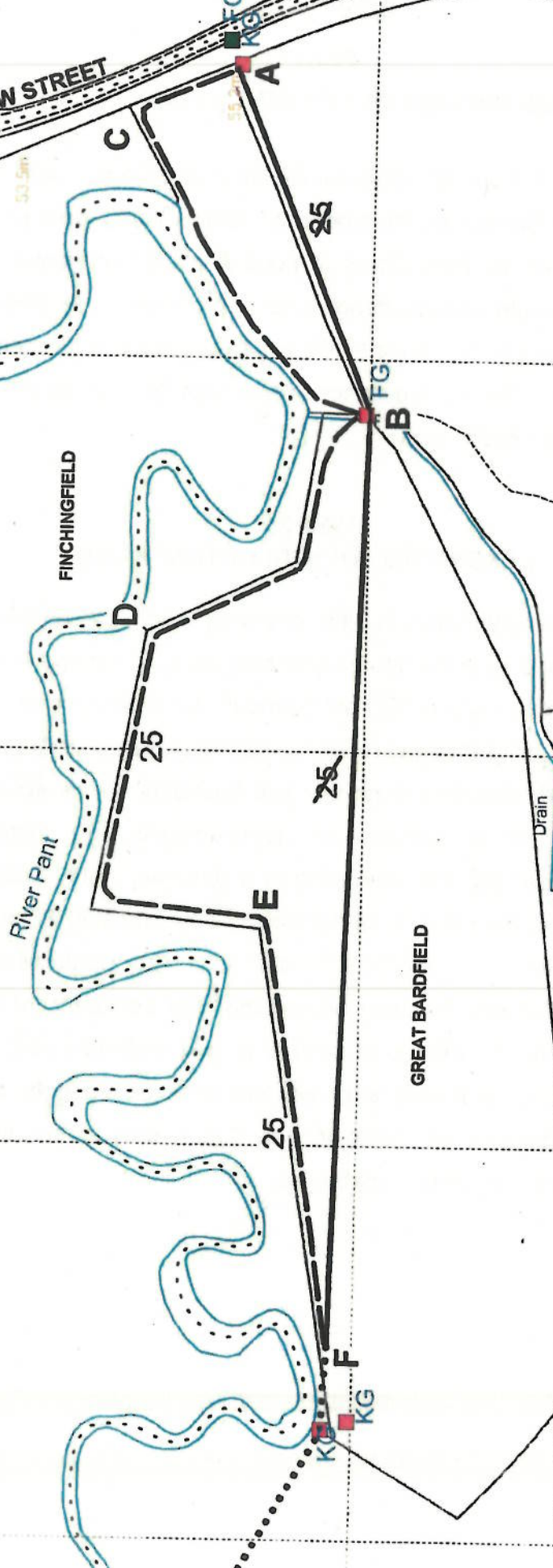

**Plan No. GBAR 25 F**  
 Division of Footpath 25 Great Bardfield  
 Route to Close A-B-F  
 New Route A-C-D-E-F  
 Unaffected  
 Definitive Map Sheet TL 63 SE  
 Scale 1:1500 at A4



County Council



© Crown copyright and

License No. 100019602

**Attesting Officer**

## **SCHEDULE**

### **PART I**

#### **DESCRIPTION OF SITE OF EXISTING PATH**

A part length of Footpath 25 Great Bardfield of unknown width as shown by a bold continuous line on the order map starting from a point just west of the highway known as Daw Street at point **A** at grid reference 56937,23093 running in a south westerly direction for approximately 94 metres to point **B** by the ditch at grid reference 56928,23090 continuing in a westerly direction across the next field for a distance of approximately 246 metres to point **F** at grid reference 56905,23090

### **PART 2**

#### **DESCRIPTION OF SITE OF NEW PATHS**

A footpath being 2 metres in width shown by a bold broken line on the order map commencing at the aforementioned point **A** running in a north north westerly direction along the field boundary for a distance of approximately 32 metres to point **C** at grid reference 56936,23096 continuing in a generally south easterly direction along the field boundary on the south side of the River pant for a distance of approximately 100 metres to the aforementioned point **B** continuing in a generally north westerly direction along the field boundary for a distance of approximately 86 metres to point **D** at grid reference 56923,23095 then in a west north westerly direction then in a southerly direction around the field boundary for a distance of approximately 107 metres to point **E** at grid reference 56915,23090 and then continuing in a west south westerly direction along the field boundary for a final distance of approximately 110 metres to the aforementioned point **F** where it continues unaffected.

Given under the Common Seal of **ESSEX COUNTY COUNCIL** this *Twelfth*  
day of *May* 2017

The Common Seal of **ESSEX COUNTY** )  
**COUNCIL** was hereunto affixed in the )  
presence of:- )



36787

Attesting Officer *H. [Signature]*

Dated: 12<sup>th</sup> day of May 2017

**PUBLIC PATH DIVERSION ORDER**

**HIGHWAYS ACT 1980  
SECTION 119**

Public Footpath 25  
In the Parish of Great Bardfield  
In the District of Braintree

**PAUL TURNER**  
Director of Legal & Assurance

Essex Legal Services  
Seax House  
County Hall  
Chelmsford  
Essex  
CM1 1QH

HIGH/10181 (SI)  
FP25