

Plan
Scale 1:5,000 @ A1

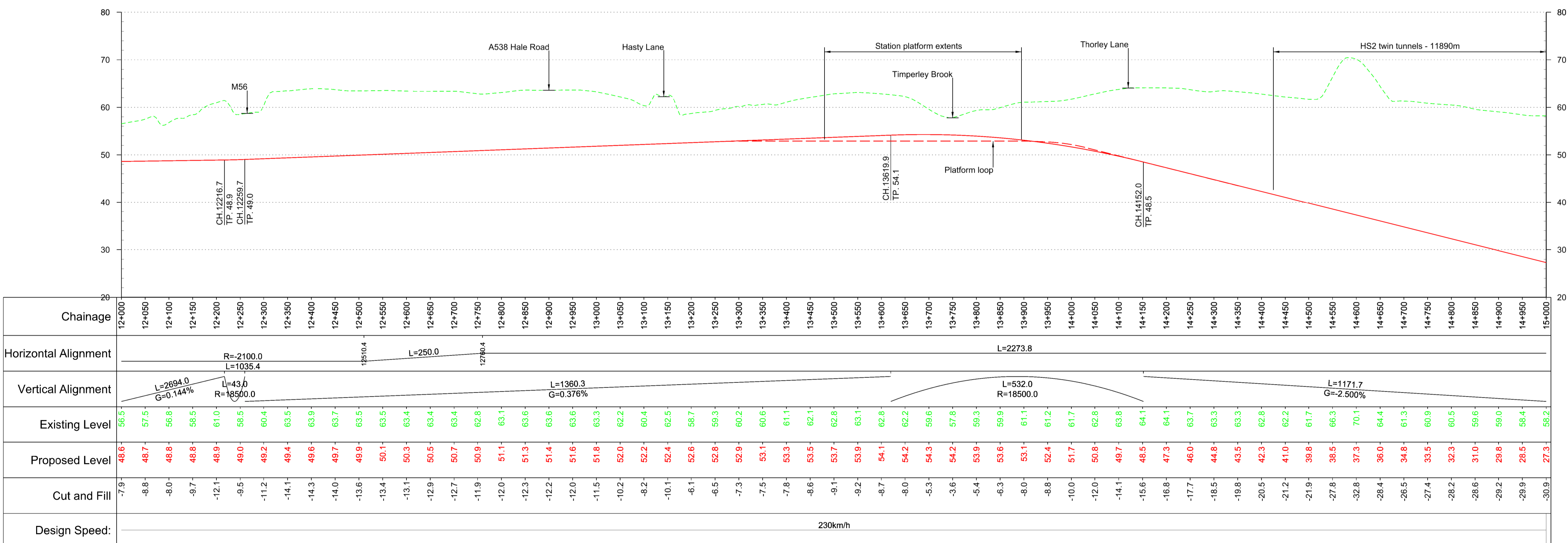

Profile
Scale H:1:5,000 V:1:500 @ A1

Fit for Condition A

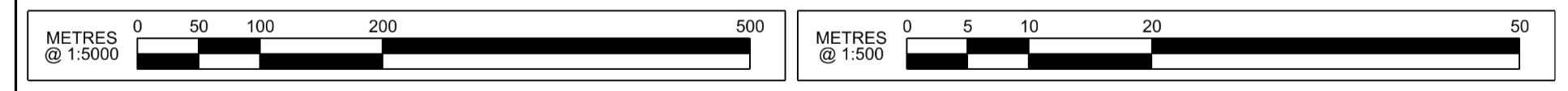

| Rev | Description | Drawn | Checked | Con App | HS2 App |
|-----|------------------------|-------|---------|---------|---------|
| P07 | Issued for Condition A | MB | DC | JG | |
| P06 | Issued for Condition A | DC | DC | JG | |
| P05 | Issued for Condition A | KB | DC | JG | |
| P04 | For Review | KB | DC | JG | |
| P03 | For Review | KB | DC | JG | |

HS2 accepts no responsibility for any circumstances which arise from the reproduction of this document after alteration, amendment or abbreviation or if it is issued in part or issued incompletely in any way.

© Crown Copyright and database right 2012. All rights reserved. Ordnance Survey Licence number 100049190

© Crown Copyright material is reproduced with the permission of Land Registry under delegated authority from the Controller of HMSO. This material was last updated on 2012 and may not be copied, distributed, sold or published without the formal permission of Land Registry. Only an official copy of a title plan or register obtained from the Land Registry may be used for legal or other official purposes.

Scale with caution as distortion can occur.

| Key Environmental Features Legend | |
|------------------------------------|-----------------------------------|
| World Heritage Site | Scheduled Monuments |
| Ramsar | Registered Parks and Gardens |
| Special Areas of Conservation | Historical Battlefields |
| Special Protection Areas | Active and/or Authorised Landfill |
| SSSI | Historical Landfill |
| National Nature Reserves | Flood Zones |
| Area of Outstanding Natural Beauty | |
| National Park | |

| Legend | |
|--|--|
| Track Centrelines | Engineering Earthworks |
| Viaduct | Railway Cutting |
| Tunnel | Railway Embankment |
| Fully Retained Cutting/Fill | |
| Major Contour | |
| Ground Profile | |
| Track Profile | |
| Minor Contour | |
| Node | |
| Retained structures will be used at depths of 15m or greater | HS2 Depot/Station Operational Boundary |

Registered in England
Registration No. 06791686
Registered office:
Eland House,
Bressenden Place,
London, SW1E 5DU

Creator/Organator
AECOM

HS2 Security Classification
INTERNAL

| Zone | Manchester Metropolitan Spur |
|---------------|---------------------------------|
| Design Stage | Pre-Consultation |
| Drawing Title | Route HSM28 Plan and Profile |
| | Sheet 5 of 9 |

| Project/Contract | | |
|-----------------------------------|----------|----------|
| West Midlands to Manchester Route | | |
| Discipline/Function | | |
| Railway Track | | |
| Drawn | Checked | Approved |
| MB | DC | JG |
| Date | Scale | Size |
| 26/04/2013 | AS SHOWN | A1 |
| Drawing No. | | Rev. |
| C320-AEC-RT-DPP-240-052805 | | P07 |