

**Plan**  
Scale 1:10,000 @ A1

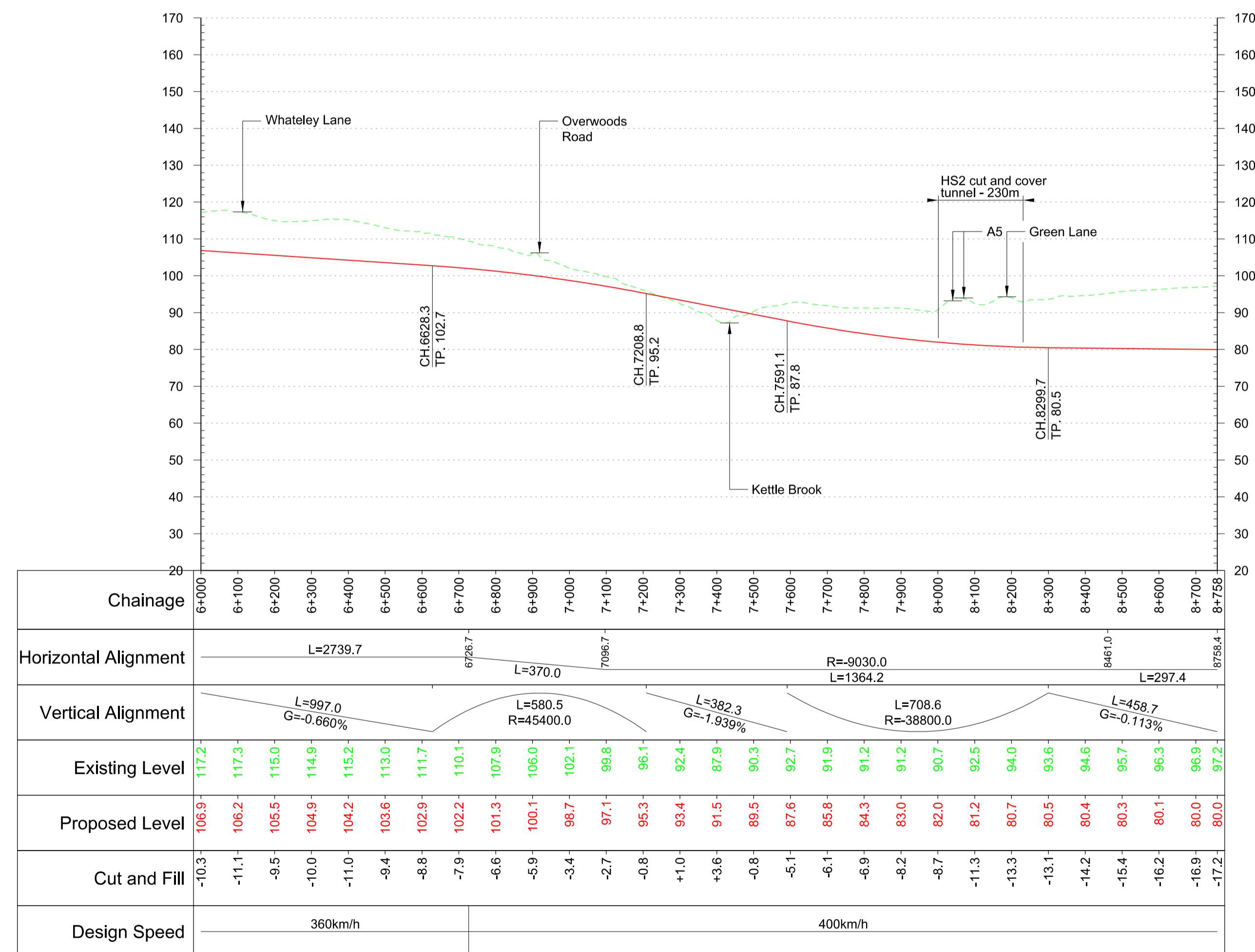

**Profile**  
Scale H:1:10,000 V:1:1000 @ A1

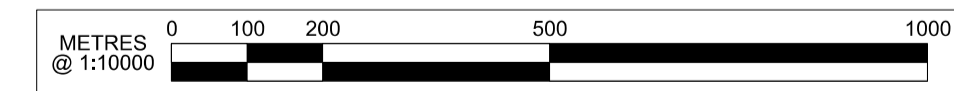

P02	Client's Comments Addressed	JV	AR	MM	11/07/17	11/07/17	11/07/17	HS2 accepts no responsibility for any circumstances which arise from the reproduction of this document after alteration, amendment or abbreviation or if it is issued in part or issued incompletely in any way.  © Crown Copyright and database right 2017. All rights reserved. Ordnance Survey Licence number 100049190  © Crown Copyright material is reproduced with the permission of Land Registry under delegated authority from the Controller of HMSO.  This material was last updated on 2017 and may not be copied, distributed, sold or published without the formal permission of Land Registry. Only an official copy of a title plan or register obtained from the Land Registry may be used for legal or other official purposes.	<b>Key Environmental Features Legend</b> <ul style="list-style-type: none"> <li>World Heritage Site</li> <li>Ramsar</li> <li>Special Areas of Conservation</li> <li>Special Protection Areas</li> <li>SSSI</li> <li>National Nature Reserves</li> <li>Area of Outstanding Natural Beauty</li> <li>National Park</li> <li>Major Development Sites</li> <li>Additional Development Sites</li> <li>Scheduled Monuments</li> <li>Registered Parks and Gardens</li> <li>Historical Battlefields</li> <li>Active and/or Authorised Landfill</li> <li>Historical Landfill</li> <li>Flood Zones</li> <li>Listed Building Grade I</li> <li>Listed Building Grade II*</li> <li>Listed Building Grade II</li> </ul>	<b>Legend</b> <ul style="list-style-type: none"> <li>Track Centrelines</li> <li>Viaduct</li> <li>Tunnel</li> <li>Existing Railway Connection</li> <li>HS2 Connection</li> <li>Fully Retained Cutting/Fill</li> <li>Major Contour</li> <li>Ground Profile</li> <li>Track Profile</li> <li>Minor Contour</li> <li>Node</li> <li>Engineering Earthworks</li> <li>Railway Cutting</li> <li>Railway Embankment</li> <li>HS2 Depot/Station Operational Boundary</li> </ul>	<p>Registered in England Registration No. 06791686 Registered office: 2 Snow Hill, Queensway, Birmingham, B4 6GA</p> <p>Creator/Organator <b>Mott MacDonald</b></p>	Zone	Leeds Leg South	Project/Contract	West Midlands to Leeds Route										
P01	First Issue	JV	AR	MM	28/06/17	28/06/17	28/06/17					Design Stage	Post-Consultation	Discipline/Function	Railway Track										
Rev	Description	Drawn	Checked	Con App	HS2 App	Scale with caution as distortion can occur.		Drawing Title	HSL01 2017 Preferred Route	Drawn	JV	Checked	AR	Approved	MM	Date	06/06/2017	Scale	1:10000	Size	A1	Drawing No.	C321-MMD-RT-DPP-110-590102	Rev.	P02