

**DEFINITIVE MAP MODIFICATION ORDER
WILDLIFE AND COUNTRYSIDE ACT 1981**

North East Lincolnshire Council

**The Humberside County Council
Borough of Cleethorpes
Definitive Map of Public Rights of Way**

**The North East Lincolnshire Council
Public Footpath, Cleethorpes No 5 Definitive Map Modification Order 2015**

**DEFINITIVE MAP MODIFICATION ORDER
WILDLIFE AND COUNTRYSIDE ACT 1981**

North East Lincolnshire Council

**The Humberside County Council
Borough of Cleethorpes Definitive Map of Public Rights of Way**

**The North East Lincolnshire Council
Public Footpath, Cleethorpes No 5 Definitive Map Modification Order 2015**

This Order is made by North East Lincolnshire Council under section 53(2)(b) of the Wildlife and Countryside Act 1981 ("the Act") because it appears to that authority that The Humberside County Council Borough of Cleethorpes Definitive Map of Public Rights of Way requires modification in consequence of the occurrence of events specified in section 53(3)(c)(i), namely that a right of way which is not shown in the map and statement subsists or is reasonably alleged to subsist over land in the area to which the map relates, being a right of way such that the land over which the right subsists is a public path; and, section 53(3)(b) namely, the expiration, in relation to any way in the area to which the map relates, of any period such that the enjoyment by the public of the way during that period raises a presumption that the way has been dedicated as a public path.

The authority has consulted with every local authority whose area includes the land to which the order relates. The North East Lincolnshire Council hereby orders that:

1. For the purposes of this order the relevant date is 6th November 2015.
2. The Humberside County Council Borough of Cleethorpes Definitive Map of Public Rights of Way shall be modified as described in Part I and Part II of the Schedule and shown on the map attached to the Order.
3. This order shall take effect on the date it is confirmed and may be cited as the The North East Lincolnshire Council Public Footpath, Cleethorpes No 5 Definitive Map Modification Order 2015

SCHEDULE

PART I

Modification of Definitive Map

Description of path or way to be added (A - E)

Public Footpath commencing on Suggitts Lane at Grid Reference 529980 409740 (Point A on the Plan), crossing the railway over to Grid Reference 529994 409753 (Point B on the Plan) for a distance of approximately 16 metres, where it then turns west and follows a generally westerly direction between the toe of the flood embankment and scrubland immediately adjoining the boundary fencing of the railway for a distance of approximately 491 metres to Grid Reference 529594 410034 (Point C on the Plan), where it then crosses over an earth bund and continues in a north westerly direction for a distance of approximately 57 metres to Grid Reference 529559 410078 (Point D on the Plan). The Public Footpath then passes through a fenceline and continues in a generally north westerly direction for approximately a further 748 metres to terminate at a point to the north of Salvesen Road at Grid Reference 529072 410633 (Point E on the Plan), being a total path length of approximately 1312 metres.

PART II

Modification of Definitive Statement

Particulars to be added

Public Footpath commencing on Suggitts Lane at Grid Reference 529980 409740, crossing the railway over to Grid Reference 529994 409753 for a distance of approximately 16 metres, where it then turns west and follows a generally westerly direction between the toe of the flood embankment and scrubland immediately adjoining the boundary fencing of the railway for a distance of approximately 491 metres to Grid Reference 529594 410034, where it then crosses over an earth bund and continues in a north westerly direction for a distance of approximately 57 metres to Grid Reference 529559 410078. The Public Footpath then passes through a fenceline and continues in a generally north westerly direction for approximately a further 748 metres to terminate at a point to the north of Salvesen Road at Grid Reference 529072 410633, being a total path length of approximately 1312 metres.

Width: Surfaced crossing area of 3.6 metres between Points A and B

Varying between 2 metres and 6 metres between Points B and C

2 metres between Points C and E on the Plan

Limitations: Pedestrian gate at Grid Reference 529980 409740 and 529994 409753.

THE COMMON SEAL of the)
North East Lincolnshire Council was)
hereunto affixed this ^{6th}..... day)
of November 2015)
in the presence of)

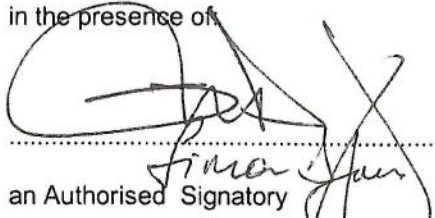

.....
an Authorised Signatory

No. in Seal Register: 6489.....

Cleethorpes No 5 Definitive map Modification Order 2015

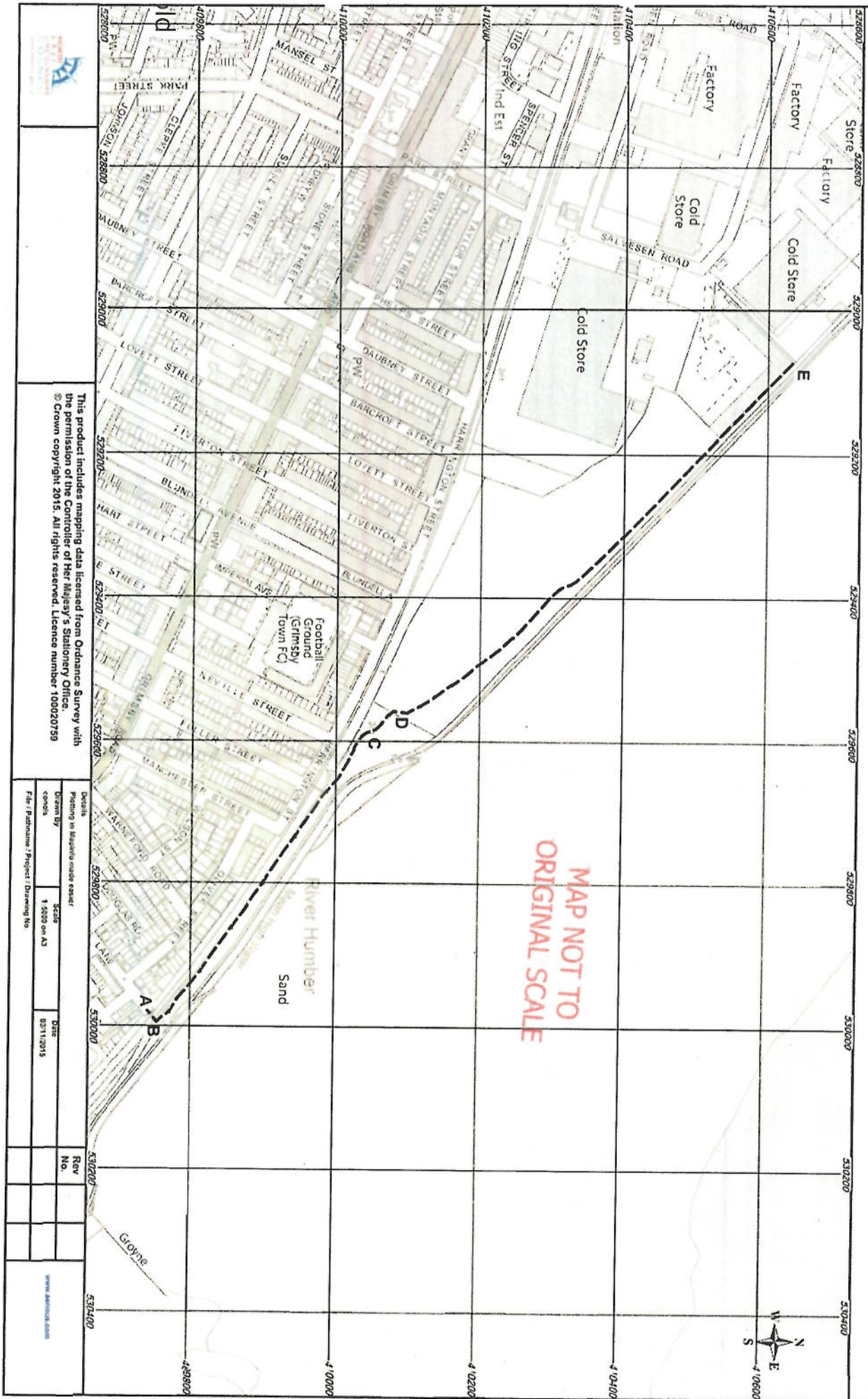

MAP NOT TO ORIGINAL SCALE

This product includes mapping data licensed from Ordnance Survey with the permission of the Controller of Her Majesty's Stationary Office. © Crown copyright 2015. All rights reserved. Licence number 100020759

Details		Rev	
Plotting in separate mode easier	Scale	No.	
Drawn By	1:5000 on A3		
Checked			
Date	02/11/2015		
File / Pathname / Project / Drawing No			



Cleethorpes No 5 Definitive map Modification Order 2015

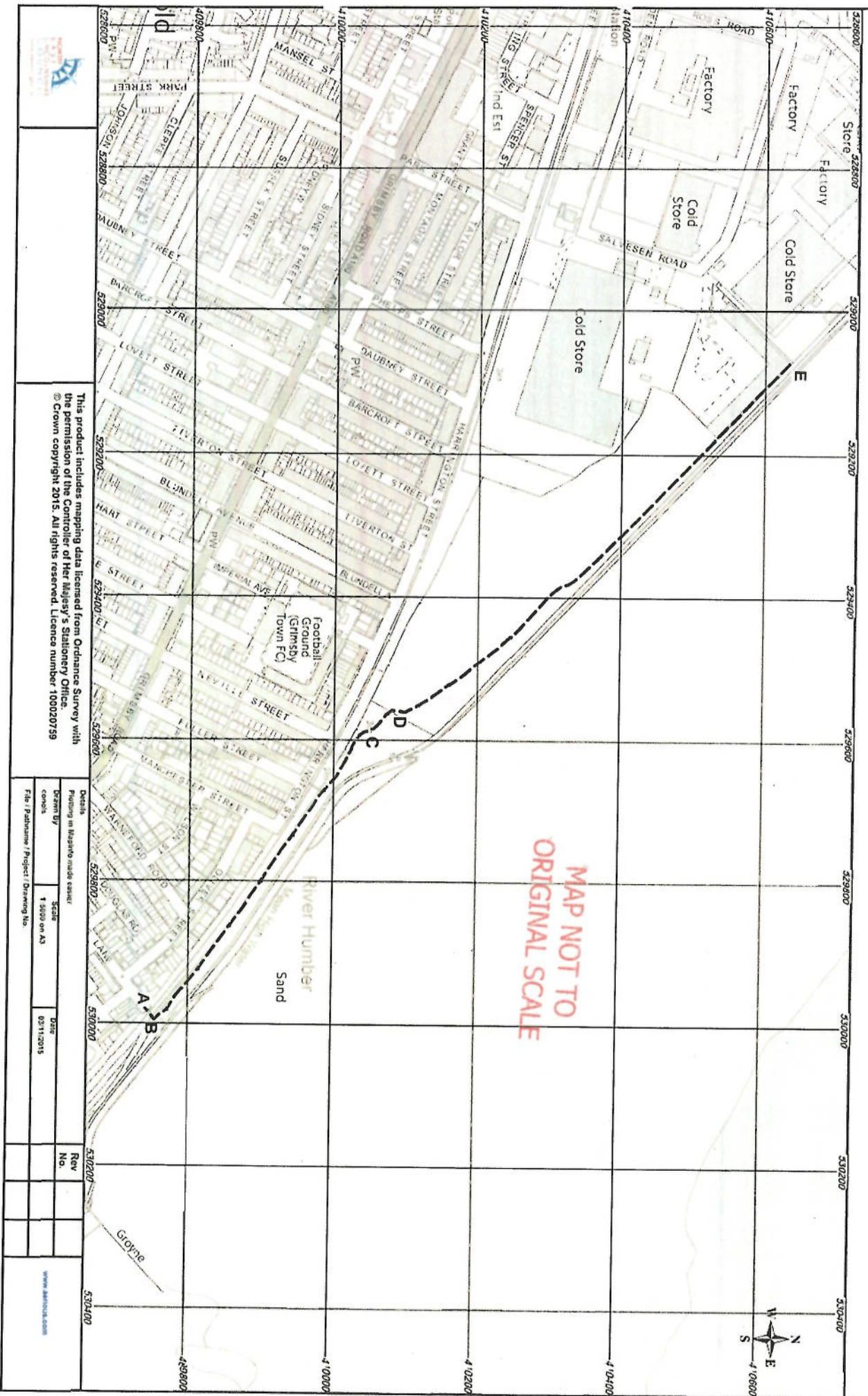

This product includes mapping data licensed from Ordnance Survey with the permission of the Controller of Her Majesty's Stationery Office. © Crown copyright 2015. All rights reserved. Licence number 100020759

Details		Rev	
Producing in MapInfo inside esri	Scale	No.	
Drawn By	1:5000 on A3	Date	
09/11/2015			
File / Pathname / Project / Drawing No.			

www.esri.com