

Plan
Scale 1:2500

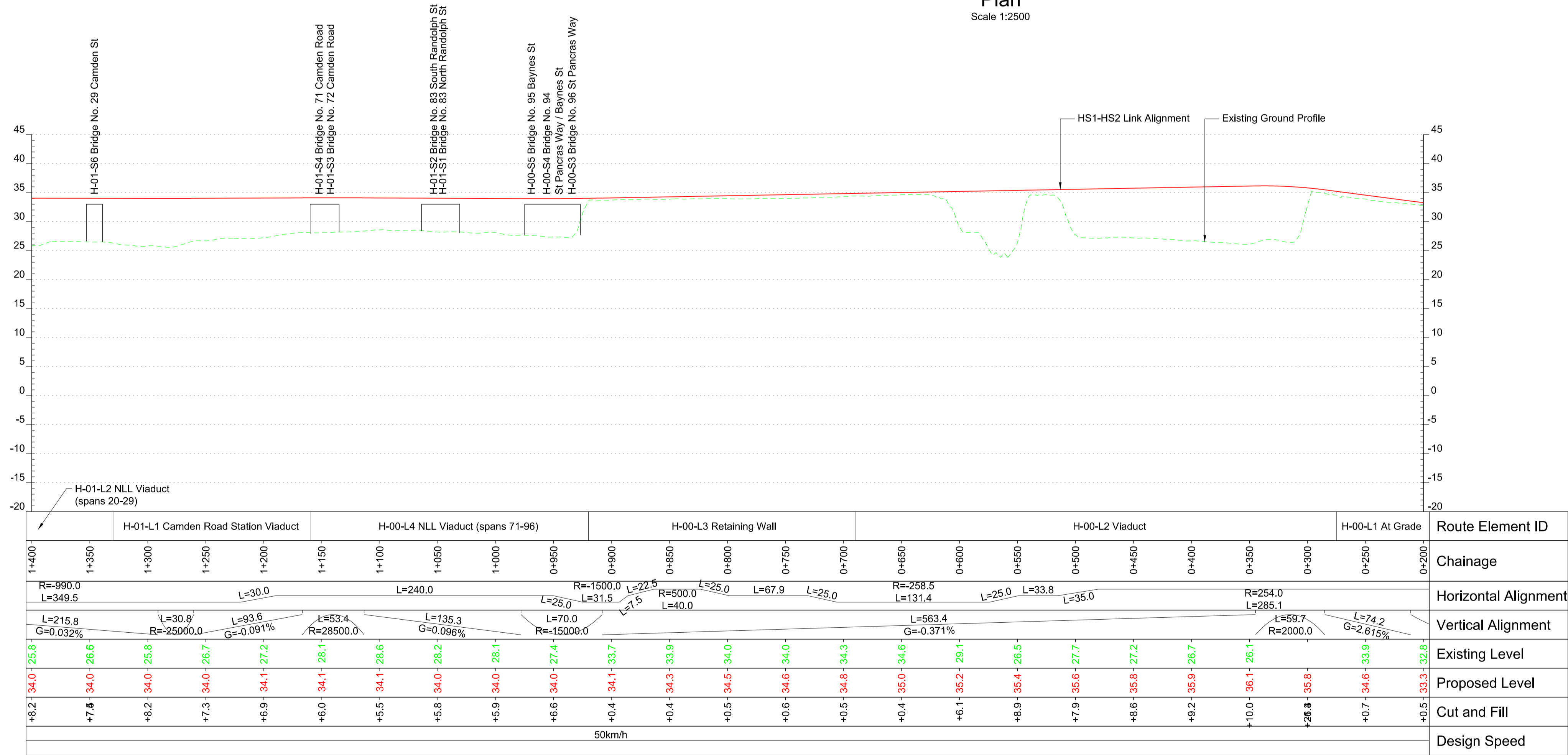

Profile
Scale H 1:2500 V 1:500

© Mott MacDonald
This document is issued for the party which commissioned it and for specific purposes connected with the captioned project only. It should not be relied upon by any other party or used for any other purpose. We accept no responsibility for the consequences of this document being relied upon by any other party or being used for any other purpose, or containing any error or omission which is due to an error or omission in data supplied to us by other parties.

P07	Condition B. Code 1 Fit for hybrid bill submission	MC	MP	05/12/13	05/12/13
P06	Condition B. Code 1 Fit for hybrid bill submission	IM	MH	21/10/13	21/10/13
P05	Interim Preliminary Design Condition B	MF	VH	28/08/13	23/08/13
P04	Initial Preliminary Design Condition A	PS	MS	18/04/13	19/04/13
P03	Initial Preliminary Design Condition B3	RL	MC	27/03/13	28/03/13
Rev	Description	Drawn	Checked	Con App	HS2 App

HS2 accepts no responsibility for any circumstances which arise from the reproduction of this document after alteration, amendment or abbreviation or if it is issued in part or issued incompletely in any way.

© Crown Copyright and database right 2013. All rights reserved.
Ordnance Survey Licence number 100049190

© Crown Copyright material is reproduced with the permission of Land Registry under delegated authority from the Controller of HMSO.
This material was last updated on 2013 and may not be copied, distributed, sold or published without the formal permission of Land Registry. Only an official copy of a title plan or register obtained from the Land Registry may be used for legal or other official purposes.

Scale with caution as distortion can occur.

Legends/Notes:

- Depot, station, headhouse or portal building
- Tunnel portal
- Electricity substation
- Land drainage area
- Ecological mitigation pond
- Balancing pond
- Replacement floodplain storage or portal building
- Woodland habitat creation
- Wetland habitat creation
- Grassland habitat creation (scrub / woodland)
- Landscape mitigation planting
- Grassed areas
- Sustainable placement
- Public realm
- Engineering earthworks
- Landscape earthworks
- Rail alignment formation
- Returned to suitable development use
- County boundary
- Borough / District boundary
- Community forum boundary
- Watercourse diversion
- Existing watercourse
- Ditches - new
- Hedgerow habitat creation
- Main utility works
- Existing public right of way (PRoW)
- New, diverted or realigned PRoW
- Stopped-up PRoW
- Tunnels external extent
- Rail alignment
- HS2 Access road
- Noise fence barrier
- Chainage (e.g. 10+000)

hs2

Registered in England
Registration No. 06791686
Registered office:
Eland House,
Bressenden Place,
London, SW1E 5DU

Creator/Organator
Mott MacDonald

HS2 Security Classification
INTERNAL

Zone	London Metropolitan	Project/Contract	London Metropolitan Area Design		
Design Stage	hybrid bill submission	Discipline/Function	Civil		
Drawing Title	HS1 - HS2 Link Sheet 2 of 4 Chainage 0+200 to 1+400	Drawn	MC	Checked	Approved
		Date	21/10/2013	Scale	AS SHOWN
		Size	A1	Rev.	P07
		Drawing No.	C221-MMD-CV-DPP-010-228700		