



Order Decision

Site visit made on 19 April 2018

by Heidi Cruickshank BSc (Hons), MSc, MIPROW

an Inspector appointed by the Secretary of State for Environment, Food and Rural Affairs

Decision date: 03 August 2018

Order Ref: ROW/3180704M1

- This Order is made under Section 53(2)(b) of the Wildlife and Countryside Act 1981 and is known as The Norfolk County Council (Dereham) Modification Order, 2017.
- The Order is dated 3 May 2017 and proposes to record six routes to the east of Dereham as restricted byways. Full details of the routes are given in the Order map and described in the Order Schedule.
- In accordance with paragraph 8(2) of Schedule 15 to the Wildlife and Countryside Act 1981 I have given notice of my proposal to confirm the Order subject to modifications.
- No objections or representations were received in response to the notice.

Summary of Decision: The Order is confirmed subject to modifications set out in the Formal Decision.

Preliminary matters

1. As set out in my interim Order decision ("the IOD"), issued on 11 May 2018, the effect of the Order if confirmed with the modifications proposed, would be to record six restricted byways over land to the east of Dereham; correct a typographical error in relation to the grid references; record the lack of limitations on the routes; record the appropriate width; and, correct a minor typographical error on one of the Order maps. The proposed modifications are set out in paragraph 51 of the IOD.
2. No objections or representations were submitted in response to the advertisement of the proposed modifications.

Conclusion

3. Having regard to all matters previously raised in the written representations, I conclude that the Order should be confirmed, subject to the modifications proposed by the IOD.

Formal Decision

4. In exercise of the powers transferred to me, the Order is confirmed subject to the modifications previously proposed:
 - Throughout the Order Schedules:
 - with the exception of the grid references TF 9985 1253 and TF9981 1260, replace text "...TF..." with "...TG...";
 - Within Part I of the Schedule:
 - in relation to route B, replace text "...1.9..." with "...3.6...";
 - in relation to route D, replace text "...2.6..." with "...3.6...";

- Within Part II of the Schedule:
 - in relation to route B, replace text "...1.9..." with "...3.6...";
 - in relation to route D, replace text "...2.6..." with "...3.6...";
 - add text "*Limitations and Conditions: None*";
- On the Order plan:
 - annexed Map 1, in relation to route B, replace text "...2.5..." with "...3.6...";
 - annexed Map 2, in relation to route B, replace text "...1.9...2...2.1...2.2...2.5..." with "...3.6...";
 - annexed Map 2, in relation to route D, replace text "...2.6..." with "...3.6...";
 - annexed Map 2, in relation to route C, replace text "...C1..." with "...C6...";
 - annexed Map 3, in relation to route B, replace text "...2...2.2...2.5...2.6..." with "...3.6...".

Heidi Cruickshank

Inspector

ANNEXED MAP 1
 NORFOLK COUNTY COUNCIL (DEREHAM) MODIFICATION ORDER 2017

Restricted Byway — V — V — V — V — V — V — V — V

Width (m) metres

Scale 1:2,000

Norfolk County Council
 County Hall
 Martineau Lane
 Norwich
 NR1 2SG

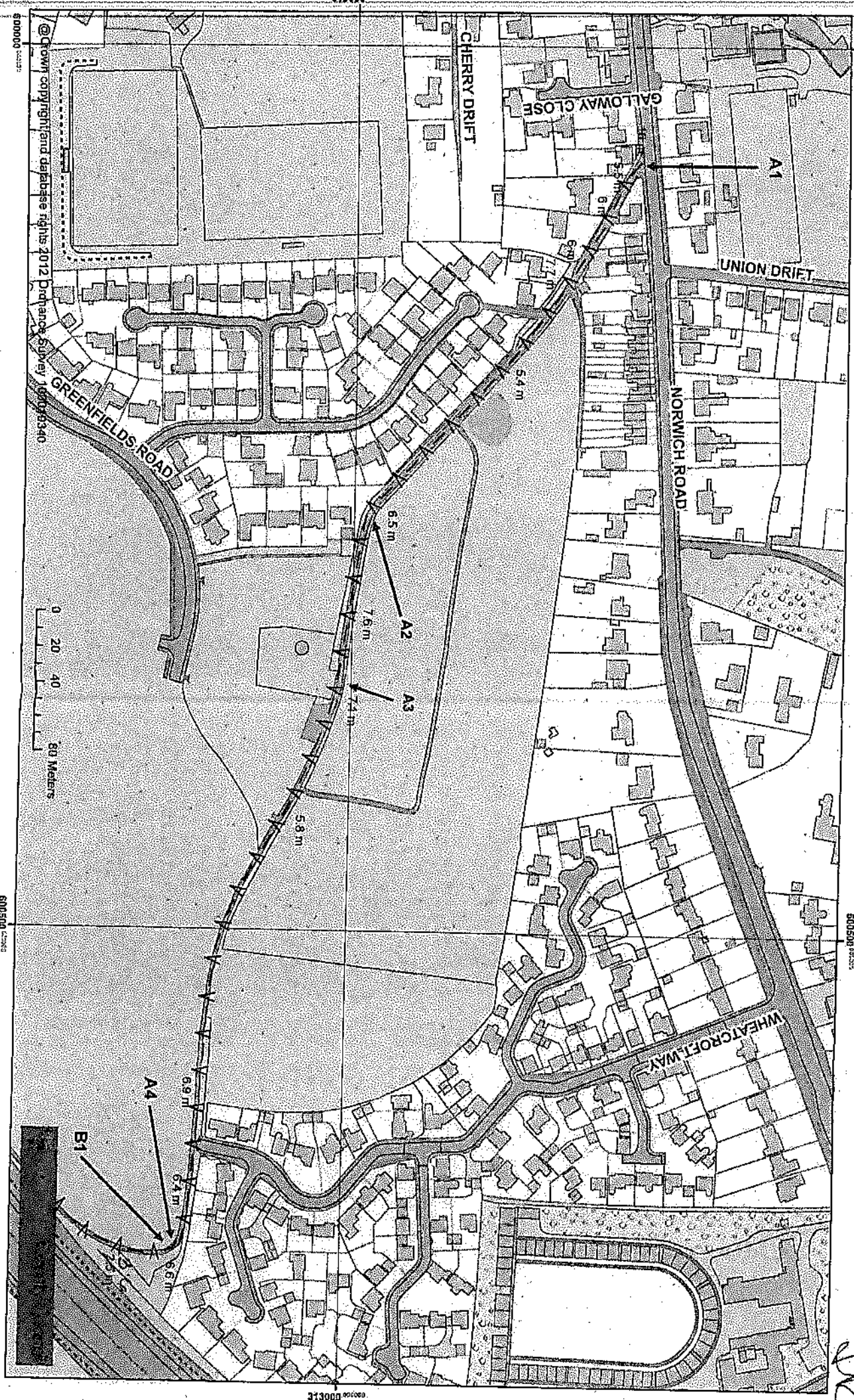
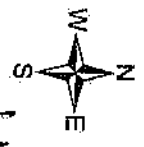

© Crown copyright and database rights 2012 Ordnance Survey 100019340
 313000
 600500

Restricted Byway — V — V — V — V — V — V — V
 Width (m) metres

Scale 1:2,500

Norfolk County Council
 County Hall
 Martineau Lane
 Norwich
 NR1 2SG

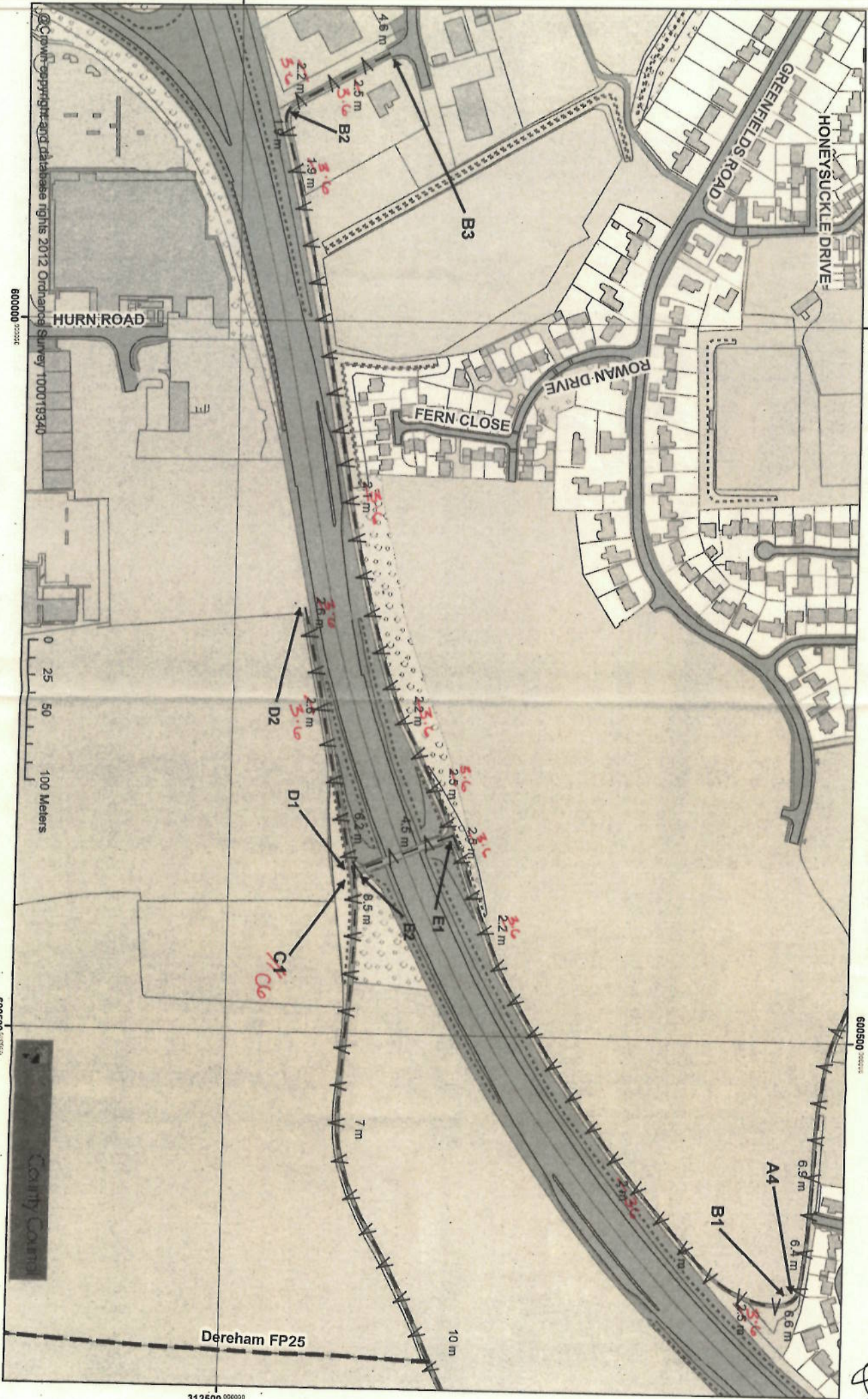
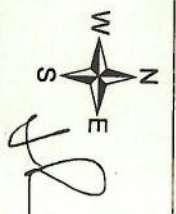

Restricted Byway — V — V — V — V — V — V — V — V

Width (m) metres

Scale 1:4,025

Norfolk County Council
County Hall
Mattieau Lane
Norwich
NR1 2SG

