

# NOTICE OF ORDER

## Town and Country Planning Act 1990 Section 257

Breckland District Council  
(Bridleway 15) Public Path Diversion 2016  
(Bridleway 16) Public Path Diversion 2016

Notice is hereby given that the above referenced Orders has been submitted to the Secretary of State for Environment, Food and Rural Affairs for determination. An Inspector will be appointed by the Secretary of State to determine the Orders.

The **start date** for the above Orders is 4 August 2017.

Consideration of the Orders will take the form of exchanges of statements of case and comments on statements of case.

The effect of the Order, if confirmed without modifications, will be to divert the entire width of a length of Shipdham Bridleway 15 running from point BR15A (grid reference E:595273, N:307001) in an North Easterly direction for approximately 87.2 metres to point BR15Y (grid reference E:595348, N:307045) and then in an Easterly direction for approximately 63 metres to point BR15D (grid reference E:595411, N:307046) and create an alternative bridleway 4 metres wide, running from point BR15A on Shipdham Bridleway 15 (grid reference) E:595273, N:307001) in a Easterly direction for approximately 134.5 metres to point BR15B (grid reference E:595407, N:307014) and then in a Northerly direction for approximately 27.4 metres to point BR15C (grid reference E:595411, N:307041) and then in a Northerly direction for approximately 5.6 metres to point BR15D (grid reference E:595411, N:307046) as shown on the Order Map.

&

Divert the entire width of Shipdham Bridleway 16 running from point BR16A (grid reference E:595393, N:307094) in a southerly direction for approximately 49.9 metres to the termination of Bridleway 16 at point BR16Z (grid reference E:595407, N:307047) and create an alternative bridleway 4 metres wide, running from BR16A on Bridleway 16 (grid reference E:595393, N:307094) in a south easterly direction for approximately 21.6 metres to point BR16B (grid reference E:595402, N:307075) and then in a South Westerly direction for approximately 29.7 metres to point BR16C (grid reference E:595411, N:307046) as shown on the Order Map.

Any queries relating to this Order should be referred to Jean McEntee at The Planning Inspectorate, Rights of Way Section, Room 3/G Hawk Wing,

Temple Quay House, 2 The Square, Temple Quay, Bristol, BS1 6PN.  
Telephone: 0303 444 5437. Email: jean.mcentee@pins.gsi.gov.uk.  
Please quote reference number ROW/3174213 & ROW/3174214 on all correspondence.

Any person wishing to view the statements of case and other documents relating to this Order may do so by appointment at Breckland Council, Elizabeth House, Walpole Loke, Dereham NR19 1EE and Norfolk County Council, County Council, Martineau Lane, Norwich NR1 2DH between 9:am and 5:pm Monday to Friday. Telephone: 01603 222899.

### **Timetable for sending in statements of case and comments**

#### **Within 2 weeks of the start date [by 18 August 2017]**

The Order Making Authority must ensure their statement of case is received by the Secretary of State. As soon as possible after the deadline, the Secretary of State will send a copy (excluding copies of any supporting documents - these will be available to view at the Authority's offices) to everyone who has made an objection or representation, the applicant and any other person who has written to us in respect of the Order.

#### **Within 8 weeks of the start date [by 29 September 2017]**

Everyone who has made an objection or representation or any other written representation must ensure their statement of case is received by the Secretary of State. As soon as possible after the deadline, the Secretary of State will send full copies to the Authority. Copies (excluding copies of any supporting documents - these will be available to view at the Authority's offices) will also be sent to the applicant, every person who has made an objection or representation and any other person who has written to us in respect of the Order.

Within the same period the applicant (if applicable) must ensure their statement of case is received by the Secretary of State. As soon as possible after the deadline, Secretary of State will send a full copy to the Authority. Copies will also be sent to everyone who has made an objection or representation and any other person who has written to us in respect of the Order (excluding copies of any supporting documents - these will be available to view at the Authority's offices).

#### **Within 14 weeks of the start date [by 10 November 2017]**

Everyone who has made an objection or representation, the Authority, the applicant (if applicable) and anyone who has written to us in respect of the Order must ensure that their comments on any or every other statement of case is received by the Secretary of State. As soon as possible after the deadline, the Secretary of State will send copies of these comments to everyone else.

Any other person wishing to make representations in writing to the Secretary of State in respect of the above Orders must do so in line with the timetable set out above.

**In fairness to the other parties everyone should keep to the timetable to ensure that statements of case and comments are received on time. Late documents will be returned.**

We cannot accept any libellous, racist or abusive comments. Any documents containing such comments will be returned.

Notice of order for w/r

PUBLIC PATH DIVERSION ORDER  
TOWN AND COUNTRY PLANNING ACT 1990, SECTION 257

BRECKLAND DISTRICT COUNCIL (BRIDLEWAY 16) PUBLIC PATH DIVERSION  
ORDER 2016

This order is made by Breckland District Council ("the Authority") under section 257 of the Town and Country Planning Act 1990 because it is satisfied that it is necessary to divert the bridleways to which this order relates in order to enable development to be carried out in accordance with planning permission granted under Part III of the Town and Country Planning Act 1990 namely the construction of 24 dwellings, associated open space, parking & access road (3PL/2015/0562/F)

**BY THIS ORDER:**

1. The Bridleway over the land shown by a bold black line on the attached map and described in Part 1 of the Schedule to this order ("the Schedule") shall be diverted as provided below.
2. There shall be created to the reasonable satisfaction of Norfolk County Council alternative bridleways for use as a replacement for the said bridleways as provided in Part 2 of the Schedule and shown by bold black dashes on the attached map.
3. The diversion of the bridleways shall have effect on the date on which Norfolk County Council certifies that the terms of Article 2 above have been complied with.
4. The following works shall be carried out in relation to the highway described in Part 2 of the Schedule making the new Bridleway even and 4metres in width.
5. Wellington Construction Ltd is hereby required to pay for the cost of carrying out the said works.
6. Where immediately before the date of which the bridleways are diverted there is apparatus under, in, on, over, along or across it belonging to statutory undertakers for the purpose of carrying on their undertaking, the undertakers shall continue to have the same rights in respect of the apparatus as they then had.

**SCHEDULE 1 – Development**

**PART 1**

**Description of site of existing path or way**

The entire width of Shipdham Bridleway 16 running from point BR16A (grid reference E:595393, N:307094) in a southerly direction for approximately 49.9 metres to the termination of Bridleway 16 at point BR16Z (grid reference E595407, N:307047)

**PART 2**

**Description of site of alternative highway**

A new bridleway 4 metres wide, running from point BR16A on Bridleway 16 (grid reference E:595393, N:307094) in a south easterly direction for approximately 21.6 metres to point BR16B (grid reference E:595402, N:307075) and then in a South Westerly direction for approximately 29.7 metres to point BR16C (grid reference E:595411, N:307046)

DATED THIS 19 DAY OF July 2016

The Common Seal of  
**Breckland District Council**  
was hereto affixed to this Deed  
in the presence of

  
.....  
Authorised Signatory



MAP NOT TO ORIGINAL SCALE

POINT	GRID REF	DETAILS
BR16A	E:595393, N:307094	EXISTING BRIDLEWAY START (BR16)
BR16Z	E:595407, N:307047	EXISTING BRIDLEWAY FINISH (BR16)
BR16A	E:595393, N:307094	PROPOSED BRIDLEWAY START (BR16)
BR16B	E:595402, N:307075	PROPOSED BRIDLEWAY (BR16)
BR16C	E:595411, N:307046	PROPOSED BRIDLEWAY FINISH (BR16)

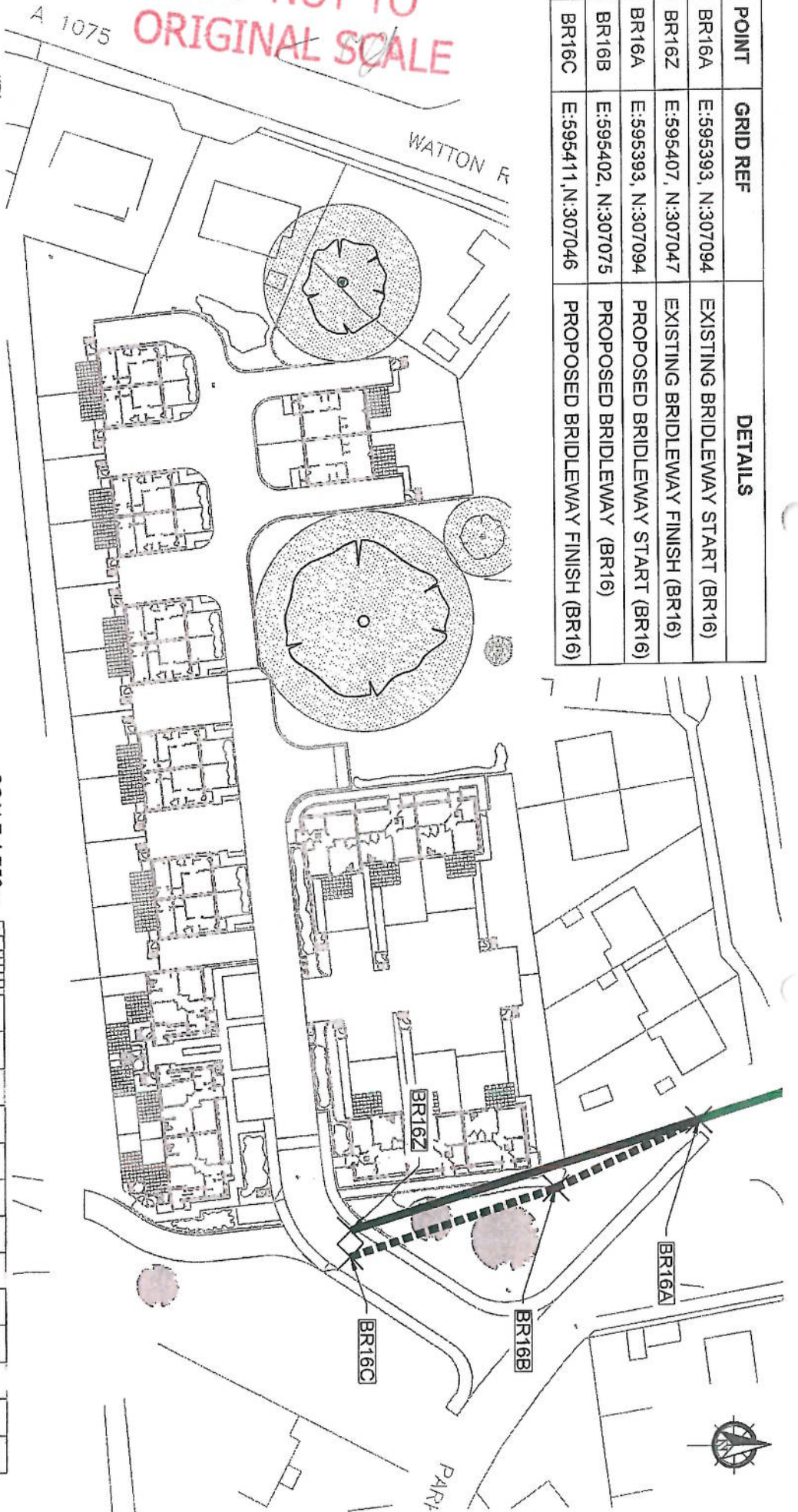

- KEY
- EXISTING BR16 ROUTE TO BE DIVERTED
  - PROPOSED BR16 ROUTE
  - EXISTING ROUTE NOT AFFECTED

**PRELIMINARY DRAWING:**  
 THIS DRAWING IS FOR PRELIMINARY PURPOSES ONLY AND MUST NOT BE READ AS A CONSTRUCTION ISSUE. IT INDICATES DESIGN INTENT ONLY AND IS SUBJECT TO AMENDMENT DURING FINAL DESIGN DEVELOPMENT.

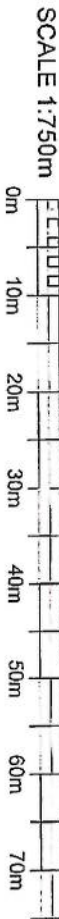

client: **Wellington** Construction Ltd  
 project: PARKLANDS AVENUE, SHIPHAM

stage: **MEH** MAB  
 scale: 1:750@M4  
 date: 06.07.16  
 client's number: 205041-553-P1

title: BRIDLEWAY BR16  
 existing and proposed  
 REALIGNMENT PLAN

**Canham Consulting**  
 Structural Engineers  
 Civil Engineers  
 Building Surveyors

Canham Consulting Ltd The Old School School Lane, Northwick, NE7 9EP. Tel: +44 (0)1603 430450 Fax: +44 (0)1603 43066  
 Email: info@canhamconsulting.co.uk www.canhamconsulting.co.uk  
 This drawing is copyright and is not to be reproduced without the written permission of Canham Consulting Ltd.

THIS DESIGN IS PROVIDED IN ACCORDANCE WITH THE CONSTRUCTION DESIGN AND MANAGEMENT REGULATIONS 2015 INCORPORATING THE APPROVED CODE OF PRACTICE, REGULATIONS 7, 9 AND 11. THOSE ALTERING THE DESIGN WITHOUT THE AUTHORITY OF CANHAM CONSULTING LTD SHOULD BE AWARE THEY MAY ALSO ASSUME RESPONSIBILITY FOR THOSE CHANGES.

PUBLIC PATH DIVERSION ORDER  
TOWN AND COUNTRY PLANNING ACT 1990, SECTION 257

BRECKLAND DISTRICT COUNCIL (BRIDLEWAY 15) PUBLIC PATH DIVERSION  
ORDER 2016

This order is made by Breckland District Council ("the Authority") under section 257 of the Town and Country Planning Act 1990 because it is satisfied that it is necessary to divert the bridleway to which this order relates in order to enable development to be carried out in accordance with planning permission granted under Part III of the Town and Country Planning Act 1990 namely the construction of 24 dwellings, associated open space, parking & access road (3PL/2015/0562/F)

BY THIS ORDER:

1. The Bridleway over the land shown by a bold black line on the attached map and described in Part 1 of the Schedule to this order ("the Schedule") shall be diverted as provided below.
2. There shall be created to the reasonable satisfaction of Norfolk County Council an alternative highway for use as a replacement for the said bridleway as provided in Part 2 of the Schedule and shown by bold black dashes on the attached map.
3. The diversion of the bridleways shall have effect on the date on which Norfolk County Council certifies that the terms of Article 2 above have been complied with.
4. The following works shall be carried out in relation to the highway described in Part 2 of the Schedule.
5. Wellington Construction Ltd is hereby required to pay for the cost of carrying out the said works.
6. Where immediately before the date of which the bridleways are diverted there is apparatus under, in, on, over, along or across it belonging to statutory undertakers for the purpose of carrying on their undertaking, the undertakers shall continue to have the same rights in respect of the apparatus as they then had.

**SCHEDULE 1 – Development**

**PART 1**

**Description of site of existing path or way**

The entire width of a length of Shipdham Bridleway 15 running from point BR15A (grid reference E:595273, N:307001) in an North Easterly direction for approximately 87.2 metres to point BR15Y (grid reference E:595348, N:307045) and then in an Easterly direction for approximately 63 metres to point BR15D (grid reference E:595411, N:307046)

**PART 2**

**Description of site of alternative highway**

A new bridleway 4 metres wide, running from point BR15A on Shipdham Bridleway 15 (grid reference E:595273, N:307001) in a Easterly direction for approximately 134.5 metres to point BR15B (grid reference E:595407, N:307014) and then in a Northerly direction for approximately 27.4 metres to point BR15C (grid reference E595411, N:307041) and then in a Northerly direction for approximately 5.6 metres to point BR15D (grid reference E:595411, N307046).

DATED THIS 19 DAY OF July 2016

The Common Seal of  
**Breckland District Council**  
was hereto affixed to this Deed  
in the presence of

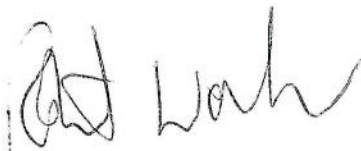

.....  
Authorised Signatory





MAP NOT TO ORIGINAL SCALE

POINT	GRID REF	DETAILS
BR15A	E:595273, N:307001	EXISTING BRIDLEWAY START (BR15)
BR15Y	E:595348, N:307045	EXISTING BRIDLEWAY (BR15)
BR15D	E:595411, N:307046	EXISTING BRIDLEWAY FINISH (BR15)
BR15A	E:595273, N:307001	PROPOSED BRIDLEWAY START (BR15)
BR15B	E:595407, N:307014	PROPOSED BRIDLEWAY (BR15)
BR15C	E:595411, N:307041	PROPOSED BRIDLEWAY (BR15)
BR15D	E:595411, N:307046	PROPOSED BRIDLEWAY FINISH (BR15)

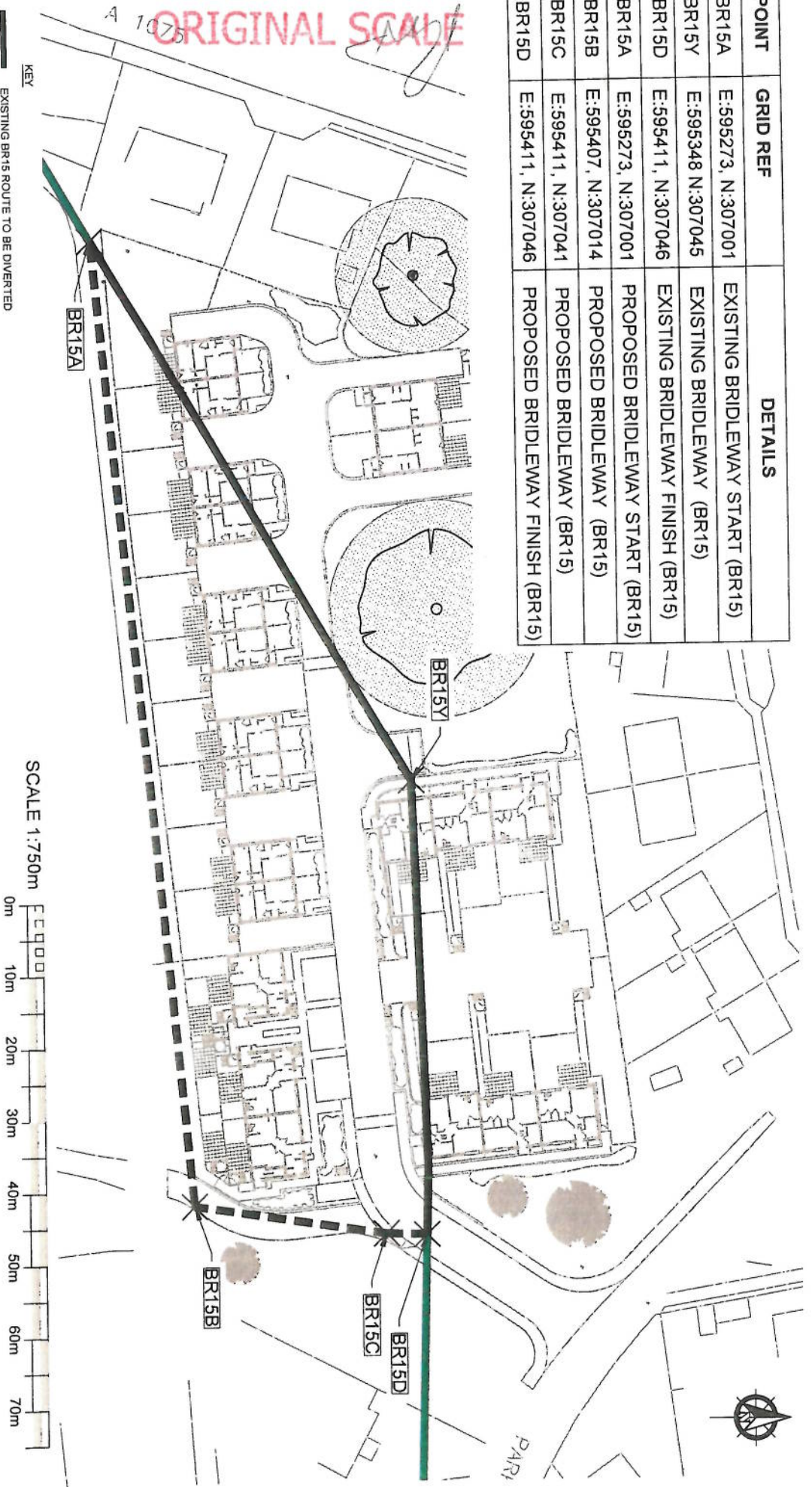

KEY  
 --- EXISTING BR15 ROUTE TO BE DIVERTED  
 - - - PROPOSED BR15 ROUTE  
 --- EXISTING ROUTE NOT AFFECTED

PRELIMINARY DRAWING:  
 THIS DRAWING IS FOR PRELIMINARY PURPOSES ONLY AND MUST NOT BE READ AS A CONSTRUCTION ISSUE.  
 IT INDICATES DESIGN INTENT ONLY AND IS SUBJECT TO AMENDMENT DURING FINAL DESIGN DEVELOPMENT.

drawn by: MEH  
 checked by: MMB  
 scale: 1:750@A4  
 date: 06.07.16  
 drawing number: 205041-552-P1

**Wellington Construction Ltd**

project: PARKLANDS AVENUE, SHIPDHAM

the: BRIDLEWAY BR15  
 EXISTING AND PROPOSED  
 REALIGNMENT PLAN

**Canham Consulting**  
 Structural Engineers  
 Civil Engineers  
 Building Surveyors

THIS DESIGN IS PRODUCED IN ACCORDANCE WITH THE CONSTRUCTION DESIGN AND MANAGEMENT REGULATIONS 2015 INCORPORATED.  
 WE APPROVED CODE OF PRACTICE, REGULATIONS 2, 9 AND 11, THOSE ALTERING THE DESIGN WITHOUT THE AUTHOR'S  
 CANHAM CONSULTING LTD SHOULD BE AWARE THEY MAY ALSO ASSUME RESPONSIBILITY FOR THOSE OMISSIONS.

Canham Consulting Ltd, The Old School, School Lane, Norfolk  
 Norfolk, NR7 6EP. Tel: +44 (0)1603 430650. Fax: +44 (0)1603 45095  
 Email: mail@canhamconsulting.co.uk www.canhamconsulting.co.uk  
 © This drawing is copyright and is not to be reproduced without the written permission of Canham Consulting Ltd.