

NOTICE OF ORDER

WILDLIFE AND COUNTRYSIDE ACT 1981

SECTION 53

Hertfordshire County Council
(Kings Langley 47Modification Order 2016)

Notice is hereby given that the above referenced Order has been submitted to the Secretary of State for Environment, Food and Rural Affairs for determination. An Inspector will be appointed by the Secretary of State to determine the Order.

The **start date** for the above Order is 11 May 2017.

Consideration of the Order will take the form of a public local inquiry.

The Inquiry will be held at Kings Langley Services Club, 3-5 Hempstead Road, Kings Langley, WD4 8BJ on **Tuesday 10 October 2017** at 10.00am.

The effect of the Order, if confirmed without modifications, will be to add a footpath commencing from the junction with Kings Langley footpath 17 at TL 0605 0399 and continuing in a generally westerly direction for approximately 375 metres on the southern side of the field north of Lady Meadow, crossing Kings Langley footpath 19 at TL 0568 0398, then continuing in a generally north westerly, north easterly then south easterly direction for approximately 395 metres around the western and northern boundaries of the field to the junction with Kings Langley footpath 19 at TL 0582 0413. Width 2 metres between TL 0605 0399 and TL 0568 0398 and 3 metres between TL 0568 0398 and TL 0582 0413.

Any queries relating to this Order should be referred to Jean McEntee at The Planning Inspectorate, Rights of Way Section, Room 3/G Hawk Wing, Temple Quay House, 2 The Square, Temple Quay, Bristol, BS1 6PN. Telephone: 0303 444 5437. Email: jean.mcentee@pins.gsi.gov.uk. Please quote reference number ROW/3168851 on all correspondence.

Any person wishing to view the statements of case and other documents relating to this Order may do so between 10am -12pm, 2pm – 4pm Monday to Friday (Excluding Bank Holidays) at Hertfordshire County Council, County Hall, Pegs Lane, Hertford, Hertfordshire, SG13 8DN. Telephone 01992 555279.

Timetable for sending in statements of case and proofs of evidence

Within 8 weeks of the start date by 6 July 2017

The Order Making Authority must ensure their statement of case is received by the Secretary of State. As soon as possible after the deadline, the Secretary of State will send a copy (excluding copies of any supporting documents - these will be available to view at the Authority's offices) to everyone who has made an objection or representation and the applicant and any other person who has written to us in respect of the Order.

Within 14 weeks of the start date by 17 August 2017

Everyone who has made an objection or representation and anyone who wishes to give evidence at the Inquiry must ensure their statement of case¹ is received by the Secretary of State. As soon as possible after the deadline, the Secretary of State will send full copies to the Authority. Copies will also be sent to the applicant, every person who has made an objection or representation and any other person who has written to us in respect of the Order (excluding copies of any supporting documents - these will be available to view at the Authority's offices).

Within the same period the applicant (if applicable) must ensure their statement of case is received by the Secretary of State. As soon as possible after the deadline, the Secretary of State will send a full copy to the Authority. Copies will also be sent to everyone who has made an objection or representation and any other person who has written to us in respect of the Order (excluding copies of any supporting documents - these will be available to view at the Authority's offices).

4 weeks before the date of the inquiry by 12 September 2017

The Authority, everyone who has made an objection or representation, the applicant (if applicable) and anyone who wishes to give evidence at the Inquiry must ensure their proof of evidence (together with any summary) is received by the Secretary of State. As soon as possible after the deadline, the Secretary of State will send copies of:

- i) the Authority's proof of evidence to everyone who has made an objection or representation, the applicant and anyone who has submitted a statement of case (excluding copies of any supporting documents - although none should be submitted with a proof of evidence);
- ii) the applicant's proof of evidence to the Authority, everyone who has made an objection or representation and anyone else who has

¹ If you wish to make a legal submission, this should be submitted at the same time as your statement of case. Otherwise legal submissions will have to be submitted in writing on the day of the inquiry.

submitted a statement of case (excluding copies of any supporting documents – although none should be submitted with a proof of evidence); and

- iii) all other proofs of evidence to the Authority, the applicant, everyone who has made an objection or representation and anyone else who has submitted a statement of case (excluding copies of any supporting documents – although none should be submitted with a proof of evidence).

All parties must keep to the timetable set out above and ensure that statements of case and proofs of evidence are received by the Secretary of State on time. Late documents will be returned.

We cannot accept any libellous, racist or abusive comments. Any documents containing such comments will be returned.

Notice of order for inquiry

WILDLIFE AND COUNTRYSIDE ACT 1981

The Definitive Map and Statement of Public Rights of Way in Hertfordshire

Hertfordshire County Council

(Kings Langley 47)

Modification Order 2016

This Order is made by Hertfordshire County Council under Section 53(2)(b) of the Wildlife and Countryside Act 1981 ("the Act") because it appears to that authority that the Definitive Map and Statement of Public Rights of Way in Hertfordshire require modification in consequence of the occurrence of an event specified in Section 53(3) (c)(i) and (iii) of the Act, namely

(c) the discovery by the authority of evidence which (when considered with all other relevant evidence available to them) shows

- (i) that a right of way which is not shown in the map and statement subsists or is reasonably alleged to subsist over land in the area to which the map relates, being a right of way such that the land over which the right subsists is a public path, a restricted byway or, subject to section 54A, a byway open to all traffic; and
- (iii) that there is no public right of way over land shown in the map and statement as a highway of any description, or any other particulars contained in the map and statement require modification.

The authority has consulted with every local authority whose area includes the land to which the Order relates. Hertfordshire County Council hereby order that:

1. For the purposes of this Order the relevant date is 13th April 2016.
2. The Definitive Map and Statement of Public Rights of Way in Hertfordshire shall be modified as described in Part I and Part II of the Schedule and shown on the plan forming part of this Order ("the Order Plan").
3. This Order shall take effect on the date it is confirmed and may be cited as the Hertfordshire County Council (Kings Langley 47) Modification Order 2016.

SCHEDULE

PART I

Modification of Definitive Map

DESCRIPTION OF PATH OR WAY TO BE ADDED

A public footpath commencing from the junction with Kings Langley Footpath 17 at TL 0605 0399 (point A on the Order Plan) and continuing in a generally westerly direction for approximately 375 metres on the southern side of the field north of Lady Meadow, crossing Kings Langley Footpath 19 at TL 0568 0398 (point B on the Order Plan), then continuing in a generally north westerly, north easterly then south easterly direction for approximately 395 metres around the western and northern boundaries of the field to the junction with Kings Langley Footpath 19 at TL 0582 0413 (point C on the Order Plan).

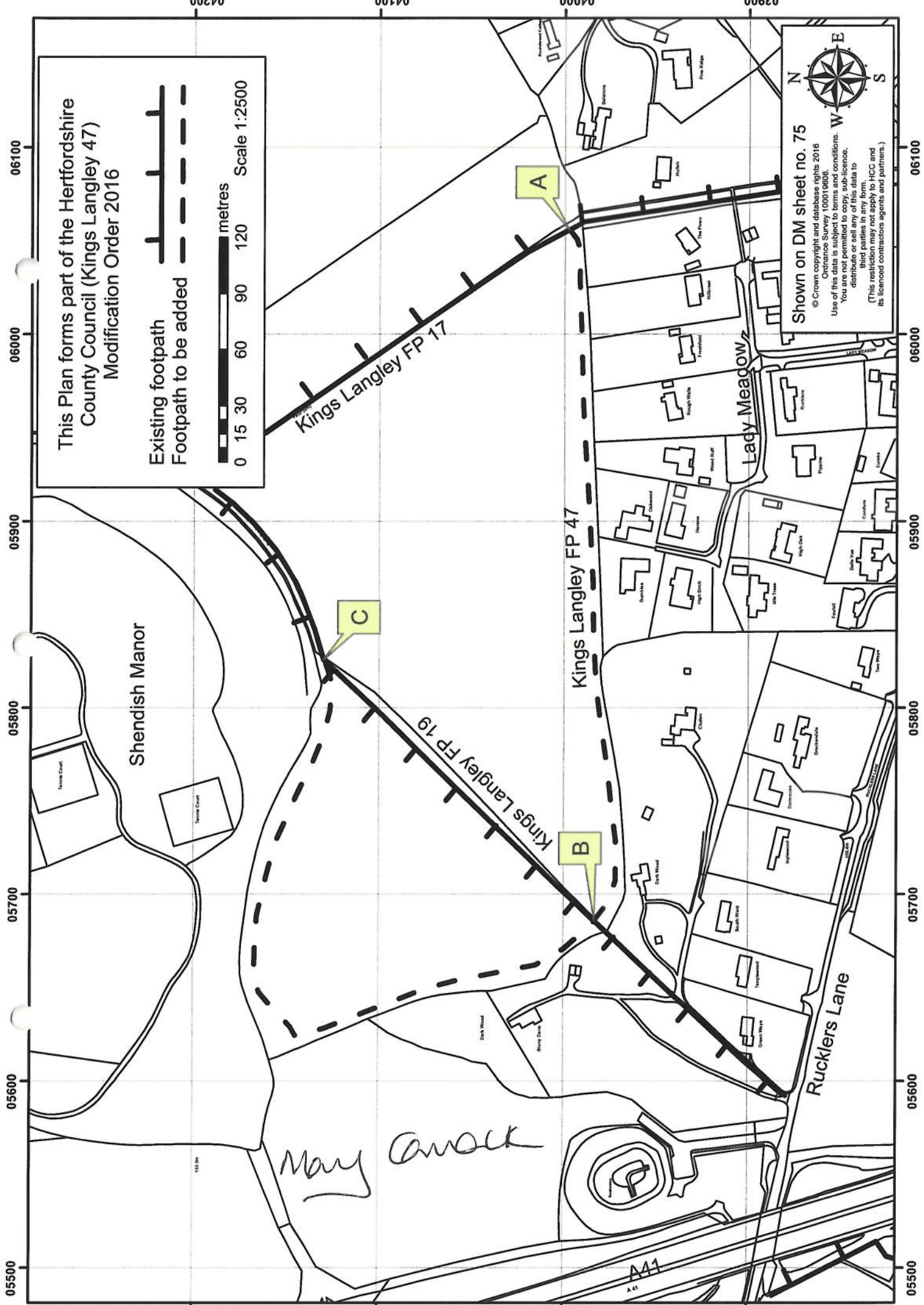

This Plan forms part of the Hertfordshire
County Council (Kings Langley 47)
Modification Order 2016

Existing footpath
Footpath to be added

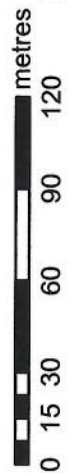

Shown on DM sheet no. 75
© Crown copyright and database rights 2016
Ordnance Survey 1000106006.
Use of this data is subject to terms and conditions.
You are not permitted to copy, sub-licence,
distribute or sell any of this data to
third parties in any form.
(This restriction may not apply to HCC and
its licensed contractors agents and partners.)

Kings Langley FP 17

Kings Langley FP 19

Kings Langley FP 47

Lady Meadow

Rucklers Lane

Shendish Manor

May Ansell

A41

04200

04100

04000

03900

05500

05600

05700

05800

05900

06000

06100

05500

05600

05700

05800

05900

06000

06100

Width: 2 metres between TL 0605 0399 (point A on the Order Plan) and TL 0568 0398 (point B on the Order Plan)
3 metres between TL 0568 0398 (point B on the Order Plan) and TL 0582 0413 (point C on the Order Plan)

Limitations: None

PART II
Modification of Definitive Statement

VARIATION OF PARTICULARS OF PATH OR WAY

A new Statement shall be recorded for Kings Langley 47 as follows:

Path No	Status	HCC Map Ref
---------	--------	-------------

047	FP	HCC 075
-----	----	---------

Commences from Kings Langley FP 17 at TL 0605 0399 then runs generally W for approx. 375m on the S side of the field N of Lady Meadow, crossing Kings Langley FP 19 at TL 0568 0398, then continues generally NW, NE then SE for approx. 395m around the W and N boundaries of the field to join Kings Langley FP 19 at TL 0582 0413.

Width 2 m between TL 0605 0399 and TL 0568 0398
3 m between TL 0568 0398 and TL 0582 0413

Limitations None

The Statement for Kings Langley 17 shall be amended as follows:

Path No	Status	HCC Map Ref
---------	--------	-------------

017	FP	HCC 075
-----	----	---------

Commences from Love Lane opposite FP13 thence generally NW to E of school thence NE to junction with Barnes Lane thence NW inside boundary parallel with Barnes Lane and across same thence NW to E of Barnes Farm through Hanging's Wood across Rucklers Lane, to junction with Kings Langley FP 47 at TL 0605 0399, thence to E of Shendish House thence NW, N and NE through Hens Head Wood thence N to parish boundary NE of Cocks Head Wood.

Width

Limitations

The Statement for Kings Langley 19 shall be amended as follows:

Path No	Status	HCC Map Ref
---------	--------	-------------

019	FP	HCC 075
-----	----	---------

Commences from parish boundary at edge of Scatterdells Wood then NE to the A41 (at TL 0551 0383) thence NW beside the A41 for approx. 70m to a junction with Rucklers Lane 2U38 (at TL 0548 0389). Recommences on the north side of Rucklers Lane to the east of the A41, thence NE, crossing Kings Langley FP 47 at TL 0568 0398, joining Kings Langley FP 47 at TL 0582 0413 and then continuing to join FP17 SE of Shendish House.

Width

Limitations No limitations between TL 0551 0383 and Rucklers Lane

IN WITNESS whereof the COMMON SEAL of HERTFORDSHIRE COUNTY COUNCIL was hereunto affixed this *6th* day of *May* 2016

The Common Seal of
HERTFORDSHIRE
COUNTY COUNCIL
was hereunto affixed
in the presence of:-

Chief Legal Officer

Mary Cormack

589/16



Mary Cormack
Asst Chief Legal Officer