

KENT

COUNTY AND BOROUGH OF MEDWAY

BOROUGH OF TONBRIDGE AND MALLING

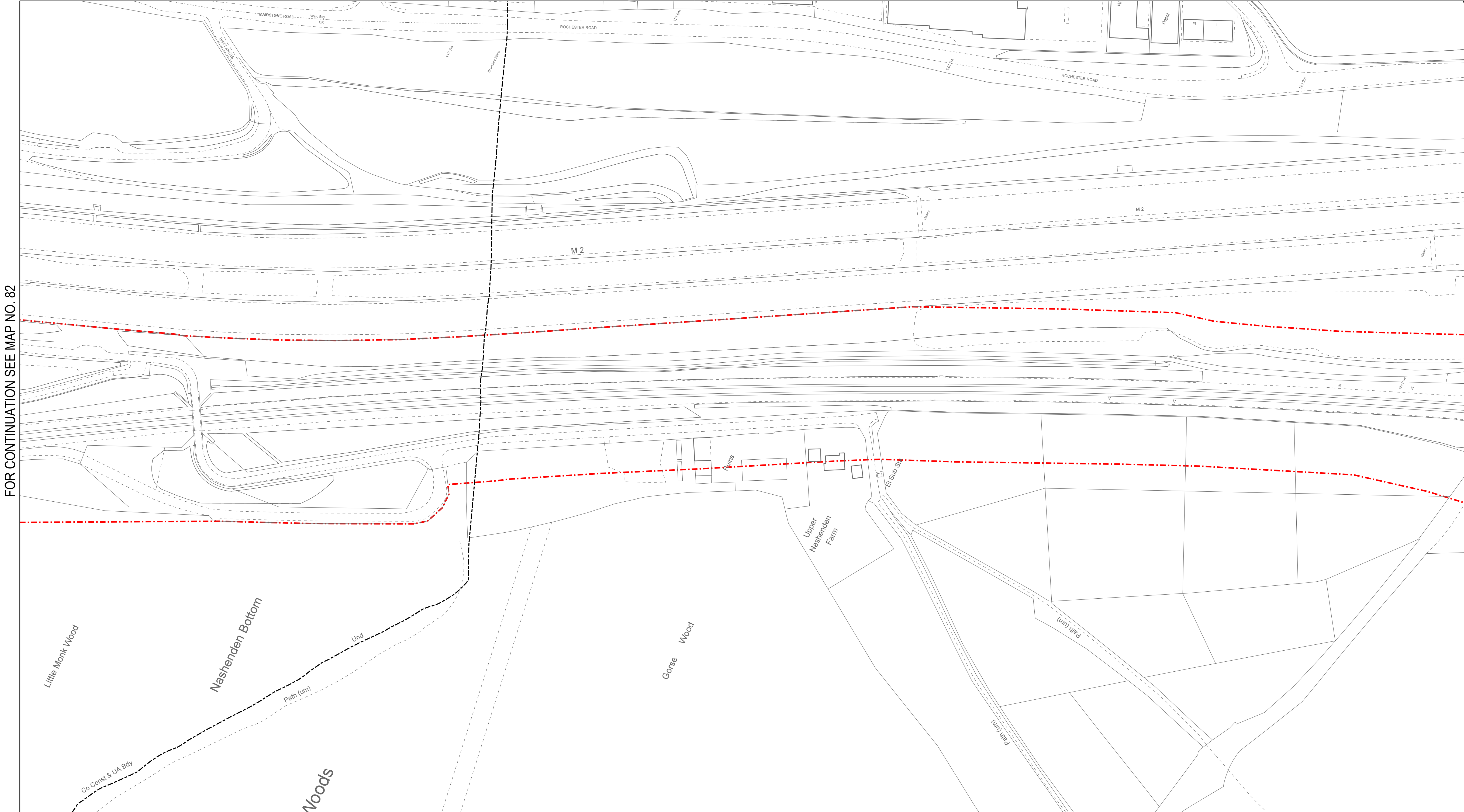

FOR CONTINUATION SEE MAP NO. 82

FOR CONTINUATION SEE MAP NO. 84

FOR CONSULTATION PURPOSES ONLY

Legend

- Proposed Limits of Land subject to reduced Safeguarding Directions
- Areas of Sub-Surface Interest
- Borough Boundary

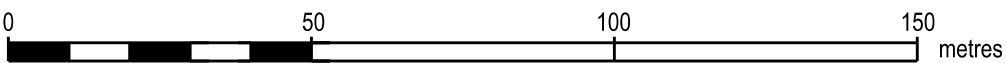

Date of Issue
JANUARY 2016

Drawing Number
040-DDS-HISP1-00383

Scale at A1 1:1250 Scale at A3 1:2500

© Crown copyright and database rights 2015, Ordnance Survey Licence No. 100052760
HS1 accept no responsibility for any circumstances, which arise from the reproduction of this map after alteration, amendment or abbreviation or if issued in part or issued incomplete in any way.



**HIGH SPEED 1
SAFEGUARDING DIRECTIONS
MAP NO. 83**

HIGH SPEED 1 LTD.
12TH FLOOR ONE EUSTON SQUARE
40 MELTON STREET
LONDON NW1 2FD