

WILDLIFE AND COUNTRYSIDE ACT 1981

THE COUNTY OF HEREFORDSHIRE DISTRICT COUNCIL WILDLIFE AND COUNTRYSIDE ACT 1981 ADDITION OF FOOTPATHS IN THE PARISH OF FOWNHOPE (TO BE KNOWN AS FOWNHOPE FWB12, FOWNHOPE FWB13, FOWNHOPE FWB14 AND FOWNHOPE FWB15) MODIFICATION ORDER 2002

This Order is made by The County of Herefordshire District Council ("the Authority") under Section 53(2)(b) of the Wildlife and Countryside Act 1981 ("the Act") because it appears to the Authority that the Definitive Map and Statement for the County of Herefordshire requires modification in consequence of the occurrence of events specified in Sections 53(3)(c)(i) of the Act, namely the discovery by the authority of evidence which (when considered with all other relevant evidence available to them) shows that a right of way which is not shown in the map and statement subsists or is reasonably alleged to subsist over land in the area to which the map relates, being a right of way to which this part applies.

The Authority has consulted with every local authority whose area includes the land to which the Order relates. The County of Herefordshire District Council hereby Order that:-

1. For the purposes of this Order the relevant date is 30th April 2002.
2. The Definitive Map and Statement for the County of Herefordshire shall be modified as described in Part I and Part II of the Schedule and shown on the plan attached to the Order.
3. This Order shall take effect on the date it is confirmed and may be cited as the County of Herefordshire District Council Wildlife and Countryside Act 1981 Addition of Footpaths in The Parish of Fownhope (To Be Known as Fownhope FWB12, Fownhope FWB13, Fownhope FWB14 and Fownhope FWB15) Modification Order 2002.

Dated 30th April 2002

THE COMMON SEAL of the County of)
Herefordshire District Council was affixed)
BY ORDER

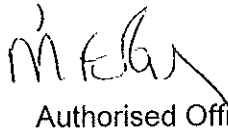
Authorised Officer

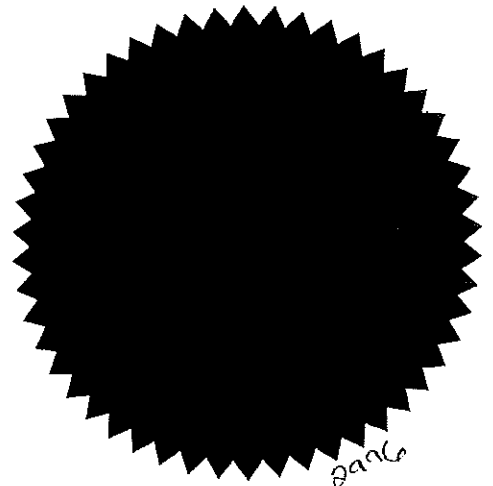

SCHEDULE

PART I

Modification of Definitive Map Description of Public Rights of Way to be Added

Path A – B

Footpath to be known as FWB12 in the Parish of Fownhope commences at the junction with footpath FWB1A Grid Reference SO 5779 3552 (point A on the Order plan) and proceeds in a north westerly direction for approximately 243 metres to join footpath FWB6A Grid Reference SO 5761 3566 (point B on the Order plan). Length of approximately 243 metres and of a width of 2 metres.

C-D

Footpath to be known as FWB13 in the Parish of Fownhope commences at the junction with footpath FWB10 Grid Reference SO 3744 3521 (point C on the Order plan) and proceeds in a north easterly direction for approximately 360 metres to join footpath FWB6A Grid Reference SO 5765 3547 (point D on the Order plan). Length of approximately 360 metres and of a width of 2 metres.

H-E-F-I-J

Footpath to be known as FWB14 in the Parish of Fownhope commences at the junction with C1295 County Road Grid Reference SO 5780 3471 (point H on the Order plan) and proceeds generally north easterly for approximately 145 metres to Grid Reference SO 5790 3480 (point E on the Order plan) and thence south easterly for approximately 177 metres to join footpath FWA11 at Grid Reference SO 5802 3468 (point J on the Order plan). Length of approximately 322 metres and of a width of 3 metres.

F-G

Footpath to be known as FWB15 in the Parish of Fownhope commences at the junction with FWB14 at Grid Reference SO 5795 3476 (point F on the Order plan) and proceeds in a south easterly direction for approximately 36 metres to Grid Reference SO 5797 3474 (point G on the Order plan). Length of approximately 36 metres and a width of 2 metres.

PART II

Modification of the Definitive Statement Variation of Particulars of Ways

Addition to Definitive Statement of: Footpath Fownhope FWB12

Commences from footpath FWB1A at Grid Reference SO 5779 3552 and proceeds in a north westerly direction for approximately 243 metres to join footpath FWB6A at Grid Reference SO 5761 3566. The total length of FWB12 is approximately 243 metres. FWB12 has a minimum width of approximately 2 metres.

Footpath Fownhope FWB13

Commences from footpath FWB10 at Grid Reference SO 5744 3521 and proceeds in a north easterly direction for approximately 360 metres to join footpath FWB6A at Grid Reference SO 5765 3547. The total length of FWB13 is approximately 360 metres. FWB13 has a minimum width of approximately 2 metres.

Footpath Fownhope FWB14

Commences at the junction with C1295 County Road at Grid Reference SO 5780 3471 and proceeds generally north easterly for approximately 145 metres to Grid Reference SO 5790 3480 and proceeding in a generally south easterly direction for approximately 62 metres to junction with footpath FWB15 at Grid Reference SO 5795 3476. Continuing in this south easterly direction for approximately 114 metres to join footpath FWA11 at Grid Reference SO 5802 3468. The total length of FWB14 is approximately 322 metres. FWB14 has a minimum width of approximately 3 metres.

Footpath Fownhope FWB15

Commences from it junction with FWB14 at Grid Reference SO 5795 3476 and proceeds in a south easterly direction for approximately 36 metres to junction with Footpath FWA11 at Grid Reference SO 5797 3474. The total length of FWB15 is approximately 36metres. FWB15 has a minimum width of approximately 2 metres.

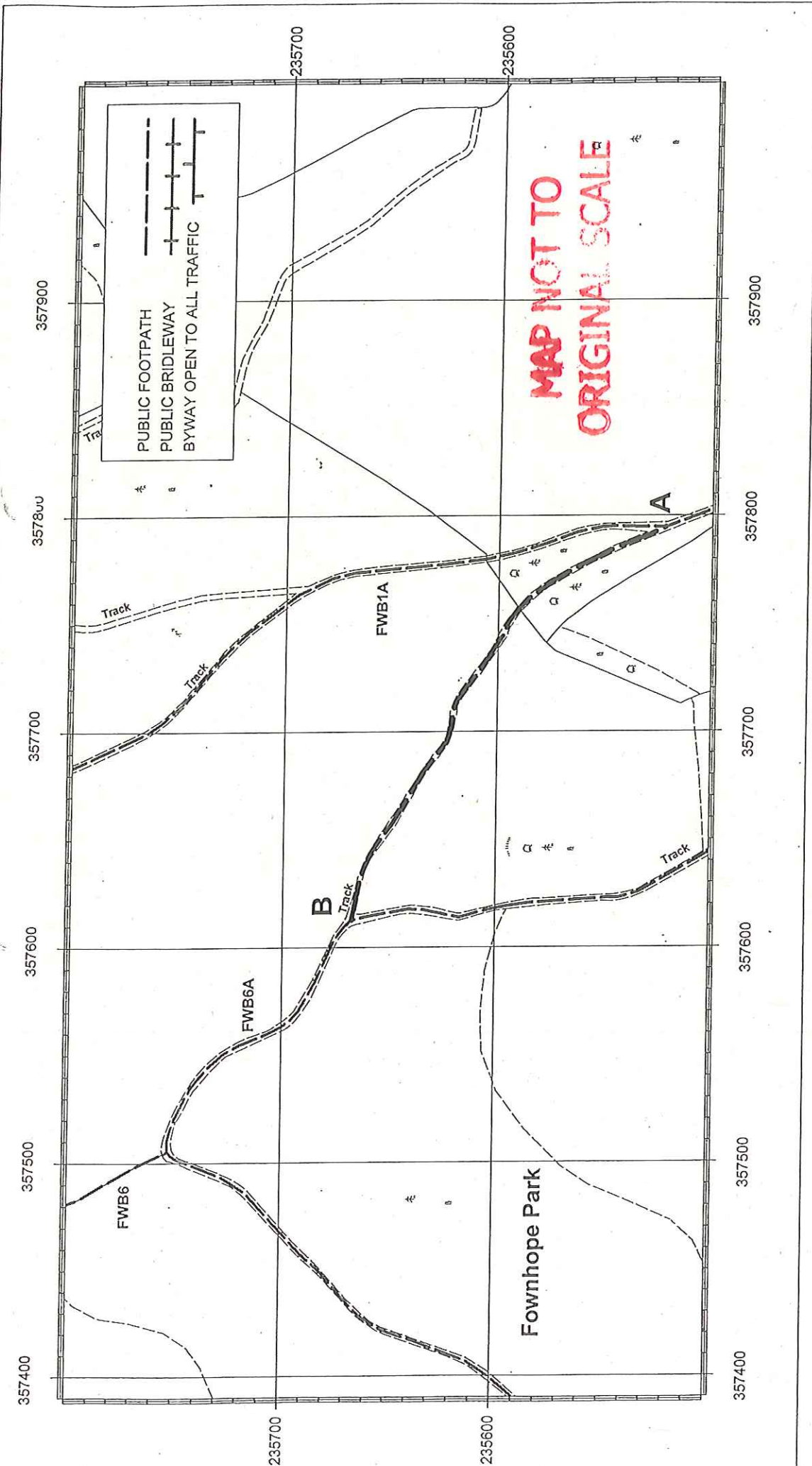

Herefordshire Council
 Directorate of Environment
 Engineering Services
 PO Box 234
 Hereford
 HR1 2ZD
 Tel.: (01432) 260000
 Fax.: (01432) 261983

PARISH OF FOWNHOPE. MODIFICATION ORDER
 PROPOSED ADDITION OF FOOTPATH
 DWG No. M111/149-GEN
 SCALE 1:2500

PROPOSED ADDITION OF FOOTPATH A ——— B

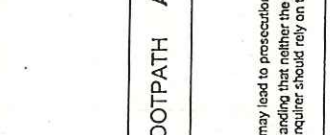

Reproduced from Ordnance Survey mapping with the permission of the Controller of Her Majesty's Stationery Office. Crown Copyright. Unauthorised reproduction infringes Crown copyright and may lead to prosecution or civil proceedings. LA05069L
 This information is based on that currently available to the County of Herefordshire District Council from the Definitive map and Statement and other public records. It is given on the strict understanding that neither the Council nor any of its officers will be responsible for the accuracy of this information or accept any liability whatsoever for any error or omission therein for any loss or damage arising from interpretation or use of the information supplied. The Inquirer should rely on the results of their own investigations.

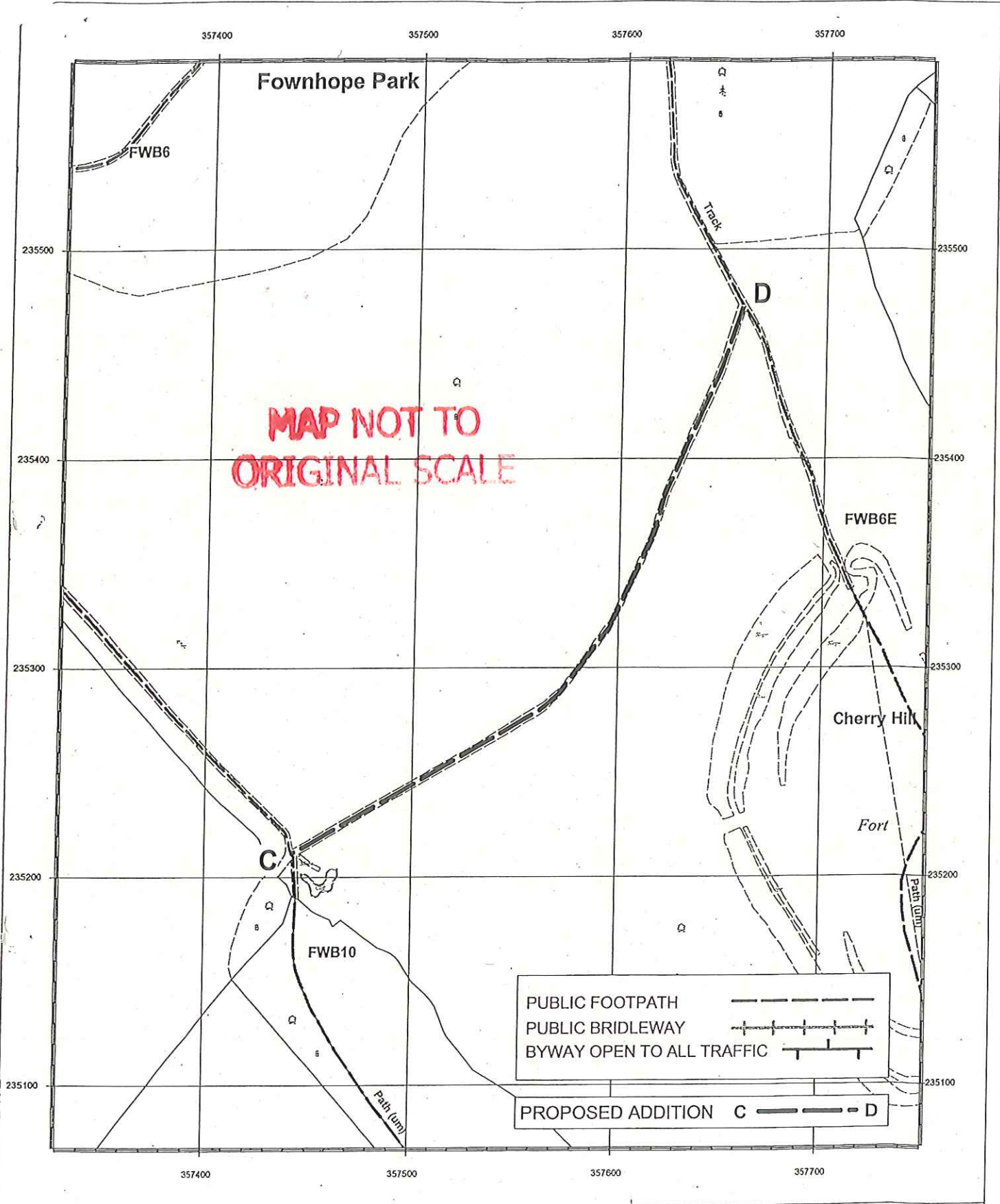

MAP NOT TO ORIGINAL SCALE

PUBLIC FOOTPATH	
PUBLIC BRIDLEWAY	
BYWAY OPEN TO ALL TRAFFIC	
PROPOSED ADDITION C-D	

NORTH



**PARISH OF FOWNHOPE.
MODIFICATION ORDER. PROPOSED
ADDITION OF FOOTPATH
DWG No. M112/149-GEN
SCALE 1:2500**

Herefordshire Council
Directorate of Environment
Engineering Services
PO Box 234
Hereford
HR1 2ZD
Tel.: (01432) 260000
Fax.: (01432) 261983

Reproduced from Ordnance Survey mapping with the permission of the Controller of Her Majesty's Stationery Office. Crown Copyright. Unauthorised reproduction infringes Crown copyright and may lead to prosecution or civil proceedings. LA09069L. This information is based on that currently available to the County of Herefordshire District Council from the Definitive map and Statement and other public records. It is given on the strict understanding that neither the Council nor any of its officers will be responsible for the accuracy of this information or accept any liability whatsoever for any error or omission therein for any loss or damage arising from interpretation or use of the information supplied. The inquirer should rely on the results of their own investigations.

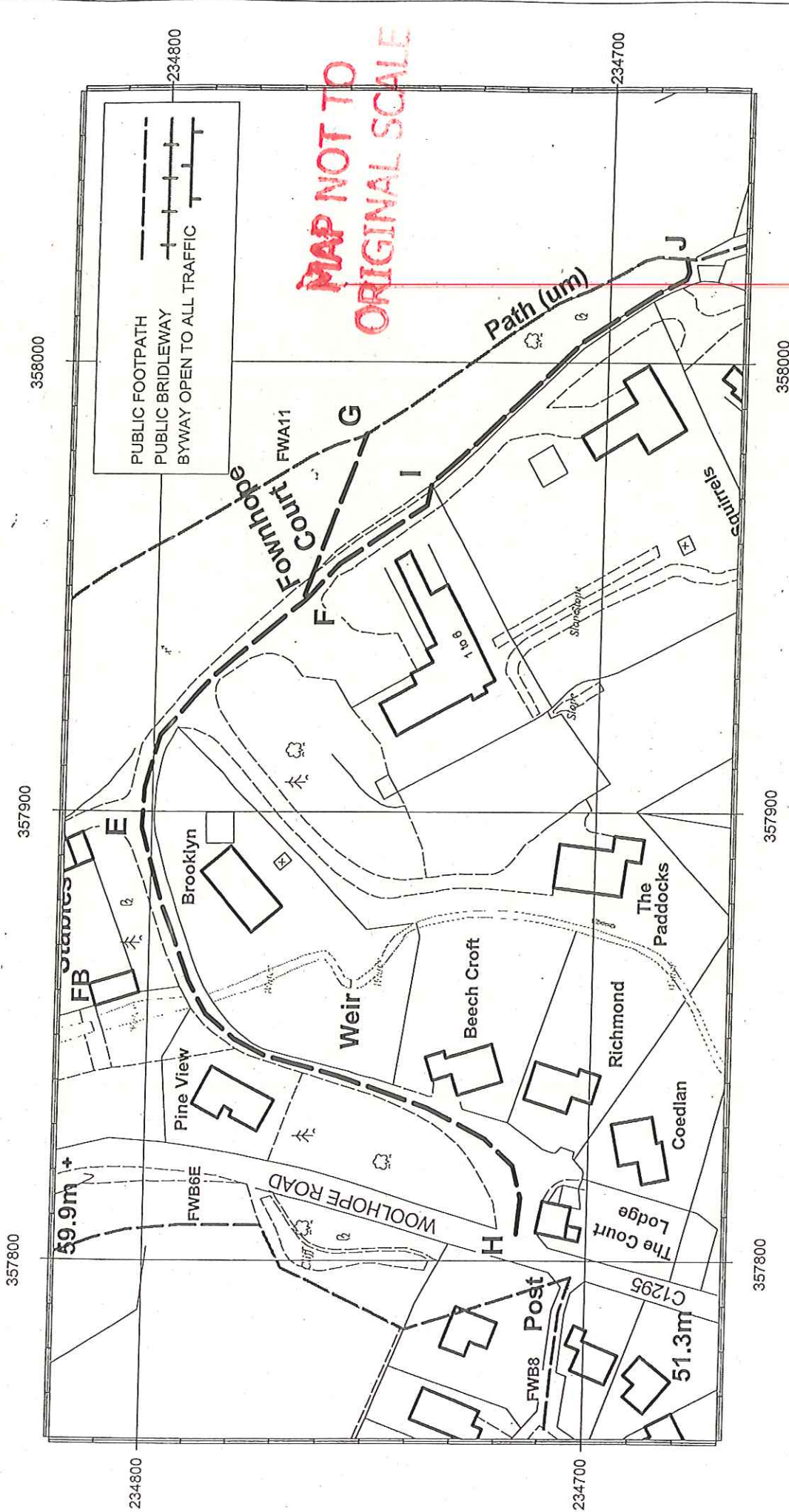

MAP NOT TO ORIGINAL SCALE

PUBLIC FOOTPATH
 PUBLIC BRIDLEWAY
 BYWAY OPEN TO ALL TRAFFIC

PARISH OF FOWNHOPE. MODIFICATION ORDER
PROPOSED ADDITION OF FOOTPATHS
 DWG No. M117149-GEN
 SCALE 1:1250

PROPOSED ADDITION OF FOOTPATHS
 F ———— F
 H ———— H
 E ———— E
 I ———— I
 J ———— J
 G ———— G

Herefordshire Council
 Directorate of Environment
 Engineering Services
 PO Box 234
 Hereford
 HR1 2ZD
 Tel.: (01432) 260000
 Fax.: (01432) 261983



Reproduced from Ordnance Survey mapping with the permission of the Controller of Her Majesty's Stationery Office. Crown Copyright. Unauthorised reproduction infringes Crown copyright and may lead to prosecution or civil proceedings. LA060699L. This information is based on that currently available to the County of Herefordshire District Council from the Definitive map and Statement and other public records. It is given on the strict understanding that neither the Council nor any of its officers will be responsible for the accuracy of this information or accept any liability whatsoever for any error or omission therein for any loss or damage arising from interpretation or use of the information supplied. The inquirer should rely on the results of their own investigations.