

**THE WILDLIFE AND COUNTRYSIDE ACT 1981, SECTION 53**

**DEFINITIVE MAP AND STATEMENT OF PUBLIC RIGHTS OF WAY OF COUNTY  
DURHAM**

**THE COUNTY COUNCIL OF DURHAM PUBLIC RIGHTS OF  
WAY MODIFICATION ORDER NO. 2  
(PUBLIC FOOTPATH NO. 77 CONSETT) 2015**

This Order is made by the County Council of Durham under Section 53(2)b of the Wildlife and Countryside Act 1981 ("the Act") because it appears to the Authority that the Definitive Map and Statement of Public Rights of Way of County Durham require modification in consequence of the occurrence of an event specified in Section 53(3)(c)(i) of the Act namely the discovery by the Authority of evidence which (when considered with all other relevant evidence available) shows that a right of way which is not shown on the Definitive Map and Statement subsists or is reasonably alleged to subsist over land in the area to which the map relates.

The County Council of Durham hereby order that:

1. For the purposes of this Order the relevant date is 30 April 2015.
2. The Definitive Map and Statement of Public Rights of Way of County Durham shall be modified as described in Part I and Part II of the Schedule and shown on the map attached to the Order.
3. The Order shall take effect on the date it is confirmed and may be cited as The County Council of Durham Public Rights of Way Modification Order No. 2 (Public Footpath No. 77 Consett) 2015.

**SCHEDULE**

**Part I**

**Modification of Definitive Map**

**Description of Public Rights of Way to be added**

<b>No of Path</b>	<b>Position</b>
77 Consett Parish (width 1.4 metres)	Commencing from a point on the B6310 grid reference NZ 414138.556139 (point A on plan) and proceeding in a generally north direction down concrete steps with adjacent handrail and across grassy area for a distance of some 29 metres to High Hamsterley Road grid reference NZ 414140.556168 (point B on plan) (A-B)

**Part II**

**Modification of Definitive Statement**

**DEFINITIVE STATEMENT OF PUBLIC RIGHTS OF WAY**

1/18/1

No: 77

**Town/Parish:** Consett

**Name of Path:**

**Status:** Footpath

**OS Sheet:** NZ 15 NW

**Starting Point:** B6310 at NZ 414138 556139 opposite Parklands Estate

**Description of Route:** Down steps with handrail and across grassy area

**Ultimate Destination:** Southern stub of High Hamsterley Road between Nos 17 and 20 at NZ 414140 556168

**Details of Features:**

**Width of Path:** 1.4 metres

**Length of Path:** 29 metres

**Type of Construction:**

**Sections Metalled:**

**Sections Ploughed:**

**General Conditions of:**

- (a) Path
- (b) Stiles and Gates
- (c) Bridges
- (d) Stepping Stones

**Details of any Signs and Notices Boards:**

**NOTES:** Added to DMS: The County Council of Durham Public Rights of Way Modification Order No. 2 (Public Footpath No. 77 Consett) 2015

**GIVEN UNDER THE COMMON SEAL OF THE COUNTY COUNCIL OF DURHAM  
ON THE 4<sup>th</sup> DAY OF JUNE 2015**

.....  
**Authorised signatory**





IAN THOMPSON  
CORPORATE DIRECTOR  
REGENERATION AND  
ECONOMIC DEVELOPMENT  
DURHAM COUNTY COUNCIL  
COUNTY HALL  
DURHAM DH1 5UQ

**The County Council  
of Durham  
Public Rights of Way  
Modification Order  
No 2 (Public Footpath  
No. 77 Consett) 2015**

Footpath to be added to  
the Definitive Map and  
Statement  
- - - - -

Scale 1: 1,000

Public Rights of Way /  
Highways not affected by  
the proposal

- - - - - Footpath
- | - | - | - | Bridleway
- Λ V V V Byway
- Λ ^ Λ ^ Adopted Highway

Drawn: 20 May 2015

Postcode: NE39 1HD

*Neil Taylor*

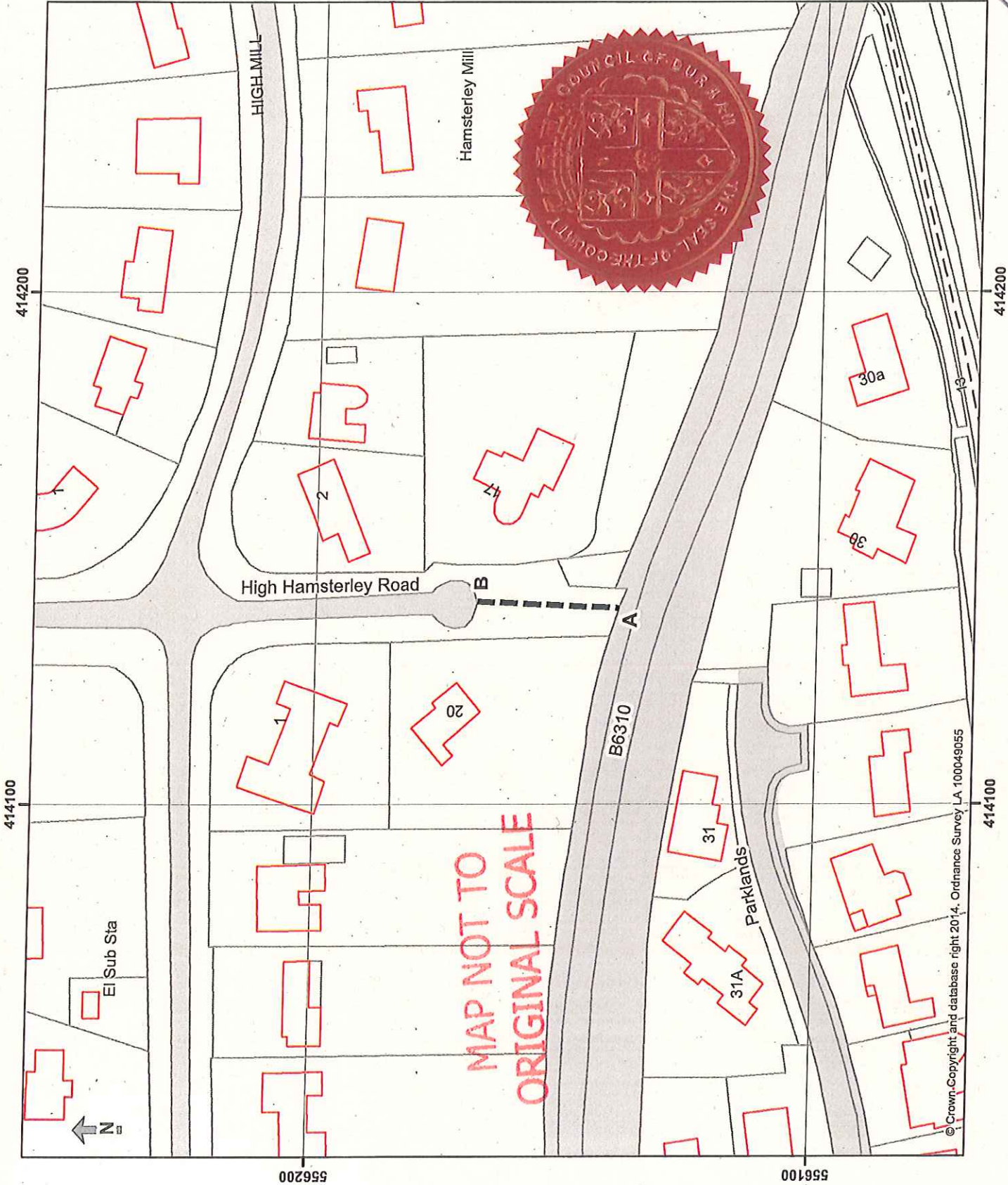

© Crown Copyright and database right 2014. Ordnance Survey LA 100049055