

PUBLIC PATH STOPPING UP ORDER

TOWN AND COUNTRY PLANNING ACT 1990, SECTION 257

**THE COUNTY COUNCIL OF DURHAM
(UNREGISTERED FOOTPATHS AT WILLOWTREE AVENUE, BELMONT PARISH)
PUBLIC PATH STOPPING UP ORDER 2015**

This Order is made by The County Council of Durham ("the Authority") under Section 257 of the Town and Country Planning Act 1990 ("the Act"), because it is satisfied that it is necessary to stop up the public footpaths to which this Order relates in order to enable development to be carried out in accordance with planning permission sought under Part III of the Town and Country Planning Act 1990 namely the construction of a residential development.

BY THIS ORDER:

1. The public footpaths over the land shown by a bold line on the attached map and described in Part 1 to the Schedule of this Order ("the Schedule") shall be stopped up.
2. The stopping up of the footpaths shall have effect on the confirmation of this order.
3. Where immediately before the date on which the footpaths are diverted if there are any apparatus under, in, on, over, along, across it belonging to statutory undertakers for the purpose of carrying on their undertaking, then, the undertakers shall continue to have the same rights in respect of the apparatus as they had then.

SCHEDULE

PART 1

Description of site of existing path or way

<u>No. of Path</u>	<u>Position</u>
Unregistered Footpaths at Willowtree Avenue Belmont Parish (entire width)	Unregistered Footpath commencing from a point on Public Footpath No 5 Belmont, south of the A690 slip-road, grid reference 429156.543756 (point A on the plan) then in a generally south south westerly direction for a distance of some 58 metres to grid reference 429134.543702 (point B on the plan) then in a southerly direction for some 36 metres to a point north west of No. 82 Willowtree Avenue, grid reference 429136.543666 (point C on the plan) (A – B – C)

And Unregistered Footpath commencing from a point on Willowtree Avenue, opposite No. 1 The Paddock, grid reference 429257.543654 (point D on plan) then in a generally westerly direction for some 126 metres to a point north west of No. 82 Willowtree Avenue, grid reference 429139.543665 (point E on plan) (D - E).

GIVEN UNDER THE COMMON SEAL)
OF THE COUNTY COUNCIL OF DURHAM)
ON THE 5th DAY OF FEBRUARY 2015)



Patricia Hordley
.....
Authorised Sealing Officer

543800

543700

543600

429100

429200

429300

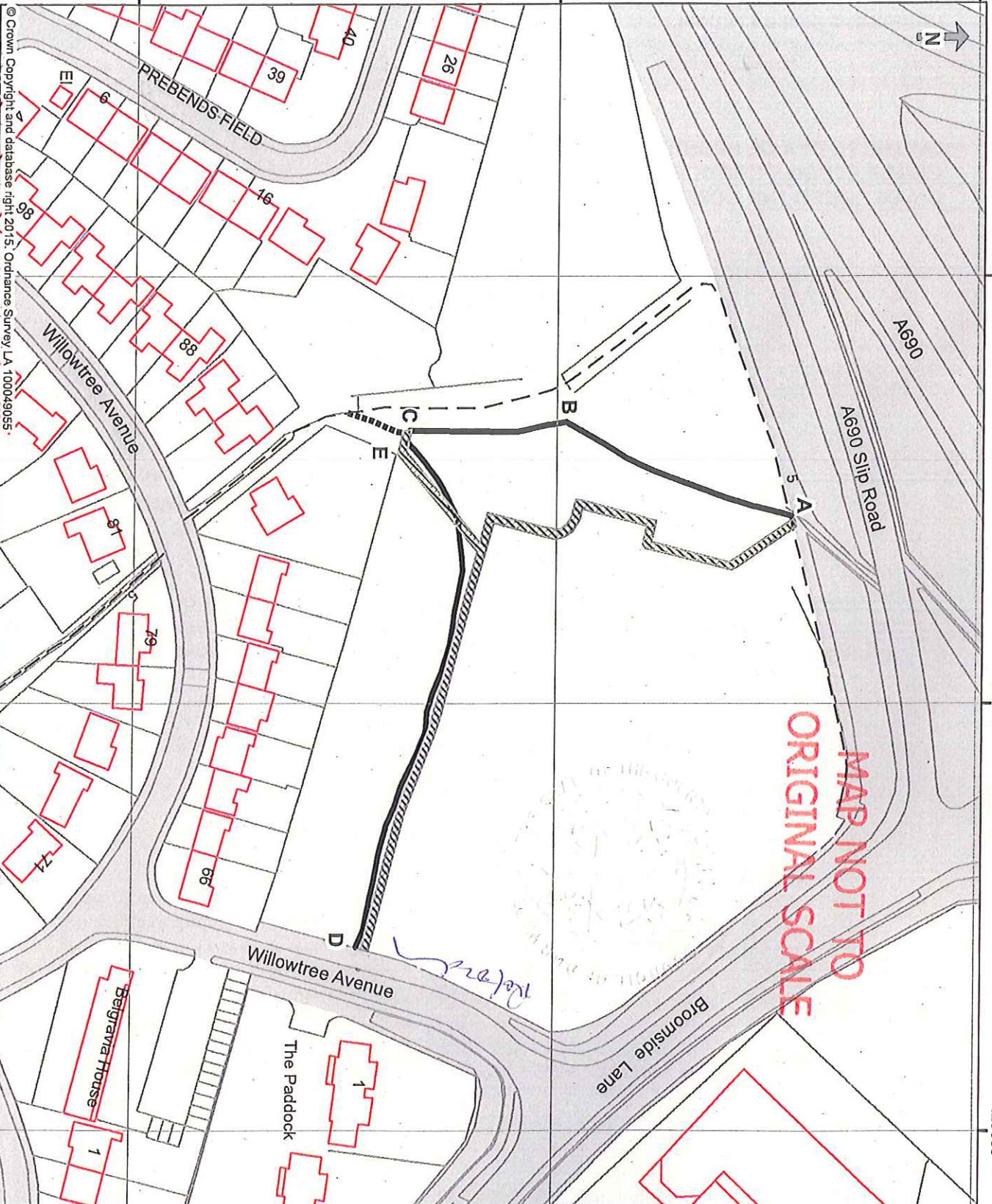

© Crown Copyright and database right 2015. Ordnance Survey LA 100043055

429100

429200

429300



IAN THOMPSON
CORPORATE DIRECTOR
REGENERATION AND
ECONOMIC DEVELOPMENT
DURHAM COUNTY COUNCIL
COUNTY HALL
DURHAM DH1 5UA

The County Council of
Durham (Unregistered
footpaths at Willowtree
Avenue, Belmont Parish)
Public Path Stopping Up
Order 2015

Footpaths to be extinguished
Adopted footpaths to
be created

Scale 1: 1,250

Public Rights of Way /
Highways not affected by
the proposal

--- Footpath

--- Adopted
Highway

----- Unregistered
Path to be
retained

Drawn: 21 January 2015

Postcode: DH1 1DZ
DH1 1HH