

HIGH SPEED RAIL (LONDON – WEST MIDLANDS) ACT 2017

HIGH SPEED RAIL (LONDON – WEST MIDLANDS) GENERAL VESTING DECLARATION No. 820

This **GENERAL VESTING DECLARATION** is executed on
by the Secretary of State for Transport (“the Acquiring Authority”).

12 JANUARY 2022

WHEREAS:

- (1) On 23 February 2017 the High Speed Rail (London – West Midlands) Act 2017 (“the High Speed Rail Act”) received Royal Assent authorising the Acquiring Authority to acquire the land specified in the Schedule hereto.
- (2) Section 4(1) of the High Speed Rail Act authorises the Acquiring Authority to acquire compulsorily so much of the land within the limits of the High Speed Rail Act as may be required for Phase One purposes¹.
- (3) Section 4(4) of the High Speed Rail Act provides that the Compulsory Purchase (Vesting Declarations) Act 1981 (“the 1981 Act”) applies as if the High Speed Rail Act were a compulsory purchase order and paragraph 3² of Schedule 6 to the High Speed Rail Act provides that the 1981 Act shall have effect subject to the modifications specified in that paragraph.
- (4) Notice pursuant to section 3A³ of the 1981 Act was first published on 03 December 2021. That notice included the particulars specified in section 3A(3) of the 1981 Act.
- (5) By paragraph 4(2) of Schedule 6 to the High Speed Rail Act, Parts 2 and 3 of Schedule 2 to the Acquisition of Land Act 1981 (exception of minerals from compulsory purchase and regulation of working of mines and minerals underlying an authorised undertaking) have effect in relation to land to which Section 4(1) of the High Speed Rail Act applies as if it were comprised in a compulsory purchase order providing for the incorporation with that Order of those Parts of that Schedule.
- (6) Paragraph 2(1) of Part 2 of Schedule 2 to the Acquisition of Land Act 1981 provides that an acquiring authority⁴ shall not be entitled to any mines under the land comprised in the compulsory purchase order unless they have been expressly purchased, and all mines under the land are to be deemed to be excepted out of the conveyance of that land unless expressly named and conveyed. Paragraph 3 of Part 3 of Schedule 2 to the Acquisition of Land Act 1981 makes provision where the owner of any mines or minerals in the land desires to work them.

1 Phase One Purposes has meaning given by section 67 of the High Speed Rail Act.

2 Paragraph 3 as substituted by section 11 of, and paragraph 6 of Schedule 14 to, the High Speed Rail Act.

3 Section 3A of the 1981 Act as inserted by paragraph 3(a) of Schedule 6 to the High Speed Rail Act as substituted by section 11 of, and paragraphs 6 and 7 of Schedule 14 to, that Act.

4 Paragraph 4(3) of Schedule 6 to the High Speed Rail Act provides for Parts 2 and 3 of the Acquisition of Land Act 1981 to have effect as if references to the acquiring authority were to the Nominated Undertaker appointed under section 45(1) of the High Speed Rail Act.

- (7) It is expedient that such mines and minerals should be vested in the Acquiring Authority and the Acquiring Authority is to expressly purchase the Land and the freehold mines and minerals comprised in the Land, together with the right to take possession of the mines and minerals, to win and work them and all related ancillary rights.

NOW THIS DEED WITNESSETH that, in exercise of the powers conferred on it by section 4 of the 1981 Act, the Acquiring Authority hereby declares:-

1. The Land and the freehold mines and minerals comprised in the Land described in the Schedule hereto (being part of the land authorised to be acquired by the High Speed Rail Act) and more particularly delineated and shown coloured pink on the plan annexed hereto, together with the right to enter upon and take possession of the land and mines and minerals, to win and work such mines and minerals and all related ancillary rights comprised therein⁵, shall vest in the Acquiring Authority as from the end of the period of 3 months from the date on which the service of notices required by section 6⁶ of the 1981 Act is completed.

For the purposes of Section 2(2) of the 1981 Act, the specified period in relation to the land comprised in this declaration is one year and one day.

5 Paragraph 4(2) of Schedule 6 to the High Speed Rail Act applies Parts 2 and 3 of Schedule 2 to the Acquisition of Land Act 1981 (exception of minerals from compulsory purchase and regulation of working of mines or minerals underlying and authorised undertaking) to land to which Section 4(1) of the High Speed Rail Act applies, as if it were comprised in a compulsory purchase order providing for the incorporation with that Order of those Parts of that Schedule.

6 Section 6 as modified by paragraph 3(c) of Schedule 6 to the High Speed Rail Act, as substituted by section 11 of, and paragraph 6 of Schedule 14 to, that Act.

SCHEDULE

Buckinghamshire

(1) Plot No.	(2) Description
66027	All those interests in 1598.5 square metres, or thereabouts, of railway, works and land, and sidings (Aylesbury Link) including all those mines and minerals beneath being part of HM land Registry title number BM365443 and unregistered land
66029	All those interests in 160.3 square metres, or thereabouts, of woodland and electricity substation (Calvert Landfill Site) including all those mines and minerals beneath being part of HM land Registry title numbers BM434523 and BM232086
66030	All those interests in 2457.5 square metres, or thereabouts, of access track and verge (Pond Farm) including all those mines and minerals beneath being part of HM land Registry title numbers BM311209 and BM312239
66037	All those interests in 474.8 square metres, or thereabouts, of bridge carrying public road and footway (Werner Terrace) over railway, works and land (Aylesbury Link) including all those mines and minerals beneath being part of unregistered land
66038	All those interests in 19013.5 square metres, or thereabouts, of agricultural land, hedgerow, building and ponds (Pond Farm) including all those mines and minerals beneath being part of HM land Registry title number BM311209
66039	All those interests in 3765.4 square metres, or thereabouts, of public road and verges (Werner Terrace) including all those mines and minerals beneath being part of unregistered land
69217	All those interests in 7220.2 square metres, or thereabouts, of woodland, electricity substation and public bridleway (SCL/18/1) (Calvert Landfill Site) including all those mines and minerals beneath being part of HM land Registry title numbers BM434523 and BM232086
70134	All those interests in 15987.4 square metres, or thereabouts, of railway, works and land, access track and woodland (Aylesbury Link) including all those mines and minerals beneath being part of unregistered land
70135	All those interests in 516.2 square metres, or thereabouts, of woodland (Calvert Landfill Site) including all those mines and minerals beneath being part of HM land Registry title numbers BM232086 and BM434523
70136	All those interests in 755.0 square metres, or thereabouts, of public road, verges and access splay (Werner Terrace) including all those mines and minerals beneath being part of unregistered land
70141	All those interests in 1.2 square metres, or thereabouts, of verge (Werner Terrace) including all those mines and minerals beneath being part of unregistered land
71172	All those interests in 61179.4 square metres, or thereabouts, of agricultural land, woodland and hedgerows (Pond Farm) including all those mines and minerals beneath being part of HM land Registry title numbers BM311209 and BM312239
71173	All those interests in 1944.0 square metres, or thereabouts, of woodland, hardstanding and public bridleway (SCL/18/1) (Calvert Landfill Site) including all those mines and minerals beneath being part of HM land Registry title numbers BM434523 and BM232086
71178	All those interests in 11.6 square metres, or thereabouts, of railway, works

	and land (Aylesbury Link) including all those mines and minerals beneath being part of unregistered land
71179	All those interests in 1518.9 square metres, or thereabouts, of access road and public bridleway (SCL/18/1) (Calvert Landfill Site) including all those mines and minerals beneath being part of HM land Registry title numbers BM434523 and BM232086
71180	All those interests in 5.7 square metres, or thereabouts, of verge (Aylesbury Link) including all those mines and minerals beneath being part of HM land Registry title numbers BM434523 and BM232086
71183	All those interests in 1370.5 square metres, or thereabouts, of grassland, woodland, access road and public bridleway (SCL/18/1) (Calvert Landfill Sites) including all those mines and minerals beneath being part of HM land Registry title numbers BM434523 and BM232086

IN WITNESS WHEREOF the Secretary of State for Transport has hereunto set its corporate seal on the day in the year first written above.

The **CORPORATE SEAL** of the SECRETARY OF STATE FOR TRANSPORT hereunto affixed to this deed is authenticated by



.....

Authorised Signatory

Dated: 12 JANUARY 2022

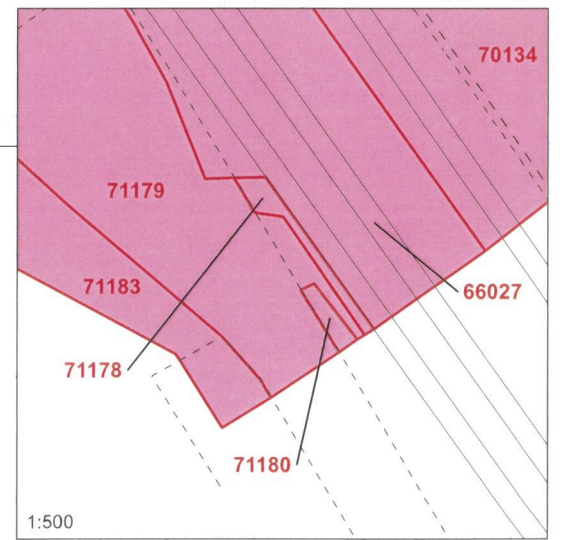
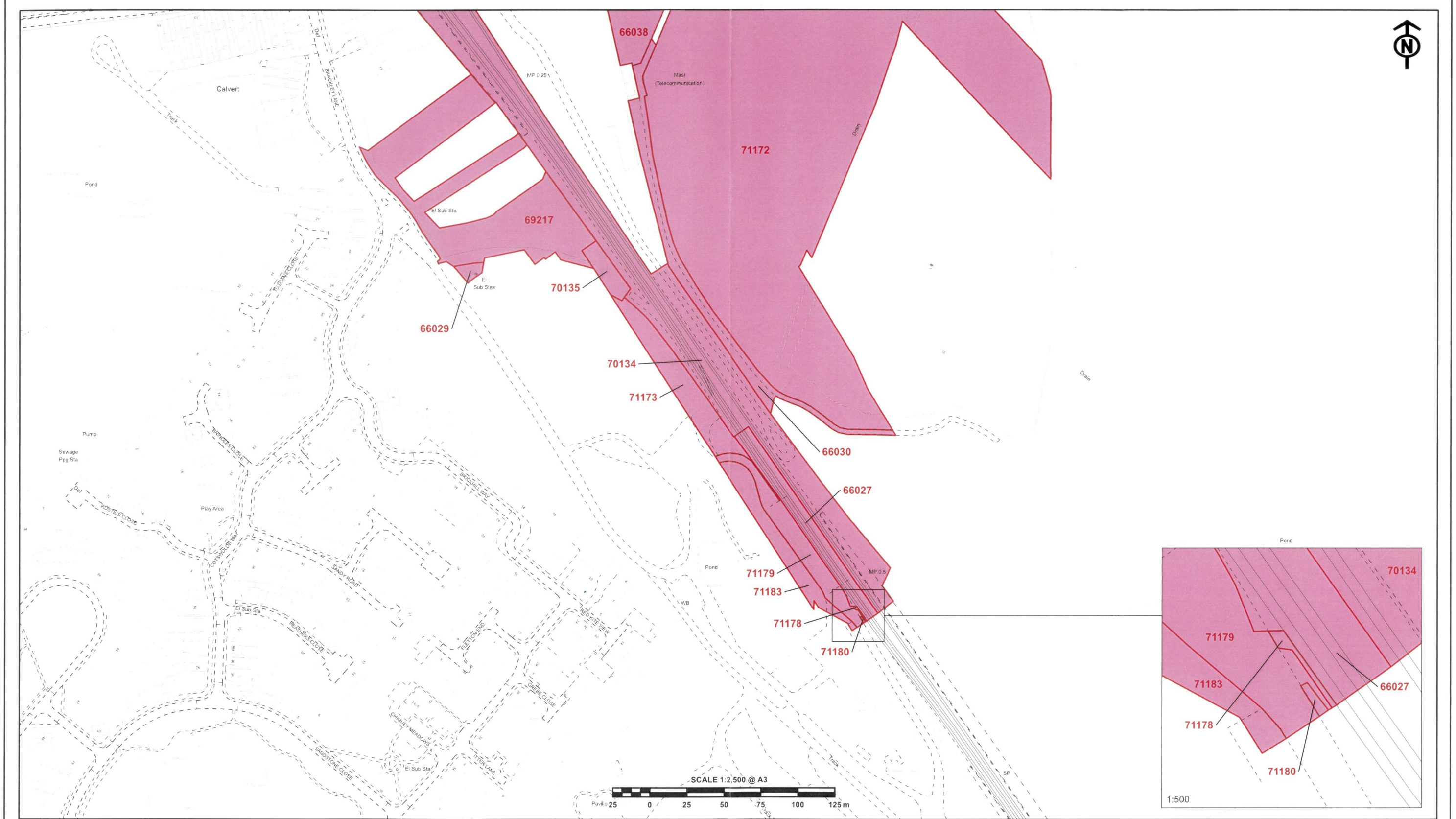

SEAL REF
DFT GP / 1013



The CORPORATE SEAL of the
 SECRETARY OF STATE
 hereunto affixed to this deed
 is authenticated by

[Signature]
 Authorised by the Secretary of State for Transport

Dated 12 JANUARY 2022



1013

CENTRE POINT: 469,066, 224,389

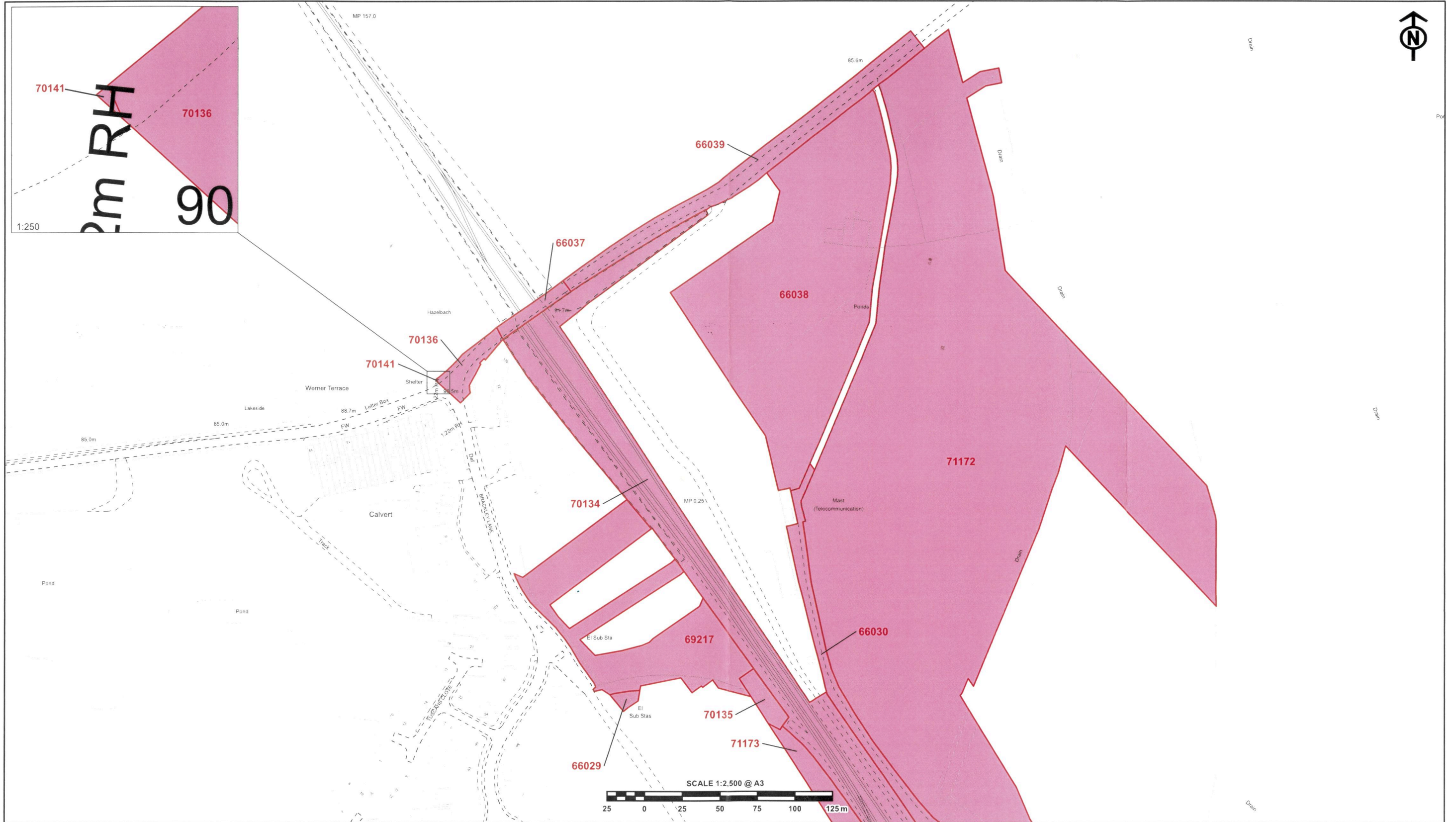

The CORPORATE SEAL of the
SECRETARY OF STATE
hereunto affixed to this deed
is authenticated by

Authorised by the Secretary of State for Transport

Dated 12 JANUARY 2022

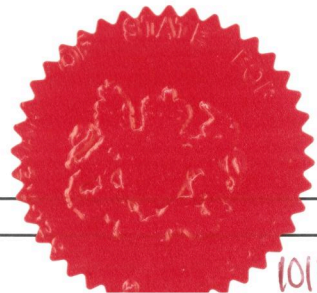

1013

CENTRE POINT: 468,957, 224,676