

HIGH SPEED RAIL (LONDON – WEST MIDLANDS) ACT 2017

HIGH SPEED RAIL (LONDON – WEST MIDLANDS) GENERAL VESTING DECLARATION No. 521

This **GENERAL VESTING DECLARATION** is executed on
by the Secretary of State for Transport (“the Authority”).

2 JULY 2021

WHEREAS:

- (1) On 23 February 2017 the High Speed Rail (London – West Midlands) Act 2017 (“the High Speed Rail Act”) received Royal Assent authorising the Authority to acquire the land specified in the Schedule hereto.
- (2) Section 4(1) of the High Speed Rail Act authorises the Authority to acquire compulsorily so much of the land within the limits of the High Speed Rail Act as may be required for Phase One purposes¹.
- (3) Section 8 of the High Speed Rail Act provides that the power under section 4(1) in relation to land may be exercised in relation to the subsoil or under-surface of the land only.
- (4) Section 4(4) of the High Speed Rail Act provides that the Compulsory Purchase (Vesting Declarations) Act 1981 (“the 1981 Act”) applies as if the High Speed Rail Act were a compulsory purchase order and paragraph 3² of Schedule 6 to the High Speed Rail Act provides that the 1981 Act shall have effect subject to the modifications specified in that paragraph.
- (5) Notice pursuant to section 3A³ of the 1981 Act was first published on 31 March 2021. That notice included the particulars specified in section 3A(3) of the 1981 Act.

NOW THIS DEED WITNESSETH that, in exercise of the powers conferred on it by section 4 of the 1981 Act, the Authority hereby declares:-

1. The land described in the Schedule hereto (being part of the land authorised to be acquired by the High Speed Rail Act) and more particularly delineated and shown coloured yellow on the plan annexed hereto, together with the right to enter upon and take possession of the land, shall vest in the Authority as from the end of the period of 3 months from the date on which the service of notices required by section 6⁴ of the 1981 Act is completed.
2. For the purposes of Section 2(2) of the 1981 Act, the specified period in relation to the land comprised in this declaration is one year and one day.

1 Phase One Purposes has meaning given by section 67 of the High Speed Rail Act

2 Paragraph 3 as substituted by section 11 of, and paragraph 6 of Schedule 14 to, the High Speed Rail Act.

3 Section 3A of the 1981 Act as inserted by paragraph 3(a) of Schedule 6 to the High Speed Rail Act as substituted by section 11 of, and paragraphs 6 and 7 of Schedule 14 to, that Act.

4 Section 6 as modified by paragraph 3(c) of Schedule 6 to the High Speed Rail Act, as substituted by section 11 of, and paragraph 6 of Schedule 14 to, that Act

SCHEDULE

Buckinghamshire

(1) Plot No.	(2) Description
64509	All that stratum of subsoil that lies beneath 1740.6 square metres, or thereabouts, of public road, verges and access splay (Chesham Road) the upper extremity of which is 163.2 metres above Ordnance Survey Datum and the lower extremity of which is 137.9 metres above Ordnance Survey Datum excluding the interests held by the Secretary of State for Transport.
64510	All that stratum of subsoil that lies beneath 2644.9 square metres, or thereabouts, of agricultural land (Middle Grove Farm) the upper extremity of which is 161.8 metres above Ordnance Survey Datum and the lower extremity of which is 138.3 metres above Ordnance Survey Datum.
64512	All that stratum of subsoil that lies beneath 255.1 square metres, or thereabouts, of agricultural land (Kings Lane) the upper extremity of which is 162.7 metres above Ordnance Survey Datum and the lower extremity of which is 141.7 metres above Ordnance Survey Datum.
64522	All that stratum of subsoil that lies beneath 451.2 square metres, or thereabouts, of public road and verges (Frith Hill) the upper extremity of which is 178.5 metres above Ordnance Survey Datum and the lower extremity of which is 158.1 metres above Ordnance Survey Datum excluding the interests held by the Secretary of State for Transport.
64523	All that stratum of subsoil that lies beneath 1185.3 square metres, or thereabouts, of house, hardstanding, garden and outbuilding (Frith Hill) the upper extremity of which is 179.4 metres above Ordnance Survey Datum and the lower extremity of which is 158.4 metres above Ordnance Survey Datum excluding the interests held by the Secretary of State for Transport.
67075	All that stratum of subsoil that lies beneath 396.4 square metres, or thereabouts, of verge (Chesham Road) the upper extremity of which is 159.3 metres above Ordnance Survey Datum and the lower extremity of which is 138.1 metres above Ordnance Survey Datum.
67076	All that stratum of subsoil that lies beneath 41.4 square metres, or thereabouts, of public road and verge (Kings Lane) the upper extremity of which is 159.7 metres above Ordnance Survey Datum and the lower extremity of which is 139.4 metres above Ordnance Survey Datum.
68387	All that stratum of subsoil that lies beneath 272.1 square metres, or thereabouts, of garden (Chiltern Cottage) the upper extremity of which is 178.2 metres above Ordnance Survey Datum and the lower extremity of which is 157.9 metres above Ordnance Survey Datum excluding the interests held by the Secretary of State for Transport.
68388	All that stratum of subsoil that lies beneath 9262.7 square metres, or thereabouts, of agricultural land, hedgerow and hardstanding (Elwis Field Farm) the upper extremity of which is 178.1 metres above Ordnance Survey Datum and the lower extremity of which is 151.9 metres above Ordnance Survey Datum excluding the interests held by the Secretary of State for Transport.
68389	All that stratum of subsoil that lies beneath 1854.8 square metres, or thereabouts, of agricultural land and woodland (Elwis Field Farm) the upper extremity of which is 172.4 metres above Ordnance Survey Datum and the lower extremity of which is 150 metres above Ordnance Survey Datum excluding the interests held by the Secretary of State for Transport.
68392	All that stratum of subsoil that lies beneath 8941.6 square metres, or thereabouts, of agricultural land, access tracks carrying public footpaths (GMI/28/1, GMI/79/1 and GMI/80/1) and woodland (Sibley's Coppice) the

	upper extremity of which is 171.9 metres above Ordnance Survey Datum and the lower extremity of which is 145.4 metres above Ordnance Survey Datum excluding the interests held by the Secretary of State for Transport.
68932	All that stratum of subsoil that lies beneath 689.3 square metres, or thereabouts, of house, garden and hardstanding (Wenash) the upper extremity of which is 164.4 metres above Ordnance Survey Datum and the lower extremity of which is 143.3 metres above Ordnance Survey Datum excluding the interests held by the Secretary of State for Transport.
68933	All that stratum of subsoil that lies beneath 725.7 square metres, or thereabouts, of agricultural land (Cudsden Farm House) the upper extremity of which is 161.2 metres above Ordnance Survey Datum and the lower extremity of which is 139.6 metres above Ordnance Survey Datum excluding the interests held by the Secretary of State for Transport.
68934	All that stratum of subsoil that lies beneath 1816.4 square metres, or thereabouts, of agricultural land (Kings Lane) the upper extremity of which is 165.4 metres above Ordnance Survey Datum and the lower extremity of which is 143.1 metres above Ordnance Survey Datum excluding the interests held by the Secretary of State for Transport.
68935	All that stratum of subsoil that lies beneath 2712.7 square metres, or thereabouts, of agricultural land, house, buildings, garden, hardstanding and hedgerows (Cudsden Farm House) the upper extremity of which is 163.8 metres above Ordnance Survey Datum and the lower extremity of which is 141.1 metres above Ordnance Survey Datum excluding the interests held by the Secretary of State for Transport.
68936	All that stratum of subsoil that lies beneath 1029.8 square metres, or thereabouts, of buildings, garden, woodland, hedgerows, hardstanding and public footpath (GMI/28/1) (Woodside Cottage) the upper extremity of which is 165.9 metres above Ordnance Survey Datum and the lower extremity of which is 144.1 metres above Ordnance Survey Datum excluding the interests held by the Secretary of State for Transport.

IN WITNESS WHEREOF the Secretary of State for Transport has hereunto set its corporate seal on the day in the year first written above.

The **CORPORATE SEAL** of the SECRETARY OF STATE FOR TRANSPORT hereunto affixed to this deed is authenticated by



.....

Authorised Signatory

Dated: 2 JULY 2021

SEAL REF
DFT GP / 0871

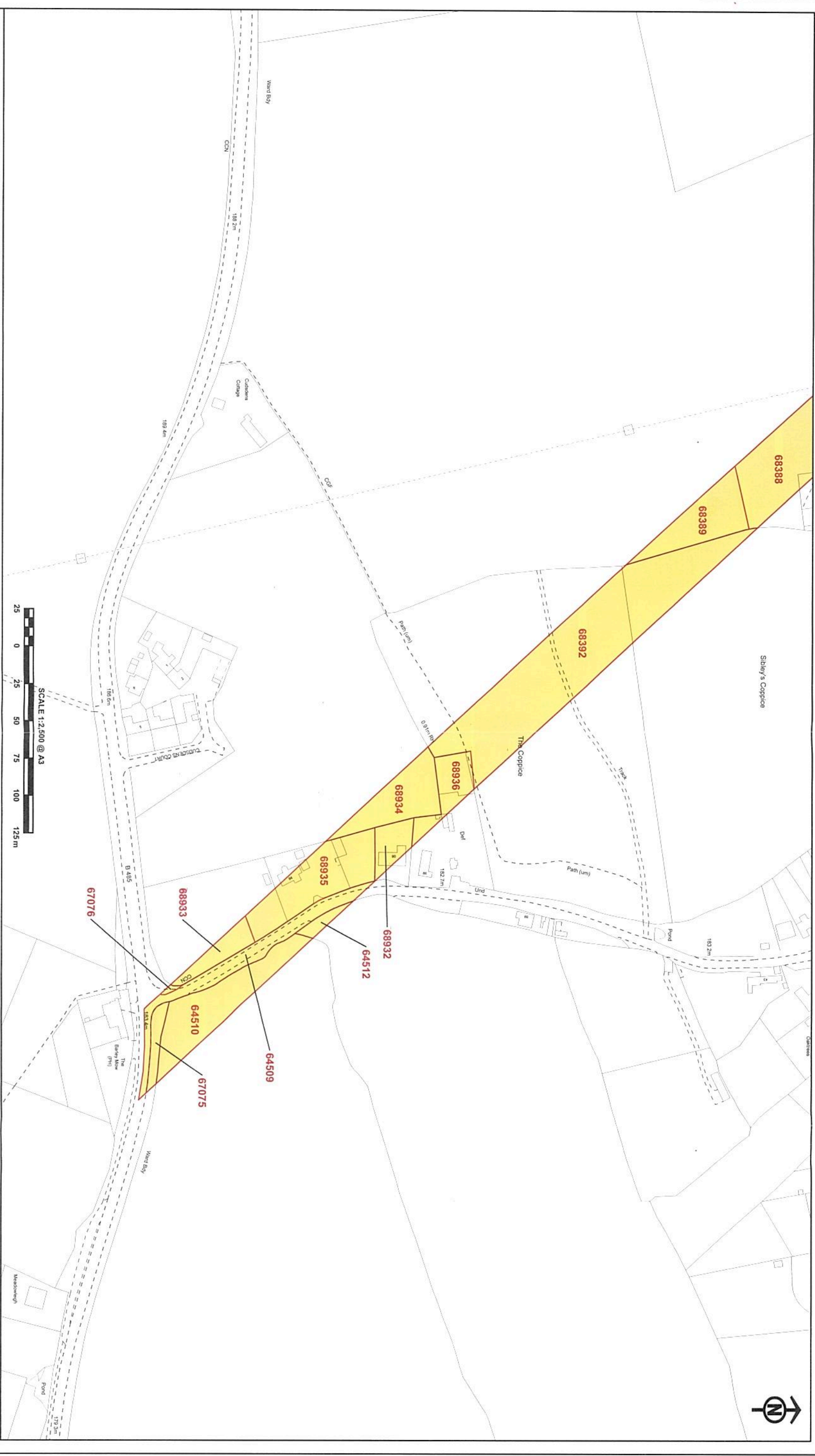



The CORPORATE SEAL of the
SECRETARY OF STATE
hereunto affixed to this deed
is authenticated by

Authorised by the Secretary of State for Transport

Dated 2 JULY 2021



0579

© Crown Copyright and Database Right 2021, Ordnance Survey, London, Nippon, 10294196
© Crown Copyright and Database Right 2021, Ordnance Survey, London, Nippon, 10294196
All other rights reserved. Reproduction in any form without the permission of the Controller of Her Majesty's Stationery Office is prohibited.

Registered in England & Wales: 02031488
Registered office: 2 South, Snow Hill, Queensway, Birmingham B4 6QA

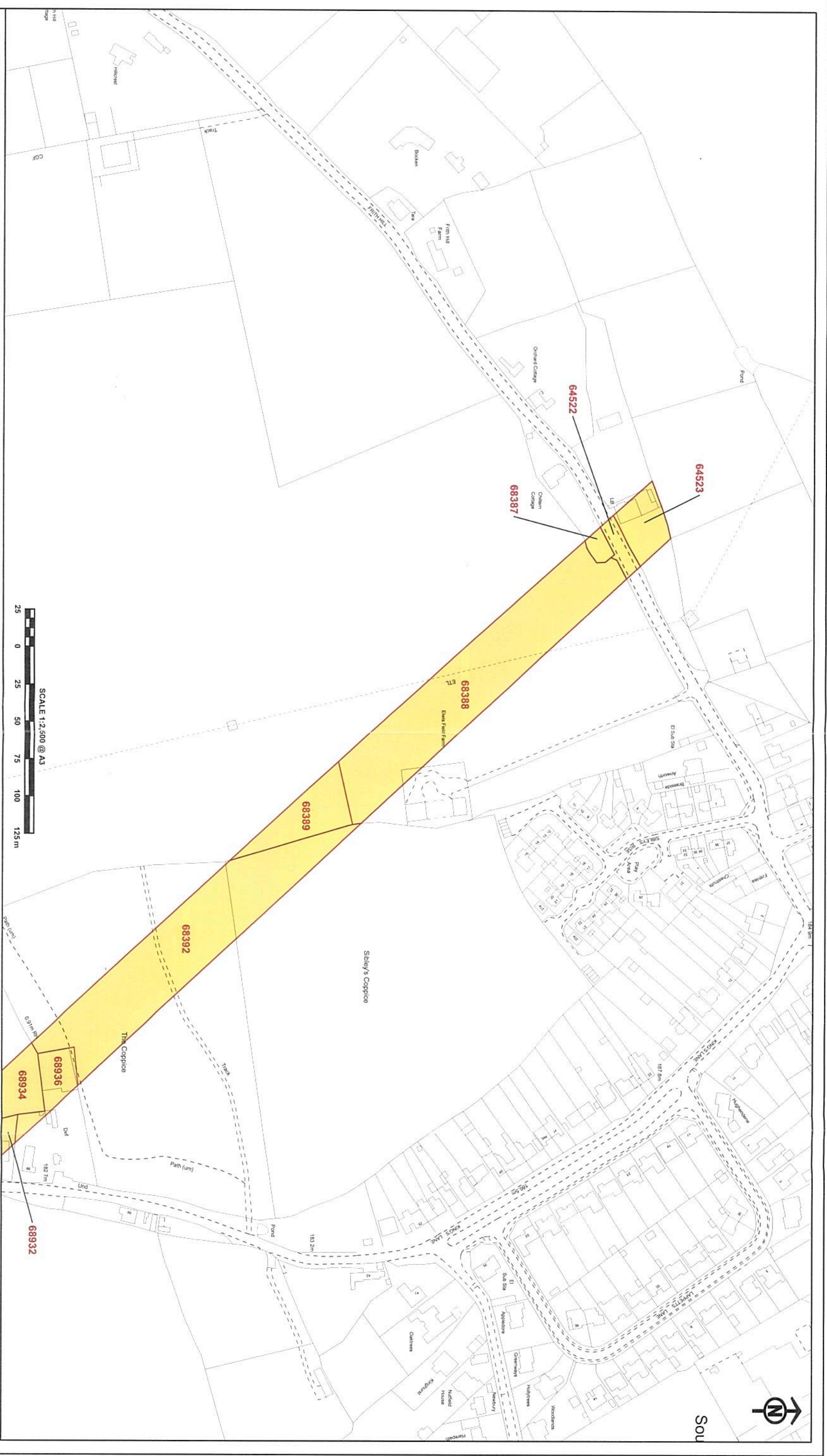

The CORPORATE SEAL of the
SECRETARY OF STATE
hereunto affixed to this deed
is authenticated by

Authorised by the Secretary of State for Transport

Dated 2 Sept 2021



0599

© Crown Copyright and Aerodrome 1974, 2020. Ordnance Survey (OS Licence) 100049190
© Crown copyright material is reproduced with the permission of Land Registry under
designated authority from the Controller of HMSO and the Crown Copyright Ordnance Survey

