

## HIGH SPEED RAIL (LONDON – WEST MIDLANDS) ACT 2017

### HIGH SPEED RAIL (LONDON – WEST MIDLANDS) GENERAL VESTING DECLARATION No. 487

This **GENERAL VESTING DECLARATION** is executed on  
by the Secretary of State for Transport ("the Authority"). 23<sup>rd</sup> March 2021

#### WHEREAS:

- (1) On 23 February 2017 the High Speed Rail (London – West Midlands) Act 2017 ("the High Speed Rail Act") received Royal Assent authorising the Authority to acquire the land specified in the Schedule hereto.
- (2) Section 4(1) of the High Speed Rail Act authorises the Authority to acquire compulsorily so much of the land within the limits of the High Speed Rail Act as may be required for Phase One purposes<sup>1</sup>.
- (3) Section 8 of the High Speed Rail Act provides that the power under section 4(1) in relation to land may be exercised in relation to the subsoil or under-surface of the land only.
- (4) Section 4(4) of the High Speed Rail Act provides that the Compulsory Purchase (Vesting Declarations) Act 1981 ("the 1981 Act") applies as if the High Speed Rail Act were a compulsory purchase order and paragraph 3<sup>2</sup> of Schedule 6 to the High Speed Rail Act provides that the 1981 Act shall have effect subject to the modifications specified in that paragraph.
- (5) Notice pursuant to section 3A<sup>3</sup> of the 1981 Act was first published on 11 February 2021. That notice included the particulars specified in section 3A(3) of the 1981 Act.

**NOW THIS DEED WITNESSETH** that, in exercise of the powers conferred on it by section 4 of the 1981 Act, the Authority hereby declares:-

1. The land described in the Schedule hereto (being part of the land authorised to be acquired by the High Speed Rail Act) and more particularly delineated and shown coloured yellow on the plan annexed hereto, together with the right to enter upon and take possession of the land, shall vest in the Authority as from the end of the period of 3 months from the date on which the service of notices required by section 6<sup>4</sup> of the 1981 Act is completed.
2. For the purposes of Section 2(2) of the 1981 Act, the specified period in relation to the land comprised in this declaration is one year and one day.

---

1 Phase One Purposes has meaning given by section 67 of the High Speed Rail Act

2 Paragraph 3 as substituted by section 11 of, and paragraph 6 of Schedule 14 to, the High Speed Rail Act.

3 Section 3A of the 1981 Act as inserted by paragraph 3(a) of Schedule 6 to the High Speed Rail Act as substituted by section 11 of, and paragraphs 6 and 7 of Schedule 14 to, that Act.

4 Section 6 as modified by paragraph 3(c) of Schedule 6 to the High Speed Rail Act, as substituted by section 11 of, and paragraph 6 of Schedule 14 to, that Act

## SCHEDULE

Buckinghamshire

(1) Plot No.	(2) Description
64418	All that stratum of subsoil that lies beneath 14.5 square metres, or thereabouts, of footway (High Street) the upper extremity of which is 58.9 metres above Ordnance Survey Datum and the lower extremity of which is 39.0 metres above Ordnance Survey Datum.
64419	All that stratum of subsoil that lies beneath 208.0 square metres, or thereabouts, of public road, footway and verge (High Street) the upper extremity of which is 58.9 metres above Ordnance Survey Datum and the lower extremity of which is 38.9 metres above Ordnance Survey Datum.
64420	All that stratum of subsoil that lies beneath 12.7 square metres, or thereabouts, of footway (High Street) the upper extremity of which is 59.0 metres above Ordnance Survey Datum and the lower extremity of which is 39.0 metres above Ordnance Survey Datum.
64421	All that stratum of subsoil that lies beneath 44.7 square metres, or thereabouts, of hardstanding and building (12 High Street) the upper extremity of which is 59.1 metres above Ordnance Survey Datum and the lower extremity of which is 39.1 metres above Ordnance Survey Datum.
64422	All that stratum of subsoil that lies beneath 311.5 square metres, or thereabouts, of building and hardstanding (12 High Street) the upper extremity of which is 59.1 metres above Ordnance Survey Datum and the lower extremity of which is 39.0 metres above Ordnance Survey Datum.
64423	All that stratum of subsoil that lies beneath 182.9 square metres, or thereabouts, of hardstanding (12 High Street) the upper extremity of which is 59.2 metres above Ordnance Survey Datum and the lower extremity of which is 39.2 metres above Ordnance Survey Datum.
64424	All that stratum of subsoil that lies beneath 15.1 square metres, or thereabouts, of public road and footway (Pheasant Hill) above river, bed and banks thereof (River Misbourne) the upper extremity of which is 58.9 metres above Ordnance Survey Datum and the lower extremity of which is 38.9 metres above Ordnance Survey Datum.
64425	All that stratum of subsoil that lies beneath 37.0 square metres, or thereabouts, of public road and footway (Pheasant Hill) the upper extremity of which is 58.9 metres above Ordnance Survey Datum and the lower extremity of which is 38.9 metres above Ordnance Survey Datum.
64426	All that stratum of subsoil that lies beneath 10.0 square metres, or thereabouts, of woodland (The Stone, Pheasant Hill) the upper extremity of which is 58.9 metres above Ordnance Survey Datum and the lower extremity of which is 39.0 metres above Ordnance Survey Datum.
64427	All that stratum of subsoil that lies beneath 19.1 square metres, or thereabouts, of river, bed and banks thereof (River Misbourne) the upper extremity of which is 58.9 metres above Ordnance Survey Datum and the lower extremity of which is 39.0 metres above Ordnance Survey Datum.
64428	All that stratum of subsoil that lies beneath 735.7 square metres, or thereabouts, of house, hardstanding and garden (Stone Cottage) the upper extremity of which is 59.2 metres above Ordnance Survey Datum and the lower extremity of which is 39.0 metres above Ordnance Survey Datum.
64429	All that stratum of subsoil that lies beneath 1917.7 square metres, or thereabouts, of car park, access road, footways and verges (High Street) the upper extremity of which is 59.5 metres above Ordnance Survey Datum and the lower extremity of which is 39.0 metres above Ordnance Survey Datum.

64430	All that stratum of subsoil that lies beneath 39.7 square metres, or thereabouts, of garden (Home Field House, Stratton Chase Drive) the upper extremity of which is 60.0 metres above Ordnance Survey Datum and the lower extremity of which is 40.0 metres above Ordnance Survey Datum.
64431	All that stratum of subsoil that lies beneath 10050.1 square metres, or thereabouts, of agricultural land (Stratton Chase Drive) the upper extremity of which is 61.1 metres above Ordnance Survey Datum and the lower extremity of which is 39.4 metres above Ordnance Survey Datum.
64432	All that stratum of subsoil that lies beneath 2589.5 square metres, or thereabouts, of woodland, verge and public footpath (CSG/30/5) (Stratton Chase Drive) the upper extremity of which is 61.3 metres above Ordnance Survey Datum and the lower extremity of which is 40.7 metres above Ordnance Survey Datum.
64433	All that stratum of subsoil that lies beneath 4589.4 square metres, or thereabouts, of grassland and hedgerow (Millbrook, Mill Lane) the upper extremity of which is 62.3 metres above Ordnance Survey Datum and the lower extremity of which is 41.3 metres above Ordnance Survey Datum.
64435	All that stratum of subsoil that lies beneath 4144.1 square metres, or thereabouts, of grassland, garden, house, outbuilding, hardstanding and hedgerow (Sorrett, Mill Lane) the upper extremity of which is 63.4 metres above Ordnance Survey Datum and the lower extremity of which is 42.0 metres above Ordnance Survey Datum.
64436	All that stratum of subsoil that lies beneath 668.8 square metres, or thereabouts, of garden, woodland and house (Fieldfare, Mill Lane) the upper extremity of which is 62.8 metres above Ordnance Survey Datum and the lower extremity of which is 42.3 metres above Ordnance Survey Datum.
64437	All that stratum of subsoil that lies beneath 1561.2 square metres, or thereabouts, of house, hardstanding, garden, access splay and verges (The Garden House, Mill Lane) the upper extremity of which is 63.6 metres above Ordnance Survey Datum and the lower extremity of which is 42.7 metres above Ordnance Survey Datum.
67205	All that stratum of subsoil that lies beneath 194.7 square metres, or thereabouts, of public road, verge and access splays (Mill Lane) the upper extremity of which is 63.6 metres above Ordnance Survey Datum and the lower extremity of which is 43.5 metres above Ordnance Survey Datum.
67209	All that stratum of subsoil that lies beneath 93.7 square metres, or thereabouts, of verge and access road (High Street) the upper extremity of which is 59.2 metres above Ordnance Survey Datum and the lower extremity of which is 39.1 metres above Ordnance Survey Datum.

**IN WITNESS WHEREOF** the Secretary of State for Transport has hereunto set its corporate seal on the day in the year first written above.

The **CORPORATE SEAL** of the SECRETARY OF STATE FOR TRANSPORT hereunto affixed to this deed is authenticated by

..... 

Authorised Signatory

Dated: 23<sup>rd</sup> March 2021

SEAL REF  
DfT GP / 072





Registered in England, Registration No. 02031916  
Registered Office: 2, Stephenson Way, Birmingham B4 6QA

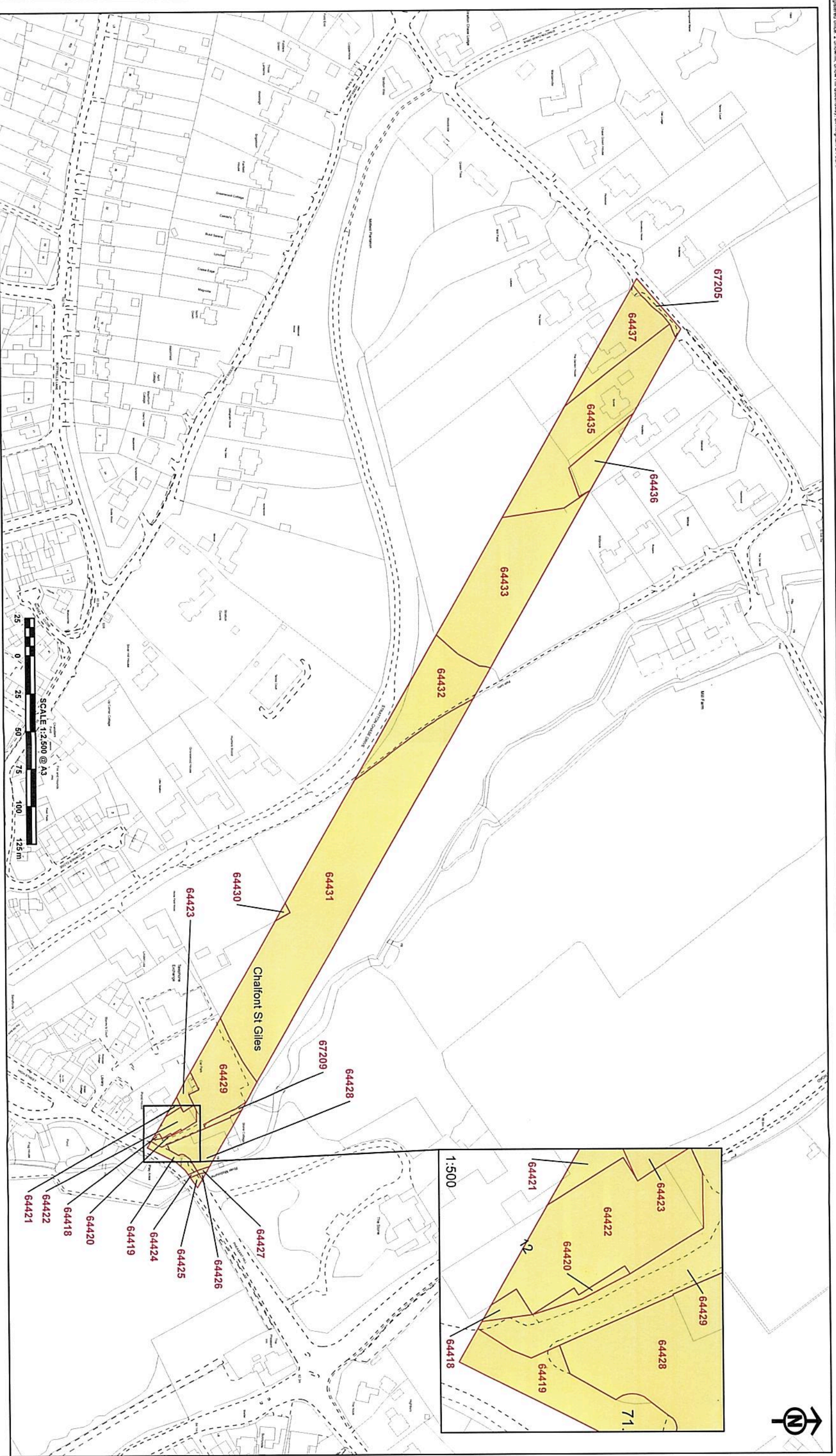

The CORPORATE SEAL of the  
SECRETARY OF STATE  
hereunto affixed to this deed  
is authenticated by

*[Signature]*

Authorised by the Secretary of State for Transport  
Dated 23rd March 2021



0472

© Crown copyright and database right 2020 Ordnance Survey, Licence Number 10004195  
© Crown copyright and database right 2020 Ordnance Survey, Licence Number 10004195  
© Crown copyright and database right 2020 Ordnance Survey, Licence Number 10004195

