

HIGH SPEED RAIL (LONDON – WEST MIDLANDS) ACT 2017

HIGH SPEED RAIL (LONDON – WEST MIDLANDS) GENERAL VESTING DECLARATION No. 564

This **GENERAL VESTING DECLARATION** is executed on 17th September 2021
by the Secretary of State for Transport (“the Authority”).

WHEREAS:

- (1) On 23 February 2017 the High Speed Rail (London – West Midlands) Act 2017 (“the High Speed Rail Act”) received Royal Assent authorising the Authority to acquire the land specified in the Schedule hereto.
- (2) Section 4(1) of the High Speed Rail Act authorises the Authority to acquire compulsorily so much of the land within the limits of the High Speed Rail Act as may be required for Phase One purposes¹.
- (3) Section 8 of the High Speed Rail Act provides that the power under section 4(1) in relation to land may be exercised in relation to the subsoil or under-surface of the land only.
- (4) Section 4(4) of the High Speed Rail Act provides that the Compulsory Purchase (Vesting Declarations) Act 1981 (“the 1981 Act”) applies as if the High Speed Rail Act were a compulsory purchase order and paragraph 3² of Schedule 6 to the High Speed Rail Act provides that the 1981 Act shall have effect subject to the modifications specified in that paragraph.
- (5) Notice pursuant to section 3A³ of the 1981 Act was first published on 25 August 2021. That notice included the particulars specified in section 3A(3) of the 1981 Act.

NOW THIS DEED WITNESSETH that, in exercise of the powers conferred on it by section 4 of the 1981 Act, the Authority hereby declares:-

1. The land described in the Schedule hereto (being part of the land authorised to be acquired by the High Speed Rail Act) and more particularly delineated and shown coloured yellow on the plan annexed hereto, together with the right to enter upon and take possession of the land, shall vest in the Authority as from the end of the period of 4 months from the date on which the service of notices required by section 6⁴ of the 1981 Act is completed.
2. For the purposes of Section 2(2) of the 1981 Act, the specified period in relation to the land comprised in this declaration is one year and one day.

1 Phase One Purposes has meaning given by section 67 of the High Speed Rail Act

2 Paragraph 3 as substituted by section 11 of, and paragraph 6 of Schedule 14 to, the High Speed Rail Act.

3 Section 3A of the 1981 Act as inserted by paragraph 3(a) of Schedule 6 to the High Speed Rail Act as substituted by section 11 of, and paragraphs 6 and 7 of Schedule 14 to, that Act.

4 Section 6 as modified by paragraph 3(c) of Schedule 6 to the High Speed Rail Act, as substituted by section 11 of, and paragraph 6 of Schedule 14 to, that Act

SCHEDULE

London Borough of Camden

(1) Plot No.	(2) Description
08098	All that stratum of subsoil that lies beneath 11265.18 square metres, or thereabouts, of flats, premises, play areas, sports court (Alexandra Road Park), public roads (Langtry Walk and Rowley Way), footbridge, access, footways, car park, parking spaces, hardstanding and land (Ainsworth Estate, Ainsworth Way and Rowley Way), the upper extremity of which is 4.8 metres above Ordnance Survey Datum and the lower extremity of which is 14.9 metres below Ordnance Survey Datum.
08099	All that stratum of subsoil that lies beneath 300.75 square metres, or thereabouts, of building, hardstanding and land (84-86 Abbey Road), the upper extremity of which is 3.5 metres above Ordnance Survey Datum and the lower extremity of which is 14.9 metres below Ordnance Survey Datum.
08100	All that stratum of subsoil that lies beneath 3.50 square metres, or thereabouts, of electricity transformer chamber and land (1A Ainsworth Way), the upper extremity of which is 3.5 metres above Ordnance Survey Datum and the lower extremity of which is 14.8 metres below Ordnance Survey Datum.
08112	All that stratum of subsoil that lies beneath 1742.25 square metres, or thereabouts, of school, premises, underground car park, play ground, access hardstanding and land (Jack Taylor School, 48A Boundary Road), the upper extremity of which is 4.6 metres above Ordnance Survey Datum and the lower extremity of which is 13.9 metres below Ordnance Survey Datum.
08113	All that stratum of subsoil that lies beneath 319.15 square metres, or thereabouts, of flats, gardens, footways, steps and hardstanding (1-46 Robert Morton House, Alexandra Place), the upper extremity of which is 4.8 metres above Ordnance Survey Datum and the lower extremity of which is 13.6 metres below Ordnance Survey Datum.
08114	All that stratum of subsoil that lies beneath 71.60 square metres, or thereabouts, of premises (4 Langtry Walk), the upper extremity of which is 4.9 metres above Ordnance Survey Datum and the lower extremity of which is 13.4 metres below Ordnance Survey Datum.
08115	All that stratum of subsoil that lies beneath 6.09 square metres, or thereabouts, of premises (3 Langtry Walk), the upper extremity of which is 4.9 metres above Ordnance Survey Datum and the lower extremity of which is 13.3 metres below Ordnance Survey Datum.
08117	All that stratum of subsoil that lies beneath 91.79 square metres, or thereabouts, of premises (5 Langtry Walk), the upper extremity of which is 4.9 metres above Ordnance Survey Datum and the lower extremity of which is 13.4 metres below Ordnance Survey Datum.
08118	All that stratum of subsoil that lies beneath 84.56 square metres, or thereabouts, of premises (7 Langtry Walk), the upper extremity of which is 4.9 metres above Ordnance Survey Datum and the lower extremity of which is 13.4 metres below Ordnance Survey Datum.
08122	All that stratum of subsoil that lies beneath 551.23 square metres, or thereabouts, of flats, shops, premises and public footways (1-9 Langtry Walk and 61-63 Loudoun Road), the upper extremity of which is 5.0 metres above Ordnance Survey Datum and the lower extremity of which is 13.4 metres below Ordnance Survey Datum.
08123	All that stratum of subsoil that lies beneath 257.26 square metres, or thereabouts, of railway (West Coast Main Line), works and land, the upper extremity of which is 5.0 metres above Ordnance Survey Datum and the

	lower extremity of which is 13.4 metres below Ordnance Survey Datum, excluding any interests held by Network Rail Infrastructure Limited.
08124	All that stratum of subsoil that lies beneath 1608.97 square metres, or thereabouts, of flats, premises, garden and public footways (9 Langtry Walk), the upper extremity of which is 4.9 metres above Ordnance Survey Datum and the lower extremity of which is 13.6 metres below Ordnance Survey Datum.
08125	All that stratum of subsoil that lies beneath 11.24 square metres, or thereabouts, of garden (102b Rowley Way), the upper extremity of which is 4.4 metres above Ordnance Survey Datum and the lower extremity of which is 13.9 metres below Ordnance Survey Datum.
08126	All that stratum of subsoil that lies beneath 134.10 square metres, or thereabouts, of public road and footways (Loudoun Road), the upper extremity of which is 5.0 metres above Ordnance Survey Datum and the lower extremity of which is 13.3 metres below Ordnance Survey Datum.
08127	All that stratum of subsoil that lies beneath 115.73 square metres, or thereabouts, of bridge carrying public road and footways (Loudoun Road) over railway (West Coat Main line) works and land, the upper extremity of which is 5.0 metres above Ordnance Survey Datum and the lower extremity of which is 13.3 metres below Ordnance Survey Datum, excluding any interests held by Network Rail Infrastructure Limited.

IN WITNESS WHEREOF the Secretary of State for Transport has hereunto set its corporate seal on the day in the year first written above.

The **CORPORATE SEAL** of the SECRETARY OF STATE FOR TRANSPORT hereunto affixed to this deed is authenticated by

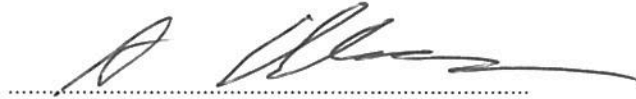

Authorised Signatory

Dated: 17th September 2021

SEAL REF
DIT GP/0665





Registered in England. Registration number 06791666.
Registered office: 2 Snowhill, Snow Hill, Queensway, Birmingham B4 6GA

HIGH SPEED RAIL (LONDON – WEST MIDLANDS) ACT 2017 GENERAL VESTING DECLARATION No. 564 SHEET 1 of 2

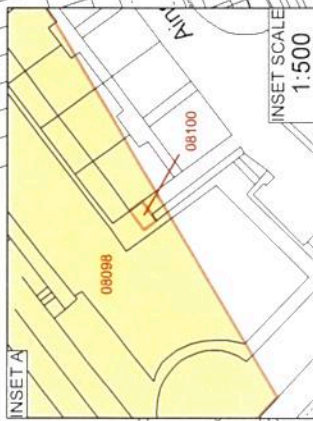
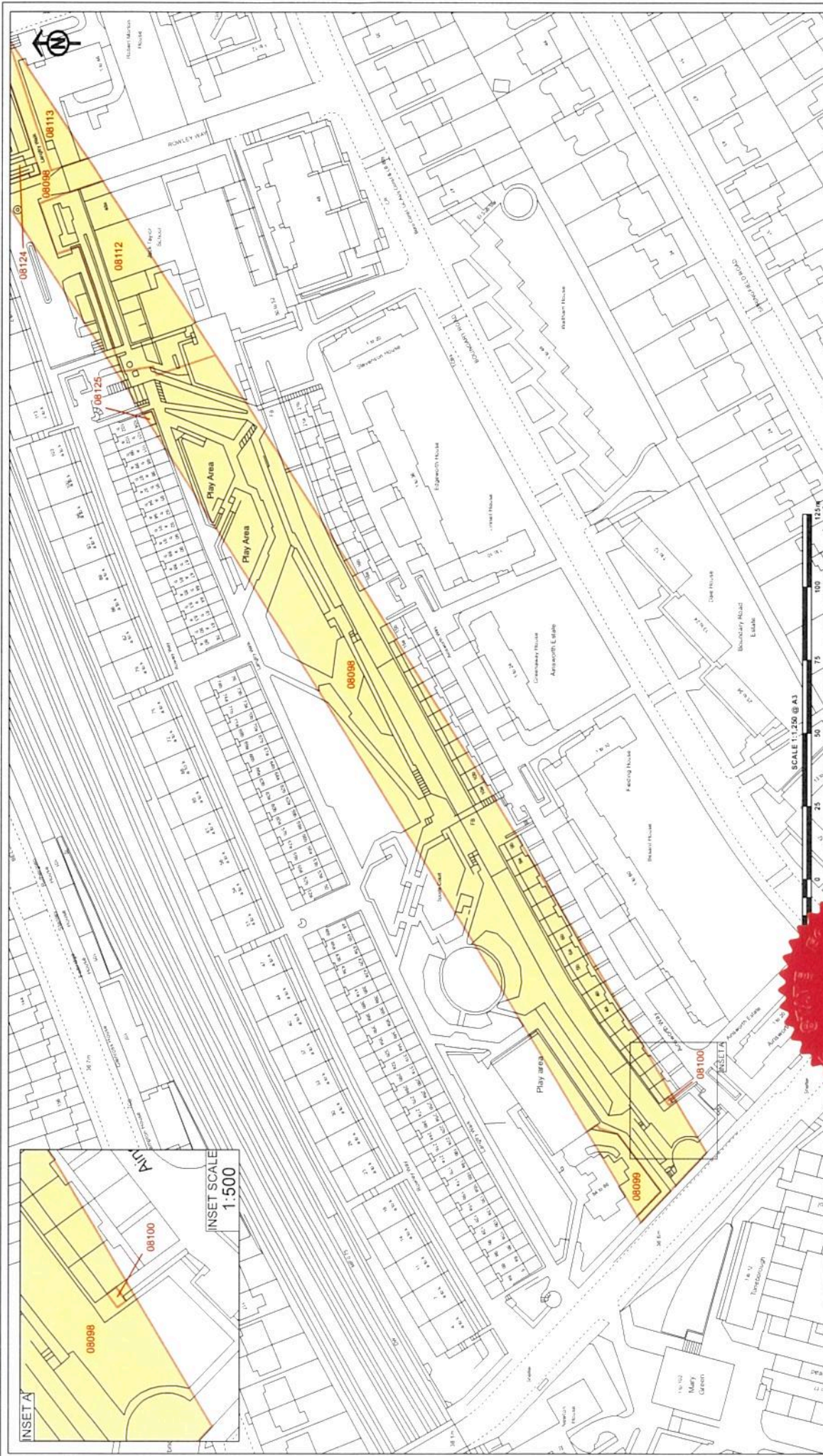

The CORPORATE SEAL of the
SECRETARY OF STATE
hereunto affixed to this declaration
is authenticated by

[Signature]
Authorised by the Secretary of State for Transport
Dated: 17th September 2021





Registered in England Registration number 06791686
 Registered office: 2 Snowhill, Sponner Hill, Goscote, Birmingham B14 6GA

HIGH SPEED RAIL (LONDON – WEST MIDLANDS) ACT 2017 GENERAL VESTING DECLARATION No. 564 SHEET 2 of 2

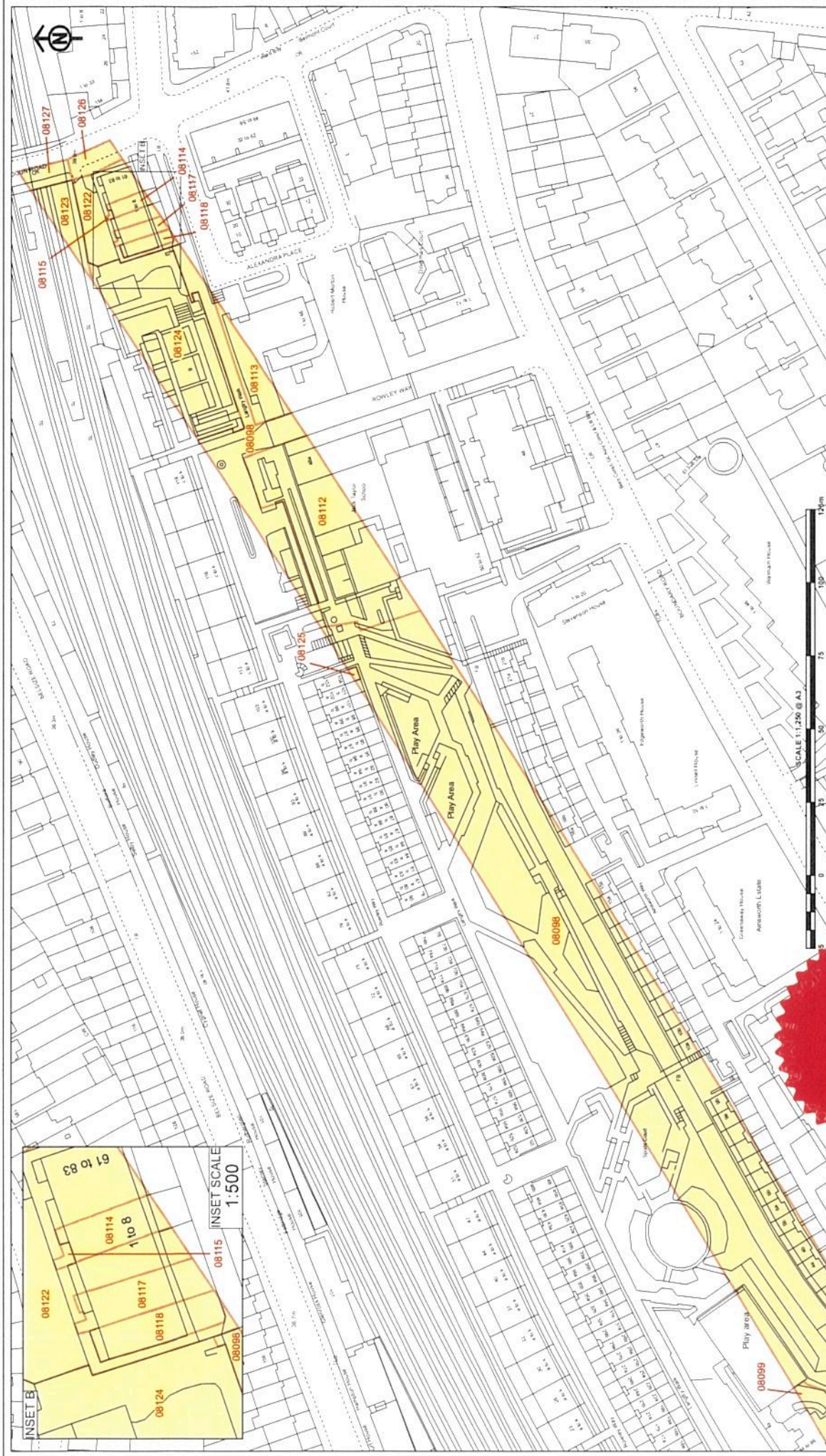

The CORPORATE SEAL of the
 SECRETARY OF STATE
 hereunto affixed to this deed
 is authenticated by

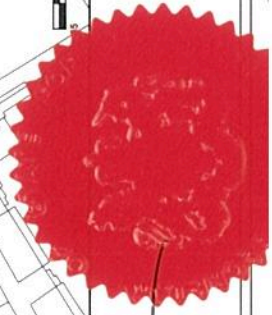

Authorised by the Secretary of State for Transport
 Dated: 14th September 2021

