

HIGH SPEED RAIL (LONDON – WEST MIDLANDS) ACT 2017

HIGH SPEED RAIL (LONDON – WEST MIDLANDS) GENERAL VESTING DECLARATION No. 623

This **GENERAL VESTING DECLARATION** is executed on
by the Secretary of State for Transport (“the Authority”).

1st November 2021

WHEREAS:

- (1) On 23 February 2017 the High Speed Rail (London – West Midlands) Act 2017 (“the High Speed Rail Act”) received Royal Assent authorising the Authority to acquire the land specified in the Schedule hereto.
- (2) Section 4(1) of the High Speed Rail Act authorises the Authority to acquire compulsorily so much of the land within the limits of the High Speed Rail Act as may be required for Phase One purposes¹.
- (3) Section 4(4) of the High Speed Rail Act provides that the Compulsory Purchase (Vesting Declarations) Act 1981 (“the 1981 Act”) applies as if the High Speed Rail Act were a compulsory purchase order and paragraph 3² of Schedule 6 to the High Speed Rail Act provides that the 1981 Act shall have effect subject to the modifications specified in that paragraph.
- (4) Notice pursuant to section 3A³ of the 1981 Act was first published on 11 October 2021. That notice included the particulars specified in section 3A(3) of the 1981 Act.

NOW THIS DEED WITNESSETH that, in exercise of the powers conferred on it by section 4 of the 1981 Act, the Authority hereby declares:-

1. The land described in the Schedule hereto (being part of the land authorised to be acquired by the High Speed Rail Act) and more particularly delineated and shown coloured pink on the plan annexed hereto, together with the right to enter upon and take possession of the land, shall vest in the Authority as from the end of the period of 4 months from the date on which the service of notices required by section 6⁴ of the 1981 Act is completed.

For the purposes of Section 2(2) of the 1981 Act, the specified period in relation to the land comprised in this declaration is one year and one day.

1 Phase One Purposes has meaning given by section 67 of the High Speed Rail Act

2 Paragraph 3 as substituted by section 11 of, and paragraph 6 of Schedule 14 to, the High Speed Rail Act.

3 Section 3A of the 1981 Act as inserted by paragraph 3(a) of Schedule 6 to the High Speed Rail Act as substituted by section 11 of, and paragraphs 6 and 7 of Schedule 14 to, that Act.

4 Section 6 as modified by paragraph 3(c) of Schedule 6 to the High Speed Rail Act, as substituted by section 11 of, and paragraph 6 of Schedule 14 to, that Act

SCHEDULE

Buckinghamshire

(1) Plot No.	(2) Description
66125	All interests in 100.1 square metres, or thereabouts, of grassland (Sewage Treatment Works)
66127	All interests in 8426.7 square metres, or thereabouts, of agricultural land, woodland, hedgerow and public footpath (TWY/18/2) (Sewage treatment Works)
66128	All interests in 23543.0 square metres, or thereabouts, of agricultural land, public footpaths (TWY/18/2 and TWY/19/3), pond, drain, woodland and hedgerow (Home Farm)
66132	All interests in 271.5 square metres, or thereabouts, of hedgerow, drain and public footpaths (TWY/18/1 and TWY/19/2) (Twyford Cricket Grounds)
66135	All interests in 680.5 square metres, or thereabouts, of agricultural land (Home Farm)
66137	All interests in 34841.5 square metres, or thereabouts, of agricultural land, hedgerows, drain and public footpaths (TWY/16/1 and TWY/17/1) (Home Farm)
66139	All interests in 8120.9 square metres, or thereabouts, of grassland and woodland (Seven Stars Cottage)
66140	All interests in 691.0 square metres, or thereabouts, of watercourse (Padbury Brook) and hedgerow (Three Bridge Mill)
66141	All interests in 60.4 square metres, or thereabouts, of dismantled railway and access track (Approach Farm)
66142	All interests in 16305.2 square metres, or thereabouts, of agricultural land, watercourse (Padbury Brook), hedgerow, woodland, footbridge and weir (Three Bridge Mill)
66143	All interests in 23746.7 square metres, or thereabouts, of agricultural land, hedgerows, woodland, drain and public footpaths (TWY/16/1 and TWY/17/1) (Home Farm)
66144	All interests in 20770.7 square metres, or thereabouts, of agricultural land, hedgerow and woodland (Approach Farm)
66145	All interests in 6433.2 square metres, or thereabouts, of dismantled railway, woodland, access track, watercourse (Padbury Brook) and footbridge (Approach Farm)
66146	All interests in 10781.7 square metres, or thereabouts, of agricultural land and hedgerow (Approach Farm)
66147	All interests in 18271.8 square metres, or thereabouts, of agricultural land, drain, hedgerow and public footpath (PBI/6/3) (Church View Farm)
66149	All interests in 57.0 square metres, or thereabouts, of watercourse (Padbury Brook)
66150	All interests in 1179.2 square metres, or thereabouts, of woodland and agricultural land (Padbury Brook)
66151	All interests in 76.5 square metres, or thereabouts, of watercourse (Padbury Brook)
66152	All interests in 97.1 square metres, or thereabouts, of woodland (Approach Farm)
66153	All interests in 34.2 square metres, or thereabouts, of watercourse (Padbury Brook)

IN WITNESS WHEREOF the Secretary of State for Transport has hereunto set its corporate seal on the day in the year first written above.

The **CORPORATE SEAL** of the SECRETARY OF STATE FOR TRANSPORT hereunto affixed to this deed is authenticated by



.....
Authorised Signatory

Dated: 1st November 2021



SEAL REF
DIT GP 10779

66155	All interests in 17110.1 square metres, or thereabouts, of dismantled railway, woodland, access track and public footpath (PBI/5(F)/7) (Approach Farm)
66156	All interests in 274.3 square metres, or thereabouts, of agricultural land, hedgerow, drain and public footpath (PBI/6/2) (Jubilee Lake)
66160	All interests in 8.2 square metres, or thereabouts, of woodland (Cowley Farm)
66162	All interests in 857.3 square metres, or thereabouts, of agricultural land and woodland (Church View Farm)
66163	All interests in 12980.6 square metres, or thereabouts, of agricultural land, drain, hedgerow and public footpaths (PBI/5(F)/7 and PBI/6/2) (Cowley Farm)
66164	All interests in 496.8 square metres, or thereabouts, of access track carrying restricted byway (PBI/5A/3) (Cowley Farm)
66165	All interests in 49.5 square metres, or thereabouts, of bridge carrying restricted byway (PBI/5A/3) and dismantled railway (Cowley Farm)
66167	All interests in 12.6 square metres, or thereabouts, of access track carrying restricted byway (PBI/5A/3) (Cowley Farm)
66168	All interests in 4865.7 square metres, or thereabouts, of agricultural land and hedgerows (Cowley Farm)
66169	All interests in 651.8 square metres, or thereabouts, of agricultural land and hedgerow (Cowley Farm)
66173	All interests in 146.7 square metres, or thereabouts, of access track carrying restricted byway (PBI/5A/3) and agricultural land (Cowley Farm)
69188	All interests in 9054.7 square metres, or thereabouts, of dismantled railway, woodland, agricultural land, drain and public footpaths (TWY/16/1, TWY/16/2, TWY/17/1 and TWY/18/2) (Approach Farm)
70338	All interests in 402.9 square metres, or thereabouts, of agricultural land (Home Farm)
70339	All interests in 2282.7 square metres, or thereabouts, of dismantled railway, access track and woodland (Home Farm)
71206	All interests in 1028.8 square metres, or thereabouts, of agricultural land, hedgerow, drain and public footpath (PBI/5(F)/7) (Church View Farm)

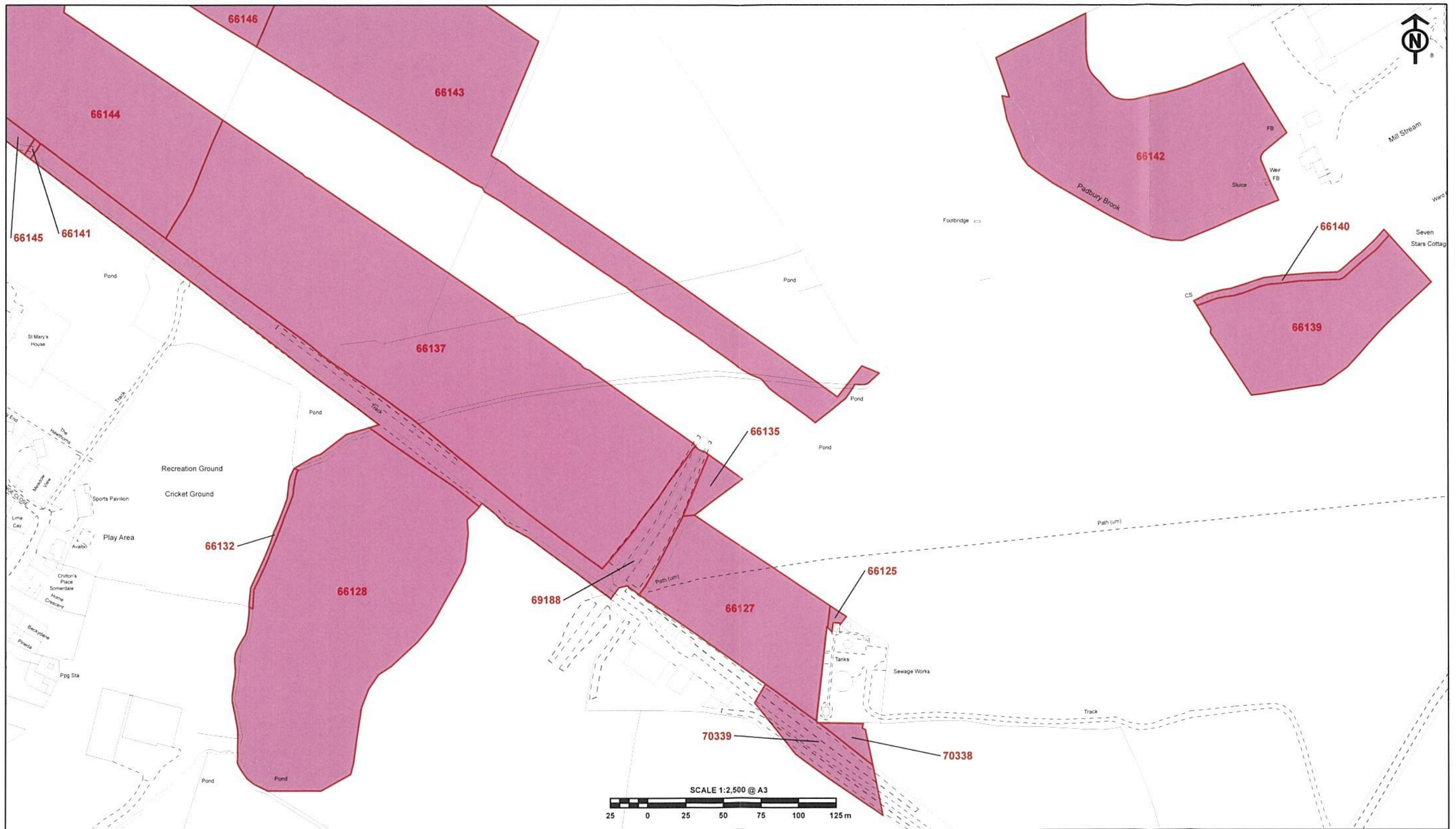

The CORPORATE SEAL of the
SECRETARY OF STATE
hereunto affixed to this deed
is authenticated by

Authorised by the Secretary of State for Transport

Dated 1st November 2024



0779

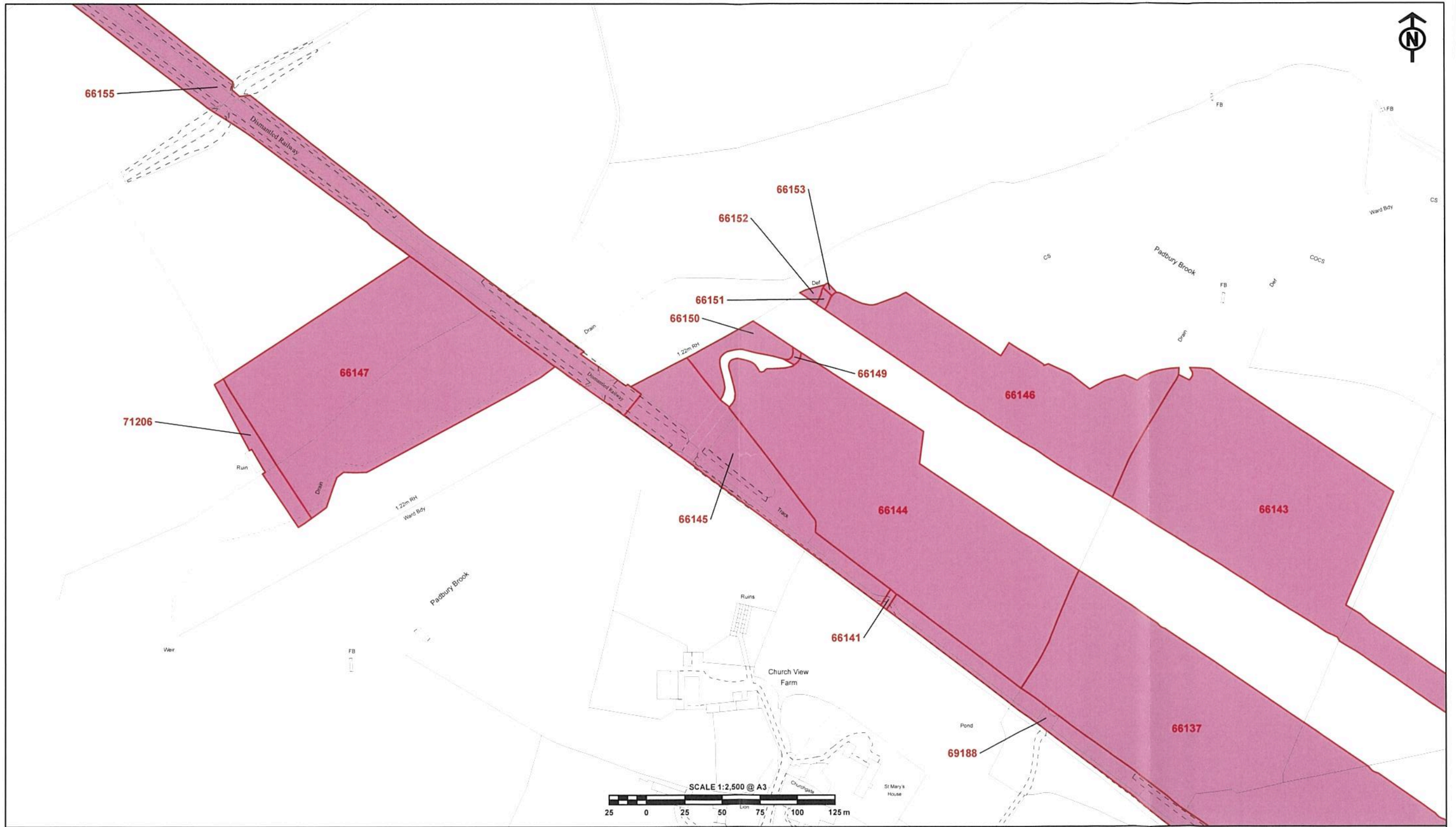

The CORPORATE SEAL of the
SECRETARY OF STATE
hereunto affixed to this deed
is authenticated by

.....
Authorised by the Secretary of State for Transport

Dated 1st November 2021

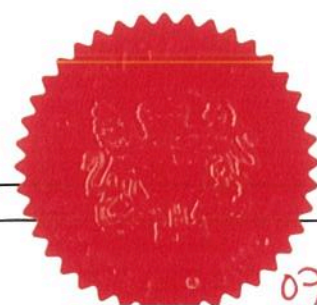

0779

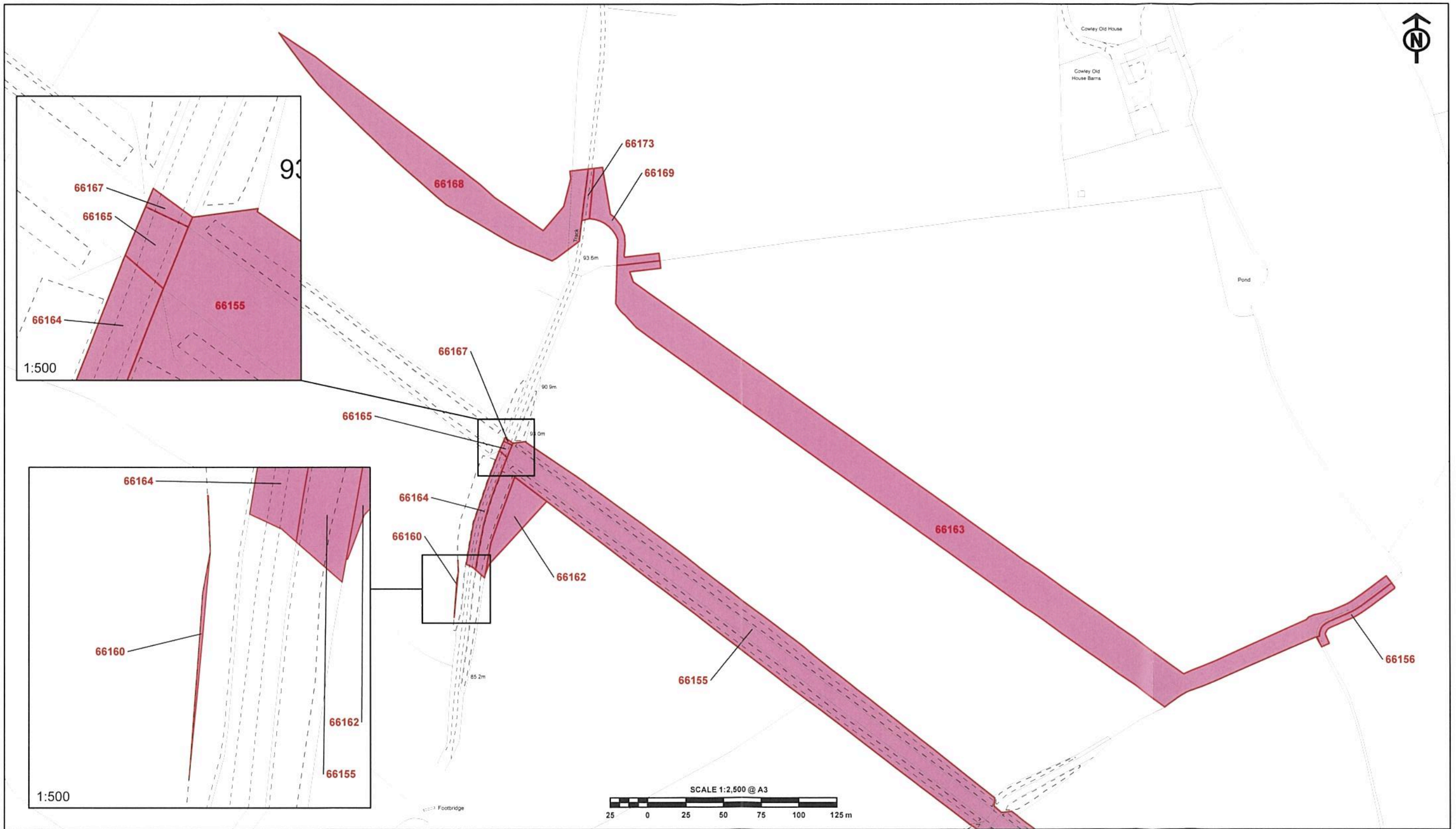

The CORPORATE SEAL of the
SECRETARY OF STATE
hereunto affixed to this deed
is authenticated by

Authorised by the Secretary of State for Transport

Dated 1st November 2021



0779

